

15-065-22897-00-00

For KCC Use: 3.26.03  
Effective Date: 3.26.03  
District # 4  
SGA?  Yes  No

KANSAS CORPORATION COMMISSION  
OIL & GAS CONSERVATION DIVISION

Form C-1  
September 1999  
Form must be Typed  
Form must be Signed  
All blanks must be Filled

**NOTICE OF INTENT TO DRILL**

Must be approved by KCC five (5) days prior to commencing well

Expected Spud Date April 15 2003  
month day year

Spot  East  
SE NE NE Sec. 3 Twp. 10 S. R. 21W  West  
990 feet from  /  (circle one) Line of Section  
330 feet from  /  (circle one) Line of Section

OPERATOR: License# 32754  
Name: ELYSIUM ENERGY, LLC  
Address: 1625 Broadway, Suite 2000  
City/State/Zip: Denver, CO, 80202  
Contact Person: Jim Annable  
Phone: (303) 389-3610

Is SECTION  Regular  Irregular?  
(Note: Locate well on the Section Plat on reverse side)

CONTRACTOR: License# 31548  
Name: Discovery Drilling

County: Graham  
Lease Name: Trible Well #: 9  
Field Name: Cooper

Well Drilled For:  Oil  Gas  OWWO  Seismic; # of Holes  Other  
 Enh Rec  Storage  Disposal  Other  
Well Class:  Infield  Pool Ext.  Wildcat  Other  
Type Equipment:  Mud Rotary  Air Rotary  Cable

Is this a Prorated / Spaced Field?  Yes  No  
Target Information(s): LKC & Arbuckle  
Nearest Lease or unit boundary: 330'  
Ground Surface Elevation: 2280 Est feet MSL

If OWWO: old well information as follows:  
Operator: \_\_\_\_\_  
Well Name: \_\_\_\_\_  
Original Completion Date: \_\_\_\_\_ Original Total Depth: \_\_\_\_\_

Water well within one-quarter mile:  Yes  No  
Public water supply well within one mile:  Yes  No  
Depth to bottom of fresh water: 150'  
Depth to bottom of usable water: 1000'  
Surface Pipe by Alternate: 1  2  
Length of Surface Pipe Planned to be set: 200+  
Length of Conductor Pipe required: None  
Projected Total Depth: 3850'  
Producing Formation Target: Arbuckle

Directional, Deviated or Horizontal wellbore?  Yes  No  
If Yes, true vertical depth: \_\_\_\_\_

Water Source for Drilling Operations:  
Well  Farm Pond  Other   
DWR Permit #: \_\_\_\_\_

Bottom Hole Location: \_\_\_\_\_  
KCC DKT #: \_\_\_\_\_

RECEIVED

MAR 21 2003

**KCC WICHITA AFFIDAVIT**

The undersigned hereby affirms that the drilling, completion and eventual plugging of this well will comply with K.S.A. 55-101, et. seq.  
It is agreed that the following minimum requirements will be met:

1. Notify the appropriate district office *prior* to spudding of well;
2. A copy of the approved notice of intent to drill *shall be* posted on each drilling rig;
3. The minimum amount of surface pipe as specified below *shall be set* by circulating cement to the top; in all cases surface pipe *shall be set* through all unconsolidated materials plus a minimum of 20 feet into the underlying formation.
4. If the well is dry hole, an agreement between the operator and the district office on plug length and placement is necessary *prior to plugging*;
5. The appropriate district office will be notified before well is either plugged or production casing is cemented in;
6. If an ALTERNATE II COMPLETION, production pipe shall be cemented from below any usable water to surface within **120 days** of spud date. *In all cases, NOTIFY district office* prior to any cementing.

I hereby certify that the statements made herein are true and to the best of my knowledge and belief.

Date: 19 March 2003 Signature of Operator or Agent: [Signature] Title: Agent

For KCC Use ONLY  
API # 15 - 065-22897-00-00  
Conductor pipe required NONE feet  
Minimum surface pipe required 200 feet per Alt. + (2)  
Approved by: RJP 3.21.03  
This authorization expires: 9.21.03  
(This authorization void if drilling not started within 6 months of effective date.)  
Spud date: \_\_\_\_\_ Agent: \_\_\_\_\_

- Remember to:
- File Drill Pit Application (form CDP-1) with Intent to Drill;
  - File Completion Form ACO-1 within 120 days of spud date;
  - File acreage attribution plat according to field proration orders;
  - Notify appropriate district office 48 hours prior to workover or re-entry;
  - Submit plugging report (CP-4) after plugging is completed;
  - Obtain written approval before disposing or injecting salt water.

2  
10  
21W

IN ALL CASES PLOT THE INTENDED WELL ON THE PLAT BELOW

Plat of acreage attributable to a well in a prorated or spaced field

If the intended well is in a prorated or spaced field, please fully complete this side of the form. If the intended well is in a prorated or spaced field complete the plat below showing that the well will be properly located in relationship to other wells producing from the common source of supply. Please show all the wells and within 1 mile of the boundaries of the proposed acreage attribution unit for gas wells and within 1/2 mile of the boundaries of the proposed acreage attribution unit for oil wells.

API No. 15 - \_\_\_\_\_
Operator: ELYSIUM ENERGY, LLC
Lease: Tribble
Well Number: 9
Field: Cooper
Number of Acres attributable to well: \_\_\_\_\_
QTR / QTR / QTR of acreage: \_\_\_\_\_

Location of Well: County: Graham
990 feet from N (circle one) Line of Section
330 feet from E (circle one) Line of Section
Sec. 3 Twp. 10 S. R. 21W [ ] East [X] West

Is Section X Regular or Irregular

If Section Is Irregular, locate well from nearest corner boundary.
Section corner used: NE NW SE SW

PLAT

(Show location of the well and shade attributable acreage for prorated or spaced wells.)
(Show footage to the nearest lease or unit boundary line.)

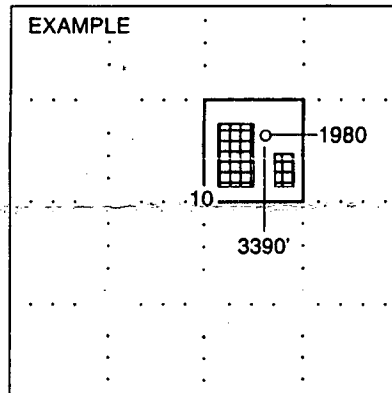
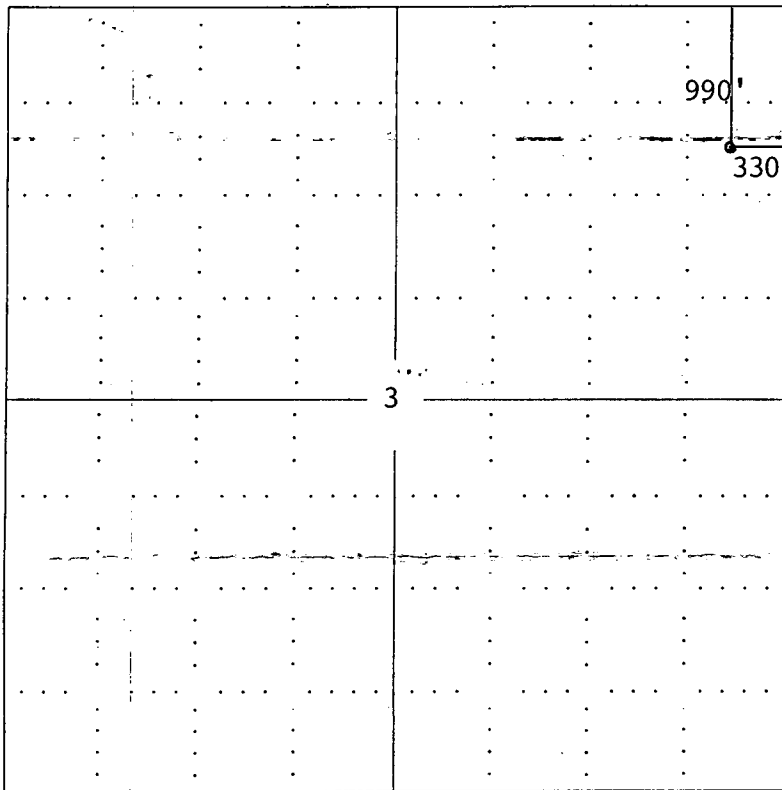

NOTE: In all cases locate the spot of the proposed drilling location.
Graham Co., KS

In plotting the proposed location of the well, you must show:

- 1. The manner in which you are using the depicted plat by identifying section lines, i.e. 1 section, 1 section with 8 surrounding sections, 4 sections, etc.
2. The distance of the proposed drilling location from the section's south / north and east / west.
3. The distance to the nearest lease or unit boundary line.
4. If proposed location is located within a prorated or spaced field a certificate of acreage attribution plat must be attached: (C0-7 for oil wells; CG-8 for gas wells).