

STATE OF KANSAS
STATE CORPORATION COMMISSION

WELL PLUGGING RECORD

Give All Information Completely
Make Required Affidavit
Mail or Deliver Report to
Conservation Division
State Corporation Comm.
245 North Water
Wichita, KS 67202

Rooks County, Sec. 21 Twp. 10 Rge. 20 E/W
Location as "NE/CNW $\frac{1}{4}$ SW $\frac{1}{4}$ " or footage from lines _____
E/2 SE NW
Lease Owner Earl M. Knighton
Lease Name Schonthaler #1 Well No. _____
Office Address Wichita, Kansas 67202
Character of Well (Completed as Oil, Gas or Dry Hole) _____

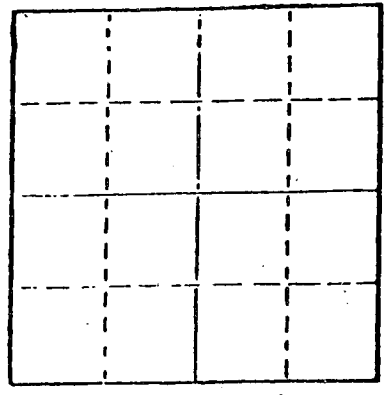

Date Well completed _____ 19____
Application for plugging filed _____ 19____
Application for plugging approved _____ 19____
Plugging commenced 11/4/77 19____
Plugging completed 11/9/77 19____
Reason for abandonment of well or producing formation _____
depleted.
If a producing well is abandoned, date of last production _____ 19____

Was permission obtained from the Conservation Division or its agents before plugging was commenced? yes

Name of Conservation Agent who supervised plugging of this well Massey
Producing formation _____ Depth to top _____ Bottom _____ Total Depth of Well 3764
Show depth and thickness of all water, oil and gas formations.

OIL, GAS OR WATER RECORDS

CASING RECORD

FORMATION	CONTENT	FROM	TO	SIZE	PUT IN	PULLED OUT
				8-5/8	292	none
				4 1/2"	3762	2811'

Describe in detail the manner in which the well was plugged, indicating where the mud fluid was placed and the method or methods used in introducing it into the hold. If cement or other plugs were used, state the character of same and depth placed, from _____ feet to _____ feet for each plug set.

Pushed wood plug to 3200', sanded to 3170' and ran 3 sacks cement. Loaded hole with salt water, shot pipe at 2813', pulled 70 joints. Pumped 20 sacks gel, 2 sacks hulls, 70 sacks cement, 8 sacks gel, plug and 70 sacks cement.

PLUGGING COMPLETE.

RECEIVED
STATE CORPORATION COMMISSION

NOV 14 1977

CONSERVATION DIVISION
Wichita, Kansas

(If additional description is necessary, use BACK of this sheet)

Name of Plugging Contractor KELSO CASING PULLING
CHASE, KANSAS

STATE OF KANSAS COUNTY OF RICE, ss.
R. DARRELL KELSO (employee of owner) or (owner or operator)
of the above-described well, being first duly sworn on oath, says: That I have knowledge of the facts, statements, and matters herein contained and the log of the above-described well as filed and that the same are true and correct. So help me God.

(Signature) [Signature]
CHASE, KANSAS (Address)

SUBSCRIBED AND SWORN TO before me this 10th day of November, 19 77

My commission expires _____

NOTARY PUBLIC
MARGARET MELCHER
Rice County, Ks.
My Comm. Exp. Feb 15 1979

[Signature]
Notary Public.

15-163-20634-0000

K.G.S. LIBRARY

State Geological Survey
WICHITA, BRANCH

KANSAS DIVISION

API No. 163 — 20,634
County Number

S. 21 T. 10 R. 20
Loc. C E2 SE NW

Operator: Earl M. Knighton
Address: 710 Petroleum Bldg. Wichita, Kansas 67202
Well No. #1 Lease Name: Schonthaler
Footage Location: 660 feet from (N) (S) line of NW 1/4, 330 feet from (E) (W) line
Principal Contractor: Revlin Drilling Company Geologist: J. Green
Spud Date: August 19, 1976 Total Depth: 3765 P.B.T.D.:
Date Completed: September 21, 1976 Oil Purchaser: Mobil

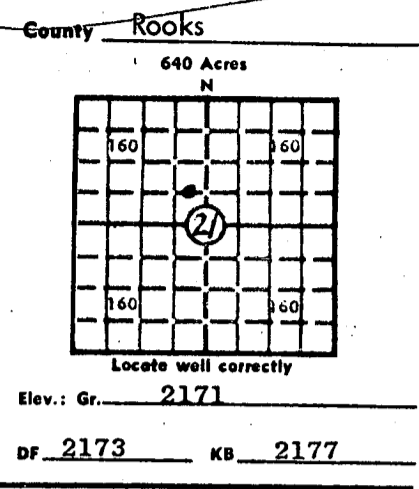

CASING RECORD

Report of all strings set — surface, intermediate, production, etc.

Purpose of string	Size hole drilled	Size casing set (in O.D.)	Weight lbs/ft.	Setting depth	Type cement	Sacks	Type and percent additives
Surface	12 1/4	8 5/8	24	290	Common Quick Set-	175	CACL
Production	7 7/8	4 1/2	9.5#	3762	Common	175	10% NACL

TUBING RECORD

Size	Setting depth	Packer set at
2 3/8	3751	

ACID, FRACTURE, SHOT, CEMENT SQUEEZE RECORD

Amount and kind of material used	Depth interval treated
500 Acid	Open Hole 3764-66

INITIAL PRODUCTION

Date of first production: October 4, 1976 Producing method (flowing, pumping, gas lift, etc.): Pumping

RATE OF PRODUCTION PER 24 HOURS	Oil bbls.	Gas	Water	Gas-oil ratio
	10	None	90	

Disposition of gas (vented, used on lease or sold):
Producing interval (s): 3764-66

Top Soil, rock, Sand and Shale	0	188
Shale	188	1660
Anhydrite	1660	1709
Shale and Shells	1709	2295
Lime and Shale	2295	3210
Lime	3210	3269
Lime and Shale	3269	3340
Lime	3340	3764

TD 3764

21-10-20W E/2 SE NW
#1 SCHONTHALER
COUNTY: ROOKS FIELD: MARGOITE
GEOL: J. R. GREEN
CARD ISSUED 8/19/76 P. 10 BOPD + WTR ARB 3761 1/2 - 3765 1/2
DATE: 12/2/76

SMP	TOPS	DEPTH	DATUM
TOP	3233	-1056	
HEEB	3435	-1258	
TOR	3459	-1282	
LKC	3475	-1298	
BKC	3680	-1503	
ARB	3760	-1587	
DD TD	3766	-1589	

8-5/8" 288/175SX, 4 1/2" 3762/175SX
DST (1) 3680-3755/75" 775, MSW, SIP
DST (2) 1077-1056# FP 65-368#
DST (2) 3756-64/1', 25' OC#, SIP 151-76# FP NA.
MICT - CO TD & DD 3766, PF 16/3761 1/2 - 3765 1/2, AC 1000, REC LD, SWB .8 BOPH, N/W/ 4 HRS, POP

RECEIVED
THE COMMISSIONER COMMISSION
NOV 14 1977
CONSERVATION DIVISION
Wichita, Kansas