

Give All Information Completely  
Make Required Affidavit  
Mail or Deliver Report to:  
Conservation Division  
State Corporation Commission  
211 No. Broadway  
Wichita, Kansas

WELL PLUGGING RECORD

ROOKS County, Sec. 29 Twp. 10s Rge. 20 (X) (W)

Location as "NE/CNW%SW%" or footage from lines SW NW NE  
Lease Owner PETROLEUM, INC.,  
Lease Name METHENY Well No. 1  
Office Address R.R. #2, GREAT BEND, KANSAS  
Character of Well (completed as Oil, Gas or Dry Hole) DRY HOLE  
Date well completed Nov. 18 19 65  
Application for plugging filed Nov. 18 19 65  
Application for plugging approved Nov. 18 19 65  
Plugging commenced Nov. 18 19 65  
Plugging completed Nov. 18 19 65  
Reason for abandonment of well or producing formation NO PRODUCIBLE ZONE

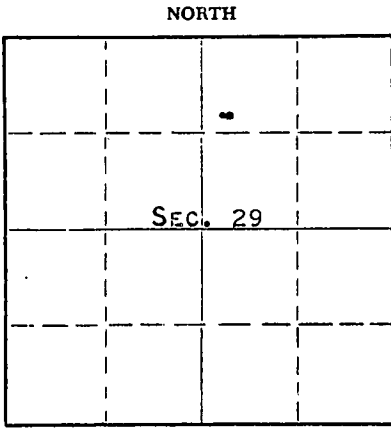

Locate well correctly on above Section Plat

If a producing well is abandoned, date of last production NONE 19  
Was permission obtained from the Conservation Division or its agents before plugging was commenced? YES

Name of Conservation Agent who supervised plugging of this well GILBERT LEIKER  
Producing formation \_\_\_\_\_ Depth to top \_\_\_\_\_ Bottom \_\_\_\_\_ Total Depth of Well 3794 Feet  
Show depth and thickness of all water, oil and gas formations.

OIL, GAS OR WATER RECORDS

CASING RECORD

FORMATION	CONTENT	FROM	TO	SIZE	PUT IN	PULLED OUT
				8-5/8"	215	NONE

Describe in detail the manner in which the well was plugged, indicating where the mud fluid was placed and the method or methods used in introducing it into the hole. If cement or other plugs were used, state the character of same and depth placed, from \_\_\_\_\_ feet to \_\_\_\_\_ feet for each plug set.

MUDDERED UP WITH HEAVY DRILLING MUD TO 540', FOLLOWED BY WOODEN PLUG, PLACED 20 SACKS CEMENT ON TOP OF PLUG. MUDDERED UP WITH HEAVY MUD TO 210', FOLLOWED BY WOODEN PLUG, PLACED 1/4 SACK HULLS, 20 SACKS CEMENT ON TOP OF PLUG. MUDDERED UP WITH HEAVY MUD TO 40', FOLLOWED BY WOODEN PLUG, PLACED 1/2 SACK HULLS, 10 SACKS CEMENT ON TOP OF PLUG TO BASE OF WELL CELLAR.

RECEIVED  
NOV 29 1965  
CONSERVATION DIVISION  
STATE OF KANSAS

(If additional description is necessary, use BACK of this sheet)

Name of Plugging Contractor GARVEY DRILLING COMPANY  
Address R.R. #2, GREAT BEND, KANSAS

STATE OF KANSAS, COUNTY OF BARTON, ss.  
MONTE CHADD (employee of owner) or (owner or operator) of the above-described well, being first duly sworn on oath, says: That I have knowledge of the facts, statements, and matters herein contained and the log of the above-described well as filed and that the same are true and correct. So help me God. MONTE CHADD, DIST. PROD. SUPT.

(Signature) *Monte Chadd*  
ROUTE #2, GREAT BEND, KANSAS  
(Address)

SUBSCRIBED AND SWORN TO before me this 23 day of NOVEMBER, 19 65

*Richard H. Dumble*  
Notary Public.

My commission expires MAY 28, 1969

# WELL LOG

15-163-30129-0000

COMPANY Petroleum, Inc.

SEC. 29 T. 10S R. 20W

FARM Metheny

NO. 1

LOC. SW NW NE

TOTAL DEPTH 3794'

COUNTY Rooks

COMM. 11-8-65

COMP. 11-17-65

CONTRACTOR Garvey Drilling Company

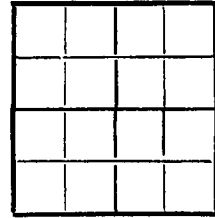

CASING 8 5/8" @ 215' w/175 sx

ELEVATION 2193' KB

PRODUCTION D & A

FIGURES INDICATE BOTTOM OF FORMATIONS

- 1045' Shale and Shells
- 1120' Sand
- 1170' Shale
- 1300' Sand
- 1666' Shale
- 1705' Anhydrite
- 2025' Shale and Shells
- 2260' Shale
- 2535' Lime and Shale
- 2685' Shale and Lime
- 2880' Lime and Shale
- 3001' Shale and Lime
- 3055' Shale
- 3445' Shale and Lime
- 3773' Lime
- 3784' Lime, Shale, and Dolomite
- 3794' Lime
- 3794' RTD

RECEIVED  
STATE CORPORATION COMMISSION

NOV 29 1965

CONSERVATION DIVISION  
Wichita, Kansas

State of Kansas }  
County of Barton } SS

I, Sam N. Stephens of Garvey Drilling Company

upon oath state the above and foregoing is a true and correct copy of the log of the Metheny No. 1 well.

Sam N. Stephens

Subscribed and sworn to before me this 23rd day of November 19 65

My Commission Expires: November 5, 1969

Richard D. Boye  
NOTARY PUBLIC