

STATE OF KANSAS  
STATE CORPORATION COMMISSION

Give All Information Completely  
Make Required Affidavit  
Mail or Deliver Report to:  
Conservation Division  
State Corporation Commission  
800 Bitting Building  
Wichita, Kansas

WELL PLUGGING RECORD

Graham County, Sec. 5 Twp. 10 Rge. (E) 21 (W)

Location as "NE/CNW&SW&" or footage from lines NW SE NE  
Lease Owner Jones, Shelburne & Farmer, Inc.  
Lease Name Rudman Well No. 1  
Office Address Russell, Kansas  
Character of Well (completed as Oil, Gas or Dry Hole) Dry  
Date well completed 6-8 19 54  
Application for plugging filed 6-8 19 54  
Application for plugging approved 6-8 19 54  
Plugging commenced 6-8 19 54  
Plugging completed 6-8 19 54  
Reason for abandonment of well or producing formation dry

NORTH

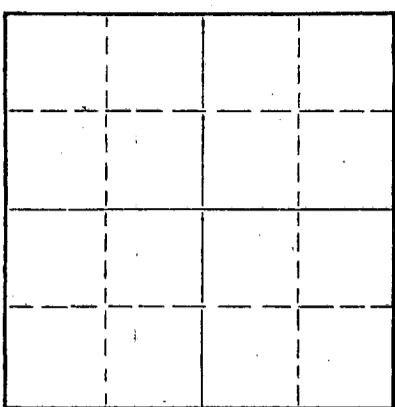

Locate well correctly on above Section Plat

If a producing well is abandoned, date of last production never produced 19  
Was permission obtained from the Conservation Division or its agents before plugging was commenced? yes

Name of Conservation Agent who supervised plugging of this well Eldon Petty  
Producing formation \_\_\_\_\_ Depth to top \_\_\_\_\_ Bottom \_\_\_\_\_ Total Depth of Well 3900 Feet  
Show depth and thickness of all water, oil and gas formations.

OIL, GAS OR WATER RECORDS

CASING RECORD

FORMATION	CONTENT	FROM	TO	SIZE	PUT IN	PULLED OUT
				8 5/8	165	None

Describe in detail the manner in which the well was plugged, indicating where the mud fluid was placed and the method or methods used in introducing it into the hole. If cement or other plugs were used, state the character of same and depth placed, from \_\_\_\_\_ feet to \_\_\_\_\_ feet for each plug set.

1. Filled hole with heavy mud
2. Pushed plug to 165'
3. Dumped 1/2 sack hulls on top of plug
4. Mixed 15 sacks cement and dumped on top of hulls
5. Filled hole to top
6. Pushed plug to 40'
7. Dumped in 1/2 sack hulls
8. Mixed 10 sacks cement and filled hole to top with same

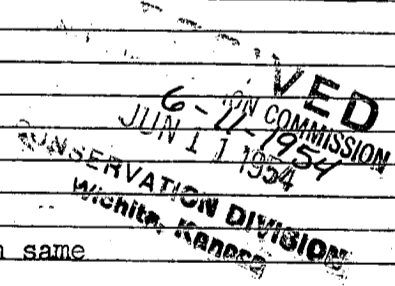

(If additional description is necessary, use BACK of this sheet)

Name of Plugging Contractor Jones, Shelburne & Farmer, Inc.  
Address Russell, Kansas

STATE OF Kansas COUNTY OF Russell, ss.  
John O. Farmer (employee of owner) or (owner or operator) of the above-described

well, being first duly sworn on oath, says: That I have knowledge of the facts, statements, and matters herein contained and the log of the above-described well as filed and that the same are true and correct. So help me God.

(Signature) John O. Farmer  
Russell, Kansas (Address)

SUBSCRIBED AND SWORN to before me this 8th day of June, 19 54

Bonnie Berryhill  
Notary Public.



PLUGGING  
FILE SEC 5 10 R 210  
BOOK PAGE 40 LINE 4

**OPERATOR** Jones, Shelburne & Farmer, Inc.

15-065-02285 -00-00

**FORMATION RECORD**

**ADDRESS** Russell, Kansas

Give detailed description and thickness of all formations drilled through, contents of sand, whether, dry, water, oil or gas.

RGE 21  
 TWP 10  
 SEC 5  
 COUNTY Graham  
 WELL NO 1  
 FARM NAME Rudman

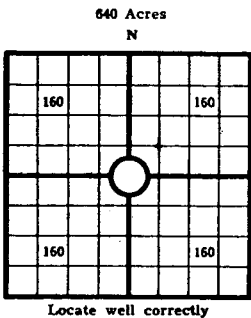

COUNTY Graham SEC 5 TWP 10 RGE 21  
 COMPANY OPERATING Jones, Shelburne & Farmer, Inc.  
 OFFICE ADDRESS Russell, Kansas  
 FARM NAME Rudman WELL NO 1  
 DRILLING STARTED 5-30, 1954, DRILLING FINISHED 6-7, 1954  
 DATE OF FIRST PRODUCTION COMPLETED  
 WELL LOCATED NW 1/4 SE 1/4 NE 1/4, North of South  
 Line and \_\_\_\_\_ ft. East of West Line of Quarter Section  
 Elevation (Relative to sea level) DERRICK FLOOR 2292 GROUND \_\_\_\_\_  
 CHARACTER OF WELL (Oil, gas or dryhole) dry

Formation	Top	Bottom	Formation	Top	Bottom
Shale	0	659			
Shale & sand	659	1480			
Redbed & shale	1480	1725			
Anhydrite	1725	1770			
Shale & shells	1770	2195			
Shale & lime	2195	2370			
Lime & shale	2370	2940			
Lime	2940	3010			
Shale & lime	3010	3265			
Lime & shale	3265	3602			
Lime	3602	3619			
Lime & shale	3619	3705			
Lime	3705	3746			
Shale & lime	3746	3790			
Lime & shale	3790	3900			

**OIL OR GAS SANDS OR ZONES**

Name	From	To	Name	From	To
1			4		
2			5		
3			6		

**Perforating Record If Any**

**Shot Record**

Formation	From	To	No. of Shots	Formation	From	To	Size of Shot

**CASING RECORD**

Amount Set						Amount Pulled				Packer Record	
Size	Wt.	Thds.	Make	Ft.	In.	Ft.	In.	Size	Length	Depth Set	Make
5/8				165							

Liner Record: Amount \_\_\_\_\_ Kind \_\_\_\_\_ Top \_\_\_\_\_ Bottom \_\_\_\_\_

**CEMENTING AND MUDDING**

Size	Amount Set		Sacks Cement	Chemical		Method of Cementing	Amount	Mudding Method	Results (See Note)
	Ft.	In.		Gal.	Make				
8 5/8	165								

Note: What method was used to protect sands if outer strings were pulled? \_\_\_\_\_

NOTE: Were bottom hole plugs used? \_\_\_\_\_ If so, state kind, depth set and results obtained \_\_\_\_\_

**TOOLS USED**

Rotary Tools were used from \_\_\_\_\_ feet to \_\_\_\_\_ Cable tools were used from \_\_\_\_\_ feet to \_\_\_\_\_ feet, and from \_\_\_\_\_ feet to \_\_\_\_\_ feet, and from \_\_\_\_\_ feet to \_\_\_\_\_ feet

Type Rig \_\_\_\_\_

**INITIAL PRODUCTION TEST**

Describe initial test: whether by flow through tubing or casing or by pumping \_\_\_\_\_

Amount of Oil Production \_\_\_\_\_ bbls. Size of choke, if any \_\_\_\_\_ Length of test \_\_\_\_\_ Water \_\_\_\_\_

Production \_\_\_\_\_ bbls. Gravity of oil \_\_\_\_\_ Type of Pump if pump is used, describe \_\_\_\_\_

\_\_\_\_\_

\_\_\_\_\_

\_\_\_\_\_

**PLUGGING**  
 FILE SEC 5 TWP 10 R 21  
 BOOK PAGE 10 LINE 4

**TOPS:**

Elevation 2294  
 Heebner 3489  
 Lansing 3530  
 Base K.C. 3759  
 Cogg. 3865  
 Simpson 3887  
 T.D. 3900

I, the undersigned, being first duly sworn upon oath, state that this well record is true, correct and complete according to the records of this office and to the best of my knowledge and belief.

\_\_\_\_\_  
 Name and title of representative of company

Subscribed and sworn to before me this 9th day of June, 1954

My Commission expires April 23, 1956

Notary Public