

STATE OF KANSAS
STATE CORPORATION COMMISSION

WELL PLUGGING RECORD

Give All Information Completely
Make Required Affidavit
Mail or Deliver Report to:
Conservation Division
State Corporation Commission
800 Bittling Building
Wichita, Kansas

NORTH

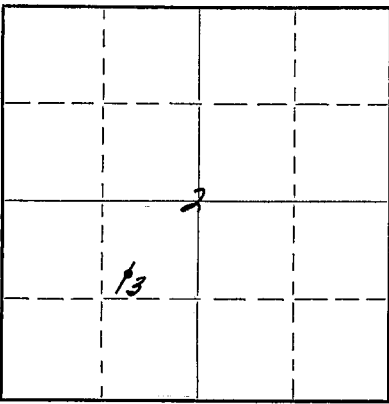

Locate well correctly on above
Section Plat

Graham County, Sec. 2 Twp. 10S Rge. (E) 21 (W)

Location as "NE/CNW $\frac{1}{4}$ /SW $\frac{1}{4}$ " or footage from lines SW/4 NE/4 SW/4
Lease Owner Skelly Oil Company
Lease Name V. V. White Well No. 3
Office Address Box 1650, Tulsa, Oklahoma
Character of Well (completed as Oil, Gas or Dry Hole) Dry Hole
Date well completed November 10, 1950
Application for plugging filed November 10, 1950
Application for plugging approved November 13, 1950
Plugging commenced November 10, 1950
Plugging completed November 10, 1950
Reason for abandonment of well or producing formation Dry Hole

If a producing well is abandoned, date of last production 19
Was permission obtained from the Conservation Division or its agents before plugging was commenced? Yes (verbally)

Name of Conservation Agent who supervised plugging of this well Mr. Eldon Petty
Producing formation none Depth to top Bottom Total Depth of Well 3913 Feet
Show depth and thickness of all water, oil and gas formations.

OIL, GAS OR WATER RECORDS

CASING RECORD

Formation	Content	From	To	OD Size	Put In	Pulled Out
Arbuckle Lime	Dry	3884'	3913'	8-5/8"	274'7"	None

Describe in detail the manner in which the well was plugged, indicating where the mud fluid was placed and the method or methods used in introducing it into the hole. If cement or other plugs were used, state the character of same and depth placed, from feet to feet for each plug set.

25 sacks of cement	3913' to 3832'
Mud laden fluid	3832' to 285'
25 sacks of cement	285' to 208'
Mud laden fluid	208' to 83'
25 sacks of cement	83' to 6'
Surface soil	6' to 0'

RECEIVED
STATE CORPORATION COMMISSION
12-6-1950

(If additional description is necessary, use BACK of this sheet)

Correspondence regarding this well should be addressed to Skelly Oil Company
Address Box 391
Hutchinson, Kansas

STATE OF Kansas, COUNTY OF Reno, ss.
H. E. Wansley (employee of owner) of the above-described well,
being first duly sworn on oath, says: That I have knowledge of the facts, statements, and matters herein contained and the log of the above-described well as filed and that the same are true and correct. So help me God.

(Signature) [Handwritten Signature]

Box 391, Hutchinson, Kansas (Address)

SUBSCRIBED AND SWORN to before me this 7th day of December, 1950.

[Handwritten Signature] Notary Public.

My commission expires April 7, 1951

PLUGGING
FILE SEC 2 T 10 R 21 W
BOOK PAGE 48 LINE 12

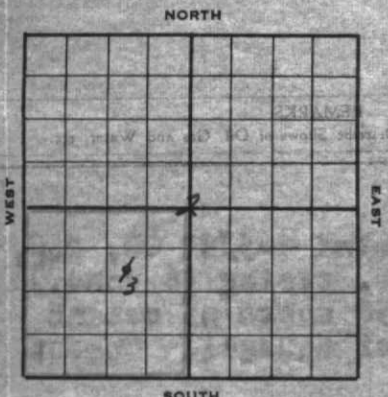

SKELLY OIL COMPANY

Well Record

Lease Name and No. Vera V. White Well No. 3 Elev. 2242' OP
 Lease Description SW/4 of Section 2-108-21W, Graham County, Kansas
 Location made October 21, 19 50 by P. J. Cussen
990 feet from North line 990 feet from East line 88/4
990 feet from South line 990 feet from West line of Sec. 2

Work com'd 10/25 19 50 Rig comp'd 10/28 19 50 Drlg. com'd 10/28 19 50 Drlg. comp'd 11/10 19 50

Rig Contractor Claude Wentworth Drilling Co., Inc.
 Drilling Contractor Claude Wentworth Drilling Co., Inc., Tulsa, Oklahoma

Rotary Drilling from 0' to 3913' Cable Tool Drilling from _____ to _____

Commenced Producing _____ 19 _____
 Initial Prod. before shot or acid _____ Bbls.
 Initial Prod. after shot or acid _____ Bbls.
 Dry Gas Well Press. _____ Volume _____ Cu. ft.
 Casing Head Gas Pressure _____ Volume _____ Cu. ft.
 Braden Head (_____ Size) Gas Pressure _____ Volume _____ Cu. ft.
 Braden Head (_____ Size) Gas Pressure _____ Volume _____ Cu. ft.

PRODUCING FORMATION DRY HOLE (Name) Top _____ Bottom _____ TOTAL DEPTH 3913'

CASING RECORD

OD Size	Wt.	Thds.	Where Set	PULLED OUT			LEFT IN			KIND	Cond'n	CEMENTING	
				Jts.	Feet	In.	Jts.	Feet	In.			Sacks Used	Method Employed
<u>8-5/8" 24#</u>			<u>PE 280'</u>				<u>7</u>	<u>274</u>	<u>7</u>	<u>R3 88</u>	<u>0</u>	<u>150</u>	<u>Halliburton</u>
<u>(8-5/8" OD casing set 5' in collar)</u>													

Liner Set at _____ Length _____ Perforated at _____
 Liner Set at _____ Length _____ Perforated at _____
 Packer Set at _____ Size and Kind _____
 Packer Set at _____ Size and Kind _____

SHOT OR ACID TREATMENT RECORD

	FIRST	SECOND	THIRD	FOURTH
Date				
Acid Used				
Size Shot				
Shot Between	Ft. and Ft.	Ft. and Ft.	Ft. and Ft.	Ft. and Ft.
Size of Shell				
Put in by (Co.)				
Length anchor				
Distance below Cas'g				
Damage to Casing or Casing Shoulder				

SIGNIFICANT GEOLOGICAL FORMATIONS

NAME	Top	Bottom	GAS		OIL		REMARKS
			From	To	From	To	
<u>Topeka Lime</u>	<u>3266'</u>						
<u>Heebner Shale</u>	<u>3451'</u>						
<u>Lansing Lime</u>	<u>3491'</u>						
<u>Conglomerate</u>	<u>3761'</u>						
<u>Arbuckle Lime</u>	<u>3884'</u>						

CLEANING OUT RECORDS

	DATE COMMENCED	DATE COMPLETED	PROD. BEFORE	PROD. AFTER	REMARKS
1st					See Reverse for other details.
2nd					" " " " "
3rd					" " " " "
4th					" " " " "

PLUGGING BACK AND DEEPENING RECORDS

	Date Commenced	Date Completed	No. Feet Plugged Back or Deepened	Prod. Before	Prod. After	REMARKS
1st						See Reverse for other details.
2nd						" " " " "
3rd						" " " " "
4th						" " " " "

(See Reverse for Record of Formation)

RECORD OF FORMATIONS

FORMATION	TOP	BOTTOM	REMARKS
Surface soil and clay, sand and shells	0	40	
Shale and shells	40	285	Set and cemented 4-5/8" OD, 24' P.E. 2-3, S.S. casing (C cond.) at 280' w/ 150 sacks of cement and 3 sacks of aquagel. Cement circulated.
Drilled 12" hole			
Shale and shells	285	1708	
Anhydrite	1708	1748	
Shale and shells	1748	2285	
Line	2285	2390	
Line and shale	2390	2550	
Line	2550	2690	
Shale and shale	2690	2834	
Shale	2834	2900	
Line and shale	2900	3100	
Line	3100	3185	
Line and shale	3185	3500	
Line and chert	3500	3543	
Line	3543	3580	
Broken line	3580	3655	
Line	3655	3780	
Conglomerate	3780	3884	
Medium hard grey crystalline dolomite	3884	3913	
TOTAL DEPTH		3913'	

Since there were no commercial shows of oil or gas encountered in drilling to the total depth of 3913', regular authority was granted to plug and abandon the well. On November 10, 1950, the well was plugged as follows:

25 sacks of cement	3913' to 3832'
Mud laden fluid	3832' to 285'
25 sacks of cement	285' to 208'
Mud laden fluid	208' to 83'
25 sacks of cement	83' to 6'
Surface soil	6' to 0'

SLOPE TEST DATA: Tests were taken at 250' intervals from 500' to 3250' inclusive, with no deviation from vertical noted.

SHOT OR ACID TREATMENT RECORD

DATE	TIME	DEPTH	REMARKS

PLUGGING
 FILE SEC 2 T 10
 BOOK PAGE 48 LINE 12

SIGNIFICANT GEOLOGICAL FORMATIONS

NAME	TOP	BOTTOM	REMARKS

CLEANING OUT RECORDS

DATE COMPLETED	PROD. BEFORE	PROD. AFTER	REMARKS

PLUGGING BACK AND DETEMING RECORDS

DATE COMPLETED	DATE COMPLETED	PROD. BEFORE	PROD. AFTER	REMARKS

(See Reverse for Record of Formations)

15-2-100
 15-2-100
 15-2-100