

15-163-01029-00-01

"OWWO"

FOR KCC USE:

FORM C-1 7/91

FORM MUST BE TYPED

FORM MUST BE SIGNED

ALL BLANKS MUST BE FILLED

EFFECTIVE DATE: 12-17-91
DISTRICT # 4
SGAT... Yes No

State of Kansas
NOTICE OF INTENTION TO DRILL

Must be approved by the K.C.C. five (5) days prior to commencing well

Expected Spud Date December 15, 1991
month day year

Spot SE NW NW Sec 30 Twp 10 S. Rg 20 X East West

OPERATOR: License # 5363
Name: BEREXCO INC.
Address: 970 Fourth Financial Center
City/State/Zip: Wichita, KS 67202
Contact Person: Gary Misak
Phone: (316) 265-3311

4290 feet from South-North line of Section
4290 feet from East-West line of Section
IS SECTION X REGULAR IRREGULAR?

CONTRACTOR: License #: 8241
Name: Emphasis Oil Operations

(NOTE: Locate well on the Section Plat on Reverse Side)
County: Rooks
Lease Name: Raymond A Well #: 2 "OWWO"
Field Name: Laura

Well Drilled For: Well Class: Type Equipment:
Oil Enh Rec X Infield X Mud Rotary
Gas Storage Pool Ext. Air Rotary
X OWWO X Disposal Wildcat Cable
Seismic; # of Holes Other

Is this a Prorated/Spaced Field? yes X no
Target Formation(s): Arbuckle
Nearest lease or unit boundary: 330
Ground Surface Elevation: 2107 feet MSU

If OWWO: old well information as follows:
Operator: Heathman Drilling Co., Inc.
Well Name: Raymond A #2
Comp. Date: 2-5-51 Old Total Depth D&A

Water well within one-quarter mile: yes X no
Public water supply well within one mile: yes X no
Depth to bottom of fresh water: 100
Depth to bottom of usable water: 934

Directional, Deviated or Horizontal wellbore? yes X no
If yes, true vertical depth:
Bottom Hole Location:

Surface Pipe by Alternate: 1 X 2
Length of Surface Pipe ~~Minimum~~ set: 107
Length of Conductor pipe required: 0
Projected Total Depth: 4200
Formation at Total Depth: Arbuckle

Water Source for Drilling Operations:
well farm pond X other

DWR Permit #: applied for
Will Cores Be Taken? yes X no
If yes, proposed zone:

AFFIDAVIT

The undersigned hereby affirms that the drilling, completion and eventual plugging of this well will comply with K.S.A. 55-101, et. seq.

It is agreed that the following minimum requirements will be met:

- 1. Notify the appropriate district office prior to spudding of well;
- 2. A copy of the approved notice of intent to drill shall be posted on each drilling rig;
- 3. The minimum amount of surface pipe as specified below shall be set by circulating cement to the top; in all cases surface pipe shall be set through all unconsolidated materials plus a minimum of 20 feet into the underlying formation;
- 4. If the well is dry hole, an agreement between the operator and the district office on plug length and placement is necessary prior to plugging;
- 5. The appropriate district office will be notified before well is either plugged or production casing is cemented in;
- 6. IF AN ALTERNATE II COMPLETION, PRODUCTION PIPE SHALL BE CEMENTED FROM BELOW ANY USABLE WATER TO SURFACE WITHIN 120 DAYS OF SPUD DATE. IN ALL CASES, NOTIFY DISTRICT OFFICE PRIOR TO ANY CEMENTING.

I hereby certify that the statements made herein are true and to the best of my knowledge and belief.

Date: 12/6/91 Signature of Operator or Agent: Gary T. ... Title: District Engineer

RECEIVED
KANSAS CORPORATION COMMISSION
12-11-1991
DEC 11 1991
CONSERVATION DIVISION
WICHITA, KS

FOR KCC USE:
API # 15- 163-01, 029
Conductor pipe required 0 feet
Minimum surface pipe required 107 feet per Alt. (2)
Approved by: [Signature] 12-12-91
This authorization expires: 6-12-92
(This authorization void if drilling not started within 6 months of effective date.)
Spud date: Agent:

RECEIVED
STATE CORPORATION COMMISSION
NOV 09 1991
CONSERVATION DIVISION
Wichita, Kansas
RECEIVED
STATE CORPORATION COMMISSION

- REMEMBER TO:
- File Drill Pit Application (form CDP-1) with Intent to Drill;
 - File Completion Form ACO-1 within 120 days of spud date;
 - File acreage attribution plat according to field proration orders;
 - Notify appropriate district office 48 hours prior to workover or re-entry;
 - Submit plugging report (CP-4) after plugging is completed;
 - Obtain written approval before disposing or injecting salt water.

Mail to: Conservation Division, 200 Colorado Derby Building, 202 W. First St., Wichita, Kansas 67202-1286.

DEC 09 1991
[Signature]

IN ALL CASES PLOT THE INTENDED WELL ON THE PLAT BELOW

PLAT OF ACREAGE ATTRIBUTABLE TO A WELL IN A PRORATED OR SPACED FIELD

If the intended well is in a prorated or spaced field, please fully complete this side of the form. If the intended well is in a prorated or spaced field complete the plat below showing that the well will be properly located in relationship to other wells producing from the common source of supply. Please show all the wells within 1 mile of the boundaries of the proposed acreage attribution unit for gas wells and within 1/2 mile of the boundaries of the proposed acreage attribution unit for oil wells.

API NO. 15- _____
 OPERATOR BEREXCO INC
 LEASE Raymond A
 WELL NUMBER #2 "OWWO"
 FIELD Laura

LOCATION OF WELL: COUNTY _____ Rooks
 4290 feet from south/~~north~~ line of section
 4290 feet from east/~~west~~ line of section
 SECTION 30 TWP 10S RG 20W

NUMBER OF ACRES ATTRIBUTABLE TO WELL _____
 QTR/QTR/QTR OF ACREAGE _____

IS SECTION X REGULAR or _____ IRREGULAR
IF SECTION IS IRREGULAR, LOCATE WELL FROM NEAREST CORNER BOUNDARY.

Section corner used: _____ NE _____ NW _____ SE _____ SW

PLAT

(Show location of the well and shade attributable acreage for prorated or spaced wells.)

(Show footage to the nearest lease or unit boundary line.)

R 20W

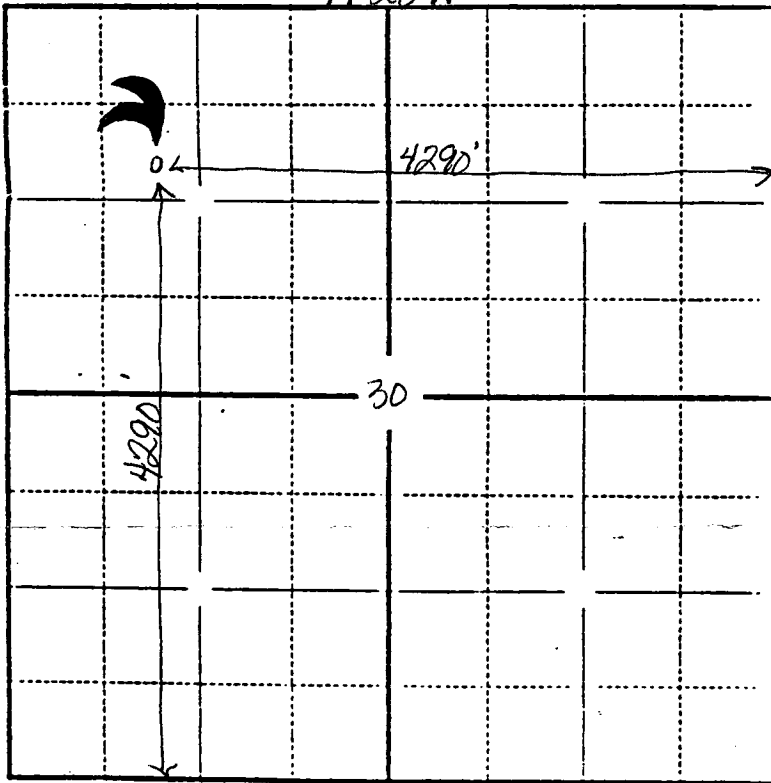

T
10
S

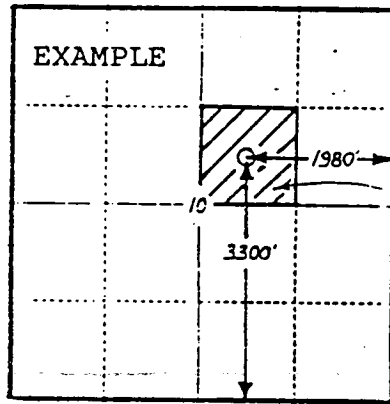

SEWARD CO.

In plotting the proposed location of the well, you must show:

- 1) The manner in which you are using the depicted plat by identifying section lines, i.e. 1 section, 1 section with 8 surrounding sections, 4 sections, etc.;
- 2) the distance of the proposed drilling location from the section's south/north and east/west lines; and
- 3) the distance to the nearest lease or unit boundary line.