

JAN 06 2003

For KCC Use: 1-11-03
Effective Date: 4
District #
SGA? Yes No

KANSAS CORPORATION COMMISSION
OIL & GAS CONSERVATION DIVISION
NOTICE OF INTENT TO DRILL

KCC WICHITA

Form C-1
September 1999

Form must be Typed
Form must be Signed
All blanks must be Filled

Must be approved by KCC five (5) days prior to commencing well
Rp: 150N & 80E of

Expected Spud Date January 15 2003
month day year

Spot N12 SW NE Sec. 10 Twp. 10 S. R. 21
1500 feet from N Line of Section
1900 feet from E Line of Section

OPERATOR: License# 5030
Name: Vess Oil Corporation
Address: 8100 E. 22nd Street North, Bldg. 300
City/State/Zip: Wichita, KS 67226
Contact Person: W.R. Horigan
Phone: 316-682-1537 EXT 103

Is SECTION Regular Irregular?
(Note: Locate well on the Section Plat on reverse side)

CONTRACTOR: License# 6039
Name: L. D. Drilling, Inc.

County: Graham
Lease Name: Bartos Well #: 11
Field Name: Cooper

Well Drilled For: Oil Gas OWWO Seismic; Other
Well Class: Infield Pool Ext. Wildcat Other
Type Equipment: Mud Rotary Air Rotary Cable

Is this a Prorated / Spaced Field? Yes No
Target Formation(s): Arbuckle

Nearest Lease or unit boundary: 740
Ground Surface Elevation: 2274 feet MSL

Water well within one-quarter mile: Yes No
Public water supply well within one mile: Yes No

Depth to bottom of fresh water: 150
Depth to bottom of usable water: 1000

Surface Pipe by Alternate: 1 2
Length of Surface Pipe Planned to be set: 240'

Length of Conductor Pipe required: NA
Projected Total Depth: 3900'

Formation at Total Depth: Arbuckle
Water Source for Drilling Operations: Well Farm Pond Other

If OWWO: old well information as follows:
Operator:
Well Name:
Original Completion Date: Original Total Depth:

DWR Permit #: (Note: Apply for Permit with DWR)

Directional, Deviated or Horizontal wellbore? Yes No
If Yes, true vertical depth:
Bottom Hole Location:
KCC DKT #:

Will Cores be taken? Yes No
If Yes, proposed zone:

AFFIDAVIT

The undersigned hereby affirms that the drilling, completion and eventual plugging of this well will comply with K.S.A. 55-101, et. seq.
It is agreed that the following minimum requirements will be met:

- 1. Notify the appropriate district office prior to spudding of well;
- 2. A copy of the approved notice of intent to drill shall be posted on each drilling rig;
- 3. The minimum amount of surface pipe as specified below shall be set by circulating cement to the top; in all cases surface pipe shall be set through all unconsolidated materials plus a minimum of 20 feet into the underlying formation.
- 4. If the well is dry hole, an agreement between the operator and the district office on plug length and placement is necessary prior to plugging;
- 5. The appropriate district office will be notified before well is either plugged or production casing is cemented in;
- 6. If an ALTERNATE II COMPLETION, production pipe shall be cemented from below any usable water to surface within 120 days of spud date. In all cases, NOTIFY district office prior to any cementing.

I hereby certify that the statements made herein are true and to the best of my knowledge and belief.

Date: 1/3/03 Signature of Operator or Agent: [Signature] Title: Vice President-Operations

For KCC Use ONLY
API # 15 - 065-22871-00-00
Conductor pipe required NONE feet
Minimum surface pipe required 200 feet per Alt. # 2
Approved by: RSP 1-6-03
This authorization expires: 7-6-03
(This authorization void if drilling not started within 6 months of effective date.)
Spud date: Agent:

Remember to:

- File Drill Pit Application (form CDP-1) with Intent to Drill;
- File Completion Form ACO-1 within 120 days of spud date;
- File acreage attribution plat according to field proration orders;
- Notify appropriate district office 48 hours prior to workover or re-entry;
- Submit plugging report (CP-4) after plugging is completed;
- Obtain written approval before disposing or injecting salt water.

10 10 21W

IN ALL CASES PLOT THE INTENDED WELL ON THE PLAT BELOW

Plat of acreage attributable to a well in a prorated or spaced field

If the intended well is in a prorated or spaced field, please fully complete this side of the form. If the intended well is in a prorated or spaced field complete the plat below showing that the well will be properly located in relationship to other wells producing from the common source of supply. Please show all the wells and within 1 mile of the boundaries of the proposed acreage attribution unit for gas wells and within 1/2 mile of the boundaries of the proposed acreage attribution unit for oil wells.

API No. 15 - _____

Operator: _____

Lease: _____

Well Number: _____

Field: _____

Number of Acres attributable to well: _____

QTR / QTR / QTR of acreage: _____

Location of Well: County: _____

_____ feet from S / N (circle one) Line of Section

_____ feet from E / W (circle one) Line of Section

Sec. _____ Twp. _____ S. R. _____ East West

Is Section _____ Regular or _____ Irregular

If Section is Irregular, locate well from nearest corner boundary.

Section corner used: ___ NE ___ NW ___ SE ___ SW

PLAT

(Show location of the well and shade attributable acreage for prorated or spaced wells.)

(Show footage to the nearest lease or unit boundary line.)

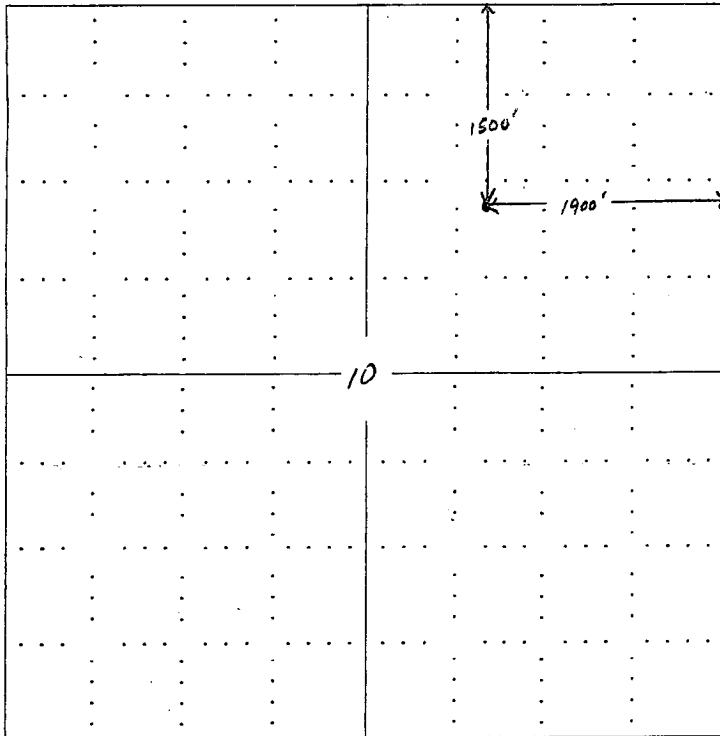

RECEIVED
JAN 06 2003
KCC WICHITA

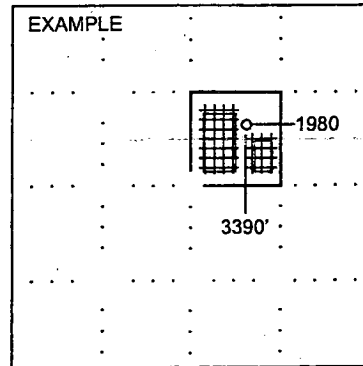

SEWARD CO.

NOTE: In all cases locate the spot of the proposed drilling location.

In plotting the proposed location of the well, you must show:

1. The manner in which you are using the depicted plat by identifying section lines, i.e. 1 section, 1 section with 8 surrounding sections, 4 sections, etc.
2. The distance of the proposed drilling location from the section's south / north and east / west.
3. The distance to the nearest lease or unit boundary line.
4. If proposed location is located within a prorated or spaced field a certificate of acreage attribution plat must be attached: (CO-7 for oil wells; CG-8 for gas wells).