

EFFECTIVE DATE: 10-11-94  
DISTRICT # 4  
SGA? Yes No

State of Kansas  
NOTICE OF INTENTION TO DRILL

FORM MUST BE TYPED  
FORM MUST BE SIGNED  
ALL BLANKS MUST BE FILLED

Must be approved by the K.C.C. five (5) days prior to commencing well

Expected Spud Date 10-28-94  
month day year

Spot 150' N of SENESW Sec 2... Twp ... 10 S, Rg ... 21 East West

OPERATOR: License # 4058  
Name: American Warrior, Inc.  
Address: P.O. Box 399  
City/State/Zip: Garden City, KS 67846  
Contact Person: Kevin Wiles  
Phone: 316-275-2963

1800' feet from South / North line of Section  
2310' feet from East / West line of Section  
IS SECTION X REGULAR IRREGULAR?

CONTRACTOR: License #: UNKNOWN  
Name: UNKNOWN

(NOTE: Locate well on the Section Plat on Reverse Side)  
County: Graham  
Lease Name: Vera White Well #: 2  
Field Name: Copper  
Is this a Prorated/Spaced Field? yes X no  
Target Formation(s): Arbuckle  
Nearest lease or unit boundary: 330'  
Ground Surface Elevation: 2275 est. feet MSL  
Water well within one-quarter mile: yes X no  
Public water supply well within one mile: yes X no  
Depth to bottom of fresh water: 55'  
Depth to bottom of usable water: 9.75'  
Surface Pipe by Alternate: 1 X 2  
Length of Surface Pipe Planned to be set: 210'  
Length of Conductor pipe required: NONE  
Projected Total Depth: 3825'  
Formation at Total Depth: Arbuckle  
Water Source for Drilling Operations:  
... well ... farm pond X other  
DWR Permit #:   
Will Cores Be Taken?: yes X no  
If yes, proposed zone:   
RECEIVED  
STATE CORPORATION COMMISSION  
OCT 11 1994  
10-11-1994

Well Drilled For: Well Class: Type Equipment:  
X Oil Enh Rec X Infield X Mud Rotary  
Gas Storage Pool Ext. Air Rotary  
OWWO Disposal Wildcat Cable  
Seismic; # of Holes Other  
Other

If OWWO: old well information as follows:  
Operator:   
Well Name:   
Comp. Date: Old Total Depth

Directional, Deviated or Horizontal wellbore? yes no  
If yes, true vertical depth:   
Bottom Hole Location:

AFFIDAVIT

The undersigned hereby affirms that the drilling, completion and eventual plugging of this well will comply with 101, et. seq.  
It is agreed that the following minimum requirements will be met:

- 1. Notify the appropriate district office prior to spudding of well;
- 2. A copy of the approved notice of intent to drill shall be posted on each drilling rig;
- 3. The minimum amount of surface pipe as specified below shall be set by circulating cement to the top; in all cases surface pipe shall be set through all unconsolidated materials plus a minimum of 20 feet into the underlying formation;
- 4. If the well is dry hole, an agreement between the operator and the district office on plug length and placement is necessary prior to plugging;
- 5. The appropriate district office will be notified before well is either plugged or production casing is cemented in;
- 6. IF AN ALTERNATE II COMPLETION, PRODUCTION PIPE SHALL BE CEMENTED FROM BELOW ANY USABLE WATER TO SURFACE WITHIN 120 DAYS OF SPUD DATE. IN ALL CASES, NOTIFY DISTRICT OFFICE PRIOR TO ANY CEMENTING.

I hereby certify that the statements made herein are true and to the best of my knowledge and belief.  
Date: 10-7-1994 Signature of Operator or Agent: Kevin Wiles Title: Production Manager

FOR KCC USE:  
API # 15- 065-22748  
Conductor pipe required NONE feet  
Minimum surface pipe required 200' feet per Alt. X  
Approved by: CB 10-11-94  
This authorization expires: 4-11-95  
(This authorization void if drilling not started within 6 months of effective date.)  
Spud date: Agent:

REMEMBER TO:

- File Drill Pit Application (form CDP-1) with Intent to Drill;
- File Completion Form ACO-1 within 120 days of spud date;
- File acreage attribution plat according to field proration orders;
- Notify appropriate district office 48 hours prior to workover or re-entry;
- Submit plugging report (CP-4) after plugging is completed;
- Obtain written approval before disposing or injecting salt water.

Mail to: Conservation Division, 200 Colorado Derby Building, 202 W. First St., Wichita, Kansas 67202-1286.

2  
10  
21

IN ALL CASES PLOT THE INTENDED WELL ON THE PLAT BELOW

PLAT OF ACREAGE ATTRIBUTABLE TO A WELL IN A PRORATED OR SPACED FIELD

If the intended well is in a prorated or spaced field, please fully complete this side of the form. If the intended well is in a prorated or spaced field complete the plat below showing that the well will be properly located in relationship to other wells producing from the common source of supply. Please show all the wells within 1 mile of the boundaries of the proposed acreage attribution unit for gas wells and within 1/2 mile of the boundaries of the proposed acreage attribution unit for oil wells.

API NO. 15- \_\_\_\_\_  
 OPERATOR American Warrior, Inc.  
 LEASE Vera White  
 WELL NUMBER #2  
 FIELD Copper

LOCATION OF WELL: COUNTY Graham  
1800' feet from south/north line of section  
2310' feet from east/west line of section  
 SECTION 2 TWP 10S RG 21W

NUMBER OF ACRES ATTRIBUTABLE TO WELL 10  
 QTR/QTR/QTR OF ACREAGE SE - NE - SW

IS SECTION X REGULAR or IRREGULAR  
IF SECTION IS IRREGULAR, LOCATE WELL FROM NEAREST CORNER BOUNDARY.

Section corner used: NE NW SE X SW  
 PLAT

(Show location of the well and shade attributable acreage for prorated or spaced wells.)  
 (Show footage to the nearest lease or unit boundary line.)

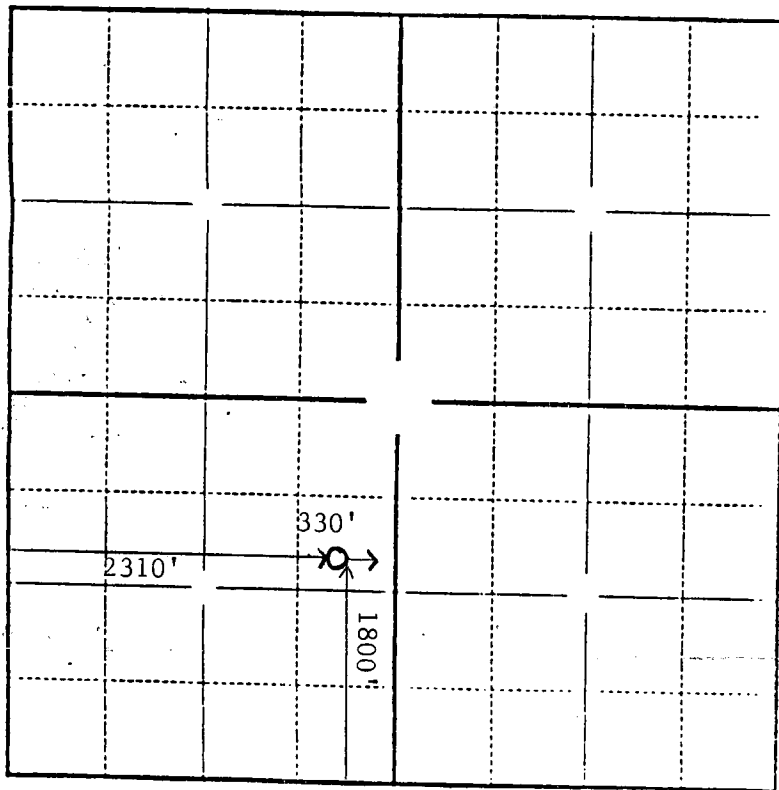

1 Section Graham County

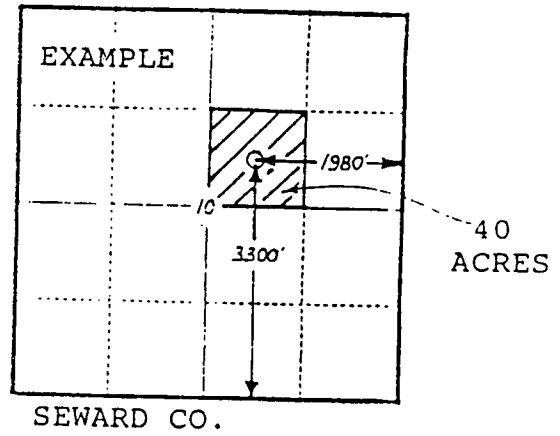

In plotting the proposed location of the well, you must show:

- 1) The manner in which you are using the depicted plat by identifying section lines, i.e. 1 section, 1 section with 8 surrounding sections, 4 sections, etc.;
- 2) the distance of the proposed drilling location from the section's south/north and east/west lines; and
- 3) the distance to the nearest lease or unit boundary line.