

For KCC Use: 6-26-2001
 Effective Date: 4
 District # 4
 SGA? Yes No

KANSAS CORPORATION COMMISSION
 OIL & GAS CONSERVATION DIVISION

Form C-1
 September 1999
 Form must be Typed
 Form must be Signed
 All blanks must be Filled

NOTICE OF INTENT TO DRILL

Must be approved by KCC five (5) days prior to commencing well

Expected Spud Date 6-29-2001
 month day year

Operator License# 9449
 Name: GREAT EASTERN ENERGY & DEVELOPMENT
 Address: BOX 150
 City/State/Zip: BOGUE KANSAS 67625
 Contact Person: MICHEAL A. DAVIGNON
 Phone: 915-682-1178

Contractor License# 30606
 Name: MURFIN DRGLG INC.

Well Drilled For:	Well Class:	Type Equipment:
<input checked="" type="checkbox"/> Oil	<input type="checkbox"/> Enh Rec	<input checked="" type="checkbox"/> Infield
<input type="checkbox"/> Gas	<input type="checkbox"/> Storage	<input type="checkbox"/> Pool Ext.
<input type="checkbox"/> OWD	<input type="checkbox"/> Disposal	<input type="checkbox"/> Wildcat
<input type="checkbox"/> Seismic; _____ of Holes	<input type="checkbox"/> Other	<input type="checkbox"/> Cable
<input type="checkbox"/> Other		

If OWWO: old well information as follows:
 Operator: _____
 Well Name: _____
 Original Completion Date: _____ Original Total Depth: _____

Directional, Deviated or Horizontal wellbore? Yes No
 If Yes, true vertical depth: _____
 Bottom Hole Location: _____
 KCC DKT #: _____

Spot East West
SW NW NW Sec. 2 Twp. 10 S. R. 21
990' feet from S / (N) (circle one) Line of Section
330' feet from E / (W) (circle one) Line of Section
 Is SECTION Regular _____ Irregular?

(Note: Locate well on the Section Plat on reverse side)
 County: GRAHAM
 Lease Name: NOAH Well #: 1
 Field Name: COOPER
 Is this a Prorated / Spaced Field? Yes No
 Target Information(s): ARBUCKLE
 Nearest Lease or unit boundary: 330'
 Ground Surface Elevation: 2265est feet MSL
 Water well within one-quarter mile: Yes No
 Public water supply well within one mile: Yes No
 Depth to bottom of fresh water: 150'
 Depth to bottom of usable water: 1980 B/DAKOTA
 Surface Pipe by Alternate: 1 2
 Length of Surface Pipe Planned to be set: 225'
 Length of Conductor Pipe required: 0'
 Projected Total Depth: 3820'
 Producing Formation Target: ARBUCKLE
 Water Source for Drilling Operations:
 Well _____ Farm Pond Other _____
 DWR Permit #: _____
 (Note: Apply for Permit with DWR)
 Will Cores be taken? Yes No
 If Yes, proposed zone: _____

AFFIDAVIT

The undersigned hereby affirms that the drilling, completion and eventual plugging of this well will comply with K.S.A. 65-101, et. seq.
 It is agreed that the following minimum requirements will be met:

1. Notify the appropriate district office prior to spudding of well;
2. A copy of the approved notice of intent to drill shall be posted on each drilling rig;
3. The minimum amount of surface pipe as specified below shall be set by circulating cement to the top; in all cases surface pipe shall be set through all unconsolidated materials plus a minimum of 20 feet into the underlying formation.
4. If the well is dry hole, an agreement between the operator and the district office on plug length and placement is necessary prior to plugging;
5. The appropriate district office will be notified before well is either plugged or production casing is cemented in;
6. If an ALTERNATE II COMPLETION, production pipe shall be cemented from below any usable water to surface within 120 days of spud date. In all cases, NOTIFY district office prior to any cementing.

I hereby certify that the statements made herein are true and to the best of my knowledge and belief.

Date: 6-29-01 Signature of Operator or Agent: [Signature] Title: Agent

For KCC Use ONLY
 API # 15 - 065-22819-0000
 Conductor pipe required NONE feet
 Minimum surface pipe required 200 feet per Alt. (2)
 Approved by: JK 6-21-2001
 This authorization expires: 12-21-2001
 (This authorization void if drilling not started within 6 months of effective date.)
 Spud date: _____ Agent: _____

- Remember to:**
- File Drill Pit Application (form CDP-1) with Intent to Drill;
 - File Completion Form ACO-1 within 120 days of spud date;
 - File acreage attribution plat according to field proration orders;
 - Notify appropriate district office 48 hours prior to workover or re-entry;
 - Submit plugging report (CP-4) after plugging is completed;
 - Obtain written approval before disposing or injecting salt water.

RECEIVED
 KANSAS CORPORATION COMMISSION

JUN 21 2001
 6-21-2001

10
21M

IN ALL CASES PLOT THE INTENDED WELL ON THE PLAT BELOW

Plat of acreage attributable to a well in a prorated or spaced field

If the intended well is in a prorated or spaced field, please fully complete this side of the form. If the intended well is in a prorated or spaced field complete the plat below showing that the well will be properly located in relationship to other wells producing from the common source of supply. Please show all the wells and within 1 mile of the boundaries of the proposed acreage attribution unit for gas wells and within 1/2 mile of the boundaries of the proposed acreage attribution unit for oil wells.

API No. 15 - _____
 Operator: GREAT EASTERN ENERGY & DEVELOPMENT 490'
 Lease: NOAH
 Well Number: 1
 Field: _____
 Number of Acres attributable to well: _____
 QTR / QTR / QTR of acreage: SW - NW - NW

Location of Well: County: GRAHAM
 _____ feet from S (circle one) Line of Section
330 feet from E (circle one) Line of Section
 Sec. 2 Twp. 10 S. R. 21 East West
 Is Section X Regular or _____ Irregular
 If Section is Irregular, locate well from nearest corner boundary.
 Section corner used: NE NW SE SW

PLAT

*(Show location of the well and shade attributable acreage for prorated or spaced wells.)
 (Show footage to the nearest lease or unit boundary line.)*

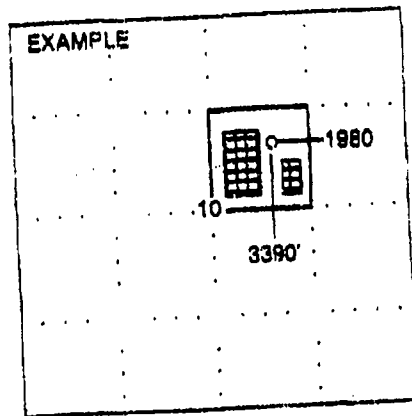
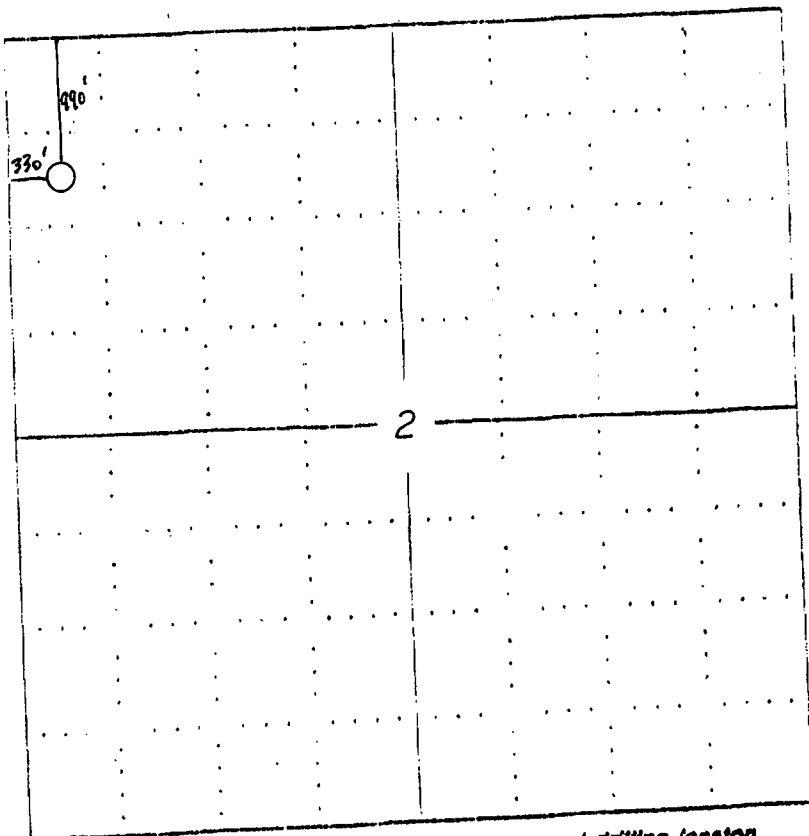

NOTE: In all cases locate the spot of the proposed drilling location.

In plotting the proposed location of the well, you must show:

1. The manner in which you are using the depleted plat by identifying section lines, i.e. 1 section, 1 section with 8 surrounding sections, 4 sections, etc.
2. The distance of the proposed drilling location from the section's south / north and east / west.
3. The distance to the nearest lease or unit boundary line.
4. If proposed location is located within a prorated or spaced field a certificate of acreage attribution plat must be attached: (CG-7 for oil wells, CG-8 for gas wells).

WASAS CORPORATION & ASSOCIATES

21 2001

CONSERVATION OF ENERGY