

STATE CORPORATION COMMISSION OF KANSAS
OIL & GAS CONSERVATION DIVISION
WELL COMPLETION OR RECOMPLETION FORM
ACO-1 WELL HISTORY
DESCRIPTION OF WELL AND LEASE

Operator: License # .7076
Name .Black Diamond Oil, Inc.
Address .1105 E. 30th, Suite 'A'
Hays, Kansas 67601
City/State/Zip

Purchaser

Operator Contact Person .Kenneth Vehige
Phone .(913)-625-5891

Contractor: License # .8241
Name .Emphasis Oil Operations

Wellsite Geologist .Kenneth Vehige
Phone .(913)-625-5891

Designate Type of Completion
 New Well Re-Entry Workover
 Oil SWD Temp Abd
 Gas Inj Delayed Comp.
 Dry Other (Core, Water Supply etc.)

If **OWWO**: old well info as follows:
Operator
Well Name
Comp. DateOld Total Depth.....

WELL HISTORY

Drilling Method:
 Mud Rotary Air Rotary Cable

.....12-11-8612-18-8612-18-86.....
Spud Date Date Reached TD Completion Date

.....3740' R.T.D.
Total Depth PBTB

Amount of Surface Pipe Set and Cemented at 218 feet
Multiple Stage Cementing Collar Used? Yes No
If yes, show depth set.....feet
If alternate 2 completion, cement circulated
from.....feet depth to.....w/.....SX cmt
Cement Company Name
Invoice #

API NO. 15-163-22900.....

County...Rooks.....

.....SE ..SE ..NE Sec.30... Twp.10...Rge.20... East
..... West

.....2970... Ft North from Southeast Corner of Section
.....330... Ft West from Southeast Corner of Section
(Note: Locate well in section plat below)

Lease Name.....Allphin.....Well #.1.....

Field Name.....

Producing Formation.....

Elevation: Ground.....2150.....KB.....2155.....

Section Plat

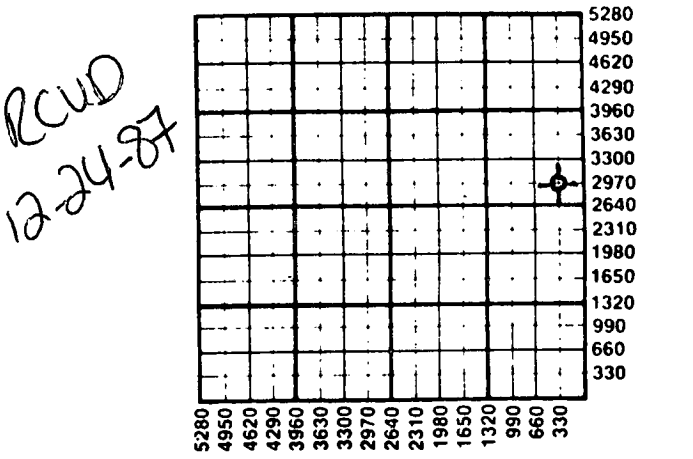

WATER SUPPLY INFORMATION
Disposition of Produced Water: Disposal
Docket # Repressuring

Questions on this portion of the ACO-1 call:
Water Resources Board (913) 296-3717
Source of Water:
Division of Water Resources Permit #.....

Groundwater.....Ft North from Southeast Corner
(Well)Ft West from Southeast Corner of
Sec Twp Rge East West
 Surface Water.2800 Ft North from Southeast Corner
(Stream, pond etc.)1450 Ft West from Southeast Corner
Sec 6 Twp 11 Rge 20 East West
 Other (explain).....
(purchased from city, R.W.D. #)

INSTRUCTIONS: This form shall be completed in duplicate and filed with the Kansas Corporation Commission, 200 Colorado Derby Building, Wichita, Kansas 67202, within 90 days after completion or recompletion of any well. Rule 82-3-130 and 82-3-107 apply.
Information on side two of this form will be held confidential for a period of 12 months if requested in writing and submitted with the form. See rule 82-3-107 for confidentiality in excess of 12 months.
One copy of all wireline logs and drillers time log shall be attached with this form. Submit CP-4 form with all plugged wells. Submit CP-111 form with all temporarily abandoned wells.

All requirements of the statutes, rules and regulations promulgated to regulate the oil and gas industry have been fully complied with and the statements herein are complete and correct to the best of my knowledge.

Signature Kenneth Vehige
Title.....Owner/Operator..... Date ..2/23/87..

Subscribed and sworn to before me this 23rd day of February,
19...87.
Notary Public Jolene H. Klaus
Date Commission Expires 2/5/90



K.C.C. OFFICE USE ONLY
F Letter of Confidentiality Attached
C Wireline Log Received
C Drillers Timelog Received
Distribution
 KCC SWD/Rep NGPA
 KGS Plug Other
(Specify)

Sec 30 Twp. 10 Rge. 20

SIDE TWO

Operator Name Black Diamond Oil, Inc. Lease Name Allphin Well # 1

Sec. 30 Twp. 10 Rge. 20 East West County Rooks

WELL LOG

INSTRUCTIONS: Show important tops and base of formations penetrated. Detail all cores. Report all drill stem tests giving interval tested, time tool open and closed, flowing and shut-in pressures, whether shut-in pressure reached static level, hydrostatic pressures, bottom hole temperature, fluid recovery, and flow rates if gas to surface during test. Attach extra sheet if more space is needed. Attach copy of log.

Drill Stem Tests Taken Yes No
 Samples Sent to Geological Survey Yes No
 Cores Taken Yes No

Formation Description
 Log Sample

DST #1 3460'-3485'
 45-45-45-45-
 Rec: 180' slight muddy water
 I.F.: 69-108#, F.F.: plugging
 I.C.I.: 1335# F.C.I.: 1403'

DST #2 3563'-3600'
 45-45-45-45
 Rec. 75' GIP, 45' OCM
 I.F. 33-35# F.F. 39-39#
 I.C.I. 255# F.C.I. 101#

Name	Top	Bottom
Anhydrite	1584'	1628'
Topeka	3148'	3353'
Toronto	3380'	3387'
L.-K.C.	3394'	3616'
Conglomerate	3660'	3696'
Arbuckle	3696'	T.D.
T.D.	3738'	
(T.D. in Arbuckle)		

CASING RECORD New Used
 Report all strings set-conductor, surface, intermediate, production, etc.

Purpose of String	Size Hole Drilled	Size Casing Set (in O.D.)	Weight Lbs/Ft.	Setting Depth	Type of Cement	#Sacks Used	Type and Percent Additives
Surface	12 1/4"	8-5/8"	20#	218'	60/40 Poz.	150	3% cc. 2% gel.

PERFORATION RECORD		Acid, Fracture, Shot, Cement Squeeze Record	
Shots Per Foot	Specify Footage of Each Interval Perforated	(Amount and Kind of Material Used)	Depth

TUBING RECORD	Size	Set At	Packer at	Liner Run	<input type="checkbox"/> Yes <input type="checkbox"/> No

Date of First Production _____ Producing Method Flowing Pumping Gas Lift Other (explain).....

Estimated Production Per 24 Hours	Oil	Gas	Water	Gas-Oil Ratio	Gravity
	Bbls	MCF	Bbls	CFPB	

METHOD OF COMPLETION Production Interval

Disposition of gas: Vented Open Hole Perforation
 Sold Other (Specify)
 Used on Lease Dually Completed
 Commingled