

STATE OF KANSAS
STATE CORPORATION COMMISSION

Form CP-4

Give All Information Completely
Make Required Affidavit
Mail or Deliver Report to:
Conservation Division
State Corporation Commission
212 No. Market
Wichita, Kansas

WELL PLUGGING RECORD

Rooks County, Sec. 30 Twp. 10s. Rge. 20 (R) (W)

Location as "NE/CNWxSWx" or footage from lines C W/2 SW NW

Lease Owner PETROLEUM, INC.,

Lease Name TEALL Well No. 2

Office Address R.R. #2, GREAT BEND, KANSAS

Character of Well (completed as Oil, Gas or Dry Hole) OIL

Date well completed NOVEMBER 7 19 64

Application for plugging filed JUNE 19 19 67

Application for plugging approved JUNE 20 19 67

Plugging commenced JULY 17 1967

Plugging completed JULY 26 1967

Reason for abandonment of well or producing formation DEPLETION OF PRODUCING ZONE

If a producing well is abandoned, date of last production APRIL 24 1967

Was permission obtained from the Conservation Division or its agents before plugging was commenced? YES

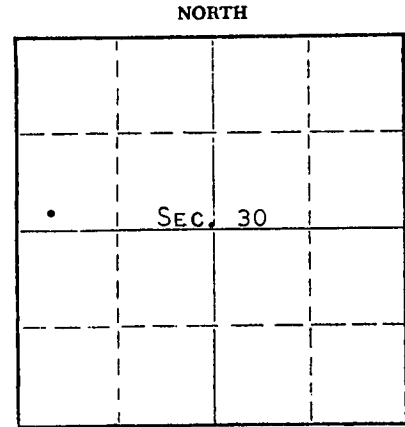

Locate well correctly on above Section Plat

Name of Conservation Agent who supervised plugging of this well LEO F. MASSEY

Producing formation ARBUCKLE Depth to top 3726 Bottom 3749 Total Depth of Well 3749 Feet

Show depth and thickness of all water, oil and gas formations.

OIL, GAS OR WATER RECORDS

CASING RECORD

FORMATION	CONTENT	FROM	TO	SIZE	PUT IN	PULLED OUT
ARBUCKLE	SLIGHT AMOUNT OF OIL & WATER	3728	3740	8-5/8"	216'	NONE
				5-1/2"	3749'	3073'

Describe in detail the manner in which the well was plugged, indicating where the mud fluid was placed and the method or methods used in introducing it into the hole. If cement or other plugs were used, state the character of same and depth placed, from _____ feet to _____ feet for each plug set.

PLUG WELL WITH 26 SACKS GEL AND 2 SACKS HULLS, FOLLOWED BY 135 SACKS CEMENT AND 4 SACKS GEL. FINISHED WITH 15 SACKS CEMENT TO TOP OF WELL.

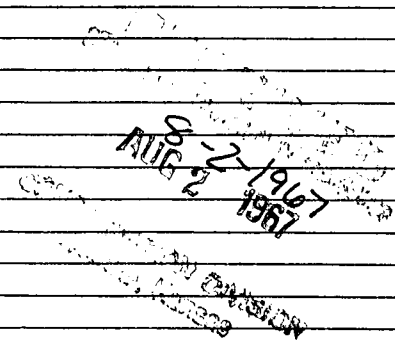

(If additional description is necessary, use BACK of this sheet)
Name of Plugging Contractor RALPH COMSTOCK PIPE PULLING, INC.,
Address 320 NORTH PARK, STAFFORD, KANSAS

STATE OF KANSAS, COUNTY OF BARTON, ss.
MONTE CHADD (employee of owner) or (owner or operator) of the above-described well, being first duly sworn on oath, says: That I have knowledge of the facts, statements, and matters herein contained and the log of the above-described well as filed and that the same are true and correct. So help me God. MONTE CHADD, DIST. PROD. SUPT.

(Signature) [Signature]
R.R. #2, GREAT BEND, KANSAS
(Address)

SUBSCRIBED AND SWORN TO before me this 1 day of AUGUST, 19 67

[Signature]
Notary Public.

My commission expires MAY 28, 1969

WELL LOG

COMPANY Petroleum, Inc.

SEC. 30 T. 10S R. 20W

FARM Teall

NO. 2

LOC. C W/2 SW NW

TOTAL DEPTH 3749'

COUNTY Rooks

COMM. 10-20-64

COMP. 10-29-64

CONTRACTOR Garvey Drilling Company

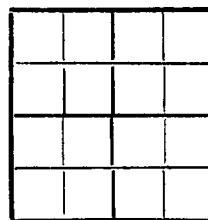

CASING 8 5/8" @ 216' w/175 sx

5 1/2" @ 3748' w/100 sx

ELEVATION 2147' DF

PRODUCTION Arbuckle

FIGURES INDICATE BOTTOM OF FORMATIONS

- 1100' Shale
- 1275' Sand
- 1568' Shale
- 1615' Anhydrite
- 2150' Shale and Shells
- 2250' Shale and Lime
- 2450' Lime and Shale
- 2555' Lime
- 2915' Lime and Shale
- 3080' Shale and Lime
- 3340' Lime and Shale
- 3698' Lime
- 3728' Conglomerate
- 3733' Arbuckle
- 3738' Lime
- 3749' Arbuckle
- 3749' RTD

RECEIVED
 OIL AND GAS COMMISSION
 8-2-1967
 AUG 2 1967
 OIL AND GAS COMMISSION
 Topeka, Kansas

State of Kansas }
 County of Barton } 83

I, Sam N. Stephens of Garvey Drilling Company
 upon oath state the above and foregoing is a true and correct copy of the log of the Teall #2 well.

Sam N. Stephens

Subscribed and sworn to before me this 5th day of November 19 64

My Commission Expires: April 14th, 1967

Arthur J. Wiles
 NOTARY PUBLIC