

STATE OF KANSAS
STATE CORPORATION COMMISSION

WELL PLUGGING RECORD

Give All Information Completely
Make Required Affidavit
Mail or Deliver Report to:
Conservation Division
State Corporation Commission
211 No. Broadway
Wichita, Kansas

GRAHAM County. Sec. 22 Twp. 10 Rge. 21 (X) (W)
Location as "NE/CNWxSWx" or footage from lines NE SW SE
Lease Owner PETROLEUM, INC.
Lease Name SVOBODA Well No. 1
Office Address ROUTE #2, GREAT BEND, KANSAS
Character of Well (completed as Oil, Gas or Dry Hole) DRY HOLE
Date well completed NOVEMBER 8 19 65
Application for plugging filed NOVEMBER 8 19 65
Application for plugging approved NOVEMBER 8 19 65
Plugging commenced NOVEMBER 8 19 65
Plugging completed NOVEMBER 8 19 65
Reason for abandonment of well or producing formation NO PRODUCIBLE ZONE

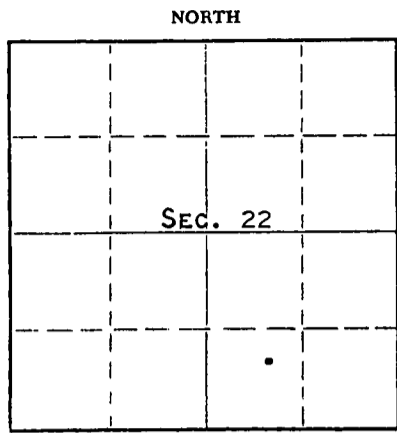

Locate well correctly on above Section Plat

If a producing well is abandoned, date of last production NONE 19
Was permission obtained from the Conservation Division or its agents before plugging was commenced? YES

Name of Conservation Agent who supervised plugging of this well GILBERT LEIKER
Producing formation _____ Depth to top _____ Bottom _____ Total Depth of Well 2900' Feet
Show depth and thickness of all water, oil and gas formations.

OIL, GAS OR WATER RECORDS				CASING RECORD		
FORMATION	CONTENT	FROM	TO	SIZE	PUT IN	PULLED OUT
				-	NONE	NONE

Describe in detail the manner in which the well was plugged, indicating where the mud fluid was placed and the method or methods used in introducing it into the hole. If cement or other plugs were used, state the character of same and depth placed, from _____ feet to _____ feet for each plug set.

HEAVY DRILLING MUD TO 1370' FOLLOWED BY WOODEN PLUG, PLACED 100 SACKS CEMENT ON TOP OF PLUG THROUGH DRILL PIPE. MUDDED UP WITH HEAVY DRILLING MUD TO 920', FOLLOWED BY WOODEN PLUG, PLACED 100 SACKS CEMENT ON TOP OF PLUG TO 420', FOLLOWED BY WOODEN PLUG, PLACED 300 SACKS CEMENT ON TOP OF PLUG TO BASE OF WELL CELLAR.

RECEIVED
STATE CORPORATION COMMISSION
NOV 15 1965
CONSERVATION DIVISION
WICHITA, KANSAS

(If additional description is necessary, use BACK of this sheet)
Name of Plugging Contractor GARVEY DRILLING COMPANY
Address R.R. #2, GREAT BEND, KANSAS

STATE OF KANSAS, COUNTY OF BARTON, ss.
MONTE CHADD (employee of owner) or (owner or operator) of the above-described well, being first duly sworn on oath, says: That I have knowledge of the facts, statements, and matters herein contained and the log of the above-described well as filed and that the same are true and correct. So help me God. MONTE CHADD DIST. PROD. SUPT.

(Signature) *Monte Chadd*
R.R. #2, GREAT BEND, KANSAS
(Address)

SUBSCRIBED AND SWORN to before me this 12 day of NOVEMBER, 19 65

My commission expires MAY 28, 1969
Richard W. Dumbler
Notary Public.

WELL LOG 15-065-30127-0000

COMPANY Petroleum, Inc.

SEC. 22 T. 10S R. 21W

FARM Svoboda NO. 1

LOC. NE SW SE

TOTAL DEPTH 2900'

COUNTY Graham

COMM. 11-4-65 COMP. 11-8-65

CONTRACTOR Garvey Drilling Company

CASING None

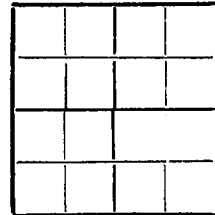

ELEVATION 2151' KB

PRODUCTION D & A

FIGURES INDICATE BOTTOM OF FORMATIONS

- 40' Post Rock
- 250' Surface Clay and Sand
- 865' Shale
- 995' Shale and Sand
- 1200' Sand
- 1365' Shale
- 1512' Red Bed and Shale
- 1560' Anhydrite
- 2050' Shale and Shells
- 2215' Shale and Lime
- 2500' Lime and Shale
- 2670' Shale and Lime
- 2900' Lime and Shale
- 2900' RTD

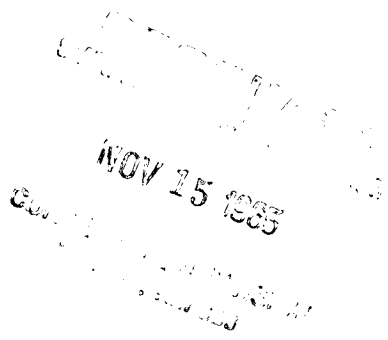

State of Kansas }
County of Barton } ss

I, Sam N. Stephens of Garvey Drilling Company

upon oath state the above and foregoing is a true and correct copy of the log of the Svoboda #1 well.

Sam N. Stephens

Subscribed and sworn to before me this 11th day of November 19 65

My Commission Expires: May 28, 1969

Richard N. Dangler
NOTARY PUBLIC