

OWWO

For KCC Use: Effective Date: 2-1-2010 District # 1 SGA? Yes No

KANSAS CORPORATION COMMISSION OIL & GAS CONSERVATION DIVISION

Form C-1 October 2007 Form must be Typed Form must be Signed All blanks must be Filled

NOTICE OF INTENT TO DRILL

Must be approved by KCC five (5) days prior to commencing well

Expected Spud Date: January 30 2010 month day year

OPERATOR: License# 34247 Name: John Tanner Address 1: 1637 N McComas Address 2: City: Wichita State: KS Zip: 67203 Contact Person: John Tanner Phone: 316-841-3394 CONTRACTOR: License# 32910 32910 Name: Professional Pulling Services LLC

Spot Description: N/2 SE NE Sec. 14 Twp. 17 S. R. 21 E W (a/a/a) 1,830 feet from N / S Line of Section 660 feet from E / W Line of Section

Is SECTION: Regular Irregular? (Note: Locate well on the Section Plat on reverse side) County: Ness

Lease Name: Elmore 'D' Well #: 2 Field Name: Upstart

Is this a Prorated / Spaced Field? Yes No Target Formation(s): Mississippian/Cherokee Group Nearest Lease or unit boundary line (in footage): 660'

Ground Surface Elevation: 2175 feet MSL Water well within one-quarter mile: Yes No Public water supply well within one mile: Yes No

Depth to bottom of fresh water: 180' Depth to bottom of usable water: 780' Surface Pipe by Alternate: I II Length of Surface Pipe Planned to be set: 284'

Length of Conductor Pipe (if any): n/a Projected Total Depth: 4148' Formation at Total Depth: Mississippian stage

Water Source for Drilling Operations: Well Farm Pond Other: DWR Permit #: n/a

(Note: Apply for Permit with DWR) Will Cores be taken? Yes No If Yes, proposed zone:

Well Drilled For: Oil Gas Enh Rec Storage Disposal Seismic; # of Holes Other: OWWO Well Class: Infield Pool Ext. Wildcat Other Type Equipment: Mud Rotary Air Rotary Cable

If OWWO: old well information as follows: Operator: Pickrell Drilling Company Well Name: Elmore 'D' 2 Original Completion Date: Feb 14, 1967 Original Total Depth: 4148'

Directional, Deviated or Horizontal wellbore? Yes No If Yes, true vertical depth: Bottom Hole Location: T17S R27W, Sec. 14 SE NE KCC DKT #: n/a

AFFIDAVIT

The undersigned hereby affirms that the drilling, completion and eventual plugging of this well will comply with K.S.A. 55 et. seq. It is agreed that the following minimum requirements will be met:

- 1. Notify the appropriate district office prior to spudding of well;
2. A copy of the approved notice of intent to drill shall be posted on each drilling rig;
3. The minimum amount of surface pipe as specified below shall be set by circulating cement to the top; in all cases surface pipe shall be set through all unconsolidated materials plus a minimum of 20 feet into the underlying formation.
4. If the well is dry hole, an agreement between the operator and the district office on plug length and placement is necessary prior to plugging;
5. The appropriate district office will be notified before well is either plugged or production casing is cemented in;
6. If an ALTERNATE II COMPLETION, production pipe shall be cemented from below any usable water to surface within 120 DAYS of spud date. Or pursuant to Appendix "B" - Eastern Kansas surface casing order #133,891-C, which applies to the KCC District 3 area, alternate II cementing must be completed within 30 days of the spud date or the well shall be plugged. In all cases, NOTIFY district office prior to any cementing.

I hereby certify that the statements made herein are true and correct to the best of my knowledge and belief.

Date: 01/27/10 Signature of Operator or Agent: [Signature] Title:

For KCC Use ONLY API # 15 - 135-20001-00-01 Conductor pipe required None feet Minimum surface pipe required 284 feet per ALT. I II Approved by: [Signature] 1-27-2010 This authorization expires: 1-27-2011 (This authorization void if drilling not started within 12 months of approval date.) Spud date: Agent:

Remember to:

- File Drill Pit Application (form CDP-1) with Intent to Drill;
- File Completion Form ACO-1 within 120 days of spud date;
- File acreage attribution plat according to field proration orders;
- Notify appropriate district office 48 hours prior to workover or re-entry;
- Submit plugging report (CP-4) after plugging is completed (within 60 days);
- Obtain written approval before disposing or injecting salt water.
- If this permit has expired (See: authorized expiration date) please check the box below and return to the address below.

Well Not Drilled - Permit Expired Date: Signature of Operator or Agent:

RECEIVED JAN 27 2010 KCC WICHITA

14 17 21 E W

IN ALL CASES PLOT THE INTENDED WELL ON THE PLAT BELOW

Plat of acreage attributable to a well in a prorated or spaced field

If the intended well is in a prorated or spaced field, please fully complete this side of the form. If the intended well is in a prorated or spaced field complete the plat below showing that the well will be properly located in relationship to other wells producing from the common source of supply. Please show all the wells and within 1 mile of the boundaries of the proposed acreage attribution unit for gas wells and within 1/2 mile of the boundaries of the proposed acreage attribution unit for oil wells.

API No. 15 - 135-20001 - 0001

Operator: John Tanner

Lease: Elmore 'D'

Well Number: 2

Field: Upstart

Number of Acres attributable to well: 40

QTR/QTR/QTR/QTR of acreage: SE/NE - C - S/2 - NE

Location of Well: County: Ness

1,830 feet from N / S Line of Section

660 feet from E / W Line of Section

Sec. 14 Twp. 17 S. R. 21 E W

Is Section: Regular or Irregular

If Section is Irregular, locate well from nearest corner boundary.

Section corner used: NE NW SE SW

PLAT

(Show location of the well and shade attributable acreage for prorated or spaced wells.)

(Show footage to the nearest lease or unit boundary line.)

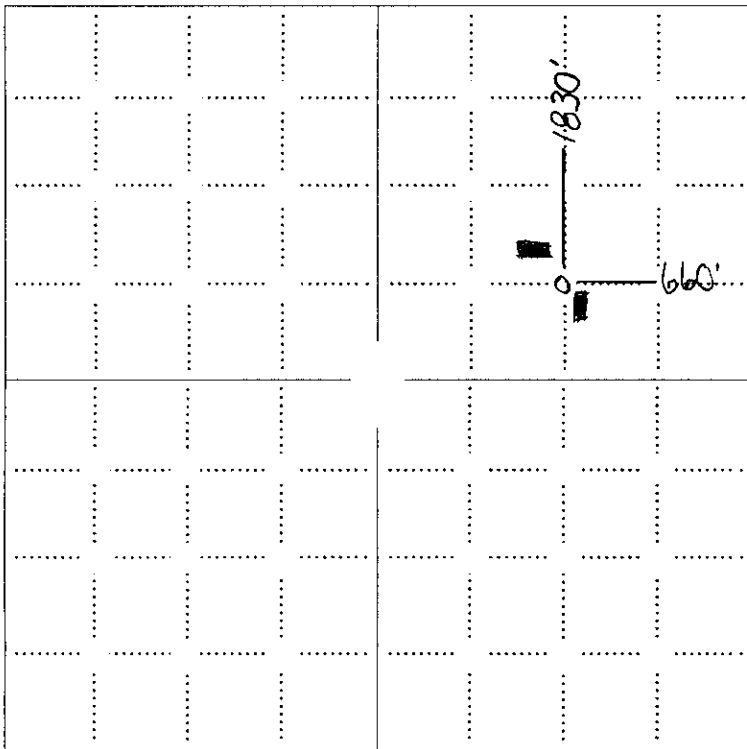

RECEIVED
JAN 27 2010
KCC WICHITA

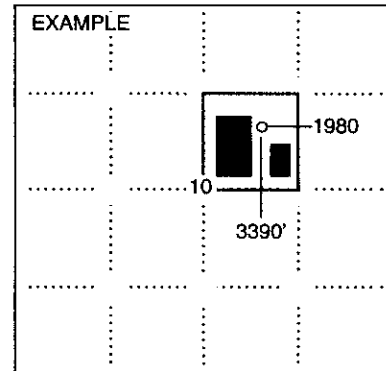

SEWARD CO.

NOTE: In all cases locate the spot of the proposed drilling location.

In plotting the proposed location of the well, you must show:

1. The manner in which you are using the depicted plat by identifying section lines, i.e. 1 section, 1 section with 8 surrounding sections, 4 sections, etc.
2. The distance of the proposed drilling location from the south / north and east / west outside section lines.
3. The distance to the nearest lease or unit boundary line (in footage).
4. If proposed location is located within a prorated or spaced field a certificate of acreage attribution plat must be attached: (CO-7 for oil wells; CG-8 for gas wells).

**KANSAS CORPORATION COMMISSION
OIL & GAS CONSERVATION DIVISION
APPLICATION FOR SURFACE PIT**

Form GDP-1
April 2004
Form must be Typed

Submit in Duplicate

Operator Name: John Tanner		License Number: 34247	
Operator Address: 1637 N McComas		Wichita KS 67203	
Contact Person: John Tanner		Phone Number: 316-841-3394	
Lease Name & Well No.: Elmore 'D' 2		Pit Location (QQQQ): Na - SE - NE	
Type of Pit: <input type="checkbox"/> Emergency Pit <input type="checkbox"/> Burn Pit <input type="checkbox"/> Settling Pit <input type="checkbox"/> Drilling Pit <input checked="" type="checkbox"/> Workover Pit <input type="checkbox"/> Haul-Off Pit <small>(If WP Supply API No. or Year Drilled)</small>		Pit is: <input checked="" type="checkbox"/> Proposed <input type="checkbox"/> Existing If Existing, date constructed: _____ Pit capacity: 200 (bbls)	
Is the pit located in a Sensitive Ground Water Area? <input type="checkbox"/> Yes <input checked="" type="checkbox"/> No		Chloride concentration: _____ mg/l <small>(For Emergency Pits and Settling Pits only)</small>	
Is the bottom below ground level? <input checked="" type="checkbox"/> Yes <input type="checkbox"/> No		Artificial Liner? <input type="checkbox"/> Yes <input checked="" type="checkbox"/> No	
Pit dimensions (all but working pits): 35 Length (feet) 14 Width (feet) <input type="checkbox"/> N/A: Steel Pits Depth from ground level to deepest point: 8 (feet) <input type="checkbox"/> No Pit		How is the pit lined if a plastic liner is not used? NATIVE CLAY	
If the pit is lined give a brief description of the liner material, thickness and installation procedure. n/a		Describe procedures for periodic maintenance and determining liner integrity, including any special monitoring. n/a	
Distance to nearest water well within one-mile of pit n/a 4159 feet Depth of water well 40 feet		Depth to shallowest fresh water 86 21 feet. Source of information: <input checked="" type="checkbox"/> measured <input type="checkbox"/> well owner <input type="checkbox"/> electric log <input checked="" type="checkbox"/> KDWR	
Emergency, Settling and Burn Pits ONLY: Producing Formation: _____ Number of producing wells on lease: _____ Barrels of fluid produced daily: _____ Does the slope from the tank battery allow all spilled fluids to flow into the pit? <input type="checkbox"/> Yes <input checked="" type="checkbox"/> No		Drilling, Workover and Haul-Off Pits ONLY: Type of material utilized in drilling/workover: water Number of working pits to be utilized: 2 Abandonment procedure: haul / evaporate water, fill pit Drill pits must be closed within 365 days of spud date.	
I hereby certify that the above statements are true and correct to the best of my knowledge and belief. 01/27/2010 Date		RECEIVED JAN 27 2010 Signature of Applicant or Agent KCC WICHITA	
KCC OFFICE USE ONLY			
Date Received: 1-27-10		Permit Number: _____ Permit Date: 1-27-10	
Lease Inspection: <input type="checkbox"/> Yes <input checked="" type="checkbox"/> No			

15-135-200001-00-01

STATE OF KANSAS
STATE CORPORATION COMMISSION
203 Colorado Derby Building
Wichita, Kansas 67202

WELL PLUGGING RECORD
K.A.R.-82-3-117

15-135-20,001-0000

API NUMBER Drilled 1966

LEASE NAME Elmore "D"

WELL NUMBER 2

1830 Ft. from N Section Line

660 Ft. from E Section Line

SEC. 14 TWP. 17 RGE. 21 (W) or (W)

COUNTY Ness

Date Well Completed 12/30/66

Plugging Commenced 10/20/98

Plugging Completed 10/20/98

TYPE OR PRINT
NOTICE: Fill out completely
and return to Cons. Div.
office within 30 days.

LEASE OPERATOR Hess Oil Company

ADDRESS P. O. Box 1009, McPherson, KS 67460

PHONE# (316) 241-4640 OPERATORS LICENSE NO. 5663

Character of Well oil

(Oil, Gas, D&A, SWD, Input, Water Supply Well)

The plugging proposal was approved on 10/7/98 (date)

by Mike Myer (KCC District Agent's Name).

Is ACO-1 filed? _____ If not, Is well log attached? card

Producing Formation Cherokee Sd Depth to Top 4094 Ft Bottom T.D. 4148 Ft.

Show depth and thickness of all water, oil and gas formations.

OIL, GAS OR WATER RECORDS

CASING RECORD

Formation	Content	From	To	Size	Put in	Pulled out
Surface		284'	0'	8-5/8"	284'	None
Production		4146'	0'	5-1/2"	4146'	None

Describe in detail the manner in which the well was plugged, indicating where the mud fluid was placed and the method or methods used in introducing it into the hole. If cement or other plugs were used, state the character of same and depth placed, from feet to feet each set.

Plugged with 210 sacks 60/40 Pozmix, 6% gel and 300# hulls as follows:
Pumped hulls down 5-1/2" casing, then 35 sacks cement. Displaced to
4094' @ 1500 psi. Perforated @ 850' and pumped in 155 sacks. Pressured
to 1000 psi. Pumped 20 sacks cement between 8-5/8" and 5-1/2" casing.
(If additional description is necessary, use BACK of this form.)

Name of Plugging Contractor Hess Oil Company License No. 5663

Address P. O. Box 1009, McPherson, KS 67460

NAME OF PARTY RESPONSIBLE FOR PLUGGING FEES: Hess Oil Company

STATE OF KANSAS COUNTY OF MCPHERSON, ss.

Dick Hess

(Employee of Operator) or (Operator) of above-described well, being first duly sworn on oath, says: That I have knowledge of the facts, statements, and matters herein contained and the log of the above-described well as filed that the same are true and correct, so help me God.

(Signature) Dick Hess

(Address) same

SUBSCRIBED AND SWORN TO before me this 2nd day of November, 19 98

My Commission Expires: _____

