

For KCC Use:
Effective Date: 2-7-2010
District # 4
SGA? Yes No

KANSAS CORPORATION COMMISSION
OIL & GAS CONSERVATION DIVISION

Form C-1
October 2007
FEB 01 2010
Form must be Typed
Form must be Signed
All blanks must be Filled

NOTICE OF INTENT TO DRILL
Must be approved by KCC five (5) days prior to commencing well

CONSERVATION DIVISION
WICHITA, KS

Expected Spud Date: 02/17/2010
month day year

OPERATOR: License# 6768
Name: Carrie Exploration and Development
Address 1: 210 West 22nd Street
Address 2:
City: Hays State: Ks Zip: 67601
Contact Person: Ron Herold
Phone: 785-625-9318
CONTRACTOR: License# 33350
Name: Southwind Drilling Inc

Spot Description: 330 from south line, 990 from west line
SE SW SW Sec. 34 Twp. 19 S. R. 11 E W
(0000) 330 feet from N / S Line of Section
990 feet from E / W Line of Section
Is SECTION: Regular Irregular?

(Note: Locate well on the Section Plat on reverse side)
County: Barton
Lease Name: Thomas Farms Well #: #1
Field Name: Chase Silica

Is this a Prorated / Spaced Field? Yes No
Target Formation(s): Arbuckle
Nearest Lease or unit boundary line (in footage): 330
Ground Surface Elevation: 1775 feet MSL
Water well within one-quarter mile: Yes No
Public water supply well within one mile: Yes No
Depth to bottom of fresh water: 60 feet
Depth to bottom of usable water: 60 feet 1P

Well Drilled For: Oil Gas Seismic; # of Holes Other
 Enh Rec Storage Disposal
Well Class: Infield Pool Ext. Wildcat Other
Type Equipment: Mud Rotary Air Rotary Cable

Surface Pipe by Alternate:
Length of Surface Pipe Planned to be set: 189 feet of 13 3/8 set at 189
Length of Conductor Pipe (if any):
Projected Total Depth: 3850
Formation at Total Depth: Arbuckle

If OWWO: old well information as follows:
Operator: Stanolind Oil and Gas Company
Well Name: Henry Kipp #1
Original Completion Date: 4/16/1938 Original Total Depth: 3371

Water Sources for Drilling Operations:
 Well Farm Pond Other:
DWR Permit #: Existing well
(Note: Apply for Permit with DWR)
Will Cores be taken? Yes No
If Yes, proposed zone:

Directional, Deviated or Horizontal wellbore? Yes No
If Yes, true vertical depth:
Bottom Hole Location:
KCC DKT #:

AFFIDAVIT

The undersigned hereby affirms that the drilling, completion and eventual plugging of this well will comply with K.S.A. 55 et. seq.
It is agreed that the following minimum requirements will be met:

1. Notify the appropriate district office **prior** to spudding of well;
2. A copy of the approved notice of intent to drill **shall be** posted on each drilling rig;
3. The minimum amount of surface pipe as specified below **shall be set** by circulating cement to the top; in all cases surface pipe **shall be set** through all unconsolidated materials plus a minimum of 20 feet into the underlying formation.
4. If the well is dry hole, an agreement between the operator and the district office on plug length and placement is necessary **prior to plugging**;
5. The appropriate district office will be notified before well is either plugged or production casing is cemented in;
6. If an ALTERNATE II COMPLETION, production pipe shall be cemented from below any usable water to surface within **120 DAYS** of spud date. Or pursuant to Appendix "B" - Eastern Kansas surface casing order #133,891-C, which applies to the KCC District 3 area, alternate II cementing must be completed within 30 days of the spud date or the well shall be plugged. **In all cases, NOTIFY district office** prior to any cementing.

I hereby certify that the statements made herein are true and correct to the best of my knowledge and belief.

Date: 1-29-2010 Signature of Operator or Agent: Ron Herold Title: Owner

For KCC Use ONLY
API # 15 - 009-14955-00-01
Conductor pipe required None feet
Minimum surface pipe required 191 feet per ALT. I II
Approved by: RWH 2-2-2010
This authorization expires: 2-2-2011
(This authorization void if drilling not started within 12 months of approval date.)
Spud date: Agent:

- Remember to:
- File Drill Pit Application (form CDP-1) with Intent to Drill;
 - File Completion Form ACO-1 within 120 days of spud date;
 - File acreage attribution plat according to field proration orders;
 - Notify appropriate district office 48 hours prior to workover or re-entry;
 - Submit plugging report (CP-4) after plugging is completed (within 60 days);
 - Obtain written approval before disposing or injecting salt water.
 - If this permit has expired (See: authorized expiration date) please check the box below and return to the address below.
- Well Not Drilled - Permit Expired Date: Signature of Operator or Agent:

34
19
11
 E
 W

IN ALL CASES PLOT THE INTENDED WELL ON THE PLAT BELOW

Plat of acreage attributable to a well in a prorated or spaced field

If the intended well is in a prorated or spaced field, please fully complete this side of the form. If the intended well is in a prorated or spaced field complete the plat below showing that the well will be properly located in relationship to other wells producing from the common source of supply. Please show all the wells and within 1 mile of the boundaries of the proposed acreage attribution unit for gas wells and within 1/2 mile of the boundaries of the proposed acreage attribution unit for oil wells.

API No. 15 - ~~No API #~~ 15-009-14955-00-01
 Operator: Carrie Exploration and Development
 Lease: Thomas Farms
 Well Number: #1
 Field: Chase Silica

Location of Well: County: Barton
 330 _____ feet from N / S Line of Section
 990 _____ feet from E / W Line of Section
 Sec. 34 Twp. 19 S. R. 11 E W

Number of Acres attributable to well: _____
 QTR/QTR/QTR/QTR of acreage: _____ - SE - SW - SW

Is Section: Regular or Irregular

If Section is Irregular, locate well from nearest corner boundary.

Section corner used: NE NW SE SW

PLAT

(Show location of the well and shade attributable acreage for prorated or spaced wells.)

(Show footage to the nearest lease or unit boundary line.)

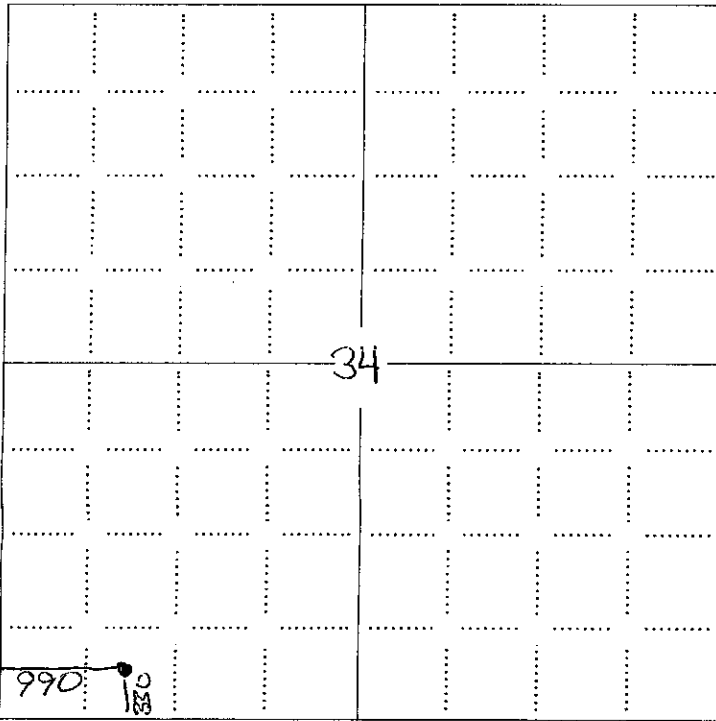

NOTE: In all cases locate the spot of the proposed drilling location.

RECEIVED
 KANSAS CORPORATION COMMISSION
 FEB 01 2010
 CONSERVATION DIVISION
 WICHITA, KS

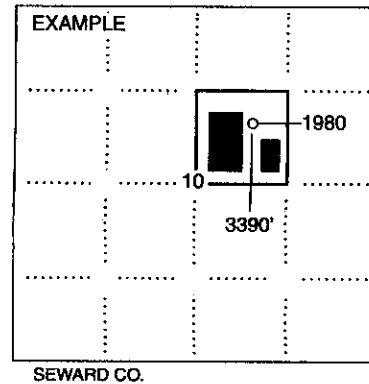

In plotting the proposed location of the well, you must show:

1. The manner in which you are using the depicted plat by identifying section lines, i.e. 1 section, 1 section with 8 surrounding sections, 4 sections, etc.
2. The distance of the proposed drilling location from the south / north and east / west outside section lines.
3. The distance to the nearest lease or unit boundary line (in footage).
4. If proposed location is located within a prorated or spaced field a certificate of acreage attribution plat must be attached: (CO-7 for oil wells; CG-8 for gas wells).

APPLICATION FOR SURFACE PIT FEB 01 2010

Submit in Duplicate

Operator Name: Carrie Exploration and Development		License Number: 6768
Operator Address: 210 West 22nd Street		Hays Ks 67601
Contact Person: Ron Herold		Phone Number: 785-625-9318
Lease Name & Well No.: Thomas Farms #1		Pit Location (QQQQ): <u>SE - SW - SW</u> Sec. <u>34</u> Twp. <u>19</u> R. <u>11</u> <input type="checkbox"/> East <input checked="" type="checkbox"/> West <u>330</u> Feet from <input type="checkbox"/> North / <input checked="" type="checkbox"/> South Line of Section <u>990</u> Feet from <input type="checkbox"/> East / <input checked="" type="checkbox"/> West Line of Section Barton County
Type of Pit: <input type="checkbox"/> Emergency Pit <input type="checkbox"/> Burn Pit <input type="checkbox"/> Settling Pit <input checked="" type="checkbox"/> Drilling Pit <input type="checkbox"/> Workover Pit <input type="checkbox"/> Haul-Off Pit (If WP Supply API No. or Year Drilled)	Pit is: <input checked="" type="checkbox"/> Proposed <input type="checkbox"/> Existing If Existing, date constructed: _____ Pit capacity: 4,500 (bbls)	
Is the pit located in a Sensitive Ground Water Area? <input checked="" type="checkbox"/> Yes <input type="checkbox"/> No		Chloride concentration: _____ mg/l (For Emergency Pits and Settling Pits only)
Is the bottom below ground level? <input checked="" type="checkbox"/> Yes <input type="checkbox"/> No	Artificial Liner? <input type="checkbox"/> Yes <input checked="" type="checkbox"/> No	How is the pit lined if a plastic liner is not used? Clay in the bottom of pit
Pit dimensions (all but working pits): <u>80</u> Length (feet) <u>80</u> Width (feet) <input type="checkbox"/> N/A: Steel Pits Depth from ground level to deepest point: <u>4</u> (feet) <input type="checkbox"/> No Pit		
If the pit is lined give a brief description of the liner material, thickness and installation procedure. Clay in the bottom of the pit		Describe procedures for periodic maintenance and determining liner integrity, including any special monitoring.
Distance to nearest water well within one-mile of pit <u>398</u> feet Depth of water well <u>60</u> feet	Depth to shallowest fresh water <u>60</u> feet. Source of information: <input type="checkbox"/> measured <input checked="" type="checkbox"/> well owner <input type="checkbox"/> electric log <input type="checkbox"/> KDWR	
Emergency, Settling and Burn Pits ONLY: Producing Formation: _____ Number of producing wells on lease: _____ Barrels of fluid produced daily: _____ Does the slope from the tank battery allow all spilled fluids to flow into the pit? <input type="checkbox"/> Yes <input type="checkbox"/> No	Drilling, Workover and Haul-Off Pits ONLY: Type of material utilized in drilling/workover: <u>fresh water bentonite mud</u> Number of working pits to be utilized: <u>1</u> Abandonment procedure: <u>haul off free water and let dry and then cover pit</u> Drill pits must be closed within 365 days of spud date.	
I hereby certify that the above statements are true and correct to the best of my knowledge and belief. _____ Date: <u>01/29/2010</u> Signature of Applicant or Agent: <u>Ron Herold</u>		

15-009-14955-00-01

KCC OFFICE USE ONLY		Steel Pit <input type="checkbox"/>	RFAC <input checked="" type="checkbox"/>	RFAS <input type="checkbox"/>
Date Received: <u>2-1-10</u>	Permit Number: _____	Permit Date: <u>2-2-10</u>	Lease Inspection: <input checked="" type="checkbox"/> Yes <input type="checkbox"/> No	



Mark Parkinson, Governor
Thomas E. Wright, Chairman
Michael C. Moffet, Commissioner
Joseph F. Harkins, Commissioner

February 2, 2010

Carrie Exploration and Development
210 West 22nd St
Hays, KS 67601

RE: Drilling Pit Application
Thomas Farms Lease Well No. 1
SW/4 Sec. 34-19S-11W
Barton County, Kansas

Dear Sir or Madam:

District staff has inspected the above referenced location and has determined that the reserve pit shall be constructed **without slots**, the bottom shall be flat and reasonably level, and the free fluids must be removed. The fluids are to be removed from the reserve pit as soon as practical after drilling operations have ceased. **Keep pits away from draw/creek.**

If production casing is set all completion fluids shall be removed from the working pits daily. NO completion fluids or non-exempt wastes shall be placed in the reserve pit.

The fluids should be taken to an authorized disposal well. Please call the District Office at (785) 625-0550 when the fluids have been removed. Please file form CDP-5 (August 2004), Exploration and Production Waste Transfer, within 30 days of fluid removal. Conservation division forms are available through our office and on the KCC web site:
www.kcc.state.ks.us/conservation/forms.

A copy of this letter should be posted in the doghouse along with the approved Intent to Drill. If you have any questions or concerns please feel free to contact the undersigned at the above address.

Sincerely,

A handwritten signature in black ink, appearing to read "Kathy Haynes".

Kathy Haynes
Environmental Protection and Remediation Department

cc: district

WELL PLUGGING RECORD

OR
FORMATION PLUGGING RECORD

Information Completely
Required Affidavit
and Deliver Report to:
Conservation Division
State Corporation Commission
800 Bittling Building
Wichita, Kansas

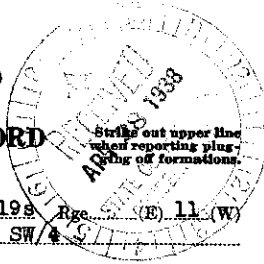

15-009-149550-00

Barton County. Sec. 34 Twp. 19S Rge. 11E (W)

Location as "NE $\frac{1}{4}$ NW $\frac{1}{4}$ SW $\frac{1}{4}$ " or footage from lines SE $\frac{1}{4}$ SW $\frac{1}{4}$ SW $\frac{1}{4}$
 Lease Owner Stanolind Oil and Gas Company
 Lease Name Henry Knipp Well No. 1
 Office Address Box 591 - Tulsa, Oklahoma
 Character of Well (Completed as Oil, Gas or Dry Hole) Dry hole
 Date, well completed April 16, 1938
 Application for plugging filed (verbal) April 16, 1938
 Application for plugging approved (verbal) April 16, 1938
 Plugging Commenced April 16, 1938
 Plugging Completed April 16, 1938
 Reason for abandonment of well or producing formation Non-Producer
 If a producing well is abandoned, date of last production 193
 Was permission obtained from the Conservation Division or its agents before plugging was commenced?
Yes

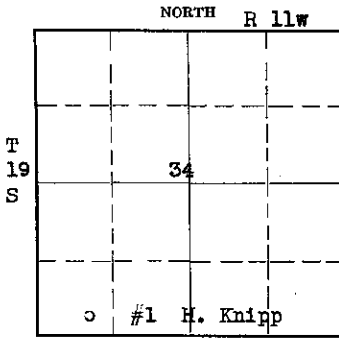

T
19
S

Locate well correctly on above Section Plat

Name of Conservation Agent who supervised plugging of this well Ed Schiel
 Producing formation Siliceous Depth to top 3342 Bottom 3371 Total Depth of Well 3371 Feet.

Show depth and thickness of all water, oil and gas formations.

OIL, GAS OR WATER RECORDS

CASING RECORD

Formation	Content	From	To	Size	Put In	Pulled Out
Siliceous lime	Dry	3342	3371	13" OD	189 (Threads off)	none

Describe in detail the manner in which the well was plugged, indicating where the mud fluid was placed and the method or methods used in introducing it into the hole. If cement or other plugs were used, state the character of same and depth placed, from _____ feet to _____ feet for each plug set.

Drove wooden plug to bottom of surface pipe - 20 sacks of cement to plug from 189 to 169'. Surface pipe then filled with mud from 169' to 15'. A plug of 15 sacks of cement was then run from 15 to 0'.

Cement plug - 189 to 169'
Cement plug - 15' to 0'

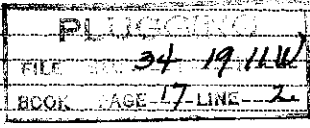

(If additional description is necessary, use BACK of this sheet)

Correspondence regarding this well should be addressed to Stanolind Oil and Gas Company
 Address Box 591 - Tulsa, Oklahoma

STATE OF Kansas, COUNTY OF Barton, ss.

H. G. Nething (employee of owner) or (owner or operator) of the above-described well, being first duly sworn on oath, says: That I have knowledge of the facts, statements, and matters herein contained and the log of the above-described well as filed and that the same are true and correct. So help me God.

(Signature) H. G. Nething
Ellinwood, Kansas
 (Address)

SUBSCRIBED AND SWORN TO before me this 23rd day of April, 1938

My commission expires May 3, 1941
Jean H. Wilcox
 Notary Public.

