

For KCC Use: 2-20-2010
Effective Date: _____
District # _____
SGA? Yes No

**KANSAS CORPORATION COMMISSION
OIL & GAS CONSERVATION DIVISION**

Form C-1
October 2007

CORRECTED
Must be Typed
Must be Signed
All blanks must be Filled

NOTICE OF INTENT TO DRILL

Must be approved by KCC five (5) days prior to commencing well

Expected Spud Date: February 28th 2010
month day year

OPERATOR: License# 5614
Name: Hutchinson Oil Co. dba
Address 1: P.O. Box 521
Address 2: _____
City: Derby State: KS Zip: 67037 + 0521
Contact Person: Steve Hutchinson
Phone: 316-788-5440

CONTRACTOR: License# 34233
Name: Maverick Drilling, LLC

Well Drilled For: Oil Enh Rec Infield Mud Rotary
 Gas Storage Pool Ext. Air Rotary
 Seismic; # of Holes Disposal Wildcat Cable
 Other: _____
 If OWWO: old well information as follows: _____

Operator: _____
Well Name: _____
Original Completion Date: _____ Original Total Depth: _____

Directional, Deviated or Horizontal wellbore? Yes No
If Yes, true vertical depth: _____

Bottom Hole Location: _____

KCC DKT #: _____

* WAS: 965' FNL; 50' FWL NLUB: 50'
IS: 1015' FNL; 90' FWL NLUB: 90'
Oil & Gas Leases w/ pooling clauses submitted.

AFFIDAVIT

The undersigned hereby affirms that the drilling, completion and eventual plugging of this well will comply with K.S.A. 55 et. seq.

It is agreed that the following minimum requirements will be met:

1. Notify the appropriate district office **prior** to spudding of well;
2. A copy of the approved notice of intent to drill **shall be** posted on each drilling rig;
3. The minimum amount of surface pipe as specified below **shall be set** by circulating cement to the top; in all cases surface pipe **shall be set** through all unconsolidated materials plus a minimum of 20 feet into the underlying formation.
4. If the well is dry hole, an agreement between the operator and the district office on plug length and placement is necessary **prior to plugging**;
5. The appropriate district office will be notified before well is either plugged or production casing is cemented in;
6. If an ALTERNATE II COMPLETION, production pipe shall be cemented from below any usable water to surface within **120 DAYS** of spud date.
Or pursuant to Appendix "B" - Eastern Kansas surface casing order #133,891-C, which applies to the KCC District 3 area, alternate II cementing must be completed within 30 days of the spud date or the well shall be plugged. **In all cases, NOTIFY district office** prior to any cementing.

I hereby certify that the statements made herein are true and correct to the best of my knowledge and belief.

Date: 2/12/10 Signature of Operator or Agent: [Signature] Title: Owner/Operator

For KCC Use ONLY
API # 15 - 185-23610-00-00
Conductor pipe required None feet
Minimum surface pipe required 200 feet per ALT. I II
Approved by: [Signature] 2-15-2010 / [Signature] 2-18-2010
This authorization expires: 2-15-2011
(This authorization void if drilling not started within 12 months of approval date.)
Spud date: _____ Agent: _____

Remember to:

- File Drill Pit Application (form CDP-1) with Intent to Drill;
- File Completion Form ACO-1 within 120 days of spud date;
- File acreage attribution plat according to field proration orders;
- Notify appropriate district office 48 hours prior to workover or re-entry;
- Submit plugging report (CP-4) after plugging is completed (within 60 days);
- Obtain written approval before disposing or injecting salt water.
- If this permit has expired (See: authorized expiration date) please check the box below and return to the address below.

Well Not Drilled - Permit Expired Date: _____
Signature of Operator or Agent: _____

Spot Description: _____
SW - NW - NW Sec. 21 Twp. 22 S. R. 11 E W
1015 - 965 feet from N / S Line of Section
90 - 50 feet from E / W Line of Section
Is SECTION: Regular Irregular?

(Note: Locate well on the Section Plat on reverse side)
County: Stafford

Lease Name: Sleeper Well #: 21-1
Field Name: Sleeper Northwest Shepherd South

Is this a Prorated / Spaced Field? Yes No
Target Formation(s): LKC/SIMPSON/ARBUCKLE

* Nearest Lease or unit boundary line (in footage): 50 - 90'
Ground Surface Elevation: 1820 est. feet MSL

Water well within one-quarter mile: Yes No
Public water supply well within one mile: Yes No

Depth to bottom of fresh water: 160'
Depth to bottom of usable water: 180'

Surface Pipe by Alternate: I II
Length of Surface Pipe Planned to be set: 300'

Length of Conductor Pipe (if any): N/A
Projected Total Depth: 3700'

Formation at Total Depth: Arbuckle

Water Source for Drilling Operations:
 Well Farm Pond Other: to be drilled
(applied for)

DWR Permit #: _____ (Note: Apply for Permit with DWR)
Will Cores be taken? Yes No
If Yes, proposed zone: _____

**RECEIVED
FEB 12 2010
KCC WICHITA**

21-22-11
 E W

CORRECTED

IN ALL CASES PLOT THE INTENDED WELL ON THE PLAT BELOW

Plat of acreage attributable to a well in a prorated or spaced field

If the intended well is in a prorated or spaced field, please fully complete this side of the form. If the intended well is in a prorated or spaced field complete the plat below showing that the well will be properly located in relationship to other wells producing from the common source of supply. Please show all the wells and within 1 mile of the boundaries of the proposed acreage attribution unit for gas wells and within 1/2 mile of the boundaries of the proposed acreage attribution unit for oil wells.

API No. 15 - _____
Operator: Hutchinson Oil Co.
Lease: Sleeper
Well Number: #21-1
Field: Sleeper Northwest

Location of Well: County: Stafford
965 feet from N / S Line of Section
50 feet from E / W Line of Section
Sec. 21 Twp. 22 S. R. 11 E W

Number of Acres attributable to well: _____
QTR/QTR/QTR/QTR of acreage: _____ SW . NW . NW

Is Section: Regular or Irregular

If Section is Irregular, locate well from nearest corner boundary.

Section corner used: NE NW SE SW

PLAT

(Show location of the well and shade attributable acreage for prorated or spaced wells.)

(Show footage to the nearest lease or unit boundary line.)

Rge. 11 West

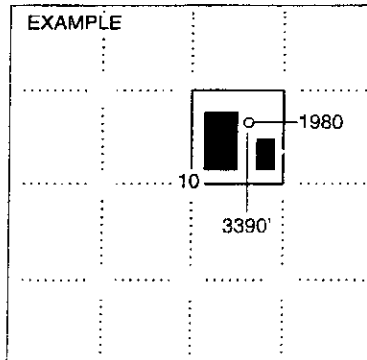
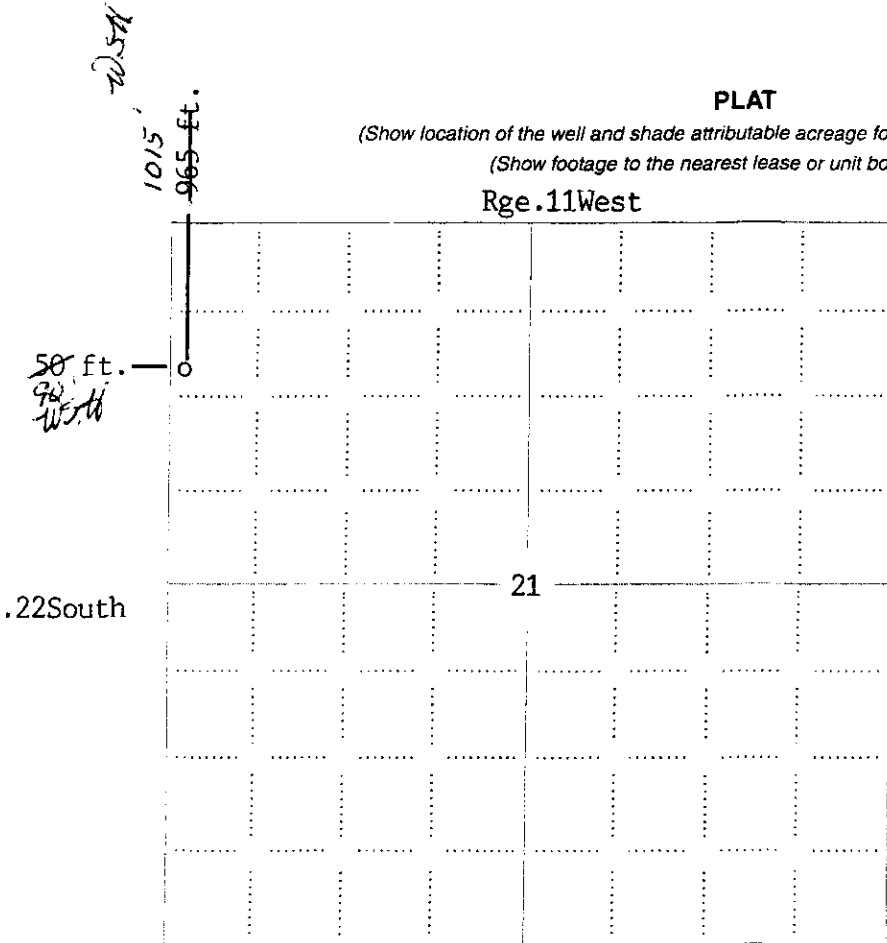

NOTE: In all cases locate the spot of the proposed drilling location.

Stafford Co., Kansas

In plotting the proposed location of the well, you must show:

1. The manner in which you are using the depicted plat by identifying section lines, i.e. 1 section, 1 section with 8 surrounding sections, 4 sections, etc.
2. The distance of the proposed drilling location from the south / north and east / west outside section lines.
3. The distance to the nearest lease or unit boundary line (in footage).
4. If proposed location is located within a prorated or spaced field a certificate of acreage attribution plat must be attached: (CO-7 for oil wells; CG-8 for gas wells).

KANSAS CORPORATION COMMISSION
OIL & GAS CONSERVATION DIVISION
APPLICATION FOR SURFACE PIT

Form CDP-1
April 2004
Form must be Typed

Submit in Duplicate

Correction

Operator Name: Hutchinson Oil Co.		License Number: 5614
Operator Address: P.O. Box 521 - Derby, KS 67037-0521		
Contact Person: Steve Hutchinson		Phone Number: (316) 788 - 5440
Lease Name & Well No.: Sleeper #21-1		Pit Location (QQQQ): SW - NW - NW Sec. 21 Twp. 22S R. 11 <input type="checkbox"/> East <input checked="" type="checkbox"/> West N 965 1015 Feet from <input checked="" type="checkbox"/> North / <input type="checkbox"/> South Line of Section 5090 Feet from <input type="checkbox"/> East / <input checked="" type="checkbox"/> West Line of Section Stafford County
Type of Pit: <input type="checkbox"/> Emergency Pit <input type="checkbox"/> Burn Pit <input type="checkbox"/> Settling Pit <input checked="" type="checkbox"/> Drilling Pit <input type="checkbox"/> Workover Pit <input type="checkbox"/> Haul-Off Pit <small>(If WP Supply API No. or Year Drilled)</small>	Pit is: <input checked="" type="checkbox"/> Proposed <input type="checkbox"/> Existing If Existing, date constructed: Pit capacity: 4,000 (bbls)	
Is the pit located in a Sensitive Ground Water Area? <input checked="" type="checkbox"/> Yes <input type="checkbox"/> No		Chloride concentration: _____ mg/l <small>(For Emergency Pits and Settling Pits only)</small>
Is the bottom below ground level? <input checked="" type="checkbox"/> Yes <input type="checkbox"/> No	Artificial Liner? <input type="checkbox"/> Yes <input checked="" type="checkbox"/> No	How is the pit lined if a plastic liner is not used? Bentonite and Solids from Drilling Operations. (Native & fresh mud)
Pit dimensions (all but working pits): 75 Length (feet) 75 Width (feet) N/A: Steel Pits Depth from ground level to deepest point: 4 (feet)		
If the pit is lined give a brief description of the liner material, thickness and installation procedure.		Describe procedures for periodic maintenance and determining liner integrity, including any special monitoring.
Distance to nearest water well within one-mile of pit 791 feet 769 - Depth of water well 75 feet		Depth to shallowest fresh water 21 feet. Source of information: _____ measured _____ well owner _____ electric log <input checked="" type="checkbox"/> KDWR
Emergency, Settling and Burn Pits ONLY: Producing Formation: _____ Number of producing wells on lease: _____ Barrels of fluid produced daily: _____ Does the slope from the tank battery allow all spilled fluids to flow into the pit? <input type="checkbox"/> Yes <input type="checkbox"/> No		Drilling, Workover and Haul-Off Pits ONLY: Type of material utilized in drilling/workover: fresh mud Number of working pits to be utilized: (3) Abandonment procedure: Pull all free fluids, allow to evaporate until dry, then backfilled as conditions allow. Drill pits must be closed within 365 days of spud date.
I hereby certify that the above statements are true and correct to the best of my knowledge and belief. 2/12/2010 Date		RECEIVED FEB 12 2010 KCC WICHITA
Signature of Applicant or Agent <i>Steve Hutchinson</i>		
KCC OFFICE USE ONLY		
RFS+C		
Date Received: 2-12-10	Permit Number: _____	Permit Date: 2-15-10 Lease Inspection: <input checked="" type="checkbox"/> Yes <input type="checkbox"/> No

15-185-23610-00-00



Mark Parkinson, Governor
Thomas E. Wright, Chairman
Joseph F. Harkins, Commissioner

February 18, 2010

Hutchinson Oil Co.
PO Box 521
Derby, KS 67037-0521

RE: Drilling Pit Application
Sleeper Lease Well No. 21-1
NW/4 Sec. 21-22S-11W
Stafford County, Kansas

Dear Sir or Madam:

District staff has inspected the above referenced location and has determined that the reserve pit shall be constructed **without slots**, the bottom shall be flat and reasonably level and the free fluids must be removed. The fluids are to be removed from the reserve pit as soon as the Hutchinson Salt section has been drilled through and displacement of the fluids into the reserve pit has occurred. The fluids should be removed again after drilling operations have ceased.

If production casing is set all completion fluids shall be removed from the working pits daily. NO completion fluids or non-exempt wastes shall be placed in the reserve pit.

The fluids should be taken to an authorized disposal well. Please call the District Office at (620) 225-8888 when the fluids have been removed. Please file form CDP-5 (August 2004), Exploration and Production Waste Transfer, within 30 days of fluid removal. Conservation division forms are available through our office and on the KCC web site: www.kcc.state.ks.us/conservation/forms.

A copy of this letter should be posted in the doghouse along with the approved Intent to Drill.

If you have any questions or concerns please feel free to contact the undersigned at the above address.

Sincerely,

Kathy Haynes

Department of Environmental Protection and Remediation

cc: File