

This form shall be filed in duplicate with the Kansas Corporation Commission, 200 Colorado Derby Building, Wichita, Kansas 67202, within ten days after the completion of the well, regardless of how the well was completed.

Attach separate letter of request if the information is to be held confidential. If confidential, only file one copy. Information on side one will be of public record and side two will then be held confidential.

Circle one: Oil, Gas, Dry, SWD, OWWO, Injection. Type and complete ALL sections. Applications must be filed for dual completion, commingling, SWD and injection, T.A.

Attach wireline logs (i.e. electrical log, sonic log, gamma ray neutron log, etc.). KCC # (316) 263-3238. (Rules 82-2-105 & 82-2-125)

OPERATOR A. Scott Ritchie

API NO. 15-065-21,573-0000

ADDRESS 125 N. Market, Suite 950

COUNTY Graham

Wichita, Kansas 67202

FIELD

**CONTACT PERSON F. Judson Hipps

PROD. FORMATION None

PHONE (316) 267-4375

LEASE McCall "B"

PURCHASER None

WELL NO. 1

ADDRESS

WELL LOCATION 150' E of C S/2 NE SW

DRILLING Murfin Drilling Company

990 Ft. from North Line and

CONTRACTOR

510 Ft. from East Line of

ADDRESS 617 Union Center

the Sw/4 SEC. 32 TWP. 10S RGE. 22W

Wichita, Kansas 67202

PLUGGING Same as above

RECEIVED STATE CORPORATION COMMISSION

CONTRACTOR

FEB 16 1982

ADDRESS

CONSERVATION DIVISION

Wichita, Kansas

PBTD None

TOTAL DEPTH 3925'

SPUD DATE 1/27/82 DATE COMPLETED 2/02/82

ELEV: GR 2272' DF KB 2277'

DRILLED WITH (XXX) (ROTARY) (XXX) TOOLS

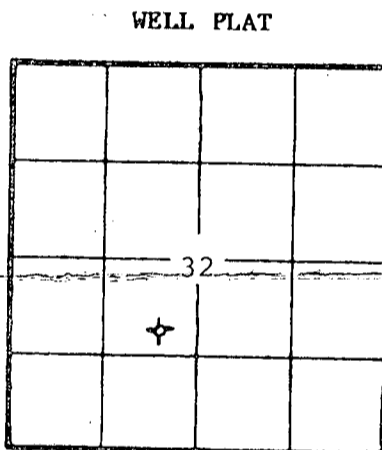

KCC [checked] KGS [checked] (Office Use)

Amount of surface pipe set and cemented 205' DV Tool Used?

AFFIDAVIT

STATE OF Kansas, COUNTY OF Sedgwick SS, I,

F. Judson Hipps OF LAWFUL AGE, BEING FIRST DULY SWORN UPON HIS OATH,

DEPOSES THAT HE IS Geologist (FOR)(XX) A. Scott Ritchie

OPERATOR OF THE McCall "B" LEASE, AND IS DULY AUTHORIZED TO MAKE

THIS AFFIDAVIT FOR AND ON THE BEHALF OF SAID OPERATOR, THAT WELL NO. 1 ON

SAID LEASE HAS BEEN COMPLETED AS OF THE 2nd DAY OF February, 19 82, AND THAT

ALL INFORMATION ENTERED HEREIN WITH RESPECT TO SAID WELL IS TRUE AND CORRECT.

FURTHER AFFIANT SAITH NOT.

SUBSCRIBED AND SWORN BEFORE ME THIS 11th DAY OF February, 19 82

(S) F. Judson Hipps

CAROLYN S. HOLDEMAN STATE NOTARY PUBLIC Sedgwick County, Kansas My Appointment Expires 10/5/82

Carolyn S. Holdeman NOTARY PUBLIC

MY COMMISSION EXPIRES:

**The person who can be reached by phone regarding any questions concerning this information. Within 45 days of completion, a witnessed initial test by the Commission is required if the well produces more than 25 BOPD or is located in a Basic Order Pool.

SIDE TWO

WELL LOG

Show all important zones of porosity and contents thereof; cored intervals, and all drill-stem tests, including depth interval tested, cushion used, time tool open, flowing and shut-in pressures, and recoveries.

SHOW GEOLOGICAL MARKERS, LOGS RUN, OR OTHER DESCRIPTIVE INFORMATION.

FORMATION DESCRIPTION, CONTENTS, ETC.	TOP	BOTTOM	NAME	DEPTH
DST #1 from 3590' to 3616' (35' zone). Recovered 350' of muddy water. IFP: 46-104#/30"; ISIP:906#/60"; FFP:138-184#/60"; FSIP:838#/60".				
ELECTRIC LOG TOPS				
DST #2 from 3610' to 3632' (50' zone). Recovered 30' of mud, no show of oil. IFP:23-23#/30"; ISIP:1055#/45"; FFP:35-35#/30"; FSIP:1043#/60".			Anhy B/Anhy Heebner Toronto Lansing B/KC Marmaton LTD	1769'(+ 508) 1816'(+ 461) 3522'(-1245) 3545'(-1268) 3560'(-1283) 3784'(-1507) 3872'(-1595) 3925'(-1648)
DST #3 from 3627' to 3644' (70' zone). Recovered 35' of slightly oil cut mud and 40' of very muddy oil. IFP:32-32#/30"; ISIP:415#/45"; FFP:53-64#/60"; FSIP:191#/60".				
DST #4 from 3684' to 3768' (140', 160' 180' & 200' zones). Recovered 175' of muddy water, no show of oil. IFP: 81-104#/30"; ISIP:792#/45"; FFP:115-127#/60"; FSIP:747#/60".				

Report of all strings set — surface, intermediate, production, etc. CASING RECORD (New) or (Used)

Purpose of string	Size hole drilled	Size casing set (in O.D.)	Weight lbs/ft.	Setting depth	Type cement	Sacks	Type and percent additives
Surface	12 1/2"	8-5/8"		205'	common	180	

LINER RECORD

PERFORATION RECORD

Top, ft.	Bottom, ft.	Sacks cement	Shots per ft.	Size & type	Depth interval

TUBING RECORD		
Size"	Setting depth	Packer set at

ACID, FRACTURE, SHOT, CEMENT SQUEEZE RECORD

Amount and kind of material used		Depth interval treated
Date of first production	Producing method (Flowing, pumping, gas lift, etc.)	Gravity
RATE OF PRODUCTION PER 24 HOURS	Oil bbls.	Gas MCF
	Water %	Gas-oil ratio bbls. CFPB
Disposition of gas (vented, used on lease or sold)		Perforations