

15-065-00923-0000

STATE OF KANSAS
STATE CORPORATION COMMISSION

Form CP-4

Give All Information Completely
Make Required Affidavit
Mail or Deliver Report to:
Conservation Division
State Corporation Commission
211 No. Broadway
Wichita, Kansas

WELL PLUGGING RECORD

GRAHAM County, Sec. 32 Twp. 10s Rge. 22 W (E) 32 (W)

Location as "NE/CNW/SW" or footage from lines NW NE SW

Lease Owner PETROLEUM, INC.

Lease Name LACERTE Well No. 1

Office Address ROUTE #2, GREAT BEND, KANSAS

Character of Well (completed as Oil, Gas or Dry Hole) OIL

Date well completed FEB. 4, 19 56

Application for plugging filed DEC. 15 19 64

Application for plugging approved DEC. 16 19 64

Plugging commenced DEC. 20 19 64

Plugging completed DEC. 20 19 64

Reason for abandonment of well or producing formation NO PRODUCIBLE ZONES DEPLETED

If a producing well is abandoned, date of last production AUGUST 3, 19 64

Was permission obtained from the Conservation Division or its agents before plugging was commenced? YES

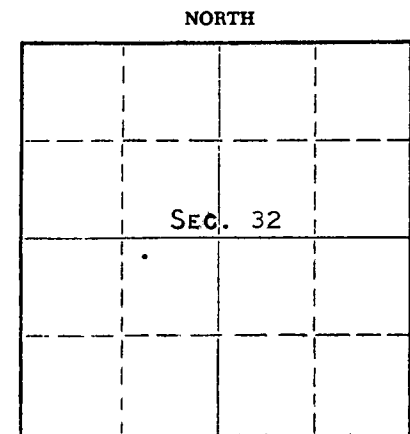

Locate well correctly on above Section Plat

Name of Conservation Agent who supervised plugging of this well W. L. NICHOLS, MORELAND, KANSAS

Producing formation L-KC Depth to top 3562 Bottom 3631 Total Depth of Well 4013 Feet

Show depth and thickness of all water, oil and gas formations.

OIL, GAS OR WATER RECORDS

CASING RECORD

FORMATION	CONTENT	FROM	TO	SIZE	PUT IN	PULLED OUT
				8-5/8	209'	NONE
				4-1/2"	3730'	NONE
	WATER AND SMALL AMOUNT OF OIL					

Describe in detail the manner in which the well was plugged, indicating where the mud fluid was placed and the method or methods used in introducing it into the hole. If cement or other plugs were used, state the character of same and depth placed, from feet to feet for each plug set.

(PLUGGED BACK TOTAL DEPTH 3637')

PUMPED IN 35 SACKS GEL AT 750# PRESSURE, FOLLOWED BY A WIPER PLUG. PUMPED IN 70 SACKS CEMENT AT 350# PRESSURE.

RECEIVED
STATE CORPORATION COMMISSION

JAN 8 1965

CONSERVATION DIVISION
Wichita, Kansas

(If additional description is necessary, use BACK of this sheet)

Name of Plugging Contractor GLENN & SMITH PIPE PULLING CO.

Address Box 156, ELLINWOOD, KANSAS

STATE OF KANSAS, COUNTY OF BARTON, ss.

MONTE CHADD (employee of owner) or (owner or operator) of the above-described

well, being first duly sworn on oath, says: That I have knowledge of the facts, statements, and matters herein contained and the log of the above-described well as filed and that the same are true and correct. So help me God. MONTE CHADD, DIST. PROD. SUPT.

(Signature)

ROUTE #2, GREAT BEND, KANSAS

(Address)

SUBSCRIBED AND SWORN to before me this 31 day of DECEMBER, 19 64

David P. Freeman

Notary Public.

My commission expires OCTOBER 19, 1968

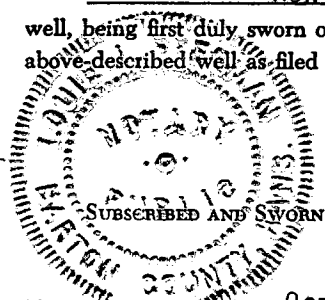

WELL LOG

15-065-00923-0000

COMPANY **Petroleum, Inc. & Colorado Oil & Gas Corp.**

SEC. 32 T. 10 R. 22W

FARM **LACERTE** NO. **1**

LOC. **NW NE SW**
1650 FWL
2310 FSL

TOTAL DEPTH **4013'**

COUNTY **Graham**

COMM. **January 11, 1956** COMP. **January 21, 1956**

CONTRACTOR **Garvey Drilling Company**

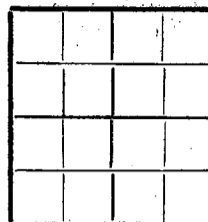

CASING **8-5/8" @ 208' w/135 sax**
4-1/2" @ 3730' w/75 sax

ELEVATION **2280 DF**
2282 RB

PRODUCTION **Lansing**

FIGURES INDICATE BOTTOM OF FORMATIONS

40	Shale & Rock
145	Shale & Clay
2180	Shale & Shells
1525	Sand
1781	Sand & Shale
1820	Anhydrite
2280	Shale & Shells
2535	Lime & Shale
2655	Lime
3230	Lime & Shale
3325	Shale & Shells
3375	Lime
3545	Lime & Shale
3795	Lime
3852	Lime & Shale
3910	Lime & Chert
3943	Lime & Shale
4000	Lime, Shale & Chert
4013	Lime & Chert

Sample Tops

Topeka	3300 (-1018)
Heebner	3523 (-1241)
Toronto	3547 (-1265)
Lansing	3562 (-1280)
Arbuckle	3988 (-1706)

RTD 4013

RECEIVED
STATE CORPORATION COMMISSION
JAN 8 1955
CONSERVATION DIVISION
Wichita, Kansas

State of KANSAS }
County of SEDGWICK } SS:

I, Karl E. Becker of Petroleum, Inc.

upon oath state that the above and foregoing is a true and correct copy of the log of the LACERTE #1 well

Subscribed and sworn to before me this 27th day of January 19 56

My Commission Expires: September 2, 1959

Karl E. Becker

Frances Sloan
NOTARY PUBLIC

FRANCES SLOAN, Notary Public
My Commission expires Sept. 2, 1959