

15-065-01749-00-00

STATE OF KANSAS  
STATE CORPORATION COMMISSION  
200 Colorado Derby Building  
Wichita, Kansas 67202

WELL PLUGGING RECORD  
K.A.R.-82-3-117

Drilling completed  
June 23, 1955

API NUMBER \_\_\_\_\_  
LEASE NAME Acheson  
WELL NUMBER #8

TYPE OR PRINT  
NOTICE: Fill out completely  
and return to Cons. Div.  
office within 30 days.

\* CORRECTED COPY

3960 Ft. from S Section Line  
1980 Ft. from E Section Line

LEASE OPERATOR John O. Farmer, Inc.  
ADDRESS P.O. Box 352, Russell, KS 67665  
PHONE# (913) 483-3144 OPERATORS LICENSE NO. 5135

SEC. 14 TWP. 10S RGE. 21 ~~XXXX~~(W)  
COUNTY Graham

Character of Well oil  
(Oil, Gas, D&A, SWD, Input, Water Supply Well)

Date Well Completed 6-23-55  
Plugging Commenced 2-21-92  
11:00 A.M.  
Plugging Completed 2-21-92

The plugging proposal was approved on February 19, 1992 (date)  
by District #4 - Dennis Hamel (KCC District Agent's Name).

Is ACO-1 filed? No If not, Is well log attached? Yes

Producing Formation Lansing/KC Depth to Top 3451' Bottom 3644' T.D. 3750'

Show depth and thickness of all water, oil and gas formations.

OIL, GAS OR WATER RECORDS | CASING RECORD

Formation	Content	From	To	Size	Put In	Pulled out
Lansing/KC	oil & water	3451'	3644'	8-5/8"	166'	-0-
				5-1/2"	3746'	-0-

Describe in detail the manner in which the well was plugged, indicating where the mud fluid was placed and the method or methods used in introducing it into the hole. If cement or other plugs were used, state the character of same and depth placed, from \_\_\_ feet to \_\_\_ feet each set.

The casing was perforated 3 shots @ 1675' prior to cementing. Mixed 300 sks. cement w/6 sks. hulls down 5-1/2" casing - pressure 200 PSIG, shut in @ 200 PSIG. Mixed 75 sks. cement down backside - maximum pressure 600 PSIG, shut in @ 300 PSIG.

(OVER FOR ADDITIONAL INFORMATION)

(If additional description is necessary, use BACK of this form.)

Name of Plugging Contractor Allied Cementing Company, Inc. License No. \_\_\_\_\_  
Address P.O. Box 31, Russell, KS 67665

NAME OF PARTY RESPONSIBLE FOR PLUGGING FEES: John O. Farmer, Inc.

STATE OF Kansas COUNTY OF Russell, ss.

John O. Farmer III (Operator) of above-described well, being first duly sworn on oath, says: That I have knowledge of the facts, statements, and matters herein contained and the log of the above-described well as filed that the same are true and correct, so help me God.

(Signature) John O. Farmer III

(Address) P.O. Box 352, Russell, KS 67665

SUBSCRIBED AND SWORN TO before me this 30th day of March, 19 92

Margaret A. Schulte  
Notary Public  
Margaret A. Schulte

My Commission Expires: \_\_\_\_\_

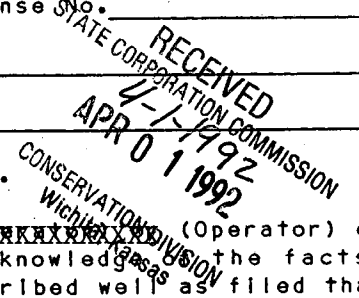
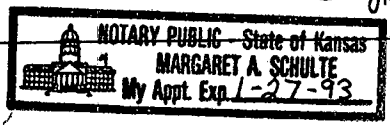

March 24, 1992

Job Start : 5:45 P.M.

Job Finish: 6:15 P.M.

Mixed 2 sks. hulls w/50 sks. cement and pumped down 5-1/2" casing.

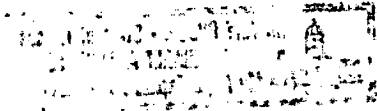

15-065-01749-00-00  
 SEC. 16 TWP. 10, RGE. 21  
 COUNTY GRABAM  
 WELL NO. 8  
 FARM NAME Achesson

Form 1002A

OPERATOR **Jones, Shelburne & Farmer, Inc.**  
**Russell, Kansas**  
 ADDRESS **Graham 14 10 21**

FORMATION RECORD

15-065-01749-00-00

Give detailed description and thickness of all formations drilled through, contents of sand, whether dry, water, oil or gas.

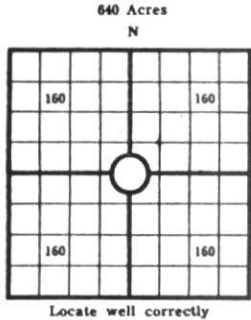

COUNTY **Jones, Shelburne & Farmer, Inc.**  
 COMPANY OPERATING **Russell, Kansas**  
 OFFICE ADDRESS **RUSSELL**  
 FARM NAME **6-14 55** WELL NO. **8-23 55**  
 DRILLING STARTED \_\_\_\_\_, 19\_\_\_\_, DRILLING FINISHED \_\_\_\_\_, 19\_\_\_\_  
 DATE OF FIRST PRODUCTION **6-9/2 NE** COMPLETED \_\_\_\_\_  
 WELL LOCATED  $\frac{1}{4}$   $\frac{1}{4}$  North of South  
 Line and \_\_\_\_\_ ft. East of West **2192 & 2188 ?**  
 Elevation (Relative to sea level) DERRICK FLOOR **Oil** GROUND \_\_\_\_\_  
 CHARACTER OF WELL (Oil, gas or dryhole) \_\_\_\_\_

OIL OR GAS SANDS OR ZONES

Name	From	To	Name	From	To
1			4		
2			5		
3			6		

Perforating Record If Any

Shot Record

Formation	From	To	No. of Shots	Formation	From	To	Size of Shot

CASING RECORD

Size	Amount Set				Amount Pulled				Packer Record		
	Wt.	Thds.	Make	El.	In.	Ft.	In.	Size	Length	Depth Set	Make
8-5/8				166							

Liner Record: Amount \_\_\_\_\_ Kind \_\_\_\_\_ Top \_\_\_\_\_ Bottom \_\_\_\_\_

CEMENTING AND MUDDING

Size	Amount Set		Sacks Cement	Chemical		Method of Cementing	Amount	Mudding Method	Results (See Note)
	Ft.	In.		Gal.	Make				
8-5/8	100		125						
5-1/2	3746		75						

Note: What method was used to protect sands if outer strings were pulled? \_\_\_\_\_

NOTE: Were bottom hole plugs used? \_\_\_\_\_ If so, state kind, depth set and results obtained \_\_\_\_\_

TOOLS USED

Rotary Tools were used from \_\_\_\_\_ feet to \_\_\_\_\_ feet to \_\_\_\_\_ feet to \_\_\_\_\_ feet, and from \_\_\_\_\_ feet to \_\_\_\_\_ feet, and from \_\_\_\_\_ feet to \_\_\_\_\_ feet to \_\_\_\_\_ feet to \_\_\_\_\_ feet.

Type Rig \_\_\_\_\_

INITIAL PRODUCTION TEST

Describe initial test: whether by flow through tubing or casing or by pumping \_\_\_\_\_

Amount of Oil Production \_\_\_\_\_ bbls. Size of choke, if any \_\_\_\_\_ Length of test \_\_\_\_\_ Water

Production \_\_\_\_\_ bbls. Gravity of oil \_\_\_\_\_ Type of Pump if pump is used, describe \_\_\_\_\_

Formation	Top	Bottom	Formation	Top	Bottom
Surface	0	166			
Shale	166	340			
Shale & shells	340	600			
Sand Clay					
Shale	600	1120			
Sand	1120	1320			
Red Bed & Shale					
Shale	1320	1657			
Anhydrite	1657	1697			
Shale & shells	1697	2135			
Line Shale	2135	2889			
Shale & line	2889	2980			
Line & shale	2980	3500			
Line	3500	3511			
Line & shale	3511	3630			
Line	3630	3737			
Arbuckle	3737	3750			
T.D.		3750			
			POPS:		
			Elevation	RB	2153 ?
			Anhydrite		1655
			Heebner		3404
			Toronto		3427
			Lansing		3444
			B.K.C.		3607
			Conglomerate		3732
			Simpson		3736
			Arbuckle		3740
			5-1/2" @		3746
			T.D.		3750

COPY

RECEIVED  
 2-26-1992  
 FEB 26 1992

I, the undersigned, being first duly sworn upon oath, state that this well record is true, correct and complete according to the records of this office and to the best of my knowledge and belief.

Vice-Pres.

Name and title of representative of company

25th June 55

Subscribed and sworn to before me this \_\_\_\_\_ day of \_\_\_\_\_, 19\_\_\_\_

My Commission expires \_\_\_\_\_

*Luella Kennedy*  
Notary Public

Phone 913-483-2627, Russell, Kansas

15-065-01749-00-00

Phone Plainville 913-434-2812

Phone 316-793-5861, Great Bend, Kansas

Phone Ness City 913-798-3843

*old*

# ALLIED CEMENTING CO., INC.

Home Office P. O. Box 31

Russell, Kansas 67665

**COPY**

Date	2-21-92	Sec.	14	Twp.	10	Range	22	Called Out	8:00AM	On Location	9:30AM	Job Start	10:00AM	Finish	11:00AM
Lease	ARHESON	Well No.	# 8	Location	Ch God	45	1E	1/2N	Graham	County	KANSAS	State			
Contractor	NONE														
Type Job	Plug														
Hole Size	7 7/8			T.D.	3750										
Csg.	5 1/2 - 8 5/8			Depth	3746 - 166										
Tbg. Size				Depth											
Drill Pipe				Depth											
Tool				Depth											
Cement Left in Csg.				Shoe Joint											
Press Max.	600			Minimum											
Meas Line				Displace											
Perf.	1														

Owner Same  
 To Allied Cementing Co., Inc.  
 You are hereby requested to rent cementing equipment and furnish cementer and helper to assist owner or contractor to do work as listed.

Charge To John O. Farmer  
 Street \_\_\_\_\_  
 City \_\_\_\_\_ State \_\_\_\_\_  
 The above was done to satisfaction and supervision of owner agent or contractor.

Purchase Order No. \_\_\_\_\_  
 Warrant

**CEMENT**  
 Amount Ordered 375 60/40 100# GEL  
 Consisting of 1/4# FLO SEAL 6-Hulls

Common	
Poz. Mix	
Gel.	
Chloride	
Quickset	

Sales Tax	
Handling	
Mileage	
Sub Total	
<b>RECEIVED</b>	
STATE CORPORATION COMMISSION	
Total	

Floating Equipment  
 FEB 26 1992  
 2-26-1992  
 WICHITA, KANSAS

### EQUIPMENT

Pumptrk	No.	Cementer	R. DAVIS*
	153	Helper	
Pumptrk	No.	Cementer	
		Helper	
Bulktrk	213	Driver	PAUL
	160	Driver	

### DEPTH of Job

Reference #		360 <sup>00</sup>
	100 PER MILE	
	Sub Total	
	Tax	
	Total	

Remarks:  
 Mixed 300 SKS w/65K HULLS down 5 1/2 casing PRESS 200  
 SHUT IN 100'  
 Mixed 75 SKS down BACK SIDE MAX PRESS 600'  
 SHUT IN 300'

**MERCURY WIRELINE, INC.**

P.O. Box 680  
 Hays, Kansas 67601-0680  
 Phone 913 / 625-1182

№ 9357

**REMIT TO:**

**COPY**

**Job Ticket**

DATE \_\_\_\_\_

CHARGE TO: JOHN O FARMER INC

ADDRESS \_\_\_\_\_

LEASE AND WELL NO. ACHESON #8 FIELD \_\_\_\_\_

NEAREST TOWN \_\_\_\_\_ COUNTY GRAHAM STATE KS

CUSTOMER'S ORDER NO. VERBAL SEC. 14 TWP. 10S RANGE 21

ZERO 5' HQL CASING SIZE 5 1/2 WEIGHT \_\_\_\_\_

CUSTOMER'S T.D. \_\_\_\_\_ Mercury WL T.D. \_\_\_\_\_ FLUID LEVEL \_\_\_\_\_

ENGINEER T. MINCH

OPERATOR M. FUNK

PERFORATING					
CODE REFERENCE	DESCRIPTION	NO HOLES	DEPTH FROM	TO	AMOUNT
703-005	PERF	3	1675		\$670 <sup>00</sup>

TRUCK RENTAL			
CODE REFERENCE	RUN NO.	PREVIOUS INVOICE NO.	AMOUNT
100	ONE		1680 <sup>00</sup>

PLUGS, PACKERS, AND OTHER					
CODE REFERENCE	MFG. TYPE	CASING SIZE	WEIGHT	DEPTH	AMOUNT

DEPTH OF OPERATIONS CHARGES					
CODE REFERENCE	FROM	TO	NO. FEET	PRICE PER FT.	AMOUNT
<b>TOTAL</b>					<b>\$1300<sup>00</sup></b>
<b>DISCOUNT PRICE</b>					<b>\$550<sup>00</sup></b>

MATERIAL INVENTORY					
CODE REFERENCE	DESCRIPTION	QUANTITY	UNIT	PRICE	AMOUNT

SUB TOTAL					
TAX					
TOTAL					

RECEIVED THE ABOVE SERVICE ACCORDING TO THE TERMS AND CONDITIONS SPECIFIED BELOW WHICH WE HAVE READ AND TO WHICH WE HEREBY AGREE.

Customer J. Minch

**General Terms and Conditions**

- All accounts are to be paid within the terms fixed by Mercury WL invoices; and should these terms not be observed, interest at the rate of 1.5% per month will be charged from the date of such invoice.
- Because of the uncertain conditions existing in a well which are beyond the control of Mercury WL, it is understood by the customer that Mercury WL, cannot guarantee the results of their services and will not be held responsible for personal or property damage in the performance of their services.
- Should any of Mercury WL, instruments be lost or damaged in the performance of the operations requested, the customer agrees to make every reasonable effort to recover same, and to reimburse Mercury WL, for the value of the items which cannot be recovered, or the cost of repairing damage to items recovered.
- It is further understood and agreed that all depth measurements shall be supervised by the customer or its employees, and customer hereby certifies that the zones, as shot were approved.
- The customer certifies that it has the full right and authority to order such work on such well and that the well in which the work is to be done by Mercury WL is in proper and suitable condition for the performance of said work.
- No employee is authorized to alter the terms or conditions of this agreement.