

STATE OF KANSAS
STATE CORPORATION COMMISSION

Give All Information Completely
Make Required Affidavit
Mail or Deliver Report to:
Conservation Division
State Corporation Commission
212 North Market, Insurance Bldg.
Wichita, Kansas

R 15-065-02397-0000
WELL PLUGGING RECORD

Graham County, Sec. 15 Twp. 10S Rge. (E) 23 (W)

Location as "NE/CNW/SW" or footage from lines NE/4 SE/4 NE/4
Lease Owner Skelly Oil Company
Lease Name Frank Law Well No. 2
Office Address Box 1650, Tulsa, Oklahoma
Character of Well (completed as Oil, Gas or Dry Hole) Dry Hole
Date well completed February 8, 1960
Application for plugging filed February 8, 1960
Application for plugging approved February 9, 1960
Plugging commenced February 8, 1960
Plugging completed February 8, 1960
Reason for abandonment of well or producing formation Dry Hole

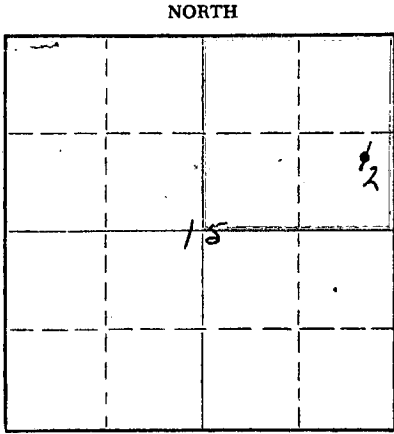

Locate well correctly on above Section Plat

If a producing well is abandoned, date of last production _____ 19____
Was permission obtained from the Conservation Division or its agents before plugging was commenced? Yes (verbally)

Name of Conservation Agent who supervised plugging of this well A. D. Fabricius
Producing formation None Depth to top _____ Bottom _____ Total Depth of Well 3971 Feet
Show depth and thickness of all water, oil and gas formations.

OIL, GAS OR WATER RECORDS

CASING RECORD

| FORMATION | CONTENT | FROM | TO | SIZE | PUT IN | PULLED OUT |
|-----------|---------|-------|----|--------|--------|------------|
| Lansing | Dry | 3668' | | 8-5/8" | 230'0" | None |
| | | | | | | |
| | | | | | | |
| | | | | | | |
| | | | | | | |
| | | | | | | |
| | | | | | | |
| | | | | | | |

Describe in detail the manner in which the well was plugged, indicating where the mud fluid was placed and the method or methods used in introducing it into the hole. If cement or other plugs were used, state the character of same and depth placed, from _____ feet to _____ feet for each plug set.

| | |
|--------------------|----------------|
| Mud laden fluid | 3971' to 3900' |
| 25 sacks of cement | 3900' to 3819' |
| Mud laden fluid | 3819' to 240' |
| 25 sacks of cement | 240' to 162' |
| Mud laden fluid | 162' to 75' |
| 25 sacks of cement | 75' to 6' |
| Surface soil | 6' to Surface |

STATE CORPORATION COMMISSION

FEB 23 1960

CONSERVATION DIVISION
Wichita

(If additional description is necessary, use BACK of this sheet)
Name of Plugging Contractor Claude Wentworth Drilling Co., Inc.
Address 2701 East 15th, Tulsa, Oklahoma

STATE OF Kansas, COUNTY OF Reno, ss.
H. E. Wansley (employee of owner) or (owner or operator) of the above-described well, being first duly sworn on oath, says: That I have knowledge of the facts, statements, and matters herein contained and the log of the above-described well as filed and that the same are true and correct. So help me God.

(Signature) _____

Box 391, Hutchinson, Kansas

(Address)

SUBSCRIBED AND SWORN TO before me this 19th day of February, 19 60

My commission expires April 7, 1963

Josephine L. Johnson
Notary Public.

15-005-02397-000

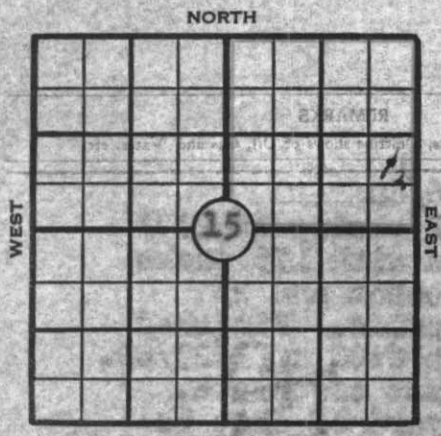

SKELLY OIL COMPANY

Well Record

Lease Name and No. **Frank Law Lease No. 41945** Well No. **2**
 Lease Description **NE/4 Section 15-103-23W, Graham County, Kansas (160 Acres)**

Location Staked **January 20, 60** by **C. W. Huff**
330 feet from **east** line by **990** feet from **south** line
 of **NE/4 Section 15**

Elev. K.B. **2357'**
 D.F.
 Elev. G.L. **2355'**

Drilling Contractor **Claude Wentworth Drig. Co., Inc.**
 Work Com'd. **Jan. 25, 60** Drilling Com'd. **Jan. 26, 60** Reached Total Depth **Feb. 7, 60**

Rotary Drilling from **Surface** to **3971'** Cable Tool Drilling from _____ to _____

Well Completed **DRY HOLE** 19____ Total Depth **3971'** P.B.T.D. _____

Initial Completion Test _____ 19____

Pressures: F.C.P. _____ F.T.P. _____ S.I.C.P. _____ S.I.T.P. _____

PRODUCING FROM

| FORMATION | thru | OPEN HOLE PERFORATIONS | TOP | BOTTOM | Total No. Shots |
|-----------------|------|------------------------|-----|--------|-----------------|
| DRY HOLE | | | | | |
| FORMATION | thru | OPEN HOLE PERFORATIONS | TOP | BOTTOM | Total No. Shots |
| FORMATION | thru | OPEN HOLE PERFORATIONS | TOP | BOTTOM | Total No. Shots |
| FORMATION | thru | OPEN HOLE PERFORATIONS | TOP | BOTTOM | Total No. Shots |

CASING RECORD

| STRINGS | SIZE | WHERE SET (Depth) | CEMENTING RECORD | | All Measurements were taken from top of Kelly Bushing which is _____ ft. from top of surface casing |
|--------------|---------------|-------------------|------------------|--|---|
| | | | Sacks Used | Top Cem't Bh'd. Cas'g. | |
| Surface | 8-5/8" | 236' | 175 | Cement did not circ. Filled w/ chat | _____ ft. Flange Collar |
| Intermediate | | | | | |
| Production | | | | | |
| Liner | | | | | Top Liner: _____ |

| Size | Wt. | Thds. | Kind | Cond. | Jts. | LEFT IN | | | | PULLED OUT | | | |
|---------------|-------------|-----------|-------------|----------|----------|------------|----------|------------|----------|------------|-----|------|-----|
| | | | | | | LTM | | WTM | | LTM | | WTM | |
| | | | | | | Feet | In. | Feet | In. | Feet | In. | Feet | In. |
| 8-5/8" | 22.7 | 33 | ARCO | A | 6 | 230 | 0 | 230 | 0 | | | | |
| | | | | | | | | | | | | | |
| | | | | | | | | | | | | | |
| | | | | | | | | | | | | | |
| | | | | | | | | | | | | | |
| | | | | | | | | | | | | | |
| | | | | | | | | | | | | | |
| | | | | | | | | | | | | | |
| | | | | | | | | | | | | | |

SIGNIFICANT GEOLOGICAL FORMATIONS

| NAME | TOP | BOTTOM | GAS | | OIL | | REMARKS |
|------------------------------|--------------|--------|------|----|------|----|---------|
| | | | FROM | TO | FROM | TO | |
| Sources: Schlumberger | | | | | | | |
| Topeka Line | 3413' | | | | | | |
| Heubner Shale | 3634' | | | | | | |
| Toronto Line | 3655' | | | | | | |
| Lansing Line | 3668' | | | | | | |
| Marmaton | 3943' | | | | | | |
| | | | | | | | |
| | | | | | | | |
| | | | | | | | |
| | | | | | | | |

TREATMENT RECORD

| DATE | TYPE TREATMENT | INTERVAL TREATED | AMOUNT OF TREATMENT |
|------|----------------|------------------|---------------------|
| | | | |
| | | | |
| | | | |
| | | | |
| | | | |

WORKOVER RECORD

| TYPE WORK | DATE COM'D. | DATE COMP. | Plugged back or Deepened | | PROD. BEFORE | PROD. AFTER |
|-----------|-------------|------------|--------------------------|----|--------------|-------------|
| | | | FROM | TO | | |
| | | | | | | |
| | | | | | | |
| | | | | | | |
| | | | | | | |
| | | | | | | |

RECORD OF FORMATIONS

| FORMATION | TOP | BOTTOM | REMARKS |
|----------------------|---------|--------|---|
| Soil, shale and sand | Surface | 240 | Spudded 1/26/60 Set 8-5/8" casing at 236' and cemented with 175 sacks of Pozmix cement and 25 calcium chloride. Finished cementing at 8:00 am 1/27/60. Cement did not circulate. Dumped 1/2 yard of chat be- hind 8-5/8" casing and filled to top of hole. |
| Shale and sand | 240 | 1175 | |
| Shale | 1175 | 1920 | |
| Anhydrite | 1920 | 2120 | |
| Shale and shells | 2120 | 2595 | |
| Lime and shale | 2595 | 3090 | |
| Lime | 3090 | 3275 | |
| Lime and shale | 3275 | 3685 | |

TOP TOPEKA Line 3413'
Top Heebner Shale 3634'
Top Toronto Line 3655'
Top Lansing Line 3668'

DRILL STEM TEST NO. 1
 3662'-3685' (23') - Tool
 open 2 hours, fair to strong
 blow increasing throughout,
 recovered 185' oil and gas
 cut mud, 300' oil and gas
 cut salt water, and 300' salt
 water, IBHP-96%, IFP-80%,
 FFP-375%, FBHP-910/ in 30
 minutes.

| FORMATION | TOP | BOTTOM | REMARKS |
|----------------|------|--------|---------|
| Lime | 3685 | 3733 | |
| Lime and shale | 3733 | 3971 | |

TOP MARNATON LINE 3943'

DRILL STEM TEST NO. 2
 3890'-3971' (81') - Tool
 open 1 hour, weak blow dead
 in 30 minutes, recovered
 25' of rotary mud, no oil
 or water, IBHP-190/ in 30
 minutes, IFP-0%, FFP-0%,
 FBHP-50/ in 30 minutes.

Since no oil or gas in commercial quantities was encountered in drilling to the total depth of 3971', regular authority was granted to plug and abandon the well.

The well was plugged as follows:

| REMARKS | DEPTH |
|--------------------|----------------|
| Mud laden fluid | 3971' to 3900' |
| 25 sacks of cement | 3900' to 3819' |
| Mud laden fluid | 3819' to 240' |
| 25 sacks of cement | 240' to 162' |
| Mud laden fluid | 162' to 75' |
| 25 sacks of cement | 75' to 6' |
| Surface soil | 6' to Surface |

Plugged and abandoned February 8, 1960.

SLOPE TEST DATA

| DEPTH | ANGLE IN DEGREES |
|-------|------------------|
| 500' | 1/2 Degree |
| 1000' | 1/2 " |
| 1250' | 3/4 " |
| 1500' | 1/2 " |
| 2000' | 1/2 " |
| 2250' | 1/2 " |
| 2500' | 1/2 " |
| 3000' | 3/4 " |
| 3500' | 1/2 " |

WORKOVER RECORD

| DATE WORK | DATE COM'D | DATE COM'D | FROM | TO | REMARKS |
|-----------|------------|------------|------|----|---------|
| | | | | | |
| | | | | | |
| | | | | | |
| | | | | | |
| | | | | | |