

FOR KCC USE:

15-065-01030-00-01
01030

FORM C-1 7/91

FORM MUST BE TYPED

FORM MUST BE SIGNED

ALL BLANKS MUST BE FILLED

EFFECTIVE DATE: 9-77-96

State of Kansas

DISTRICT # 4

NOTICE OF INTENTION TO DRILL

SGA? Yes No

Must be approved by the K.C.C. five (5) days prior to commencing well

Expected Spud Date: October 1, 1996
month day year

Spot: C NW SW/4 Sec 9 Twp 10 S, Rg 24 East West

OPERATOR: License # 03655
Name: STAAB ENERGY & LEASING
Address: 2514 Haney Drive
City/State/Zip: Hays, Kansas 67601-2220
Contact Person: Norman G. Staab
Phone: 9130628-1326

1,980 feet from South line of Section
660 feet from East line of Section
IS SECTION X REGULAR IRREGULAR?

CONTRACTOR: License #: 6039
Name: L. D. Drilling, Inc.

(NOTE: Locate well on the Section Plat on Reverse Side)
County: Graham
Lease Name: Herman Well #: 6 WSW
Field Name: Bryan

Well Drilled For: Well Class: Type Equipment:

Oil Enh Rec X Infield A Mud Rotary
Gas Storage Pool Ext. Air Rotary
X OWD Disposal Wildcat Cable
Seismic: # of Holes Other
X Other WSW

Is this a Prorated/Spaced Field? yes X no
Target Formation(s): Cedar Hill
Nearest lease or unit boundary: 660'
Ground Surface Elevation: 2,499 feet MSL
Water well within one-quarter mile: X yes no
Public water supply well within one mile: yes X no
Depth to bottom of fresh water: 85' 150'
Depth to bottom of usable water: 1450' 1750' BASE OF DAKOTA
Surface Pipe by Alternate: 1 X 2
Length of Surface Pipe to be set: 229'
Length of Conductor pipe required: N/A
Projected Total Depth: 1,900'
Formation at Total Depth: Cedar Hill
Water Source for Drilling Operations:
well X farm pond other
DWR Permit #:
Will Cores Be Taken? yes no
If yes, proposed zone:

If OWD: old well information as follows:
Operator: Murfin Drilling Company
Well Name: Herman "C" # 1
Comp. Date: 11-27-59 Old Total Depth 4,050'

Directional, Deviated or Horizontal wellbore? yes X no
If yes, true vertical depth:
Bottom Hole Location:

AFFIDAVIT

The undersigned hereby affirms that the drilling, completion and eventual plugging of this well will comply with K.S.A. 55-101, et. seq.

It is agreed that the following minimum requirements will be met:

- 1. Notify the appropriate district office prior to spudding of well;
- 2. A copy of the approved notice of intent to drill shall be posted on each drilling rig;
- 3. The minimum amount of surface pipe as specified below shall be set by circulating cement to the top; in all cases surface pipe shall be set through all unconsolidated materials plus a minimum of 20 feet into the underlying formation;
- 4. If the well is dry hole, an agreement between the operator and the district office on plug length and placement is necessary prior to plugging;
- 5. The appropriate district office will be notified before well is either plugged or production casing is cemented in;
- 6. IF AN ALTERNATE II COMPLETION, PRODUCTION PIPE SHALL BE CEMENTED FROM BELOW ANY USABLE WATER TO SURFACE WITHIN 120 DAYS OF SPUD DATE. IN ALL CASES, NOTIFY DISTRICT OFFICE PRIOR TO ANY CEMENTING.

I hereby certify that the statements made herein are true and to the best of my knowledge and belief.

Date: Sept. 14, 1996 Signature of Operator or Agent: Title: Owner

FOR KCC USE:
API # 15- 065-01030-0000
Conductor pipe required NONE feet
Minimum surface pipe required 229 feet per Alt. X (2)
Approved by: JK 9-17-96
This authorization expires: 3-17-97
(This authorization void if drilling not started within 6 months of effective date.)
Spud date: Agent:

REMEMBER TO:

- File Drill Pit Application (form CDP-1) with Intent to Drill;
- File Completion Form ACO-1 within 120 days of spud date;
- File acreage attribution plat according to field proration orders;
- Notify appropriate district office 48 hours prior to workover or re-entry;
- Submit plugging report (CP-4) after plugging is completed;
- Obtain written approval before disposing or injecting salt water.

Mail to: Conservation Division, 200 Colorado Derby Building, 202 W. First St., Wichita, Kansas 67202-1286.

6
10
24W

IN ALL CASES PLOT THE INTENDED WELL ON THE PLAT BELOW

PLAT OF ACREAGE ATTRIBUTABLE TO A WELL IN A PRORATED OR SPACED FIELD

If the intended well is in a prorated or spaced field, please fully complete this side of the form. If the intended well is in a prorated or spaced field complete the plat below showing that the well will be properly located in relationship to other wells producing from the common source of supply. Please show all the wells within 1 mile of the boundaries of the proposed acreage attribution unit for gas wells and within 1/2 mile of the boundaries of the proposed acreage attribution unit for oil wells.

API NO. 15- _____
 OPERATOR STAAB ENERGY & LEASING LOCATION OF WELL: COUNTY Graham
 LEASE Herman 1,980 feet from south/~~north~~ line of section
 WELL NUMBER 5 WSW 660 feet from ~~east~~/west line of section
 FIELD Bryan SECTION 9 TWP 10 RG 24

NUMBER OF ACRES ATTRIBUTABLE TO WELL 160 IS SECTION X REGULAR or IRREGULAR
 QTR/QTR/QTR OF ACREAGE C - NW - SW **IF SECTION IS IRREGULAR, LOCATE WELL FROM NEAREST CORNER BOUNDARY.**

Section corner used: NE NW SE SW
PLAT

(Show location of the well and shade attributable acreage for prorated or spaced wells.)
 (Show footage to the nearest lease or unit boundary line.)

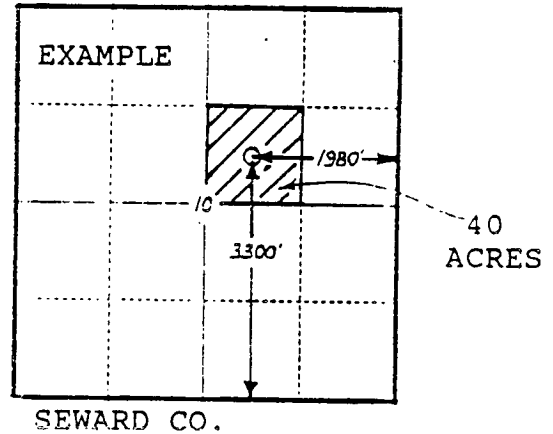
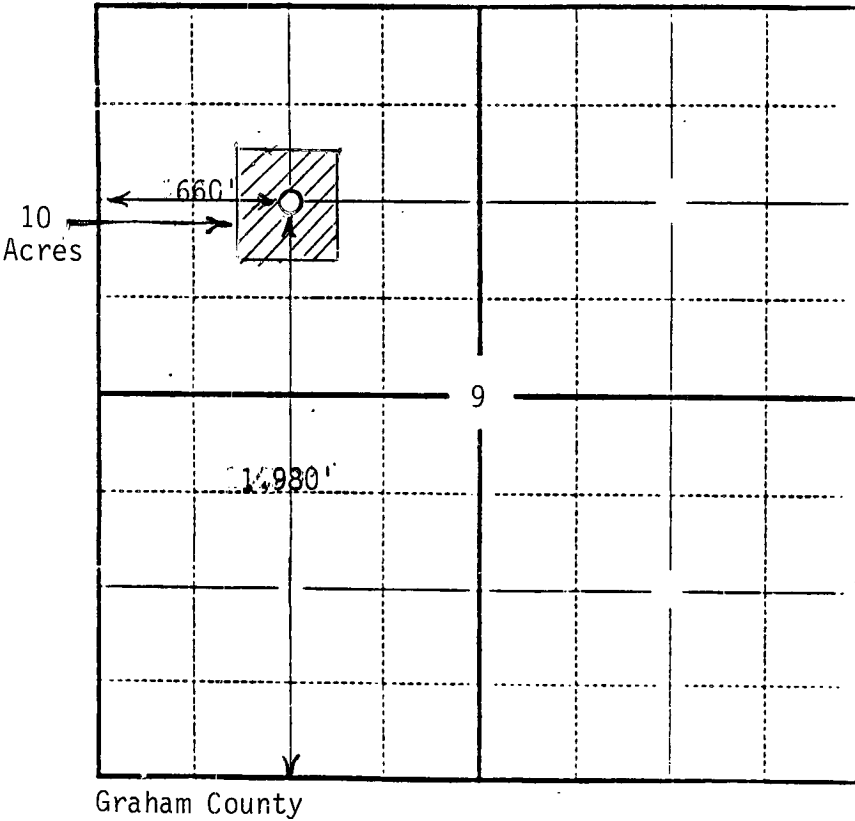

In plotting the proposed location of the well, you must show:

- 1) The manner in which you are using the depicted plat by identifying section lines, i.e. 1 section, 1 section with 8 surrounding sections, 4 sections, etc.;
- 2) the distance of the proposed drilling location from the section's south/north and east/west lines; and
- 3) the distance to the nearest lease or unit boundary line.