

15-065-22715-00-00

EFFECTIVE DATE: 6-7-93

State of Kansas

NOTICE OF INTENTION TO DRILL

Must be approved by the K.C.C. five (5) days prior to commencing well

DISTRICT # 4

SSA? Yes X No

Expected Spud Date June 10 1993 month day year

Spot NW SW SE Sec 9 Twp 10 S. Rg 24 East West

OPERATOR: License # 5669 Name: Helberg Oil Company Address: Box 32 City/State/Zip: Morland, Kansas 67650 Contact Person: Jerry M. Helberg Phone: 913-627-5665

990 feet from South / line of Section 2310 feet from East / line of Section

IS SECTION X REGULAR IRREGULAR (NOTE: Locate well on the Section Plat on Reverse Side)

CONTRACTOR: License #: 5669 Name: Helberg Oil Company

County: Graham Lease Name: G. Hobbs Well #: 1 Field Name: (new-unknown)

Well Drilled For: Well Class: Type Equipment: X Oil Enh Rec Infield X Mud Rotary Gas Storage X Pool Ext Air Rotary OAWD Disposal Wildcat Cable Seismic # of Holes Other

Is this a Prorated/Spaced Field? yes X no Target Formation(s): LKC

If OAWD: old well information as follows: Operator: Well Name: Comp. Date: Old Total Depth

Nearest lease or unit boundary: .330 Ground Surface Elevation: (est...2485) feet MSL

Directional, Deviated or Horizontal wellbore? yes X no If yes, true vertical depth: Bottom Hole Location

Water well within one-quarter mile: yes X no Public water supply well within one mile: yes X no

Depth to bottom of fresh water: 100 290 Depth to bottom of usable water: 100 1250

Surface Pipe by Alternate: 1 X 2 Length of Surface Pipe Planned to be set: 200

Length of Conductor pipe required: NONE Projected Total Depth: 4000

Formation at Total Depth: LKC Water Source for Drilling Operations:

well X farm pond other DWR Permit #: under 2 acres

Will Cores Be Taken? yes X no If yes, proposed zone:

AFFIDAVIT

The undersigned hereby affirms that the drilling, completion and eventual plugging of this well will comply with K.S.A. 55-101, et. seq. It is agreed that the following minimum requirements will be met:

- 1. Notify the appropriate district office prior to spudding of well; 2. A copy of the approved notice of intent to drill shall be posted on each drilling rig; 3. The minimum amount of surface pipe as specified below shall be set by circulating cement to the top; in all cases surface pipe shall be set through all unconsolidated materials plus a minimum of 28 feet into the underlying formation; 4. If the well is dry hole, an agreement between the operator and the district office on plug length and placement is necessary prior to plugging; 5. The appropriate district office will be notified before well is either plugged or production casing is cemented in; 6. IF AN ALTERNATE II COMPLETION, PRODUCTION PIPE SHALL BE CEMENTED FROM BELOW ANY USABLE WATER TO SURFACE WITHIN 120 DAYS OF SPUD DATE. IN ALL CASES, NOTIFY DISTRICT OFFICE PRIOR TO ANY CEMENTING.

I hereby certify that the statements made herein are true and to the best of my knowledge and belief. Date: 6-2-1993 Signature of Operator or Agent: Title: Owner

FOR KCC USE: API # 15- 065-22715 Conductor pipe required None feet Minimum surface pipe required 200 feet per Alt. X(2) Approved by: CB 6-2-93 This authorization expires: 12-2-93 (This authorization void if drilling not started within 6 months of effective date.) Spud date: Agent:

REMEMBER TO:

- File Drill Pit Application (form CDP-1) with Intent to Drill; - File Completion Form ACO-1 within 120 days of spud date; - File acreage attribution plat according to field proration orders; - Notify appropriate district office 48 hours prior to workover or re-entry; - Submit plugging report (CP-4) after plugging is completed; - Obtain written approval before disposing or injecting salt water.

Mail to: Conservation Division, 200 Colorado Derby Building, 202 W. First St., Wichita, Kansas 67202-1286.

RECEIVED STATE COMMISSION 6-2-1993 JUN 2 1993 CONSERVATION DIVISION Wichita, Kansas

Handwritten initials/signature

IN ALL CASES PLOT THE INTENDED WELL ON THE PLAT BELOW

PLAT OF ACREAGE ATTRIBUTABLE TO A WELL IN A PRORATED OR SPACED FIELD

If the intended well is in a prorated or spaced field, please fully complete this side of the form. If the intended well is in a prorated or spaced field complete the plat below showing that the well will be properly located in relationship to other wells producing from the common source of supply. Please show all the wells within 1 mile of the boundaries of the proposed acreage attribution unit for gas wells and within 1/2 mile of the boundaries of the proposed acreage attribution unit for oil wells.

API NO. 15- _____
OPERATOR Helberg Oil Company
LEASE G. Hobbs
WELL NUMBER 1
FIELD _____

LOCATION OF WELL: COUNTY Graham
990 feet from south/~~north~~ line of section
2310 feet from east/~~west~~ line of section
SECTION 9 TWP 10 RG 24

NUMBER OF ACRES ATTRIBUTABLE TO WELL 20
QTR/QTR/QTR OF ACREAGE NW - SW - SE

IS SECTION X REGULAR or IRREGULAR
IF SECTION IS IRREGULAR, LOCATE WELL FROM NEAREST CORNER BOUNDARY.

Section corner used: NE NW X SE SW

PLAT

(Show location of the well and shade attributable acreage for prorated or spaced wells.)
(Show footage to the nearest lease or unit boundary line.)

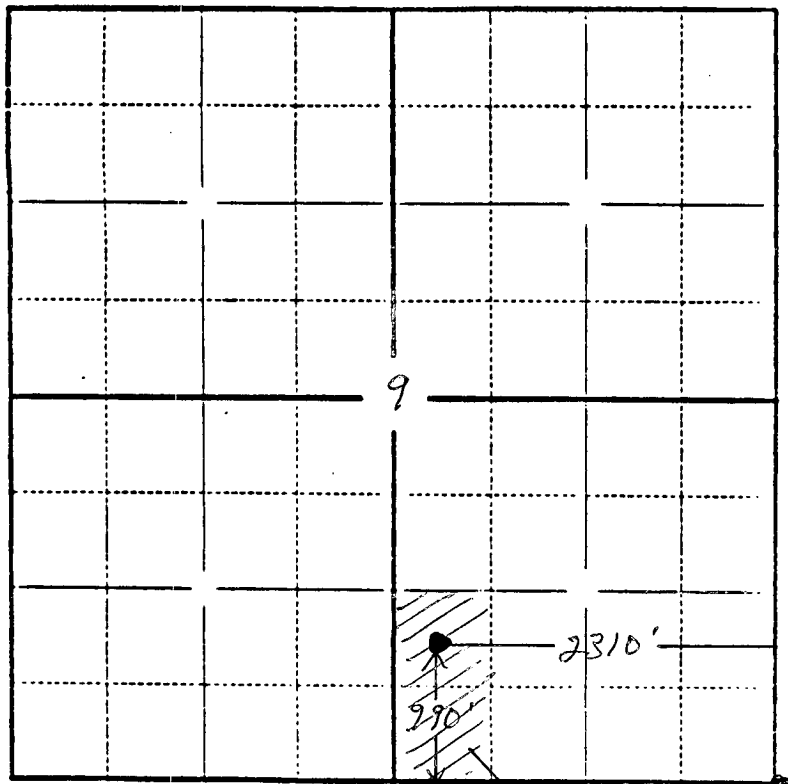

Graham Co. 9-10-24 20 acre

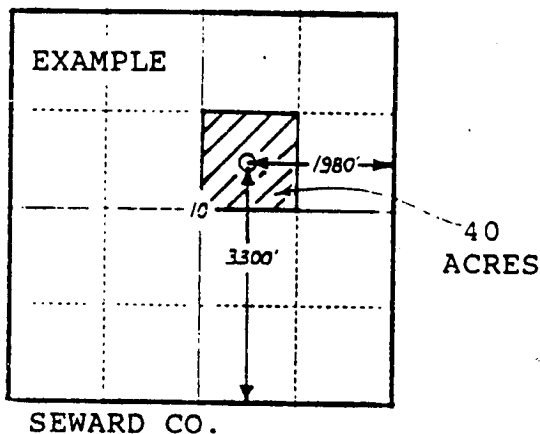

In plotting the proposed location of the well, you must show:

- 1) The manner in which you are using the depicted plat by identifying section lines, i.e. 1 section, 1 section with 8 surrounding sections, 4 sections, etc.;
- 2) the distance of the proposed drilling location from the section's south/north and east/west lines; and
- 3) the distance to the nearest lease or unit boundary line.