

Give All Information Completely
Make Required Affidavit
Mail or Deliver Report to:
Conservation Division
State Corporation Commission
212 No. Market
Wichita, Kansas

WELL PLUGGING RECORD

Graham County. Sec. 2 Twp. 10 Rge. 25 (E) (W)

Location as "NE/CNW/SW" or footage from lines C SE SW

Lease Owner Knight Casing Pulling Company

Lease Name V. Rome Well No. 1

Office Address Chase, Kansas

Character of Well (completed as Oil, Gas or Dry Hole) _____

Date well completed _____ 19 _____

Application for plugging filed _____ 19 _____

Application for plugging approved _____ 19 _____

Plugging commenced 2/7/67 _____ 19 _____

Plugging completed 2/10/67 _____ 19 _____

Reason for abandonment of well or producing formation depleted.

If a producing well is abandoned, date of last production _____ 19 _____

Was permission obtained from the Conservation Division or its agents before plugging was commenced? yes

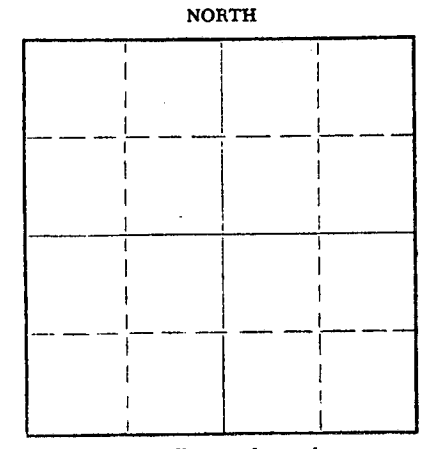

Locate well correctly on above Section Plat

Name of Conservation Agent who supervised plugging of this well Nicholes

Producing formation _____ Depth to top _____ Bottom _____ Total Depth of Well 3978 Feet

Show depth and thickness of all water, oil and gas formations.

OIL, GAS OR WATER RECORDS

CASING RECORD

FORMATION	CONTENT	FROM	TO	SIZE	PUT IN	PULLED OUT
				8 5/8	200	none
				4 1/2	3978	1694

Describe in detail the manner in which the well was plugged, indicating where the mud fluid was placed and the method or methods used in introducing it into the hole. If cement or other plugs were used, state the character of same and depth placed, from _____ feet to _____ feet for each plug set.

Rigged up and pulled rods, pulled tubing. Cleaned cellar, sanded hole to 3965'. Set 3 sacks of cement. Rigged up on 4 1/2", loaded hole with water. Shot pipe at 2898', 2482', 1985', broke high pressure oil line. Shot pipe at 1889', 1794', 1697', got pipe loose and pulled pipe. Loaded trailer, set rock bridge at 200' and ran 3 yards of ready mix.

PLUGGING COMPLETE.

RECEIVED
STATE CORPORATION COMMISSION
3-13-1967
MAR 13 1967

CONSERVATION DIVISION
Wichita, Kansas

(If additional description is necessary, use BACK of this sheet)

Name of Plugging Contractor KNIGHT CASING PULLING COMPANY
Address CHASE, KANSAS

STATE OF KANSAS COUNTY OF RICE, ss.
NOEL J. KNIGHT (employee of owner) or (owner or operator) of the above-described

well, being first duly sworn on oath, says: That I have knowledge of the facts, statements, and matters herein contained and the log of the above-described well as filed and that the same are true and correct. So help me God.

(Signature) [Signature]
CHASE, KANSAS
(Address)

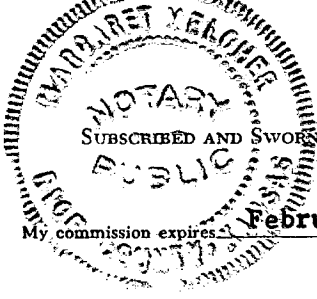

to before me this 9th day of March, 19 67

Margaret Melcher
Notary Public.

TEXACO INC.—LOG OF WELL

Tulsa DIVISION

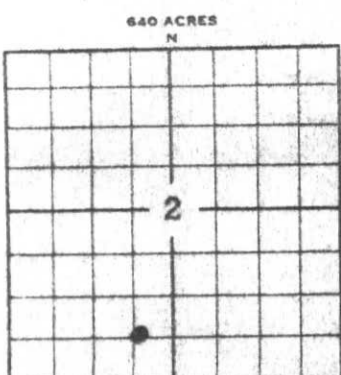

WELL Veronica Rome #1 L. D. FILE NO. 221947
 LOC. tr SE SW SEC. 2 TWP. 10S RGE. 25W
 DIST. Wichita CO. PARISH Graham STATE Kansas
 COMM. DRLG. 8-29-62 COMP. DRLG. 9-4-62 DAYS DRLG. 7
 ROT. FROM 0 TO 3976 CABLE FROM _____ TO _____
 CONTR. OR CO. RIG NO. _____ T. D. DRILLED 3976
 COMP. T. D. 3954 ZERO ELEV. BH-KB 6.6' GRD. ELEV. 2474 CSG. FLG. ELEV. _____
 DATE OF FIRST PROD. 9-11-62 OFFICIAL COMP. DATE 10-20-62
 LOGS RUN Gamma Laterolog, sonic and micro laterolog

CASING RECORD

SIZE INCHES	DEPTH FEET	WEIGHT #/FT.	GRADE	RANGE	REMARKS—QUAN. CMT., TEMP. SURV., ETC.
8-5/8	210	22.7#	SW		Set & cmtd 8-5/8" casing @ 210' w/150 sx HA-5. Cmt circ.
4-1/2	3978	10.5#	J-55		Set & cmtd 4-1/2" csg @ 3978' w/125 sx salt sat Pozmix. Casing Centralizers 3967 3905 3810 3734 2130 200

COMPLETION DATA

FORMATION	<u>Lensing</u>		
DATE OF TEST	<u>10-20-62</u>		
DEPTH OF PROD. INTERVAL	<u>3923-27</u>		
INITIAL PRODUCTION:	OIL - BPD	<u>5 BO/24 hrs</u>	
	GAS - MCF		
	WATER - BPD	<u>3-1/2 BSW</u>	
	GOR		
	BHP - PSI		
CORRECTED API GRAVITY	<u>39.3°</u>		
PRODUCING CONDITIONS	<u>Pump</u>		
ARTIFICIAL STIMULATION	<u>6250 Gal. Acid</u>		

RECEIVED
 STATE CORPORATION COMMISSION
 12-12-1966
 DEC 12 1966
 CONSERVATION DIVISION
 Wichita, Kansas

(1) 2.40
 (2) 600.00
 480.00

REMARKS

*1. ...
 2. ...
 3. ...*

WELL Veronica Rome #1 FIELD Elrick AREA Hays

DRILLER'S WELL LOG

OPERATOR: **TEXACO, INC.**
P. O. Box 2420
Tulsa 2, Oklahoma

WELL NAME: **Veronica Rome #1**
LOCATION: **C SE SW 2-108-25W**
Graham County, Kansas

CONTRACTOR: **K&E DRILLING, INC.**
719 UNION CENTER BLDG.
WICHITA, KANSAS

COMMENCED: **8-29-62**
COMPLETED: **9-5-62**
ELEVATION:

CASING RECORD: **8-5/8" @ 210' w/150 sx.**
4-1/2" @ 3977' w/125 sx.

ROTARY TOTAL DEPTH: **3978**

PRODUCTION:

FORMATION RECORD

Depths shown indicate bottom of formations encountered.

Sand & Clay	125
Shale	1160
Sand	1220
Shale & Sand Str.	1465
Shale & Red Bed	2110
Anhydrite	2147
Shale & Shells	2745
Lime & Shale	3610
Lime	3978 RTD

RECEIVED
STATE CORPORATION COMMISSION
12-12-1966
DEC 12 1966
CONSERVATION DIVISION
Wichita, Kansas

CERTIFICATION

State of KANSAS
County of SEDGWICK } ss:

I, H. L. Wilson, of K&E DRILLING, INC., upon oath state that the above and foregoing is a true and correct copy of the Driller's Log of the above named well.

Subscribed and sworn to before me this 11th day of September, 1962

My Commission expires August 30, 1965

H. L. Wilson
H. L. Wilson
Julene M. Bannon
Julene M. Bannon
Notary Public.

