

NOTICE OF INTENTION TO DRILL

Must be approved by the K.C.C. five (5) days prior to commencing well

Expected Spud Date November 4 1991
month day year

SE NW SE Sec 24 Twp 12 S, Rg 22 XX West

OPERATOR: License # 30676
Name: Pioneer Oil and Gas
Address: 6925 Union Park Center, Suite 145
City/State/Zip: Midvale, UT 84047
Contact Person: Jason G. Blake
Phone: (801) 566-3000 FAX (801) 566-3023

1650 feet from South line of Section
1650 feet from East line of Section
(Note: Locate well on Section Plat on Reverse Side)

CONTRACTOR: License #: Unknown at this time - will
Name: notify on the ACO-1

County: Trego
Lease Name: Sherfick So. Well #: 24-66
Field Name: Sherfick South Extension

Well Drilled For: Well Class: Type Equipment:
XX Oil ... Inj XX Infield XX Mud Rotary
... Gas ... Storage ... Pool Ext. ... Air Rotary
... OWWO ... Disposal ... Wildcat ... Cable
... Seismic; ... # of Holes

Is this a Prorated Field? ... yes XX no
Target Formation(s): Lansing, Marmaton, Arbuckle
Nearest lease or unit boundary: 990 feet
Ground Surface Elevation: 2343 (est) feet MSL

If OWWO: old well information as follows:
Operator: N/A
Well Name: _____
Comp. Date: _____ Old Total Depth _____

Domestic well within 330 feet: ... yes XX no
Municipal well within one mile: ... yes XX no
Depth to bottom of fresh water: 150'
Depth to bottom of usable water: 1000'
Surface Pipe by Alternate: ... 1 XX 2
Length of Surface Pipe Planned to be set: 250 feet
Length of Conductor pipe required: N/A
Projected Total Depth: 4100 feet
Formation at Total Depth: Arbuckle
Water Source for Drilling Operations:
... well ... farm pond XX other

Directional, Deviated or Horizontal wellbore? ... yes XX no
If yes, total depth location: _____

DWR Permit #: N/A
Will Cores Be Taken?: ... yes XX no
If yes, proposed zone: _____

AFFIDAVIT

The undersigned hereby affirms that the drilling, completion and eventual plugging of this well will comply with K.S.A. 55-101, et. seq.

It is agreed that the following minimum requirements will be met:

1. The appropriate district office shall be notified before setting surface pipe;
2. The minimum amount of surface pipe as specified above shall be set by circulating cement to the top; in all cases surface pipe shall be set through all unconsolidated materials plus a minimum of 20 feet into the underlying formation;
3. If the well is dry, a plugging proposal shall be submitted to the district office. An agreement between the operator and the district office on plug length and placement is necessary prior to plugging;
4. The appropriate district office will be notified before well is either plugged or production casing is cemented in;
5. If an Alternate II completion, production pipe shall be cemented from below any usable water to surface within 120 days of spud date. In all cases, notify district office prior to any cementing.

I hereby certify that the statements made herein are true and to the best of my knowledge and belief.

Date: 10/23/91 Signature of Operator or Agent: Jason G. Blake Title: Field Operations Mgr.

FOR KCC USE:	
API # 15- <u>195-22,097</u>	
Conductor pipe required <u>None</u> feet	
Minimum surface pipe required <u>250</u> feet per Alt. • ②	
Approved by: <u>mw 10-25-91</u>	
EFFECTIVE DATE: <u>10-30-91</u>	
This authorization expires: <u>4-25-92</u>	
(This authorization void if drilling not started within 6 months of effective date.)	
Spud date: _____	Agent: _____

RECEIVED
KANSAS CORPORATION COMMISSION
OCT 24 1991
CONSERVATION DIVISION
WICHITA, KS

211 12 22W

REMEMBER TO:

- File Drill Pit Application (form CDP-1) with Intent to Drill;
- File Completion Form ACO-1 within 120 days of spud date;
- File acreage attribution plat according to field proration orders;
- Notify appropriate district office 48 hours prior to workover or re-entry;
- Submit plugging report (CP-4) after plugging is completed;
- Obtain written approval before disposing or injecting salt water.

PLAT OF ACREAGE ATTRIBUTABLE TO A WELL

State Corporation Commission, Conservation Division
200 Colorado Derby Bldg. Wichita, Kansas 67202

OPERATOR Pioneer Oil and Gas LOCATION OF WELL:
 LEASE Sherfick South 1650 feet north of SE corner
 WELL NUMBER 24-66 1650 feet west of SE corner
 FIELD Sherfick South Extension Sec. 24 T 12 S R 22 E/W
 COUNTY Trego
 NO. OF ACRES ATTRIBUTABLE TO WELL 10 IS SECTION XX REGULAR IRREGULAR?
 DESCRIPTION OF ACREAGE SE NW SE IF IRREGULAR, LOCATE WELL FROM NEAREST
 CORNER BOUNDARY.

NOTE: If plat depicted is insufficient for your circumstances, you may attach your own scaled or surveyed plat.

PLAT
1 section

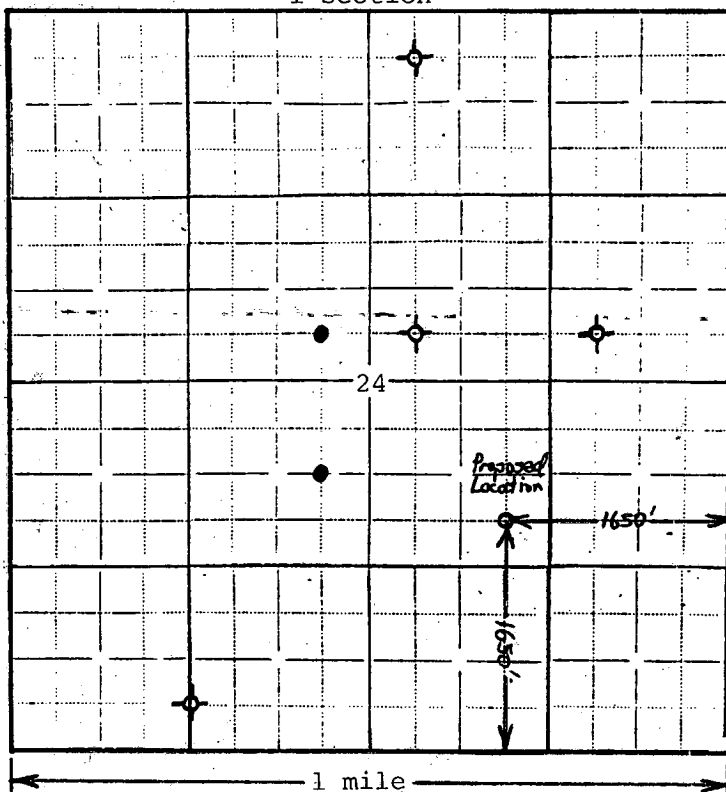

In plotting the proposed location of the well, you must show:

- 1) The manner in which you are using the depicted plat by identifying section lines, i.e. 1 section, 1 section with 8 surrounding partial sections, 4 sections, 16 sections, etc.;
- 2) the well's location relative to the location of other wells producing from the same common source of supply in adjoining drilling units, pursuant to K.A.R. 82-3-108, 82-3-207, 82-3-312, or special orders of the Commission;
- 3) the distance of the proposed drilling location from the section's east and south lines; and
- 4) the distance to the nearest lease or unit boundary line.

I hereby certify that the statements made herein are true and to the best of my knowledge and belief.

Signature of Operator or Agent *James Bluh*
 Date 10/23/91 Title Field Operations Manager