

15-065-02643-00-00

STATE OF KANSAS  
STATE CORPORATION COMMISSION

WELL PLUGGING RECORD

Give All Information Completely  
Make Required Affidavit  
Mail or Deliver Report to:  
Conservation Division  
State Corporation Commission  
212 North Market, Insurance Bldg.  
Wichita, Kansas

Graham County. Sec. 2 Twp. 10s Rge. 22w (E) (W)  
Location as "NE/CNW%SW%" or footage from lines E/2 E/2 NE  
Lease Owner John O. Farmer, Inc.  
Lease Name Brassfield "B" Well No. 1  
Office Address P.O. Box 352, 370 West Wichita, Russell, Kansas  
Character of Well (completed as Oil, Gas or Dry Hole) Dry Hole  
Date well completed 4/7 19 63  
Application for plugging filed 4/7 19 63  
Application for plugging approved 4/7 19 63  
Plugging commenced 4/7 19 63  
Plugging completed 9:30 A. M. 4/7 19 63  
Reason for abandonment of well or producing formation Dry hole

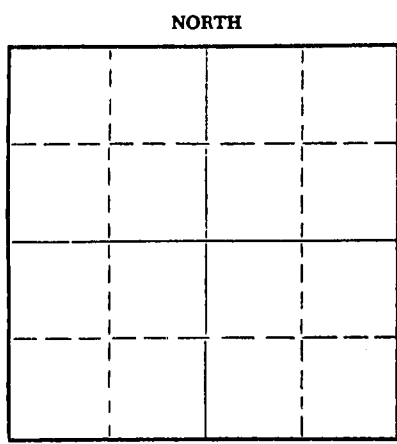

Locate well correctly on above  
Section Plat

If a producing well is abandoned, date of last production 19  
Was permission obtained from the Conservation Division or its agents before plugging was commenced? Yes

Name of Conservation Agent who supervised plugging of this well W. L. Nichols  
Producing formation \_\_\_\_\_ Depth to top \_\_\_\_\_ Bottom \_\_\_\_\_ Total Depth of Well 3725 Feet  
Show depth and thickness of all water, oil and gas formations.

OIL, GAS OR WATER RECORDS

CASING RECORD

FORMATION	CONTENT	FROM	TO	SIZE	PUT IN	PULLED OUT

Describe in detail the manner in which the well was plugged, indicating where the mud fluid was placed and the method or methods used in introducing it into the hole. If cement or other plugs were used, state the character of same and depth placed, from \_\_\_\_\_ feet to \_\_\_\_\_ feet for each plug set.

Plug # 1 @ 540' w/ 20 sx. cement  
# 2 @ 150' w/ 20 sx. cement  
# 3 @ 30' w/ 8 sx. cement

Completed 9:30 A.M. 4/7/63

RECEIVED  
STATE CORPORATION COMMISSION  
4-15-63  
APR 15 1963

CONSERVATION DIVISION  
Wichita, Kansas

Name of Plugging Contractor John O. Farmer, Inc.  
Address P.O. Box 352, Russell, Kansas

STATE OF KANSAS, COUNTY OF RUSSELL, ss.  
John O. Farmer (employee of owner) or (owner or operator) of the above-described

well, being first duly sworn on oath, says: That I have knowledge of the facts, statements, and matters herein contained and the log of the above-described well as filed and that the same are true and correct. So help me God.

(Signature) John O. Farmer  
P.O. Box 352, Russell, Kansas (Address)

SUBSCRIBED AND SWORN TO before me this 12th day of April, 19 63

My commission expires February 15, 1967

Helen Carlson Notary Public.

4/15/63  
6909-W

OPERATOR JOHN O. FARMER, INC.

15-065-02643-00-00  
FORMATION RECORD

ADDRESS P.O. Box 352, Russell, Kansas

Give detailed description and thickness of all formation drilled through, contents of sand, whether dry, water, oil or gas.

WELL NO. COUNTY TWP. RGE.

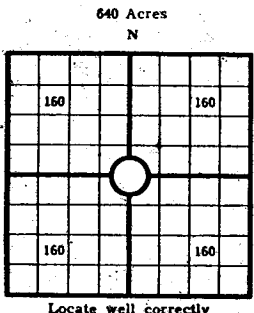

640 Acres  
N  
COUNTY Graham SEC. 2 TWP. 10s RGE. 22W  
COMPANY OPERATING John O. Farmer, Inc.  
OFFICE ADDRESS P.O. Box 352, Russell, Ka.  
DRILLING STARTED 3/28 63 DRILLING FINISHED 4/7 63  
DATE OF FIRST PRODUCTION \_\_\_\_\_ COMPLETED \_\_\_\_\_  
WELL LOCATED E/2 1/4 E/2 1/4 NW 1/4 North of South  
Line and \_\_\_\_\_ ft. East of West Line of Quarter Section  
Elevation (Relative to sea level) DERRICK FLOOR 2307 GROUND 2309  
CHARACTER OF WELL (Oil, gas or dryhole) Dry

OIL OR GAS SANDS OR ZONES

Name	From	To	Name	From	To
1			4		
2			5		
3			6		

Perforating Record If Any

Shot Record

Formation	From	To	No. of Shots	Formation	From	To	Size of Shot

CASING RECORD

Amount Set							Amount Pulled			Packer Record	
Size	Wt.	Ths.	Spoke	Ft.	In.	Fe.	Size	Legals	Depth Set	Make	

Liner Record: Amount \_\_\_\_\_ Kind \_\_\_\_\_ Top \_\_\_\_\_ Bottom \_\_\_\_\_

CEMENTING AND MUDDING

Size	Amount Set		Sacks Cement	Chemical		Method of Cementing	Amount	Mudding Method	Results (See Note)
	Ft.	In.		Gal.	Make				
8 5/8"	164		115						

Note: What method was used to protect sands if outer strings were pulled?

NOTE: Were bottom hole plugs used? If so, state kind, depth set and results obtained

TOOLS USED

Rotary Tools were used from 0 feet to T.D. Cable tools were used from \_\_\_\_\_ feet to \_\_\_\_\_ feet, and from \_\_\_\_\_ feet to \_\_\_\_\_ feet, and from \_\_\_\_\_ feet to \_\_\_\_\_ feet

Type Rig Rotary

INITIAL PRODUCTION TEST

Describe initial test: whether by flow through tubing or casing or by pumping

Amount of Oil Production \_\_\_\_\_ bbls. Size of choke, if any \_\_\_\_\_ Length of test \_\_\_\_\_ Water

Production \_\_\_\_\_ bbls. Gravity of oil \_\_\_\_\_ Type of Pump if pump is used, describe \_\_\_\_\_

Formation	Top	Bottom	Formation	Top	Bottom
Shale	0	370			
Shale & Sand	370	1780			
Lime & Shale	1780	2345			
Shale & Lime	2345	3680			
Lime	3680	3705			
Lime & Shale	3705	3725			
			Log Tops		
			Heebner	3495	(-1186)
			Toronto	3517	(-1203)
			Lansing K.C.	3532	(-1223)
			Total Depth	3721	(-1412)

RECEIVED  
STATE CORPORATION COMMISSION

APR 15 1963  
4-15-1963

CONSERVATION DIVISION  
Wichita, Kansas

I, the undersigned, being first duly sworn upon oath, state that this well record is true, correct and complete according to the records of this office and to the best of my knowledge and belief.

John O. Farmer  
President of representative of company

Subscribed and sworn to before me this 12 day of April, 1963

My Commission expires Feb. 15, 1967

Helen Carlson  
Notary Public