

FOR KCC USE:

15-065-21801-00-02

* PERMIT EXTENSION

CORRECTED

FORM C-1 7/91

FORM MUST BE SIGNED

ALL BLANKS MUST BE FILLED

EFFECTIVE DATE: 12-6-2000

State of Kansas

DISTRICT # 4

NOTICE OF INTENTION TO DRILL

SGA? ... Yes. No

Must be approved by the K.C.C. five (5) days prior to commencing well.

Expected Spud Date ... December 5, 2000 ... month day year

Spot ... East ... Ap SW SE NW SW ... Sec ..30. Twp .10.. S, Rg ..24. X_ West

OPERATOR: License # ...6861

1600 ... feet from South / North line of Section ... 930 ... feet from East / West line of Section IS SECTION X REGULAR IRREGULAR?

Name: ...Ron's Oil Operations

(NOTE: Locate well on the Section Plat on Reverse Side)

Address: ...Rt. 1, Box 194

City/State/Zip: ...Penokee, KS 67659

Contact Person: ...Ron Nickelson

Phone: ...785-421-2315

County: ...Graham

Lease Name: ..Gano ... Well #:1-B

Field Name: ..MARTHA WASHINGTON SE

Is this a Prorated/Spaced Field? ... yes ..X.. no

Target Formation(s): ...Cedar Hill

Nearest lease or unit boundary: ...930'

Ground Surface Elevation: ...2430 EST ... feet MSL

Water well within one-quarter mile: ... yes ..X. no

Public water supply well within one mile: ... yes ..X. no

Depth to bottom of fresh water: ...150'

Depth to bottom of usable water: ...1,180 B./DAKOTA

Surface Pipe by Alternate: ... 1 ..X. 2

Length of Surface Pipe Planned to be set: ...238' SET

Length of Conductor pipe required: ...n/a

Projected Total Depth: ...1900'

Formation at Total Depth: ...Cedar Hill

Water Source for Drilling Operations: ... well ... farm pond ..X. other

Will Cores Be Taken?: ... yes ..X. no

If yes, proposed zone: ...

* API No. WAS REPORTED INCORRECTLY

* CONTRACTOR: License #: ADVISE ON ACO-1 Name: ...unknown

* CONTRACTOR MUST BE LIC. W/KCC

Well Drilled For: Well Class: Type Equipment:

- Oil, Gas, Seismic, etc. options with checkboxes for Infield, Mud Rotary, etc.

If OWWO: old well information as follows:

Operator: ...A. L. Abercrombie, Inc

Well Name: ...Gano #1-B

Comp. Date: ..6-3-83 ... Old Total Depth ...4301'

Directional, Deviated or Horizontal wellbore? ... yes ..X. no

If yes, true vertical depth: ...

Bottom Hole Location: ...

AFFIDAVIT

WAS: 15-065-22804-0000

The undersigned hereby affirms that the drilling, completion and eventual plugging of this well will comply with K.S.A. 55-101, et. seq.

It is agreed that the following minimum requirements will be met:

API No. 15: 15-065-21801-0002

- 1. Notify the appropriate district office prior to spudding of well;
2. A copy of the approved notice of intent to drill shall be posted on each drilling rig;
3. The minimum amount of surface pipe as specified below shall be set by circulating cement to the top;
4. If the well is dry hole, an agreement between the operator and the district office on plug length and placement is necessary prior to plugging;
5. The appropriate district office will be notified before well is either plugged or production casing is cemented in;
6. IF AN ALTERNATE II COMPLETION, PRODUCTION PIPE SHALL BE CEMENTED FROM BELOW ANY USABLE WATER TO SURFACE WITHIN 120 DAYS OF SPUD DATE.

I hereby certify that the statements made herein are true and to the best of my knowledge and belief.

Date: ...11/30/2000 ... Signature of Operator or Agent: Donna Thanda ... Title: ...Agent

RECEIVED KANSAS CORPORATION COMMISSION

NOV 30 2000

CONSERVATION DIVISION WICHITA, KS

FOR KCC USE: API # 15-065-21801-0002 ✓ Conductor pipe required NONE feet Minimum surface pipe required 200 feet per Alt. X(2) Approved by: JK 12-1-2000 / COR 12-6-2000 This authorization expires: 6-1-2001 12-1-2001 *DPW Permit Extension Spud date: Agent:

REMEMBER TO:

- File Drill Pit Application (form CDP-1) with Intent to Drill;
- File Completion Form ACO-1 within 120 days of spud date;
- File acreage attribution plat according to field proration orders;
- Notify appropriate district office 48 hours prior to workover or re-entry;
- Submit plugging report (CP-4) after plugging is completed;
- Obtain written approval before disposing or injecting salt water.

Mail to: KCC - Conservation Division, 130 S. Market - Room 2078, Wichita, Kansas 67202.

30

10

24W

IN ALL CASES PLOT THE INTENDED WELL ON THE PLAT BELOW

PLAT OF ACREAGE ATTRIBUTABLE TO A WELL IN A PRORATED OR SPACED FIELD

If the intended well is in a prorated or spaced field, please fully complete this side of the form. If the intended well is in a prorated or spaced field complete the plat below showing that the well will be properly located in relationship to other wells producing from the common source of supply. Please show all the wells within 1 mile of the boundaries of the proposed acreage attribution unit for gas wells and within 1/2 mile of the boundaries of the proposed acreage attribution unit for oil wells.

API NO. 15- _____
 OPERATOR _____ LOCATION OF WELL: COUNTY _____
 LEASE _____ feet from south/north line of section _____
 WELL NUMBER _____ feet from east/west line of section _____
 FIELD _____ SECTION _____ TWP _____ RG _____

NUMBER OF ACRES ATTRIBUTABLE TO WELL _____ IS SECTION _____ REGULAR or _____ IRREGULAR
 QTR/QTR/QTR OF ACREAGE _____ - _____ - _____ **IF SECTION IS IRREGULAR, LOCATE WELL FROM NEAREST CORNER BOUNDARY.**
 Section corner used: _____ NE _____ NW _____ SE _____ SW

PLAT

(Show location of the well and shade attributable acreage for prorated or spaced wells.)
 (Show footage to the nearest lease or unit boundary line.)

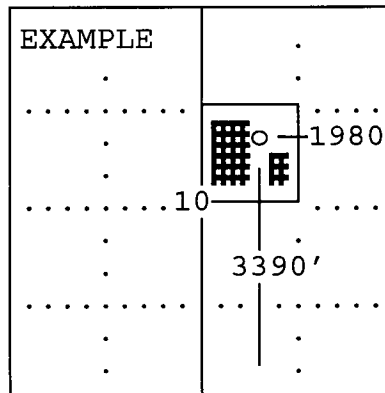
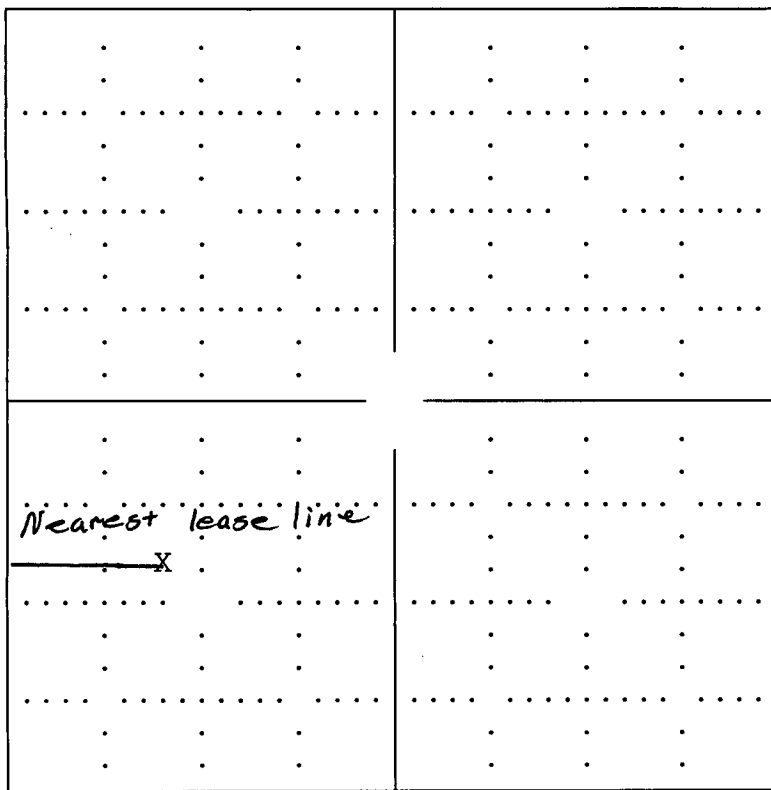

SEWARD CO.

In plotting the proposed location of the well, you must show:

- 1) The manner in which you are using the depicted plat by identifying section lines, i.e. 1 section, 1 section with 8 surrounding sections, 4 sections, etc.;
- 2) the distance of the proposed drilling location from the section's south/north and east/west; and
- 3) the distance to the nearest lease or unit boundary line.

15-065-21801-0002

I am writing this letter in regard to the Sand disposal in 30-10-24 in Graham county. I filed a intent and it expires on 6-1-001 I need to get a 30 day extention or little more either muddy or cant get rig.

Ronsail op. Inc

Ronald Nickelson Pres

api # 065-21801-0002

Ronsail op Inc
1884 200 avenue
Perokke KS 67659

RECEIVED
KANSAS CORPORATION COMMISSION

JUN 1 2001

CONSERVATION DIVISION