

EFFECTIVE DATE: 4-8-95

State of Kansas

FORM MUST BE SIGNED

DISTRICT # 4

NOTICE OF INTENTION TO DRILL

ALL BLANKS MUST BE FILLED

SGA? Yes No

Must be approved by the K.C.C. five (5) days prior to commencing well

Spot NW - SW - SE. Sec 19. Twp 10. S. Rg 24. East West

Expected Spud Date April 20 1995 month day year

990 feet from South / North line of Section 2310 feet from East / West line of Section IS SECTION X REGULAR IRREGULAR

OPERATOR: License # 6037 Name: Staab Oil Co Address: 1607 Hopewell RD City/State/Zip: Hays, KS 67601 Contact Person: Francis C. Staab Phone: 913-625-5013

(NOTE: Locate well on the Section Plat on Reverse Side)

County: Graham Lease Name: Rush Well #: 1 Field Name: M. Washington E.

CONTRACTOR: License #: 5655 Name: Shields Drilling Co

Is this a Prorated/Spaced Field? yes X no Target Formation(s): Lansing-Kansas City

Nearest lease or unit boundary: 990 Ground Surface Elevation: NA EST 2380 feet MSL

Table with columns: Well Drilled For, Well Class, Type Equipment. Includes rows for Oil, Gas, UWVO, Seismic, etc.

Water well within one-quarter mile: yes X no Public water supply well within one mile: yes X no

Depth to bottom of fresh water: 400' / 180' Depth to bottom of usable water: 800' / 1140'

Surface Pipe by Alternate: 1 X 2 Length of Surface Pipe Planned to be set: 200'

Length of Conductor pipe required: N/A Projected Total Depth: 4050'

Formation at Total Depth: Lansing-Kansas City Water Source for Drilling Operations:

If UWVO: old well information as follows: Operator: Well Name: Comp. Date: Old Total Depth:

... well ... farm pond X other DWR Permit #: Running spring water not more than 2 feet deep

Will Cores Be Taken?: yes X no If yes, proposed zone:

Directional, Deviated or Horizontal wellbore? yes X no If yes, true vertical depth: Bottom Hole Location:

AFFIDAVIT

The undersigned hereby affirms that the drilling, completion and eventual plugging of this well will comply with K.S.A. 55-101, et. seq. It is agreed that the following minimum requirements will be met:

- 1. Notify the appropriate district office prior to spudding of well; 2. A copy of the approved notice of intent to drill shall be posted on each drilling rig; 3. The minimum amount of surface pipe as specified below shall be set by circulating cement to the top; in all cases surface pipe shall be set through all unconsolidated materials plus a minimum of 20 feet into the underlying formation; 4. If the well is dry hole, an agreement between the operator and the district office on plug length and placement is necessary prior to plugging; 5. The appropriate district office will be notified before well is either plugged or production casing is cemented in; 6. IF AN ALTERNATE II COMPLETION, PRODUCTION PIPE SHALL BE CEMENTED FROM BELOW ANY USABLE WATER TO SURFACE WITHIN 120 DAYS OF SPUD DATE. IN ALL CASES, NOTIFY DISTRICT OFFICE PRIOR TO ANY CEMENTING.

I hereby certify that the statements made herein are true and to the best of my knowledge and belief. Date: 3-29-95 Signature of Operator or Agent: Francis C. Staab Title: Partner

FOR KCC USE: API # 15-065-22754-0000 Conductor pipe required NONE feet Minimum surface pipe required 300 feet per Alt. X(2) Approved by: DW 4-3-95 This authorization expires: 10-3-95 (This authorization void if drilling not started within 6 months of effective date.) Spud date: Agent:

STATE CORPORATION COMMISSION APR - 3 1995

REMEMBER TO:

- File Drill Pit Application (form CDP-1) with Intent to Drill; - File Completion Form ACO-1 within 120 days of spud date; - File acreage attribution plat according to field proration orders; - Notify appropriate district office 48 hours prior to workover or re-entry; - Submit plugging report (CP-4) after plugging is completed; - Obtain written approval before disposing or injecting salt water.

Mail to: Conservation Division, 200 Colorado Derby Building, 202 W. First St., Wichita, Kansas 67202-1286.

Handwritten numbers: 16, 10, 24w

PLAT OF ACREAGE ATTRIBUTABLE TO A WELL IN A PRORATED OR SPACED FIELD

If the intended well is in a prorated or spaced field, please fully complete this side of the form. If the intended well is in a prorated or spaced field complete the plat below showing that the well will be properly located in relationship to other wells producing from the common source of supply. Please show all the wells within 1 mile of the boundaries of the proposed acreage attribution unit for gas wells and within 1/2 mile of the boundaries of the proposed acreage attribution unit for oil wells.

API NO. 15- _____
 OPERATOR Staab Oil Co.
 LEASE Rush
 WELL NUMBER 1
 FIELD M. Washington East

LOCATION OF WELL: COUNTY Graham
990 feet from south north line of section
2310 feet from east west line of section
 SECTION 19 TWP 10S RG 24W

NUMBER OF ACRES ATTRIBUTABLE TO WELL 160
 QTR/QTR/QTR OF ACREAGE _____

IS SECTION X REGULAR or _____ IRREGULAR
 IF SECTION IS IRREGULAR, LOCATE WELL FROM NEAREST
CORNER BOUNDARY.
 Section corner used: _____ NE _____ NW _____ SE _____ SW

PLAT

(Show location of the well and shade attributable acreage for prorated or spaced wells.)
 (Show footage to the nearest lease or unit boundary line.)

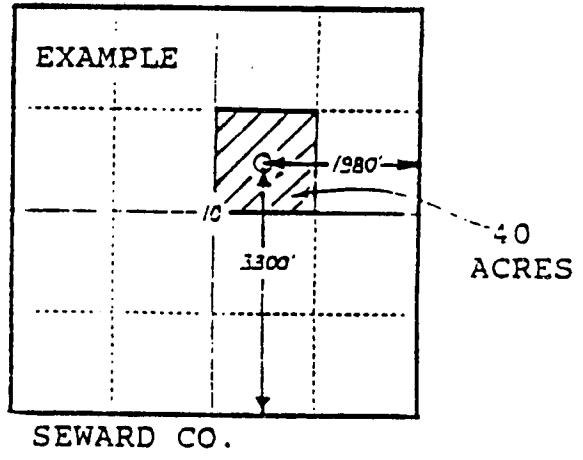
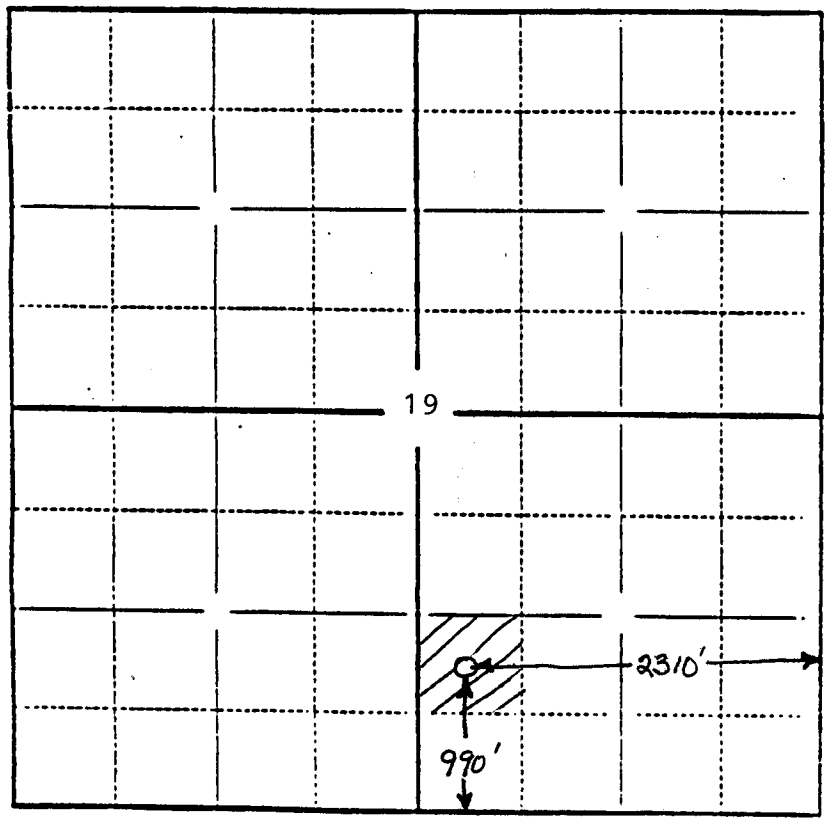

In plotting the proposed location of the well, you must show:

- 1) The manner in which you are using the depicted plat by identifying section lines, i.e. 1 section, 1 section with 8 surrounding sections, 4 sections, etc.;
- 2) the distance of the proposed drilling location from the section's south/north and east/west lines; and
- 3) the distance to the nearest lease or unit boundary line.