

Owwo

For KCC Use: Effective Date: 4-14-2010 District # \_\_\_\_\_ SGA?  Yes  No

KANSAS CORPORATION COMMISSION OIL & GAS CONSERVATION DIVISION

Form C-1 October 2007 Form must be Typed Form must be Signed All blanks must be Filled

NOTICE OF INTENT TO DRILL

Must be approved by KCC five (5) days prior to commencing well

Expected Spud Date: 04/20/2010 month day year

OPERATOR: License# 33839 Name: Robert Hopkins Operations, LLC Address 1: 709 Harold Ave. City: Salina State: Ks Zip: 67401 Contact Person: Robert Hopkins Phone: 785-819-2460 CONTRACTOR: License# 31548 Name: Discovery Drilling

Spot Description: NW SE (a/a/a/a) 2,165 feet from  N /  S Line of Section 1,950 feet from  E /  W Line of Section Is SECTION:  Regular  Irregular?

(Note: Locate well on the Section Plat on reverse side) County: Trego Lease Name: Coffman Well #: 1 Field Name: wildcat Is this a Prorated / Spaced Field?  Yes  No Target Formation(s): Mississippian Nearest Lease or unit boundary line (in footage): 475 feet MSL Ground Surface Elevation: 2327 Water well within one-quarter mile:  Yes  No Public water supply well within one mile:  Yes  No Depth to bottom of fresh water: 100 Depth to bottom of usable water: 600 Surface Pipe by Alternate:  I  II Length of Surface Pipe planned to be set: 204 (already set) Length of Conductor Pipe (if any): n/a Projected Total Depth: 4280 Formation at Total Depth: Mississippian Water Source for Drilling Operations:  Well  Farm Pond  Other: DWR Permit #: (Note: Apply for Permit with DWR)  Will Cores be taken?  Yes  No If Yes, proposed zone: \_\_\_\_\_

Well Drilled For:  Oil  Gas  Enh Rec  Storage  Disposal  Seismic; # of Holes  Other: Well Class:  Infield  Pool Ext.  Wildcat  Other Type Equipment:  Mud Rotary  Air Rotary  Cable  If OWWO: old well information as follows: Operator: Hess Oil Co. Well Name: Joyce #1 Original Completion Date: 3/21/2007 Original Total Depth: 4240

Directional, Deviated or Horizontal wellbore?  Yes  No If Yes, true vertical depth: \_\_\_\_\_ Bottom Hole Location: \_\_\_\_\_ KCC DKT #: \_\_\_\_\_

AFFIDAVIT

The undersigned hereby affirms that the drilling, completion and eventual plugging of this well will comply with K.S.A. 55 et. seq. It is agreed that the following minimum requirements will be met:

- 1. Notify the appropriate district office prior to spudding of well;
2. A copy of the approved notice of intent to drill shall be posted on each drilling rig;
3. The minimum amount of surface pipe as specified below shall be set by circulating cement to the top; in all cases surface pipe shall be set through all unconsolidated materials plus a minimum of 20 feet into the underlying formation.
4. If the well is dry hole, an agreement between the operator and the district office on plug length and placement is necessary prior to plugging;
5. The appropriate district office will be notified before well is either plugged or production casing is cemented in;
6. If an ALTERNATE II COMPLETION, production pipe shall be cemented from below any usable water to surface within 120 DAYS of spud date. Or pursuant to Appendix "B" - Eastern Kansas surface casing order #133,891-C, which applies to the KCC District 3 area, alternate II cementing must be completed within 30 days of the spud date or the well shall be plugged. In all cases, NOTIFY district office prior to any cementing.

I hereby certify that the statements made herein are true and correct to the best of my knowledge and belief. Date: 4/9/2010 Signature of Operator or Agent: Robert Hopkins Title: managing partner

For KCC Use ONLY API # 15 - 195-22440-00-01 Conductor pipe required None feet Minimum surface pipe required 204 feet per ALT.  I  II Approved by: [Signature] 4-9-2010 This authorization expires: 4-9-2011 (This authorization void if drilling not started within 12 months of approval date.) Spud date: \_\_\_\_\_ Agent: \_\_\_\_\_

Remember to: - File Drill Pit Application (form GDP-1) with Intent to Drill; - File Completion Form ACO-1 within 120 days of spud date; - File acreage attribution plat according to field proration orders; - Notify appropriate district office 48 hours prior to workover or re-entry; - Submit plugging report (CP-4) after plugging is completed (within 60 days); - Obtain written approval before disposing or injecting salt water. - If this permit has expired (See: authorized expiration date) please check the box below and return to the address below.  Well Not Drilled - Permit Expired Date: \_\_\_\_\_ Signature of Operator or Agent: \_\_\_\_\_

RECEIVED APR 09 2010 KCC WICHITA

4 14 22

**IN ALL CASES PLOT THE INTENDED WELL ON THE PLAT BELOW**

*Plat of acreage attributable to a well in a prorated or spaced field*

**If the intended well is in a prorated or spaced field, please fully complete this side of the form.** If the intended well is in a prorated or spaced field complete the plat below showing that the well will be properly located in relationship to other wells producing from the common source of supply. Please show all the wells and within 1 mile of the boundaries of the proposed acreage attribution unit for gas wells and within 1/2 mile of the boundaries of the proposed acreage attribution unit for oil wells.

API No. 15 - 195-22440-00-01  
Operator: Robert Hopkins Operations, LLC  
Lease: Coffman  
Well Number: 1  
Field: wildcat

Location of Well: County: Trego  
2,165 feet from  N /  S Line of Section  
1,950 feet from  E /  W Line of Section  
Sec. 4 Twp. 14 S. R. 22  E  W

Number of Acres attributable to well: \_\_\_\_\_  
QTR/QTR/QTR/QTR of acreage: \_\_\_\_\_ - \_\_\_\_\_ - NW - SE

Is Section:  Regular or  Irregular

**If Section is Irregular, locate well from nearest corner boundary.**  
Section corner used:  NE  NW  SE  SW

**PLAT**

*(Show location of the well and shade attributable acreage for prorated or spaced wells.)  
(Show footage to the nearest lease or unit boundary line.)*

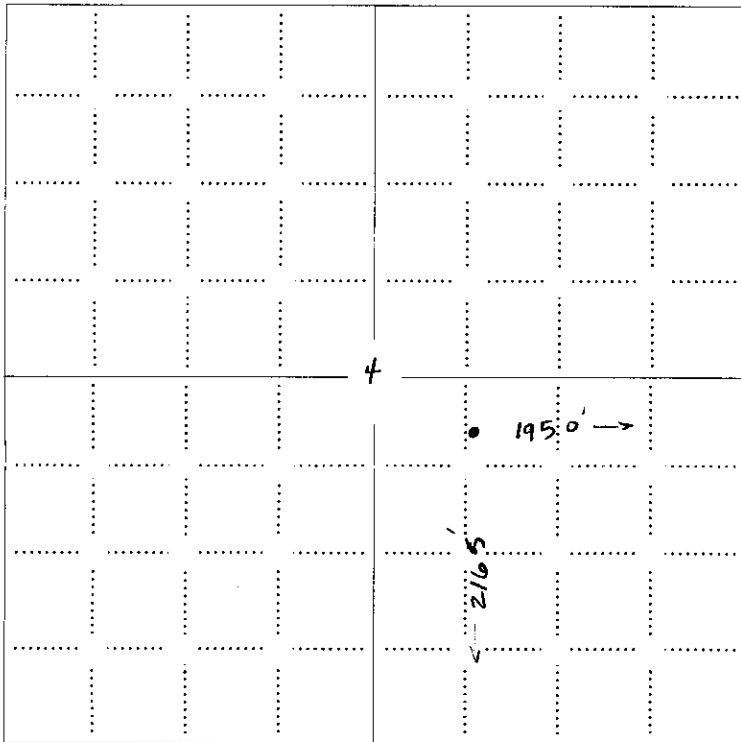

RECEIVED  
APR 09 2010  
KCC WICHITA

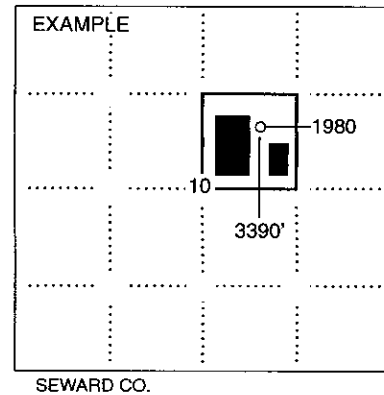

**NOTE: In all cases locate the spot of the proposed drilling location.**

**In plotting the proposed location of the well, you must show:**

1. The manner in which you are using the depicted plat by identifying section lines, i.e. 1 section, 1 section with 8 surrounding sections, 4 sections, etc.
2. The distance of the proposed drilling location from the south / north and east / west outside section lines.
3. The distance to the nearest lease or unit boundary line (in footage).
4. If proposed location is located within a prorated or spaced field a certificate of acreage attribution plat must be attached: (CO-7 for oil wells; CG-8 for gas wells).

**KANSAS CORPORATION COMMISSION  
OIL & GAS CONSERVATION DIVISION  
APPLICATION FOR SURFACE PIT**

Form CDP-1  
April 2004  
Form must be Typed

*Submit in Duplicate*

Operator Name: <b>Robert Hopkins Operations, LLC</b>		License Number: <b>33839</b>
Operator Address: <b>709 Harold Ave.</b>		<b>Salina Ks 67401</b>
Contact Person: <b>Robert Hopkins</b>		Phone Number: <b>785-819-2460</b>
Lease Name & Well No.: <b>Coffman 1</b>		Pit Location (QQQQ): _____ NW _____ SE
Type of Pit: <input type="checkbox"/> Emergency Pit <input type="checkbox"/> Burn Pit <input type="checkbox"/> Settling Pit <input checked="" type="checkbox"/> Drilling Pit <input type="checkbox"/> Workover Pit <input type="checkbox"/> Haul-Off Pit <small>(If WP Supply API No. or Year Drilled)</small>	Pit is: <input checked="" type="checkbox"/> Proposed <input type="checkbox"/> Existing If Existing, date constructed: _____ Pit capacity: <b>3,000</b> (bbls)	Sec. <b>4</b> Twp. <b>14</b> R. <b>22</b> <input type="checkbox"/> East <input checked="" type="checkbox"/> West <b>2,450</b> <sup><b>2165</b></sup> Feet from <input type="checkbox"/> North / <input checked="" type="checkbox"/> South Line of Section <b>1,950</b> Feet from <input checked="" type="checkbox"/> East / <input type="checkbox"/> West Line of Section <b>Trego</b> _____ County
Is the pit located in a Sensitive Ground Water Area? <input type="checkbox"/> Yes <input checked="" type="checkbox"/> No		Chloride concentration: _____ mg/l <small>(For Emergency Pits and Settling Pits only)</small>
Is the bottom below ground level? <input checked="" type="checkbox"/> Yes <input type="checkbox"/> No	Artificial Liner? <input type="checkbox"/> Yes <input checked="" type="checkbox"/> No	How is the pit lined if a plastic liner is not used? <b>compacted clay soil</b>
Pit dimensions (all but working pits): <u>70</u> Length (feet) <u>70</u> Width (feet) <input type="checkbox"/> N/A: Steel Pits Depth from ground level to deepest point: <u>5</u> (feet) <input type="checkbox"/> No Pit		
If the pit is lined give a brief description of the liner material, thickness and installation procedure.		Describe procedures for periodic maintenance and determining liner integrity, including any special monitoring.  <b>RECEIVED APR 09 2010 KCC WICHITA</b>
Distance to nearest water well within one-mile of pit <u>none</u> feet    Depth of water well _____ feet	Depth to shallowest fresh water <u>30</u> feet. Source of information: <input type="checkbox"/> measured <input type="checkbox"/> well owner <input type="checkbox"/> electric log <input checked="" type="checkbox"/> KDWR	
<b>Emergency, Settling and Burn Pits ONLY:</b> Producing Formation: _____ Number of producing wells on lease: _____ Barrels of fluid produced daily: _____ Does the slope from the tank battery allow all spilled fluids to flow into the pit? <input type="checkbox"/> Yes <input type="checkbox"/> No	<b>Drilling, Workover and Haul-Off Pits ONLY:</b> Type of material utilized in drilling/workover: <u>bentonite gel mud</u> Number of working pits to be utilized: <u>3</u> Abandonment procedure: <u>allow liquid to evaporate; let cuttings dry, then backfill</u> Drill pits must be closed within 365 days of spud date.	
I hereby certify that the above statements are true and correct to the best of my knowledge and belief.		
<u>4/9/2010</u> Date	 Signature of Applicant or Agent	

15-195-22440-00-01

<b>KCC OFFICE USE ONLY</b>		Steel Pit <input type="checkbox"/>	RFAC <input type="checkbox"/>	RFAS <input type="checkbox"/>
Date Received: <u>4/9/10</u>	Permit Number: _____	Permit Date: <u>4/9/10</u>	Lease Inspection: <input type="checkbox"/> Yes <input checked="" type="checkbox"/> No	

Mail to: KCC - Conservation Division, 130 S. Market - Room 2078, Wichita, Kansas 67202

Notice: Fill out COMPLETELY and return to Conservation Division at the address below within 60 days from plugging date.

KANSAS CORPORATION COMMISSION  
OIL & GAS CONSERVATION DIVISION  
WELL PLUGGING RECORD  
K.A.R. 82-3-117

Form CP-4  
December 2003  
Type or Print on this Form  
Form must be Signed  
All blanks must be Filled

Lease Operator: Hess Oil Company  
Address: P. O. Box 1009, McPherson, KS 67460  
Phone: (620) 241-4640 Operator License #: 5663  
Type of Well: D&A Docket #: \_\_\_\_\_  
(Oil, Gas D&A, SWD, ENHR, Water Supply Well, Cathodic, Other) (If SWD or ENHR)  
The plugging proposal was approved on: \_\_\_\_\_ (Date)  
by: \_\_\_\_\_ (KCC District Agent's Name)  
Is ACO-1 filed?  Yes  No If not, is well log attached?  Yes  No  
Producing Formation(s): List All (If needed attach another sheet)  
\_\_\_\_\_  
Depth to Top: \_\_\_\_\_ Bottom: \_\_\_\_\_ T.D. \_\_\_\_\_  
\_\_\_\_\_  
Depth to Top: \_\_\_\_\_ Bottom: \_\_\_\_\_ T.D. \_\_\_\_\_  
\_\_\_\_\_  
Depth to Top: \_\_\_\_\_ Bottom: \_\_\_\_\_ T.D. \_\_\_\_\_

API Number: 15 - 195-22,440-00-00  
Lease Name: Joyce  
Well Number: 1  
Spot Location (QQQQ): Appx - C - NW - SE  
2105 2115 2105 Feet from  North /  South Section Line Int  
1950 Feet from  East /  West Section Line  
Sec. 4 Twp. 14 S. R. 22  East  West  
County: Trego  
Date Well Completed: 3/21/07  
Plugging Commenced: 3/21/07  
Plugging Completed: 3/21/07

Show depth and thickness of all water, oil and gas formations.

Oil, Gas or Water Records		Casing Record (Surface Conductor & Production)				
Formation	Content	From	To	Size	Put In	Pulled Out
surface		204'	0'	8-5/8"	204'	none

Describe in detail the manner in which the well is plugged, indicating where the mud fluid was placed and the method or methods used in introducing it into the hole. If cement or other plugs were used, state the character of same depth placed from (bottom), to (top) for each plug set.

Plugged hole w/200 sx 60/40 pozmix, 6% gel, 1/4# floeal per sack as follows: 25 sx @ 1800', 100 sx @ 880', 40 sx @ 260', 10 sx @ 40', 15 sx RH, 10 sx MH. PD @ 2:30 pm 3-21-07.

Name of Plugging Contractor: Mallard JV, Inc. License #: 4958  
Address: P. O. Box 1009, McPherson, KS 67460  
Name of Party Responsible for Plugging Fees: Hess Oil Company  
State of Kansas County, McPherson, ss.  
Bryan Hess, President

(Employee of Operator) or (Operator) on above-described well, first duly sworn on oath, says: That I have knowledge of the facts statements, and matters herein contained, and the log of the above-described well, and the same are true and correct, so help me God.

(Signature) Bryan Hess  
(Address) same

RECEIVED  
KANSAS CORPORATION COMMISSION

APR 17 2007

CONSERVATION DIVISION  
WICHITA, KS

SUBSCRIBED and SWORN TO before me this 16th day of April

Carol A. Nickel  
Notary Public

My Commission Expires: \_\_\_\_\_

NOTARY PUBLIC  
STATE OF KANSAS  
Carol A. Nickel  
My Appt Expires 6-1-09

Mail to: KCC - Conservation Division, 130 S. Market - Room 2078, Wichita, Kansas 67202

PPF