

Copy Sent 4/19/10

For KCC Use: 4-27-2010
Effective Date: 3
District # 3
SGA? Yes No

KANSAS CORPORATION COMMISSION
OIL & GAS CONSERVATION DIVISION
NOTICE OF INTENT TO DRILL
Must be approved by KCC five (5) days prior to commencing well

Form C-1
October 2007
Form must be Typed
Form must be Signed
All blanks must be Filled

Expected Spud Date: 4/19/10
month day year

OPERATOR: License# 30345
Name: Piqua Petro., Inc.
Address 1: 1331 Xylan Road
Address 2: _____
City: Piqua State: KS Zip: 66761
Contact Person: Greg Lair
Phone: 620-433-0099
CONTRACTOR: License# 32079
Name: John E Leis

Spot Description:
NE SE SE Sec. 16 Twp. 25 S. R. 17 E W
(0000) 950 feet from N / S Line of Section
530 feet from E / W Line of Section

Is SECTION: Regular Irregular?

(Note: Locate well on the Section Plat on reverse side)

County: Woodson

Lease Name: Collins-Bennett Well #: 14-10

Field Name: Humboldt-Chanute

Is this a Prorated / Spaced Field? Yes No

Target Formation(s): Squirrel

Nearest Lease or unit boundary line (in footage): 520'

Ground Surface Elevation: N/A feet MSL

Water well within one-quarter mile: Yes No

Public water supply well within one mile: Yes No

Depth to bottom of fresh water: 125'

Depth to bottom of usable water: 200'

Surface Pipe by Alternate: I II

Length of Surface Pipe Planned to be set: 20'

Length of Conductor Pipe (if any): none

Projected Total Depth: 1200'

Formation at Total Depth: Squirrel

Water Source for Drilling Operations:
 Well Farm Pond Other: _____

DWR Permit #: _____

(Note: Apply for Permit with DWR)

Will Cores be taken? Yes No

If Yes, proposed zone: _____

RECEIVED
KANSAS CORPORATION COMMISSION

APR 21 2010

CONSERVATION DIVISION
WICHITA, KS

AFFIDAVIT

The undersigned hereby affirms that the drilling, completion and eventual plugging of this well will comply with K.S.A. 55 et. seq.
It is agreed that the following minimum requirements will be met:

1. Notify the appropriate district office **prior** to spudding of well;
2. A copy of the approved notice of intent to drill **shall be** posted on each drilling rig;
3. The minimum amount of surface pipe as specified below **shall be set** by circulating cement to the top; in all cases surface pipe **shall be set** through all unconsolidated materials plus a minimum of 20 feet into the underlying formation.
4. If the well is dry hole, an agreement between the operator and the district office on plug length and placement is necessary **prior to plugging**;
5. The appropriate district office will be notified before well is either plugged or production casing is cemented in;
6. If an ALTERNATE II COMPLETION, production pipe shall be cemented from below any usable water to surface within **120 DAYS** of spud date.
Or pursuant to Appendix "B" - Eastern Kansas surface casing order #133,891-C, which applies to the KCC District 3 area, alternate II cementing must be completed within 30 days of the spud date or the well shall be plugged. **In all cases, NOTIFY district office** prior to any cementing.

I hereby certify that the statements made herein are true and correct to the best of my knowledge and belief.

Date: 4/16/10 Signature of Operator or Agent: Judith Roman Title: Secretary/Treasurer

For KCC Use ONLY

API # 15 - 207-27602-00-00

Conductor pipe required None feet

Minimum surface pipe required 20 feet per ALT. I II

Approved by: 4-22-2010

This authorization expires: 4-22-2011
(This authorization void if drilling not started within 12 months of approval date.)

Spud date: _____ Agent: _____

Remember to:

- File Drill Pit Application (form CDP-1) with Intent to Drill;
- File Completion Form ACO-1 within 120 days of spud date;
- File acreage attribution plat according to field proration orders;
- Notify appropriate district office 48 hours prior to workover or re-entry;
- Submit plugging report (CP-4) after plugging is completed (within 60 days);
- Obtain written approval before disposing or injecting salt water.
- If this permit has expired (See: authorized expiration date) please check the box below and return to the address below.

Well Not Drilled - Permit Expired Date: _____
Signature of Operator or Agent: _____

16
25
17
 E W

IN ALL CASES PLOT THE INTENDED WELL ON THE PLAT BELOW

Plat of acreage attributable to a well in a prorated or spaced field

If the intended well is in a prorated or spaced field, please fully complete this side of the form. If the intended well is in a prorated or spaced field complete the plat below showing that the well will be properly located in relationship to other wells producing from the common source of supply. Please show all the wells and within 1 mile of the boundaries of the proposed acreage attribution unit for gas wells and within 1/2 mile of the boundaries of the proposed acreage attribution unit for oil wells.

API No. 15 - 207-27602-00-00
 Operator: Piqua Petro., Inc.
 Lease: Collins-Bennett
 Well Number: 14-10
 Field: Humboldt-Chanute

Location of Well: County: Woodson
 950 feet from N / S Line of Section
 530 feet from E / W Line of Section
 Sec. 16 Twp. 25 S. R. 17 E W

Number of Acres attributable to well: _____
 QTR/QTR/QTR/QTR of acreage: NE - NE - SE - SE

Is Section: Regular or Irregular

If Section is Irregular, locate well from nearest corner boundary.
 Section corner used: NE NW SE SW

PLAT

*(Show location of the well and shade attributable acreage for prorated or spaced wells.)
 (Show footage to the nearest lease or unit boundary line.)*

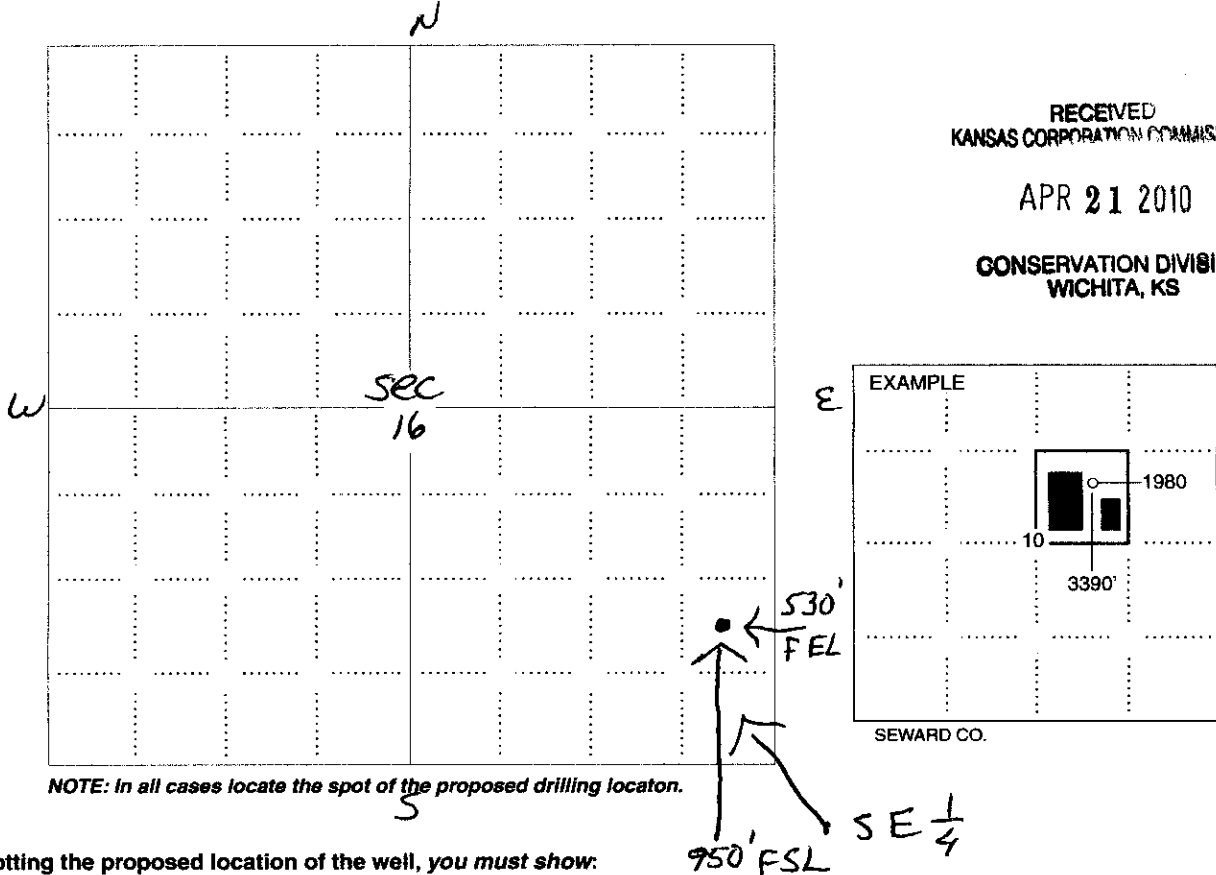

NOTE: In all cases locate the spot of the proposed drilling location.

In plotting the proposed location of the well, you must show:

1. The manner in which you are using the depicted plat by identifying section lines, i.e. 1 section, 1 section with 8 surrounding sections, 4 sections, etc.
2. The distance of the proposed drilling location from the south / north and east / west outside section lines.
3. The distance to the nearest lease or unit boundary line (in footage).
4. If proposed location is located within a prorated or spaced field a certificate of acreage attribution plat must be attached: (CO-7 for oil wells; CG-8 for gas wells).

**KANSAS CORPORATION COMMISSION
OIL & GAS CONSERVATION DIVISION
APPLICATION FOR SURFACE PIT**

Form CDP-1
April 2004
Form must be Typed

Submit in Duplicate

Operator Name: Piqua Petro., Inc.		License Number: 30345
Operator Address: 1331 Xylan Road		Piqua KS 66761
Contact Person: Greg Lair		Phone Number: 620-433-0099
Lease Name & Well No.: Collins-Bennett 14-10		Pit Location (QQQQ): NE ^{SE} NE SE
Type of Pit: <input type="checkbox"/> Emergency Pit <input type="checkbox"/> Burn Pit <input type="checkbox"/> Settling Pit <input checked="" type="checkbox"/> Drilling Pit <input type="checkbox"/> Workover Pit <input type="checkbox"/> Haul-Off Pit <small>(If WP Supply API No. or Year Drilled)</small>	Pit is: <input checked="" type="checkbox"/> Proposed <input type="checkbox"/> Existing If Existing, date constructed: _____ Pit capacity: _____ (bbls)	Sec. <u>16</u> Twp. <u>25</u> R. <u>17</u> <input checked="" type="checkbox"/> East <input type="checkbox"/> West 950 Feet from <input type="checkbox"/> North / <input checked="" type="checkbox"/> South Line of Section 520 ⁵³⁰ Feet from <input checked="" type="checkbox"/> East / <input type="checkbox"/> West Line of Section Woodson County
Is the pit located in a Sensitive Ground Water Area? <input type="checkbox"/> Yes <input checked="" type="checkbox"/> No		Chloride concentration: _____ mg/l <small>(For Emergency Pits and Settling Pits only)</small>
Is the bottom below ground level? <input checked="" type="checkbox"/> Yes <input type="checkbox"/> No	Artificial Liner? <input type="checkbox"/> Yes <input checked="" type="checkbox"/> No	How is the pit lined if a plastic liner is not used? clay soil
Pit dimensions (all but working pits): <u>15</u> Length (feet) <u>8</u> Width (feet) <input type="checkbox"/> N/A: Steel Pits Depth from ground level to deepest point: <u>3</u> (feet) <input type="checkbox"/> No Pit		
if the pit is lined give a brief description of the liner material, thickness and installation procedure. N/A		Describe procedures for periodic maintenance and determining liner integrity, including any special monitoring. Watch that clay soil is holding water. <div style="text-align: right;">RECEIVED KANSAS CORPORATION COMMISSION APR 21 2010 CONSERVATION DIVISION WICHITA, KS</div>
Distance to nearest water well within one-mile of pit <u>1000</u> feet Depth of water well <u>20</u> feet		Depth to shallowest fresh water <u>20</u> feet. Source of information: <input type="checkbox"/> measured <input checked="" type="checkbox"/> well owner <input type="checkbox"/> electric log <input type="checkbox"/> KDWR
Emergency, Settling and Burn Pits ONLY: Producing Formation: _____ Number of producing wells on lease: _____ Barrels of fluid produced daily: _____ Does the slope from the tank battery allow all spilled fluids to flow into the pit? <input type="checkbox"/> Yes <input type="checkbox"/> No		Drilling, Workover and Haul-Off Pits ONLY: Type of material utilized in drilling/workover: <u>shale and limestone</u> Number of working pits to be utilized: <u>1</u> Abandonment procedure: <u>back fill back in</u> Drill pits must be closed within 365 days of spud date.
I hereby certify that the above statements are true and correct to the best of my knowledge and belief.		
<u>4/16/10</u> Date	 Signature of Applicant or Agent	
KCC OFFICE USE ONLY		
Date Received: <u>4-21-10</u> Permit Number: _____		Steel Pit <input type="checkbox"/> RFAC <input checked="" type="checkbox"/> RFAS <input type="checkbox"/>
Permit Date: <u>4-21-10</u> Lease Inspection: <input checked="" type="checkbox"/> Yes <input checked="" type="checkbox"/> No		

15-207-27602-00-00



Mark Parkinson, Governor
Thomas E. Wright, Chairman
Joseph F. Harkins, Commissioner

April 21, 2010

Piqua Petro., Inc.
1331 Xylan Road
Piqua, KS 66761

RE: Drilling Pit Application
Collins-Bennett Lease Well No. 14-10
SE/4 Sec. 16-25S-17E
Woodson County, Kansas

Dear Sir or Madam:

District staff has inspected the above referenced location and has determined that the reserve pit shall be constructed **without slots**, the bottom shall be flat and reasonably level, and the free fluids must be removed. The fluids are to be removed from the reserve pit as soon as practical after drilling operations have ceased.

If production casing is set all completion fluids shall be removed from the working pits daily. NO completion fluids or non-exempt wastes shall be placed in the reserve pit.

The fluids should be taken to an authorized disposal well. Please call the District Office at (620) 432-2300 when the fluids have been removed. Please file form CDP-5 (August 2004), Exploration and Production Waste Transfer, within 30 days of fluid removal. Conservation division forms are available through our office and on the KCC web site:
www.kcc.state.ks.us/conservation/forms.

A copy of this letter should be posted in the doghouse along with the approved Intent to Drill.

If you have any questions or concerns please feel free to contact the undersigned at the above address.

Sincerely,

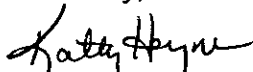

Kathy Haynes

Environmental Protection and Remediation Department

cc: File