

For KCC Use: Effective Date: 5-12-03 District #: 4 SGA? Yes No

KANSAS CORPORATION COMMISSION OIL & GAS CONSERVATION DIVISION NOTICE OF INTENT TO DRILL

Form C-1 September 1999 Form must be Typed Form must be Signed All blanks must be Filled

Must be approved by KCC five (5) days prior to commencing well

Expected Spud Date: June 3 2003 month day year

OPERATOR: License# 32047 Name: MICA Energy Corp. Address: P.O. Box 20707 City/State/Zip: Oklahoma City, OK 73156 Contact Person: Michael E. Carr Phone: 405-942-4552

CONTRACTOR: License# KLN 30606 Name: Murfin Drilling Company, Inc

Spot C W/2NE. NE Sec. 19 Twp. 1S S. R. 33 East West 660 feet from 6 / (N) (circle one) Line of Section 990 feet from (E) W (circle one) Line of Section Is SECTION X Regular Irregular?

(Note: Locate well on the Section Plat on reverse side)

County: Rawlins Lease Name: Dozbaha Well #: 1-19 Field Name: Wildcat

Is this a Prorated / Spaced Field? Yes No Target Formation(s): BLKC

Nearest Lease or unit boundary: 660' Ground Surface Elevation: 3020' feet MSL

Water well within one-quarter mile: Yes No Public water supply well within one mile: Yes No

Depth to bottom of fresh water: +80' 200 Depth to bottom of usable water: +250' 200

Surface Pipe by Alternate: 1 X 2 Length of Surface Pipe Planned to be set: 215' 250' Min

Length of Conductor Pipe required: None Projected Total Depth: 4300'

Formation at Total Depth: BLKC Water Source for Drilling Operations: Well Farm Pond Other X

DWR Permit #: (Note: Apply for Permit with DWR) Will Cores be taken? Yes No

If Yes, proposed zone: (Note: Apply for Permit with DWR)

Well Drilled For: Well Class: Type Equipment: Oil Gas OWWO Seismic: # of Holes Other Enh Rec Storage Disposal Infield Pool Ext Wildcat Other Mud Rotary Air Rotary Cable

If OWWO: old well information as follows: Operator: Well Name: Original Completion Date: Original Total Depth:

Directional, Deviated or Horizontal wellbore? Yes No If Yes, true vertical depth: Bottom Hole Location: KCC DKT #:

AFFIDAVIT

The undersigned hereby affirms that the drilling, completion and eventual plugging of this well will comply with K.S.A. 55-101. It is agreed that the following minimum requirements will be met: 1. Notify the appropriate district office prior to spudding of well; 2. A copy of the approved notice of intent to drill shall be posted on each drilling rig; 3. The minimum amount of surface pipe as specified below shall be set by circulating cement to the top; in all cases surface pipe shall be set through all unconsolidated materials plus a minimum of 20 feet into the underlying formation. 4. If the well is dry hole, an agreement between the operator and the district office on plug length and placement is necessary prior to plugging; 5. The appropriate district office will be notified before well is either plugged or production casing is cemented in; 6. If an ALTERNATE II COMPLETION, production pipe shall be cemented from below any usable water to surface within 120 days of spud date. In all cases, NOTIFY district office prior to any cementing.

I hereby certify that the statements made herein are true and to the best of my knowledge and belief.

Date: 4/30/03 Signature of Operator or Agent: Title: President

For KCC Use ONLY API # 15 - 153-20823-00-06 Conductor pipe required NONE feet Minimum surface pipe required 250 feet per Alt. 1 Approved by: RJP 5-7-03 This authorization expires: 11-7-03 (This authorization void if drilling not started within 6 months of effective date.) Spud date: Agent:

Remember to:

- File Drill Pit Application (form CDP-1) with Intent to Drill; - File Completion Form ACO-1 within 120 days of spud date; - File acreage attribution plat according to field proration orders; - Notify appropriate district office 48 hours prior to workover or re-entry; - Submit plugging report (CP-4) after plugging is completed; - Obtain written approval before disposing or injecting salt water.

RECEIVED MAY 07 2003 KCC WICHITA

19 1 33W

P.O. Box 404
Concordia, Ks. 66901

Invoice Number KO424031

Fall & Associates
Stake and Elevation Service
1-800-636-2821

<u>MICA ENERGY CORP.</u>		<u>1-19</u>	<u>Dozbaba</u>
Operator		Number	Farm Name
<u>Rawlins-KS</u>	<u>19</u>	<u>1s</u>	<u>33w</u>
County-State	S	T	R
			<u>C W/2 NE NE</u>
			Location

MICA Energy Corp.
P.O. Box 20707
Oklahoma City, OK 73156

Elevation 3020 Gr.

Ordered By: Mike

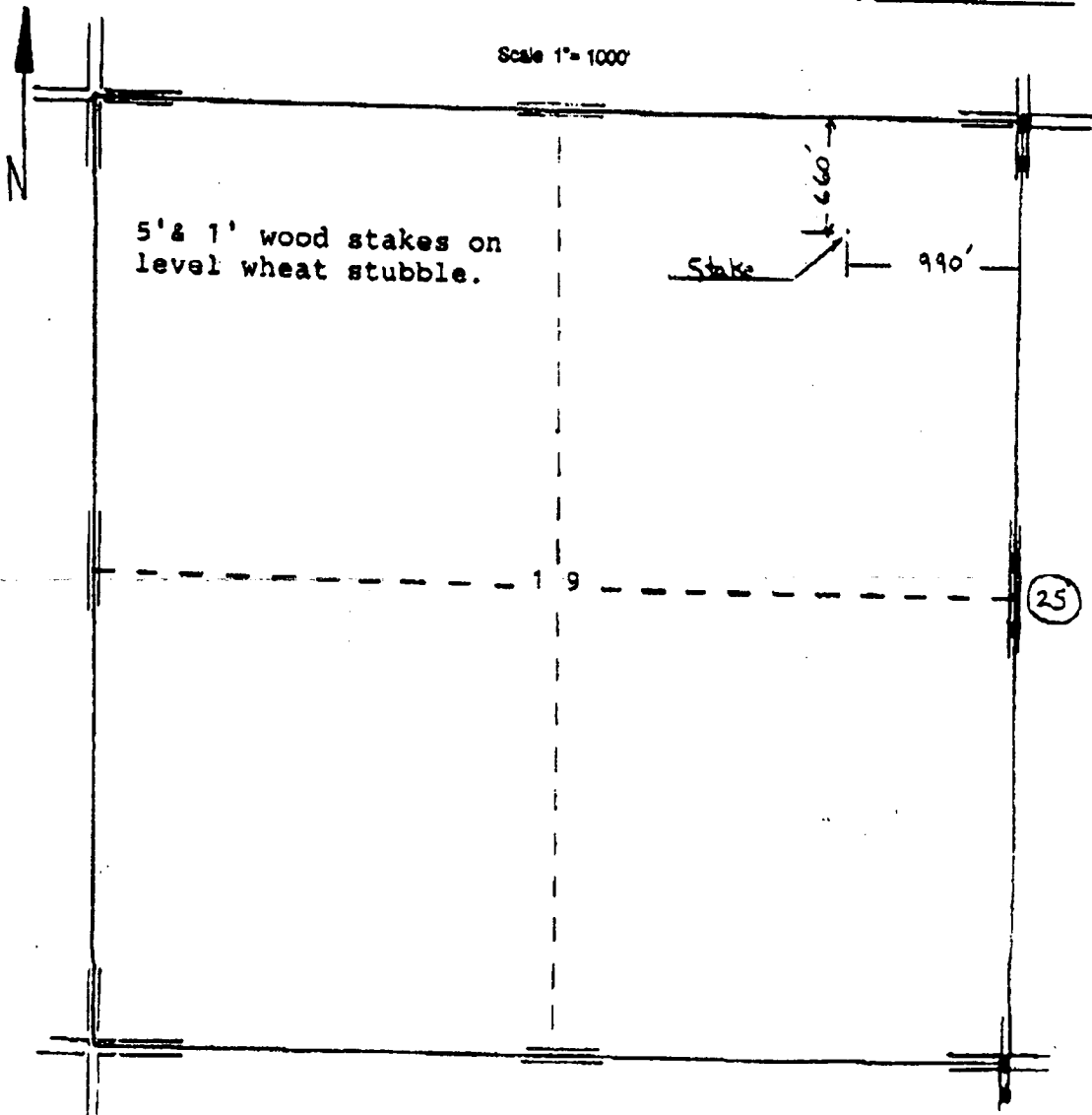

IN ALL CASES PLOT THE INTENDED WELL ON THE PLAT BELOW

Plat of acreage attributable to a well in a prorated or spaced field

If the intended well is in a prorated or spaced field, please fully complete this side of the form. If the intended well is in a prorated or spaced field complete the plat below showing that the well will be properly located in relationship to other wells producing from the common source of supply. Please show all the wells and within 1 mile of the boundaries of the proposed acreage attribution unit for gas wells and within 1/2 mile of the boundaries of the proposed acreage attribution unit for oil wells.

API No. 15 - _____
 Operator: MICA Energy Corp.
 Lease: Dozbaba
 Well Number: 1
 Field: Wildcat
 Number of Acres attributable to well: 40
 QTR / QTR / QTR of acreage: _____

Location of Well: County: Rawlins

 660 _____ feet from S (circle one) Line of Section
 990 _____ feet from (circle one) Line of Section
 Sec. 19 Twp. 1S S. R. 33 East West

Is Section X Regular or _____ Irregular

If Section is Irregular, locate well from nearest corner boundary.
Section corner used: _____ NE _____ NW _____ SE _____ SW

PLAT *see plat on prev. page*

*(Show location of the well and shade attributable acreage for prorated or spaced wells.)
(Show footage to the nearest lease or unit boundary line.)*

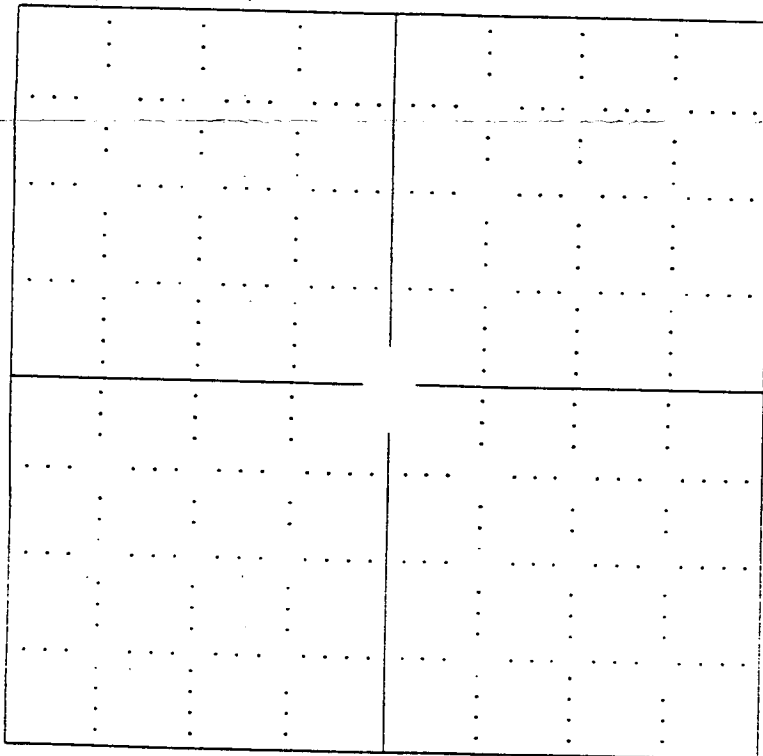

RECEIVED
 MAY 07 2003
 KCC WICHITA

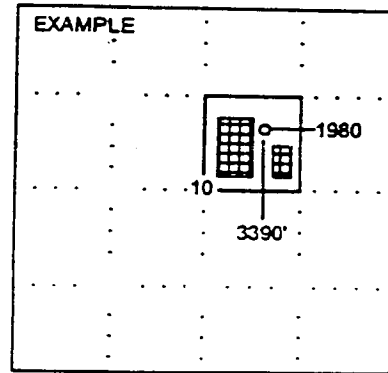

NOTE: *In all cases locate the spot of the proposed drilling location.*

In plotting the proposed location of the well, you must show:

1. The manner in which you are using the depicted plat by identifying section lines, i.e. 1 section, 1 section with 8 surrounding sections, 4 sections, etc.
2. The distance of the proposed drilling location from the section's south / north and east / west.
3. The distance to the nearest lease or unit boundary line.
4. If proposed location is located within a prorated or spaced field a certificate of acreage attribution plat must be attached: (CO-7 for oil wells; CG-8 for gas wells).