

For KCC Use: 5-4-2010
 Effective Date: 5-4-2010
 District #: 4
 SGA? Yes No

KANSAS CORPORATION COMMISSION
 OIL & GAS CONSERVATION DIVISION

Form C-1
 October 2007

Form must be Typed
 Form must be Signed
 All blanks must be Filled

NOTICE OF INTENT TO DRILL

Must be approved by KCC five (5) days prior to commencing well

Expected Spud Date: 5 4 2010
 month day year

OPERATOR: License# 6246 ✓
 Name: Bennett & Schulte Oil Company
 Address 1: P.O. Box 329
 Address 2: _____
 City: Russell State: KS Zip: 67665 + _____
 Contact Person: Frank Schulte
 Phone: 785-483-2721

CONTRACTOR: License# 33905 ✓
 Name: Royal Drilling, Inc.

Well Drilled For: Oil Gas Enh Rec Storage Disposal Seismic; # of Holes _____ Other: _____
 Well Class: Infield Pool Ext. Wildcat Other _____
 Type Equipment: Mud Rotary Air Rotary Cable

If OWWO: old well information as follows:
 Operator: _____
 Well Name: _____
 Original Completion Date: _____ Original Total Depth: _____

Directional, Deviated or Horizontal wellbore? Yes No
 If Yes, true vertical depth: _____
 Bottom Hole Location: _____
 KCC DKT #: _____

Spot Description: _____
 SE NE SE NE Sec. 14 Twp. 13 S. R. 16 E W
 (a/a/a/a) 1,960 feet from N / S Line of Section
125 feet from E / W Line of Section

Is SECTION: Regular Irregular?
 (Note: Locate well on the Section Plat on reverse side)

County: Ellis
 Lease Name: Hoffman Well #: 2
 Field Name: N/A

Is this a Prorated / Spaced Field? Yes No
 Target Formation(s): Arbuckle

Nearest Lease or unit boundary line (in footage): 330
 Ground Surface Elevation: 1952 Est. feet MSL

Water well within one-quarter mile: Yes No
 Public water supply well within one mile: Yes No

Depth to bottom of fresh water: 180
 Depth to bottom of usable water: 500

Surface Pipe by Alternate: I II
 Length of Surface Pipe Planned to be set: 400 520

Length of Conductor Pipe (if any): _____
 Projected Total Depth: 3450

Formation at Total Depth: Arbuckle

Water Source for Drilling Operations: Well Farm Pond Other: _____
 DWR Permit #: _____

(Note: Apply for Permit with DWR)
 Will Cores be taken? Yes No

If Yes, proposed zone: _____

Declaration of Unitization submitted.

AFFIDAVIT

The undersigned hereby affirms that the drilling, completion and eventual plugging of this well will comply with K.S.A. 55 APR 29 2010

It is agreed that the following minimum requirements will be met:

1. Notify the appropriate district office **prior** to spudding of well;
2. A copy of the approved notice of intent to drill **shall be** posted on each drilling rig;
3. The minimum amount of surface pipe as specified below **shall be set** by circulating cement to the top; in all cases surface pipe **shall be set** through all unconsolidated materials plus a minimum of 20 feet into the underlying formation.
4. If the well is dry hole, an agreement between the operator and the district office on plug length and placement is necessary **prior to plugging**;
5. The appropriate district office will be notified before well is either plugged or production casing is cemented in;
6. If an ALTERNATE II COMPLETION, production pipe shall be cemented from below any usable water to surface within **120 DAYS** of spud date.
 Or pursuant to Appendix "B" - Eastern Kansas surface casing order #133,891-C, which applies to the KCC District 3 area, alternate II cementing must be completed within 30 days of the spud date or the well shall be plugged. **In all cases, NOTIFY district office** prior to any cementing.

I hereby certify that the statements made herein are true and correct to the best of my knowledge and belief.

Date: 4/28/2010 Signature of Operator or Agent: Sherry Payne Title: Agent

RECEIVED
 KANSAS CORPORATION COMMISSION
 CONSERVATION DIVISION
 WICHITA, KS

For KCC Use ONLY
 API # 15 - 051-25981-0000
 Conductor pipe required None feet
 Minimum surface pipe required 520 feet per ALT I II
 Approved by: Russ 4-29-2010
 This authorization expires: 4-29-2011
 (This authorization void if drilling not started within 12 months of approval date.)
 Spud date: _____ Agent: _____

Remember to:
 - File Drill Pit Application (form CDP-1) with Intent to Drill;
 - File Completion Form ACO-1 within 120 days of spud date;
 - File acreage attribution plat according to field proration orders;
 - Notify appropriate district office 48 hours prior to workover or re-entry;
 - Submit plugging report (CP-4) after plugging is completed (within 60 days);
 - Obtain written approval before disposing or injecting salt water.
 - If this permit has expired (See: authorized expiration date) please check the box below and return to the address below.
 Well Not Drilled - Permit Expired Date: _____
 Signature of Operator or Agent: _____

14
 13
 16
 E
 W

IN ALL CASES PLOT THE INTENDED WELL ON THE PLAT BELOW

Plat of acreage attributable to a well in a prorated or spaced field

If the intended well is in a prorated or spaced field, please fully complete this side of the form. If the intended well is in a prorated or spaced field complete the plat below showing that the well will be properly located in relationship to other wells producing from the common source of supply. Please show all the wells and within 1 mile of the boundaries of the proposed acreage attribution unit for gas wells and within 1/2 mile of the boundaries of the proposed acreage attribution unit for oil wells.

API No. 15 - 051-25981-0000
 Operator: Bennett & Schulte Oil Company
 Lease: Hoffman
 Well Number: 2
 Field: N/A
 Number of Acres attributable to well: _____
 QTR/QTR/QTR/QTR of acreage: SE - NE - SE - NE

Location of Well: County: Ellis
1,960 feet from N / S Line of Section
125 feet from E / W Line of Section
 Sec. 14 Twp. 13 S. R. 16 E W

Is Section: Regular or Irregular

If Section is Irregular, locate well from nearest corner boundary.

Section corner used: NE NW SE SW

PLAT

(Show location of the well and shade attributable acreage for prorated or spaced wells.)

(Show footage to the nearest lease or unit boundary line.)

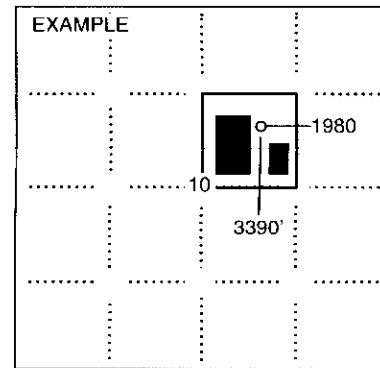
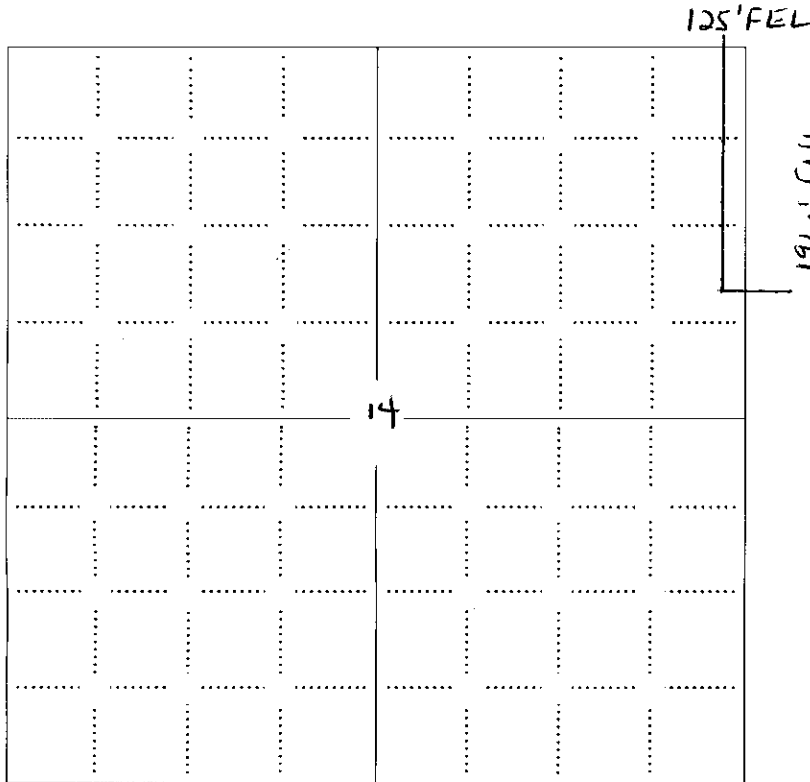

NOTE: In all cases locate the spot of the proposed drilling locaton.

In plotting the proposed location of the well, you must show:

1. The manner in which you are using the depicted plat by identifying section lines, i.e. 1 section, 1 section with 8 surrounding sections, 4 sections, etc.
2. The distance of the proposed drilling location from the south / north and east / west outside section lines.
3. The distance to the nearest lease or unit boundary line (in footage).
4. If proposed location is located within a prorated or spaced field a certificate of acreage attribution plat must be attached: (CO-7 for oil wells; CG-8 for gas wells).

**KANSAS CORPORATION COMMISSION
OIL & GAS CONSERVATION DIVISION
APPLICATION FOR SURFACE PIT**

Form CDP-1
April 2004
Form must be Typed

Submit in Duplicate

Operator Name: Bennett & Schulte Oil Company		License Number: 6246
Operator Address: P.O. Box 329		Russell KS 67665
Contact Person: Frank Schulte		Phone Number: 785-483-2721
Lease Name & Well No.: Hoffman 2		Pit Location (QQQQ): SE NE SE NE Sec. 14 Twp. 13 R. 16 <input type="checkbox"/> East <input checked="" type="checkbox"/> West 1,960 Feet from <input checked="" type="checkbox"/> North / <input type="checkbox"/> South Line of Section 125 Feet from <input checked="" type="checkbox"/> East / <input type="checkbox"/> West Line of Section Ellis County
Type of Pit: <input type="checkbox"/> Emergency Pit <input type="checkbox"/> Burn Pit <input type="checkbox"/> Settling Pit <input checked="" type="checkbox"/> Drilling Pit <input type="checkbox"/> Workover Pit <input type="checkbox"/> Haul-Off Pit <small>(If WP Supply API No. or Year Drilled)</small>	Pit is: <input checked="" type="checkbox"/> Proposed <input type="checkbox"/> Existing If Existing, date constructed: _____ Pit capacity: 1,200 (bbls)	
Is the pit located in a Sensitive Ground Water Area? <input type="checkbox"/> Yes <input checked="" type="checkbox"/> No		Chloride concentration: _____ mg/l <small>(For Emergency Pits and Settling Pits only)</small>
Is the bottom below ground level? <input checked="" type="checkbox"/> Yes <input type="checkbox"/> No	Artificial Liner? <input type="checkbox"/> Yes <input checked="" type="checkbox"/> No	How is the pit lined if a plastic liner is not used? Native Mud
Pit dimensions (all but working pits): 80 Length (feet) 80 Width (feet) <input type="checkbox"/> N/A: Steel Pits Depth from ground level to deepest point: 6 (feet) <input type="checkbox"/> No Pit		
If the pit is lined give a brief description of the liner material, thickness and installation procedure.		Describe procedures for periodic maintenance and determining liner integrity, including any special monitoring.
Distance to nearest water well within one-mile of pit N/A feet Depth of water well _____ feet		Depth to shallowest fresh water _____ feet. Source of information: <input type="checkbox"/> measured <input type="checkbox"/> well owner <input type="checkbox"/> electric log <input type="checkbox"/> KDWR
Emergency, Settling and Burn Pits ONLY: Producing Formation: _____ Number of producing wells on lease: _____ Barrels of fluid produced daily: _____ Does the slope from the tank battery allow all spilled fluids to flow into the pit? <input type="checkbox"/> Yes <input type="checkbox"/> No		Drilling, Workover and Haul-Off Pits ONLY: Type of material utilized in drilling/workover: Fresh Mud Number of working pits to be utilized: 3 Abandonment procedure: Allow to dry and backfill Drill pits must be closed within 365 days of spud date.
I hereby certify that the above statements are true and correct to the best of my knowledge and belief.		
_____ 4/28/2010 Date	_____ <i>Sherry Payne</i> Signature of Applicant or Agent	RECEIVED KANSAS CORPORATION COMMISSION APR 29 2010 CONSERVATION DIVISION WICHITA, KS
KCC OFFICE USE ONLY		
Steel Pit <input type="checkbox"/> RFAC <input type="checkbox"/> RFAS <input type="checkbox"/>		
Date Received: 4-29-10 Permit Number: _____	Permit Date: 4-29-10	Lease Inspection: <input type="checkbox"/> Yes <input checked="" type="checkbox"/> No

157051-25981-0000