

For KCC Use: 5-18-2010
 Effective Date: _____
 District # 3
 SGA? Yes No

KANSAS CORPORATION COMMISSION
 OIL & GAS CONSERVATION DIVISION

Form C-1
 October 2007
Form must be Typed
Form must be Signed
All blanks must be Filled

NOTICE OF INTENT TO DRILL
Must be approved by KCC five (5) days prior to commencing well

Expected Spud Date: 5-18-10
month day year

Spot Description: _____
S2 S2 NW Sec. 23 Twp. 34 S. R. 16 E W
 (0000) 2,310 feet from N / S Line of Section
 1,320 feet from E / W Line of Section

OPERATOR: License# 32887
 Name: Endeavor Energy Resources, LP
 Address 1: PO Box 40
 Address 2: _____
 City: Delaware State: OK Zip: 74027 + _____
 Contact Person: Joe Driskill
 Phone: 918-467-3111

Is SECTION: Regular Irregular?
 (Note: Locate well on the Section Plat on reverse side)
 County: Montgomery
 Lease Name: Campbell Well #: 23-3
 Field Name: Coffeyville - Cherryvale

CONTRACTOR: License# 33072
 Name: Well Refined Drilling

Is this a Prorated / Spaced Field? Yes No
 Target Formation(s): Weir

Well Drilled For: Oil Gas Enh Rec Storage Disposal Seismic; # of Holes _____ Other: _____
 Well Class: Infield Pool Ext. Wildcat Other _____
 Type Equipment: Mud Rotary Air Rotary Cable

Nearest Lease or unit boundary line (in footage): 330
 Ground Surface Elevation: 719' feet MSL
 Water well within one-quarter mile: Yes No
 Public water supply well within one mile: Yes No

If OWWO: old well information as follows:
 Operator: NA
 Well Name: NA
 Original Completion Date: na Original Total Depth: na

Depth to bottom of fresh water: 20'
 Depth to bottom of usable water: 150'
 Surface Pipe by Alternate: I II
 Length of Surface Pipe Planned to be set: 40'
 Length of Conductor Pipe (if any): none
 Projected Total Depth: 1000'
 Formation at Total Depth: Mississippi

Directional, Deviated or Horizontal wellbore? Yes No
 If Yes, true vertical depth: NA
 Bottom Hole Location: NA
 KCC DKT #: na

Water Source for Drilling Operations:
 Well Farm Pond Other: Air drilled
 DWR Permit #: _____
 (Note: Apply for Permit with DWR)
 Will Cores be taken? Yes No
 If Yes, proposed zone: _____

AFFIDAVIT

The undersigned hereby affirms that the drilling, completion and eventual plugging of this well will comply with K.S.A. 55 et. seq.
 It is agreed that the following minimum requirements will be met:

1. Notify the appropriate district office **prior** to spudding of well;
2. A copy of the approved notice of intent to drill **shall be** posted on each drilling rig;
3. The minimum amount of surface pipe as specified below **shall be set** by circulating cement to the top; in all cases surface pipe **shall be set** through all unconsolidated materials plus a minimum of 20 feet into the underlying formation.
4. If the well is dry hole, an agreement between the operator and the district office on plug length and placement is necessary **prior to plugging**;
5. The appropriate district office will be notified before well is either plugged or production casing is cemented in;
6. If an ALTERNATE II COMPLETION, production pipe shall be cemented from below any usable water to surface within **120 DAYS** of spud date.
 Or pursuant to Appendix "B" - Eastern Kansas surface casing order #133,891-C, which applies to the KCC District 3 area, alternate II cementing must be completed within 30 days of the spud date or the well shall be plugged. **In all cases, NOTIFY district office** prior to any cementing.

I hereby certify that the statements made herein are true and correct to the best of my knowledge and belief.

Date: 5-10-10 Signature of Operator or Agent: Joe Driskill Title: Operations Superintendent

For KCC Use ONLY
 API # 15 - 125-31965-00-00
 Conductor pipe required None feet
 Minimum surface pipe required 20 feet per ALT. I II
 Approved by: RWA 5-13-2010
 This authorization expires: 5-13-2011
 (This authorization void if drilling not started within 12 months of approval date.)
 Spud date: _____ Agent: _____

Remember to:

- File Drill Pit Application (form CDP-1) with Intent to Drill;
- File Completion Form ACO-1 within 120 days of spud date;
- File acreage attribution plat according to field proration orders;
- Notify appropriate district office 48 hours prior to workover or re-entry;
- Submit plugging report (CP-4) after plugging is completed (within 60 days);
- Obtain written approval before disposing or injecting salt water.
- If this permit has expired (See: authorized expiration date) please check the box below and return to the address below.

Well Not Drilled - Permit Expired Date: _____
 Signature of Operator or Agent: _____

RECEIVED
 KANSAS CORPORATION COMMISSION
 MAY 12 2010
 CONSERVATION DIVISION
 WICHITA, KS

23
 34
 16
 E
 W

IN ALL CASES PLOT THE INTENDED WELL ON THE PLAT BELOW

Plat of acreage attributable to a well in a prorated or spaced field

If the intended well is in a prorated or spaced field, please fully complete this side of the form. If the intended well is in a prorated or spaced field complete the plat below showing that the well will be properly located in relationship to other wells producing from the common source of supply. Please show all the wells and within 1 mile of the boundaries of the proposed acreage attribution unit for gas wells and within 1/2 mile of the boundaries of the proposed acreage attribution unit for oil wells.

API No. 15 - 125-31965-0000
 Operator: Endeavor Energy Resources, LP
 Lease: Campbell
 Well Number: 23-3
 Field: Coffeyville
 Number of Acres attributable to well: 120
 QTR/QTR/QTR/QTR of acreage: _____ - _____ - _____ - _____ NW

Location of Well: County: Montgomery
2,310 feet from N / S Line of Section
1,320 feet from E / W Line of Section
 Sec. 23 Twp. 34 S. R. 16 E W

Is Section: Regular or Irregular

If Section is Irregular, locate well from nearest corner boundary.

Section corner used: NE NW SE SW

PLAT

(Show location of the well and shade attributable acreage for prorated or spaced wells.)

(Show footage to the nearest lease or unit boundary line.)

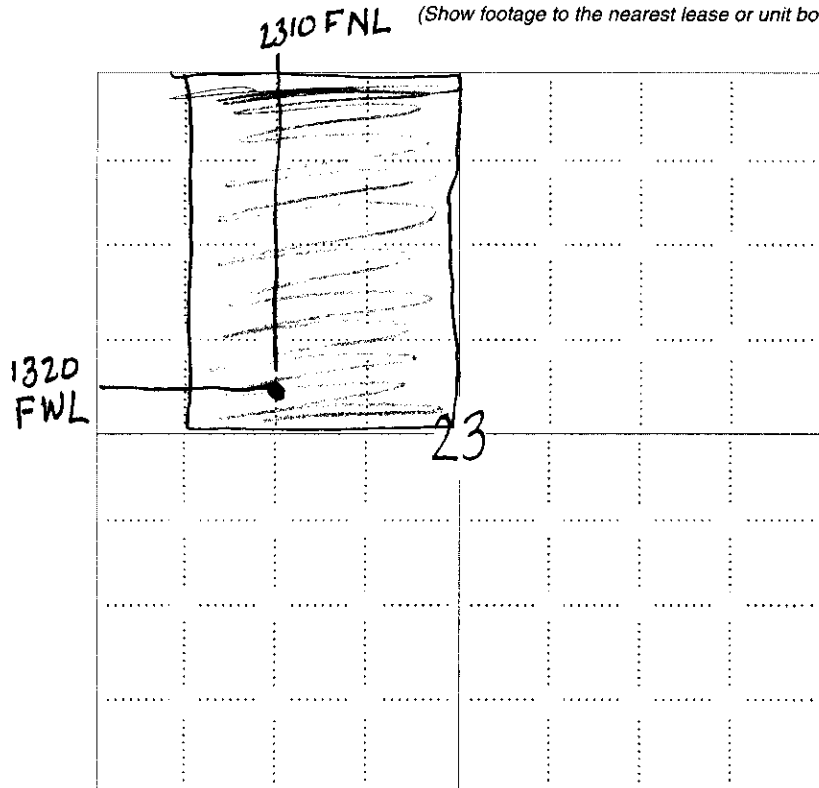

RECEIVED
 KANSAS CORPORATION COMMISSION

MAY 12 2010

CONSERVATION DIVISION
 WICHITA, KS

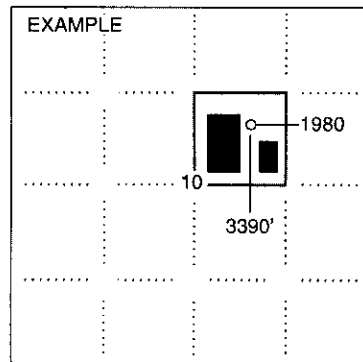

SEWARD CO.

NOTE: In all cases locate the spot of the proposed drilling location.

In plotting the proposed location of the well, you must show:

1. The manner in which you are using the depicted plat by identifying section lines, i.e. 1 section, 1 section with 8 surrounding sections, 4 sections, etc.
2. The distance of the proposed drilling location from the south / north and east / west outside section lines.
3. The distance to the nearest lease or unit boundary line (in footage).
4. If proposed location is located within a prorated or spaced field a certificate of acreage attribution plat must be attached: (CO-7 for oil wells; CG-8 for gas wells).

**KANSAS CORPORATION COMMISSION
OIL & GAS CONSERVATION DIVISION
APPLICATION FOR SURFACE PIT**

Form CDP-1
April 2004
Form must be Typed

Submit in Duplicate

Operator Name: Endeavor Energy Resources, LP		License Number: 32887
Operator Address: PO Box 40		Delaware OK 74027
Contact Person: Joe Driskill		Phone Number: 918-467-3111
Lease Name & Well No.: Campbell 23-3		Pit Location (QQQQ): <u>S2 . S2 NW</u>
Type of Pit: <input type="checkbox"/> Emergency Pit <input type="checkbox"/> Burn Pit <input type="checkbox"/> Settling Pit <input checked="" type="checkbox"/> Drilling Pit <input type="checkbox"/> Workover Pit <input type="checkbox"/> Haul-Off Pit <small>(If WP Supply API No. or Year Drilled)</small>	Pit is: <input checked="" type="checkbox"/> Proposed <input type="checkbox"/> Existing If Existing, date constructed: _____ Pit capacity: _____ (bbls)	Sec. <u>23</u> Twp. <u>34</u> R. <u>16</u> <input checked="" type="checkbox"/> East <input type="checkbox"/> West <u>2,310</u> Feet from <input checked="" type="checkbox"/> North / <input type="checkbox"/> South Line of Section <u>1,320</u> Feet from <input type="checkbox"/> East / <input checked="" type="checkbox"/> West Line of Section Montgomery County
Is the pit located in a Sensitive Ground Water Area? <input checked="" type="checkbox"/> Yes <input checked="" type="checkbox"/> No		Chloride concentration: _____ mg/l <small>(For Emergency Pits and Settling Pits only)</small>
Is the bottom below ground level? <input checked="" type="checkbox"/> Yes <input type="checkbox"/> No	Artificial Liner? <input type="checkbox"/> Yes <input checked="" type="checkbox"/> No	How is the pit lined if a plastic liner is not used? natural clay / earth
Pit dimensions (all but working pits): <u>30</u> Length (feet) <u>10</u> Width (feet) <input type="checkbox"/> N/A: Steel Pits Depth from ground level to deepest point: <u>6</u> (feet) <input type="checkbox"/> No Pit		
If the pit is lined give a brief description of the liner material, thickness and installation procedure. NA		Describe procedures for periodic maintenance and determining liner integrity, including any special monitoring. NA
Distance to nearest water well within one-mile of pit <u>unknown</u> feet Depth of water well _____ feet		Depth to shallowest fresh water _____ feet. Source of information: <input type="checkbox"/> measured <input type="checkbox"/> well owner <input checked="" type="checkbox"/> electric log <input type="checkbox"/> KDWR
Emergency, Settling and Burn Pits ONLY: Producing Formation: _____ Number of producing wells on lease: _____ Barrels of fluid produced daily: _____ Does the slope from the tank battery allow all spilled fluids to flow into the pit? <input type="checkbox"/> Yes <input type="checkbox"/> No		Drilling, Workover and Haul-Off Pits ONLY: Type of material utilized in drilling/workover: <u>air</u> Number of working pits to be utilized: <u>1</u> Abandonment procedure: <u>dewater and backfill</u> Drill pits must be closed within 365 days of spud date.
I hereby certify that the above statements are true and correct to the best of my knowledge and belief.		
<u>5-10-10</u> Date	 Signature of Applicant or Agent	

RECEIVED
KANSAS CORPORATION COMMISSION
MAY 12 2010
CONSERVATION DIVISION
WICHITA, KS

15-125-31965-0000

KCC OFFICE USE ONLY		Steel Pit <input type="checkbox"/>	RFAC <input checked="" type="checkbox"/>	RFAS <input type="checkbox"/>
Date Received: <u>5-12-10</u>	Permit Number: _____	Permit Date: <u>5-12-10</u>	Lease Inspection: <input checked="" type="checkbox"/> Yes <input type="checkbox"/> No	

Mail to: KCC - Conservation Division, 130 S. Market - Room 2078, Wichita, Kansas 67202

May 12, 2010

Endeavor Energy Resources, LP
PO Box 40
Delaware, OK 74027

RE: Drilling Pit Application
Campbell Lease Well No. 23-3
NW/4 Sec. 23-34S-16E
Montgomery County, Kansas

Dear Sir or Madam:

District staff has inspected the above referenced location and has determined that the reserve pit shall be constructed **without slots**, the bottom shall be flat and reasonably level, and the free fluids must be removed. The fluids are to be removed from the reserve pit as soon as practical after drilling operations have ceased.

If production casing is set all completion fluids shall be removed from the working pits daily. NO completion fluids or non-exempt wastes shall be placed in the reserve pit.

The fluids should be taken to an authorized disposal well. Please call the District Office at (620) 432-2300 when the fluids have been removed. Please file form CDP-5 (August 2004), Exploration and Production Waste Transfer, within 30 days of fluid removal. Conservation division forms are available through our office and on the KCC web site:
www.kcc.state.ks.us/conservation/forms.

A copy of this letter should be posted in the doghouse along with the approved Intent to Drill.

If you have any questions or concerns please feel free to contact the undersigned at the above address.

Sincerely,

Kathy Haynes

Environmental Protection and Remediation Department

cc: File