

For KCC Use:  
Effective Date: 5-19-10  
District #: 2  
SGA?  Yes  No

KANSAS CORPORATION COMMISSION  
OIL & GAS CONSERVATION DIVISION

OWWO

Form C-1  
October 2007  
Form must be Typed  
Form must be Signed  
All blanks must be Filled

NOTICE OF INTENT TO DRILL

Must be approved by KCC five (5) days prior to commencing well

Expected Spud Date: June 1 2010  
month day year

OPERATOR: License# 34124 ✓  
Name: Brian Barthelme  
Address 1: 1802 Maple  
Address 2: 2370 Somerset  
City: Wichita State: Ks Zip: 67213 +  
Contact Person: Brian Barthelme  
Phone: (316) 650-0094  
CONTRACTOR: License# 5870 ✓  
Name: Phillips Well Service

Spot Description:  
C - SE - SE - NW Sec. 1 Twp. 25 S. R. 5  E  W  
(4000) 2970 feet from  N /  S Line of Section  
2970 feet from  E /  W Line of Section

Is SECTION:  Regular  Irregular?

(Note: Locate well on the Section Plat on reverse side)

County: Butler  
Lease Name: Entz Well #: 1 OWWO

Field Name: wildcat  
Is this a Prorated / Spaced Field?  Yes  No

Target Formation(s): Lansing  
Nearest Lease or unit boundary line (in footage): 2310

Ground Surface Elevation: 1396 feet MSL  
Water well within one-quarter mile:  Yes  No

Public water supply well within one mile:  Yes  No  
Depth to bottom of fresh water: 160

Depth to bottom of usable water: 180  
Surface Pipe by Alternate:  I  II

Length of Surface Pipe Planned to be set: 1800' 206'  
Length of Conductor Pipe (if any): none

Projected Total Depth: 1912'  
Formation at Total Depth: Lansing

Water Source for Drilling Operations:  
 Well  Farm Pond  Other: Trucked

DWR Permit #: \_\_\_\_\_  
(Note: Apply for Permit with DWR  )  
Will Cores be taken?  Yes  No

If Yes, proposed zone: \_\_\_\_\_

Well Drilled For:  Oil  Gas  Seismic; # of Holes \_\_\_\_\_  
 Enh Rec  Storage  Disposal  
 Infield  Pool Ext.  Wildcat  Other  
Type Equipment:  Mud Rotary  Air Rotary  Cable  
Other: pulling unit, mud pump, power swivel

If OWWO: old well information as follows:  
Operator: E.H. Adair Oil Co. & Lee Phillips Oil Co.  
Well Name: Entz 1  
Original Completion Date: 5/27/59 Original Total Depth: 3010

Directional, Deviated or Horizontal wellbore?  Yes  No  
If Yes, true vertical depth: \_\_\_\_\_  
Bottom Hole Location: \_\_\_\_\_  
KCC DKT #: \_\_\_\_\_

AFFIDAVIT

The undersigned hereby affirms that the drilling, completion and eventual plugging of this well will comply with K.S.A. 55 et. seq.  
It is agreed that the following minimum requirements will be met:

1. Notify the appropriate district office *prior* to spudding of well;
2. A copy of the approved notice of intent to drill *shall be* posted on each drilling rig;
3. The minimum amount of surface pipe as specified below *shall be set* by circulating cement to the top; in all cases surface pipe *shall be set* through all unconsolidated materials plus a minimum of 20 feet into the underlying formation.
4. If the well is dry hole, an agreement between the operator and the district office on plug length and placement is necessary *prior to plugging*;
5. The appropriate district office will be notified before well is either plugged or production casing is cemented in;
6. If an ALTERNATE II COMPLETION, production pipe shall be cemented from below any usable water to surface within **120 DAYS** of spud date.  
Or pursuant to Appendix "B" - Eastern Kansas surface casing order #133,891-C, which applies to the KCC District 3 area, alternate II cementing must be completed within 30 days of the spud date or the well shall be plugged. *In all cases, NOTIFY district office prior to any cementing.*

I hereby certify that the statements made herein are true and correct to the best of my knowledge and belief.

Date: 5/12/2010 Signature of Operator or Agent: Brian Barthelme Title: operator

For KCC Use ONLY  
API # 15 - 015-00130-00-01  
Conductor pipe required None feet  
Minimum surface pipe required 206 feet per ALT  I  II  
Approved by: SB 5-19-10  
This authorization expires: 5-14-11  
(This authorization void if drilling not started within 12 months of approval date.)  
Spud date: \_\_\_\_\_ Agent: \_\_\_\_\_

Remember to:

- File Drill Pit Application (form CDP-1) with Intent to Drill;
- File Completion Form ACO-1 within 120 days of spud date;
- File acreage attribution plat according to field prorations orders;
- Notify appropriate district office 48 hours prior to workover or re-entry;
- Submit plugging report (CP-4) after plugging is completed (within 60 days);
- Obtain written approval before disposing or injecting salt water.
- If this permit has expired (See: authorized expiration date) please check the box below and return to the address below.

Well Not Drilled - Permit Expired Date: \_\_\_\_\_  
Signature of Operator or Agent: \_\_\_\_\_

Mail to: KCC - Conservation Division, 130 S. Market - Room 2078, Wichita, Kansas 67202

RECEIVED  
MAY 13 2010  
KCC WICHITA

1-25-5  
 I  II

**IN ALL CASES PLOT THE INTENDED WELL ON THE PLAT BELOW**

*Plat of acreage attributable to a well in a prorated or spaced field*

*If the intended well is in a prorated or spaced field, please fully complete this side of the form. If the intended well is in a prorated or spaced field complete the plat below showing that the well will be properly located in relationship to other wells producing from the common source of supply. Please show all the wells and within 1 mile of the boundaries of the proposed acreage attribution unit for gas wells and within 1/2 mile of the boundaries of the proposed acreage attribution unit for oil wells.*

API No. 15 - 015-00130-00-01  
 Operator: Brian Barthelme  
 Lease: Entz  
 Well Number: 1  
 Field: wildcat  
 Number of Acres attributable to well: \_\_\_\_\_  
 QTR/QTR/QTR/QTR of acreage: C - SE - SE - NW

Location of Well: County: Butler  
 \_\_\_\_\_ 2970' feet from  N /  S Line of Section  
 \_\_\_\_\_ 2970' feet from  E /  W Line of Section  
 Sec. 1 Twp. 25 S. R. 5  E  W

Is Section:  Regular or  Irregular

If Section is Irregular, locate well from nearest corner boundary.  
 Section corner used:  NE  NW  SE  SW

**PLAT**

*(Show location of the well and shade attributable acreage for prorated or spaced wells.)*

*(Show footage to the nearest lease or unit boundary line.)*

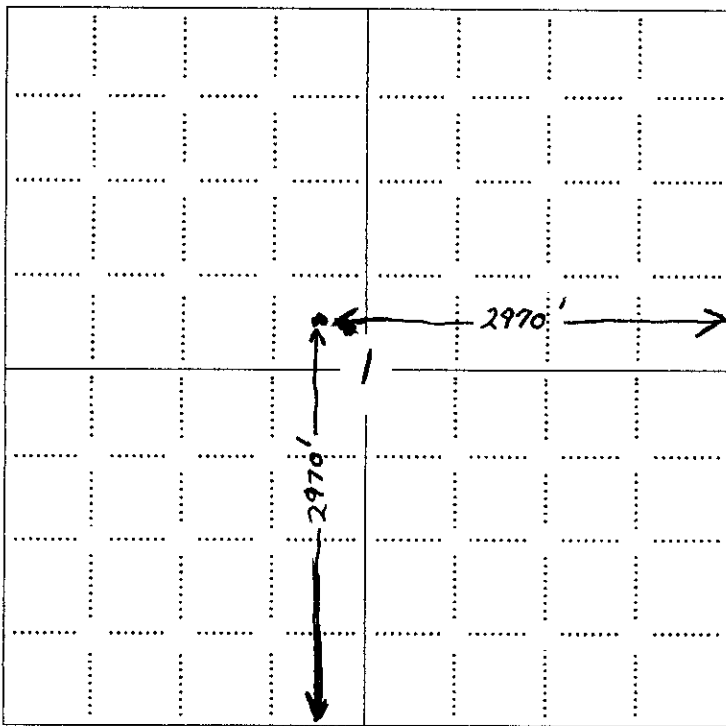

RECEIVED  
 MAY 13 2010  
 KCC WICHITA

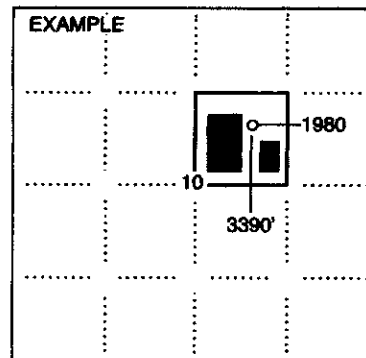

SEWARD CO.

**NOTE: In all cases locate the spot of the proposed drilling location.**

**In plotting the proposed location of the well, you must show:**

1. The manner in which you are using the depicted plat by identifying section lines, i.e. 1 section, 1 section with 8 surrounding sections, 4 sections, etc.
2. The distance of the proposed drilling location from the south / north and east / west outside section lines.
3. The distance to the nearest lease or unit boundary line (in footage).
4. If proposed location is located within a prorated or spaced field a certificate of acreage attribution plat must be attached: (CO-7 for oil wells; CG-8 for gas wells).

STATE OF KANSAS  
CORPORATION COMMISSION

Information Completely  
Required Affidavit  
or Deliver Report to:  
Conservation Division  
State Corporation Commission  
211 No. Broadway  
Wichita, Kansas

WELL PLUGGING RECORD

Butler County, Sec. 1 Twp. 25 Rge. 5(E) (W)  
Location as "NE/CNW/SE" or footage from lines SE SE NW  
Lease Owner E. H. Adair Oil Co.  
Lease Name Eitz Well No. 1  
Office Address 1005 E. 2nd, Wichita  
Character of Well (completed as Oil, Gas or Dry Hole) Dry Hole  
Date well completed 6-22-59 19  
Application for plugging filed 6-22-59 19  
Application for plugging approved 6-22-59 19  
Plugging commenced 6-22-59 19  
Plugging completed 6-22-59 19  
Reason for abandonment of well or producing formation

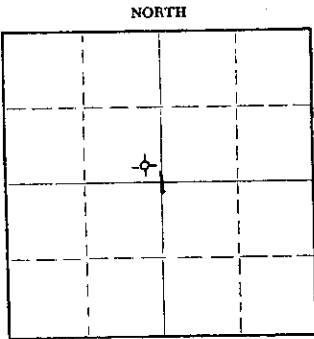

Locate well correctly on above  
Section Plat

If a producing well is abandoned, date of last production 19  
Was permission obtained from the Conservation Division or its agents before plugging was com-  
menced? Yes  
Name of Conservation Agent who supervised plugging of this well Mr. Guthrie  
Producing formation Depth to top Bottom Total Depth of Well 3010 Feet  
Show depth and thickness of all water, oil and gas formations.

OIL, GAS OR WATER RECORDS

CASING RECORD

FORMATION	CONTENT	FROM	TO	SIZE	PUT IN	PULLED OUT
Copy of drillers log attached hereto.						

Describe in detail the manner in which the well was plugged, indicating where the mud fluid was placed and the method or methods used in introducing it into the hole. If cement or other plugs were used, state the character of same and depth placed, from feet to feet for each plug set.

Mud to 230'. Plug with 15 sx. cement and 1/4 sx. hulls.  
Mud to 35'. Plug with 10 sx. cement and 1/4 sx. hulls.  
Two sx. cement in the rat hole.

(If additional description is necessary, use BACK of this sheet)

Name of Plugging Contractor E. H. Adair Oil Company  
Address 1005 E. Second Wichita

STATE OF Kansas, COUNTY OF Sedgwick, ss.  
Sherrill Compton (employee of owner) or (owner/operator) of the above-described well, being first duly sworn on oath, says: That I have knowledge of the facts, statements, and matters herein contained and the log of the above-described well as filed and that the same are true and correct. So help me, God.

(Signature) Sherrill Compton

(Address)

SUBSCRIBED AND SWORN TO before me this 25th day of May, 1959

My commission expires 9-15-61

L. Hill

Notary Public.

PLUGGING  
FILE SEC 1 T. 25 R. 5E  
BOOK PAGE 52 LINE 41

E. M. Adair Oil Company  
 1005 East Second Street  
 Wichita 7, Kansas.

RECEIVED  
 STATE GEOLOGICAL SURVEY  
 JUL 23 1955  
 CONSERVATION DIVISION  
 Wichita, Kansas

E. M. Adair Oil Company &  
 Lee Phillips Oil Company  
 Entz No. 1  
 SE-SE-NW of  
 Sec. 1, Twp. 25S., Range 5 E.  
 Butler County, Kansas  
 Elevation: 1400 K.D.

Comm: 8-16-59  
 Comp: 6-22-59  
 Contractor:  
 E. M. Adair - Rig #3  
 8-5/8 in. @ 206 ft. w/140 ex.  
 Prot: D. & A.

Figures indicate bottoms of formations

Shale & Lime	1536	Sand & Shaley Sand	2430
Shale	1612	Shale	2450
Sand	1643	Lime	2474
Shale	1698	Shale & Lime	2502
Lime	1904	Shale	2568
Shale	1912	Lime	2577
Lime	1926	Shale	2650
Shale	1990	Sand	2655
Lime	1912	Shale	2693
Lime & Shale	1950	Cherty Lime	2702
Shale	2081	Chert	2801
Lime	2225	Lime	2819
Sand	2247	Shale	2920
Lime	2254	Dolomite	2970
Shale	2329	Sandy Dolomite	3010
Lime	2335	T.D.	3010

ELECTRIC-LOG TOPS:

LANSING	1790	(- 380)
KANSAS CITY	2081	(- 671)
BASE. K. C.	2254	(- 854)
PERU SNAB	2335	(- 935)
MISSISSIPPI	2693	(-1293)
KINDERHOOK	2819	(-1419)
VIOLA	2920	(-1520)
SIMPSON SAND	2971	(-1571)
T. D.	3011	

Certified correct:

*Sherrill Compton*  
 Sherrill Compton Geologist

PLUGGING  
 FILE SEC. 1 T. 25 R. SE  
 BOOK PAGE 50 LINE 41

**KANSAS CORPORATION COMMISSION  
OIL & GAS CONSERVATION DIVISION  
APPLICATION FOR SURFACE PIT**

Form CDP-1  
April 2004  
Form must be Typed

*Submit in Duplicate*

Operator Name: <u>Brian Barthelme</u>		License Number: <u>34124</u>
Operator Address: <u>1802 Maple, Wichita, Ks. 67213</u>		
Contact Person: <u>Brian Barthelme</u>		Phone Number: <u>(316) 650-0094</u>
Lease Name & Well No.: <u>Entz #1 OWWO</u>		Pit Location (QQQQ): <u>C - SE - SE - NW</u>
Type of Pit: <input type="checkbox"/> Emergency Pit <input type="checkbox"/> Burn Pit <input type="checkbox"/> Settling Pit <input checked="" type="checkbox"/> Drilling Pit <input type="checkbox"/> Workover Pit <input type="checkbox"/> Haul-Off Pit <small>(If WP Supply API No. or Year Drilled)</small>	Pit Is: <input checked="" type="checkbox"/> Proposed <input type="checkbox"/> Existing If Existing, date constructed: _____ Pit capacity: <u>150</u> (bbls)	Sec. <u>1</u> Twp. <u>25</u> R. <u>5</u> <input checked="" type="checkbox"/> East <input type="checkbox"/> West <u>2970'</u> Feet from <input type="checkbox"/> North / <input checked="" type="checkbox"/> South Line of Section <u>2970'</u> Feet from <input checked="" type="checkbox"/> East / <input type="checkbox"/> West Line of Section <u>Butler</u> County
Is the pit located in a Sensitive Ground Water Area? <input type="checkbox"/> Yes <input checked="" type="checkbox"/> No		Chloride concentration: _____ mg/l <small>(For Emergency Pits and Settling Pits only)</small>
Is the bottom below ground level? <input checked="" type="checkbox"/> Yes <input type="checkbox"/> No	Artificial Liner? <input type="checkbox"/> Yes <input checked="" type="checkbox"/> No	How is the pit lined if a plastic liner is not used? <u>rock and clay soil</u>
Pit dimensions (all but working pits): <u>30</u> Length (feet) <u>8</u> Width (feet) <input type="checkbox"/> N/A: Steel Pits Depth from ground level to deepest point: <u>4</u> (feet) <input type="checkbox"/> No Pit		
If the pit is lined give a brief description of the liner material, thickness and installation procedure.		Describe procedures for periodic maintenance and determining liner integrity, including any special monitoring.
Distance to nearest water well within one-mile of pit <u>2310</u> feet    Depth of water well <u>110</u> feet		Depth to shallowest fresh water <u>110</u> feet. Source of information: <input type="checkbox"/> measured <input checked="" type="checkbox"/> well owner <input type="checkbox"/> electric log <input type="checkbox"/> KDWR
<b>Emergency, Settling, and Burn Pits ONLY:</b> Producing Formation: _____ Number of producing wells on lease: _____ Barrels of fluid produced daily: _____ Does the slope from the tank battery allow all spilled fluids to flow into the pit? <input type="checkbox"/> Yes <input type="checkbox"/> No		<b>Drilling, Workover and Haul-Off Pits ONLY:</b> Type of material utilized in drilling/workover: <u>water</u> Number of working pits to be utilized: <u>one</u> Abandonment procedure: <u>Let dry, push rock and clay in, put top soil back on top, compact.</u> Drill pits must be closed within 365 days of spud date.
I hereby certify that the above statements are true and correct to the best of my knowledge and belief.		
<u>5/12/2010</u> Date		<u>Brian Barthelme</u> Signature of Applicant or Agent
<b>KCC OFFICE USE ONLY</b> Steel Pit <input type="checkbox"/> RFAC <input type="checkbox"/> RFAS <input type="checkbox"/>		
Date Received: <u>5-13-10</u> Permit Number: _____ Permit Date: <u>5-13-10</u> Lease Inspection: <input type="checkbox"/> Yes <input checked="" type="checkbox"/> No		

RECEIVED  
MAY 13 2010  
KCC WICHITA

15-015-00130-00-01