

15-065-21305-00-00

STATE OF KANSAS
STATE CORPORATION COMMISSION

Give All Information Completely
Make Required Affidavit
Mail or Deliver Report to:
Conservation Division
State Corporation Commission
212 North Market, Insurance Bldg.
Wichita, Kansas

WELL PLUGGING RECORD

Graham County, Sec. 27 Twp. 10S Rge. 25W (W)

Location as "NE/CNW/SW" or footage from lines SE SE SW
Lease Owner John O. Farmer, Inc.
Lease Name Schamberger Well No. #1
Office Address P.O. Box 352, Russell, KS 67665
Character of Well (completed as Oil, Gas or Dry Hole) Dry Hole
Date well completed October 20, 19 80
Application for plugging filed Yes 19
Application for plugging approved 19
Plugging commenced 19
Plugging completed 10:00 a.m., October 20, 19 80
Reason for abandonment of well or producing formation

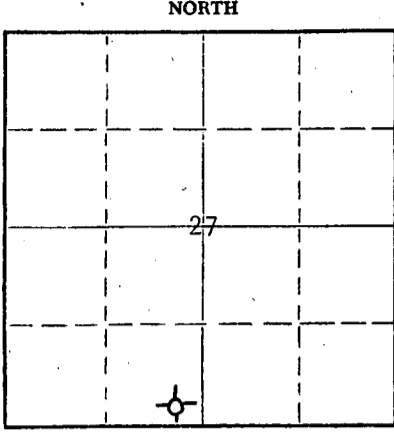

Locate well correctly on above Section Plat

If a producing well is abandoned, date of last production 19
Was permission obtained from the Conservation Division or its agents before plugging was commenced? Yes

Name of Conservation Agent who supervised plugging of this well Gilbert Balthazor
Producing formation Depth to top Bottom Total Depth of Well Feet
Show depth and thickness of all water, oil and gas formations.

OIL, GAS OR WATER RECORDS

CASING RECORD

FORMATION	CONTENT	FROM	TO	SIZE	PUT IN	PULLED OUT

Describe in detail the manner in which the well was plugged, indicating where the mud fluid was placed and the method or methods used in introducing it into the hole. If cement or other plugs were used, state the character of same and depth placed, from feet to feet for each plug set.

Plug #1 @ 1100' w/75 sxs. cement
Plug #2 @ 200' w/20 sxs. cement
Plug #3 @ 40' w/10 sxs. cement

RECEIVED
STATE CORPORATION COMMISSION
10-28-1980
OCT 28 1980
CONSERVATION DIVISION
Wichita, Kansas

(If additional description is necessary, use BACK of this sheet)

Name of Plugging Contractor John O. Farmer, Inc.
Address P.O. Box 352, Russell, KS 67665

STATE OF Kansas, COUNTY OF Russell, ss.
John O. Farmer III (employee of owner) or (owner or operator) of the above-described well, being first duly sworn on oath, says: That I have knowledge of the facts, statements, and matters herein contained and the log of the above-described well as filed and that the same are true and correct. So help me God.

(Signature) John O. Farmer III
P.O. Box 352, Russell, KS 67665 (Address)

SUBSCRIBED AND SWORN TO before me this 27th day of October, 19 80

My commission expires March 29, 1983

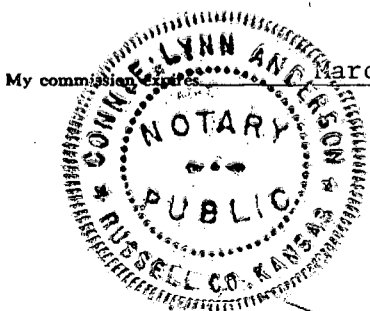

Connie Lynn Anderson
Notary Public.

IMPORTANT

Kans. Geo. Survey request samples on this well.

KANSAS

WELL COMPLETION REPORT AND DRILLER'S LOG

API No. 15 065 — 21,305 County Number

S. 27 T. 10S R. 25W SE SE SW County Graham

Operator John O. Farmer, Inc. Address P.O. Box 352, Russell, KS 67665 Well No. #1 Lease Name Schamberger Footage Location 330 feet from (N) line 330 feet from (E) line Principal Contractor John O. Farmer, Inc. Geologist Sam L. Farmer Spud Date 10-13-80 Date Completed 10-20-80 Total Depth -4080' P.B.T.D. Directional Deviation Oil and/or Gas Purchaser

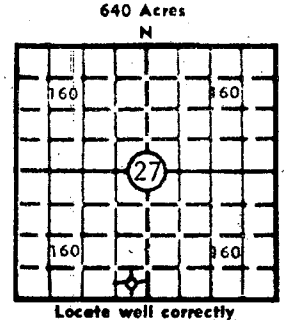

Elev.: Gr. 2498' DF 2501' KB 2503'

CASING RECORD

Report of all strings set — surface, intermediate, production, etc.

Table with 8 columns: Purpose of string, Size hole drilled, Size casing set (in O.D.), Weight lbs./ft., Setting depth, Type cement, Sacks, Type and percent additives. Row 1: Surface, 12-1/4", 8-5/8", 24, 200', Common, 150.

LINER RECORD

PERFORATION RECORD

Tables for Liner Record (Top, Bottom, Sacks cement) and Tubing Record (Size, Setting depth, Packer set at).

ACID, FRACTURE, SHOT, CEMENT SQUEEZE RECORD

Table for Acid, Fracture, Shot, Cement Squeeze Record with columns for Amount and kind of material used and Depth interval treated.

INITIAL PRODUCTION

Form for Initial Production including Date of first production, Producing method, Rate of production per 24 hours (Oil, Gas, Water, Gas-oil ratio), Disposition of gas, and Producing interval(s).

RECEIVED STATE CORPORATION COMMISSION OCT 28 1980 CONSERVATION DIVISION Wichita, Kansas

INSTRUCTIONS: As provided in KCC Rule 82-2-125, within 90 days after completion of a well, one completed copy of this Drillers Log shall be transmitted to the State Geological Survey of Kansas, 4150 Monroe Street, Wichita, Kansas 67209. Copies of this form are available from the Conservation Division, State Corporation Commission, 245 No. Water, Wichita, Kansas 67202. Phone AC 316-522-2206. If confidential custody is desired, please note Rule 82-2-125. Drillers Logs will be on open file in the Oil and Gas Division, State Geological Survey of Kansas, Lawrence, Kansas 66044.

Operator **John O. Farmer, Inc.** DESIGNATE TYPE OF COMP.: OIL, GAS, DRY HOLE, SWDW, ETC.:

Well No. #1 Lease Name **Schamberger** Dry Hole

S 27 T 10 S R 25 W^{EX} W

WELL LOG

Show all important zones of porosity and contents thereof; cored intervals, and all drill-stem tests, including depth interval tested, cushion used, time tool open, flowing and shut-in pressures, and recoveries.

SHOW GEOLOGICAL MARKERS, LOGS RUN, OR OTHER DESCRIPTIVE INFORMATION.

FORMATION DESCRIPTION, CONTENTS, ETC.	TOP	BOTTOM	NAME	DEPTH
Clay & Sand	0	115		<u>Sample Tops</u>
Blue Shale	115	200		
Shale & Sand	200	970	Anhydrite	2164 (+339)
Sand & Shale	970	1490	Topeka	3592 (-1089)
Shale & Sand Gyp.	1490	1743	Heebner	3804 (-1301)
Sand	1743	1909	Toronto	3824 (-1321)
Red Bed	1909	2150	Lansing	3840 (-1337)
Anhydrite	2150	2206	T.D.	4080 (-1577)
Shale & Shells	2206	2400		
Shale & Lime	2400	2985		
Lime & Shale	2985	3140		
Shale & Lime	3140	3630		
Lime & Shale	3630	3830		
Lime	3830	4080		

USE ADDITIONAL SHEETS, IF NECESSARY, TO COMPLETE WELL RECORD.

Date Received _____

 Signature
 Vice-President
 Title
 October 27, 1980
 Date