

STATE OF KANSAS  
STATE CORPORATION COMMISSION

WELL PLUGGING RECORD

Give All Information Completely  
Make Required Affidavit  
Mail or Deliver Report to  
Conservation Division  
State Corporation Comm.  
245 North Water  
Wichita, KS 67202

GRAHAM County, Sec. 24 Twp. 10S Rge. 25 E/W  
Location as "NE/CNW $\frac{1}{4}$ SW $\frac{1}{4}$ " or footage from lines  
NW SE NW  
Lease Owner C-G Drilling Co., Inc  
Lease Name KNOLL Well No. 1  
Office Address 340 Broadway Plaza Bldg., Wichita, KS  
Character of Well (Completed as Oil, Gas or Dry Hole)  
OIL  
Date Well completed October 9, 1962 19  
Application for plugging filed YES - April 2 1981  
Application for plugging approved YES - April 2 1981  
Plugging commenced April 2, 1981 19  
Plugging completed April 2, 1981 19  
Reason for abandonment of well or producing formation  
PLUGGED & ABANDONED  
If a producing well is abandoned, date of last production  
July 1978 19  
Was permission obtained from the Conservation Division or  
its agents before plugging was commenced? YES

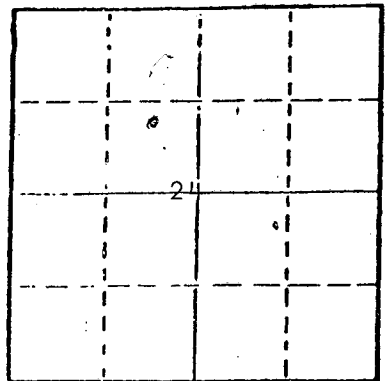

Locate well correctly on above  
Section Plot

Name of Conservation Agent who supervised plugging of this well Gilbert Balthazor  
Producing formation Kansas City Depth to top Bottom Total Depth of Well 4072'  
Show depth and thickness of all water, oil and gas formations.

OIL, GAS OR WATER RECORDS

CASING RECORD

FORMATION	CONTENT	FROM	TO	SIZE	PUT IN	PULLED OUT
				855/8	204.94	

Describe in detail the manner in which the well was plugged, indicating where the mud fluid was placed and the method or methods used in introducing it into the hold. If cement or other plugs were used, state the character of same and depth placed, from \_\_\_\_\_ feet to \_\_\_\_\_ feet for each plug set.

Mixed 3 sacks hulls - 10% gel - 35 sacks cement - 6% gel - Released  
plub - 25 cement Max 500# shut-in 200# - Finished 12:00 p.m.

(If additional description is necessary, use BACK of this sheet)

Name of Plugging Contractor Allied Cementing Coi., Inc.

STATE OF KANSAS COUNTY OF SEDGWICK, ss.  
Jay H. Galloway (employee of owner) or (owner or operator)  
of the above-described well, being first duly sworn on oath, says: That I have knowledge of the facts, statements, and matters herein contained and the log of the above-described well as filed and that the same are true and correct. So help me God.

(Signature) Jay H. Galloway  
340 Broadway Plaza Bldg, Wichita, KS  
(Address)

SUBSCRIBED AND SWORN TO before me this  
**EARLENE M. LUMRY**  
STATE NOTARY PUBLIC  
SEDGWICK COUNTY, KANSAS  
MY APPT. EXP. \_\_\_\_\_

17th day of June, 19 81  
Earlene M. Lumry  
Earlene M. Lumry Notary Public.

My commission expires September 7, 1981

RECEIVED  
STATE CORPORATION COMMISSION

JUN 18 1981

CONSERVATION DIVISION  
Wichita, Kansas

15-065-01056-0000

KANSAS

WELL COMPLETION REPORT AND DRILLER'S LOG

S. 24 T. 10S R25 EX W

Loc. NW SE NW

API No. 15 County Number

County Graham

Operator C G Drilling Co., Inc.

Address 1107 Douglas Bldg., Wichita, KS 67202

Well No. 1 Lease Name Knoll

Footage Location 1650 feet from (N) (S) line 1650 feet from (E) (W) line

Principal Contractor C G Drilling Co., Inc. Geologist

Spud Date 9/26/62 Date Completed 10/9/62 Total Depth 4072 P.B.T.D.

Directional Deviation Oil and/or Gas Purchaser

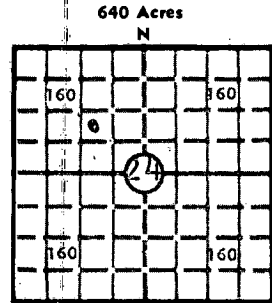

Locate well correctly

Elev.: Gr.

DF KB 2456

CASING RECORD

Report of all strings set — surface, intermediate, production, etc.

Purpose of string	Size hole drilled	Size casing set (in O.D.)	Weight lbs/ft.	Setting depth	Type cement	Sacks	Type and percent additives
Surface	12 1/4	8 5/8		204		135	
Production		5 1/2		4070		175	salt sat.

LINER RECORD

PERFORATION RECORD

Top, ft.	Bottom, ft.	Sacks cement	Shots per ft.	Size & type	Depth interval

Size	Setting depth	Packer set at

ACID, FRACTURE, SHOT, CEMENT SQUEEZE RECORD

Amount and kind of material used	Depth interval treated

RECEIVED STATE CORPORATION COMMISSION

SEP 24 1962

CONSERVATION DIVISION Wichita, Kansas

INITIAL PRODUCTION

Date of first production	Producing method (flowing, pumping, gas lift, etc.)				
RATE OF PRODUCTION PER 24 HOURS	Oil bbls.	Gas MCF	Water bbls.	Gas-oil ratio CFPB	
Disposition of gas (vented, used on lease or sold)			Producing interval(s)		

INSTRUCTIONS: As provided in KCC Rule 82-2-125, within 90 days after completion of a well, one completed copy of this Drillers Log shall be transmitted to the State Geological Survey of Kansas, 4150 Monroe Street, Wichita, Kansas 67209. Copies of this form are available from the Conservation Division, State Corporation Commission, 245 No. Water, Wichita, Kansas 67202. Phone AC 316-522-2206. If confidential custody is desired, please note Rule 82-2-125. Drillers Logs will be on an open file in the Oil and Gas Division, State Geological Survey of Kansas, Lawrence, Kansas 66044.

Operator: C G Drilling Co., Inc. DESIGNATE TYPE OF COMP.: OIL, GAS, DRY HOLE, SWDW, ETC.: 011

Well No. 1 Lease Name Knoll

S 24 T10S R 25 E W

**WELL LOG**  
 Show all important zones of porosity and contents thereof; cored intervals, and all drill-stem tests, including depth interval tested, cushion used, time tool open, flowing and shut-in pressures, and recoveries. SHOW GEOLOGICAL MARKERS, LOGS RUN, OR OTHER DESCRIPTIVE INFORMATION.

FORMATION DESCRIPTION, CONTENTS, ETC.	TOP	BOTTOM	NAME	DEPTH
Anhydrite	2118	338		
Heebner	3718	-1262		
Toronto	3743	-1287		
Lansing	3765	-1309		
B/KC	3994	-1538		
TD	4072	-1616		

USE ADDITIONAL SHEETS, IF NECESSARY, TO COMPLETE WELL RECORD.

Date Received: \_\_\_\_\_  
 Signature: *Kris Knoettgen*  
 Title: Secretary  
 Date: 9/23/80