

**KANSAS CORPORATION COMMISSION  
OIL & GAS CONSERVATION DIVISION  
APPLICATION FOR SURFACE PIT**

Form CDP-1  
April 2004  
Form must be Typed

*Submit in Duplicate*

*Correction -*

Operator Name: <b>LaVeta Oil &amp; Gas, LLC</b>		License Number: <b>32432</b> ✓
Operator Address: <b>P.O. Box 780, Middleburg, VA. 20118</b>		
Contact Person: <b>Bennie Griffin</b>		Phone Number: <b>620-458-9222</b>
Lease Name & Well No.: <b>Mary Fischer #1</b>		Pit Location (QQQQ): Approx <u>E/2</u> <u>E/2</u> <u>SE</u> Sec. <u>6</u> Twp. <u>22</u> R. <u>11</u> <input type="checkbox"/> East <input checked="" type="checkbox"/> West <u>1,200</u> Feet from <input type="checkbox"/> North / <input checked="" type="checkbox"/> South Line of Section * <u>50</u> Feet from <input checked="" type="checkbox"/> East / <input type="checkbox"/> West Line of Section <b>Stafford</b> County
Type of Pit: <input type="checkbox"/> Emergency Pit <input type="checkbox"/> Burn Pit <input type="checkbox"/> Settling Pit <input type="checkbox"/> Drilling Pit <input type="checkbox"/> Workover Pit <input checked="" type="checkbox"/> Haul-Off Pit <small>(If WP Supply API No. or Year Drilled)</small>	Pit is: <input checked="" type="checkbox"/> Proposed <input type="checkbox"/> Existing If Existing, date constructed: _____ Pit capacity: _____ (bbls)	
Is the pit located in a Sensitive Ground Water Area? <input checked="" type="checkbox"/> Yes <input type="checkbox"/> No		Chloride concentration: _____ mg/l <small>(For Emergency Pits and Settling Pits only)</small>
Is the bottom below ground level? <input checked="" type="checkbox"/> Yes <input type="checkbox"/> No	Artificial Liner? <input type="checkbox"/> Yes <input checked="" type="checkbox"/> No	How is the pit lined if a plastic liner is not used? <b>Bentonite Gel and Drilling Mud</b>
Pit dimensions (all but working pits): <u>70</u> Length (feet) <u>70</u> Width (feet) <input type="checkbox"/> N/A: Steel Pits Depth from ground level to deepest point: <u>4</u> (feet) <input type="checkbox"/> No Pit		
If the pit is lined give a brief description of the liner material, thickness and installation procedure.		Describe procedures for periodic maintenance and determining liner integrity, including any special monitoring.
Distance to nearest water well within one-mile of pit <u>2211</u> feet    Depth of water well <u>50</u> feet		Depth to shallowest fresh water <u>17</u> feet. Source of information: <input type="checkbox"/> measured <input type="checkbox"/> well owner <input type="checkbox"/> electric log <input checked="" type="checkbox"/> KDWR
<b>Emergency, Settling and Burn Pits ONLY:</b> Producing Formation: _____ Number of producing wells on lease: _____ Barrels of fluid produced daily: _____ Does the slope from the tank battery allow all spilled fluids to flow into the pit? <input type="checkbox"/> Yes <input type="checkbox"/> No		<b>Drilling, Workover and Haul-Off Pits ONLY:</b> Type of material utilized in drilling/workover: <u>Bentonite Gel, Drilling mud</u> Number of working pits to be utilized: <u>3</u> Abandonment procedure: <u>Haul off excess water, let dry, and backfill as conditions allow.</u> Drill pits must be closed within 365 days of spud date.
I hereby certify that the above statements are true and correct to the best of my knowledge and belief.		<b>RECEIVED</b> KANSAS CORPORATION COMMISSION
<u>June 26, 2008</u> Date	 Signature of Applicant or Agent	<b>JUN 27 2008</b> CONSERVATION DIVISION WICHITA KS
<b>KCC OFFICE USE ONLY</b>		
Date Received: <u>6/27/08</u>	Permit Number: <u>15-185-23521-0000</u>	Permit Date: <u>6/27/08</u> Lease Inspection: <input type="checkbox"/> Yes <input checked="" type="checkbox"/> No

**KANSAS CORPORATION COMMISSION  
OIL & GAS CONSERVATION DIVISION  
APPLICATION FOR SURFACE PIT**

Form CDP-1  
April 2004  
Form must be Typed

*Submit in Duplicate*

Operator Name: <b>LaVeta Oil &amp; Gas, LLC</b>		License Number: <b>32432</b>
Operator Address: <b>P.O. Box 780, Middleburg, VA 20118</b>		
Contact Person: <b>Bennie Griffin</b>		Phone Number: <b>620-458-9222</b>
Lease Name & Well No.: <b>Mary Fischer #1</b>		Pit Location (QQQQ): <b>NE - SE - SE -</b>
Type of Pit: <input type="checkbox"/> Emergency Pit <input type="checkbox"/> Burn Pit <input type="checkbox"/> Settling Pit <input type="checkbox"/> Drilling Pit <input type="checkbox"/> Workover Pit <input checked="" type="checkbox"/> Haul-Off Pit <small>(If WP Supply API No. or Year Drilled)</small>	Pit is: <input checked="" type="checkbox"/> Proposed <input type="checkbox"/> Existing If Existing, date constructed: _____ Pit capacity: _____ (bbls)	Sec. <u>6</u> Twp. <u>22</u> R. <u>11</u> <input type="checkbox"/> East <input checked="" type="checkbox"/> West <u>1,200</u> Feet from <input type="checkbox"/> North / <input checked="" type="checkbox"/> South Line of Section <u>100</u> Feet from <input checked="" type="checkbox"/> East / <input type="checkbox"/> West Line of Section <b>Stafford</b> _____ County
Is the pit located in a Sensitive Ground Water Area? <input checked="" type="checkbox"/> Yes <input type="checkbox"/> No		Chloride concentration: _____ mg/l <small>(For Emergency Pits and Settling Pits only)</small>
Is the bottom below ground level? <input checked="" type="checkbox"/> Yes <input type="checkbox"/> No	Artificial Liner? <input type="checkbox"/> Yes <input checked="" type="checkbox"/> No	How is the pit lined if a plastic liner is not used?
Pit dimensions (all but working pits): <u>70</u> Length (feet) <u>70</u> Width (feet) <input type="checkbox"/> N/A: Steel Pits Depth from ground level to deepest point: <u>4</u> (feet) <input type="checkbox"/> No Pit		
If the pit is lined give a brief description of the liner material, thickness and installation procedure. <b>n/a</b>		Describe procedures for periodic maintenance and determining liner integrity, including any special monitoring. <b>n/a</b>
Distance to nearest water well within one-mile of pit <u>2200</u> feet    Depth of water well <u>50</u> feet		Depth to shallowest fresh water <u>17</u> feet. Source of information: <input type="checkbox"/> measured <input type="checkbox"/> well owner <input type="checkbox"/> electric log <input checked="" type="checkbox"/> KDWR
<b>Emergency, Settling and Burn Pits ONLY:</b> Producing Formation: _____ Number of producing wells on lease: _____ Barrels of fluid produced daily: _____ Does the slope from the tank battery allow all spilled fluids to flow into the pit? <input type="checkbox"/> Yes <input type="checkbox"/> No		<b>Drilling, Workover and Haul-Off Pits ONLY:</b> Type of material utilized in drilling/workover: <u>water and bent, mud</u> Number of working pits to be utilized: <u>1</u> Abandonment procedure: <u>let evaporate, haul excess free water, push back in with sandy soil on top.</u> Drill pits must be closed within 365 days of spud date.
I hereby certify that the above statements are true and correct to the best of my knowledge and belief.		
<u>5/2/08</u> Date		 Signature of Applicant or Agent
<b>KCC OFFICE USE ONLY</b>		
Date Received: <u>5/2/08</u> Permit Number: <u>15-185-23521-010</u> Permit Date: <u>5/5/08</u>		Steel Pit <input type="checkbox"/> RFAC <input checked="" type="checkbox"/> RFAS <input checked="" type="checkbox"/>
Lease Inspection: <input checked="" type="checkbox"/> Yes <input type="checkbox"/> No		

Mail to: KCC - Conservation Division, 130 S. Market - Room 2078, Wichita, Kansas 67202



Kathleen Sebelius, Governor  
Thomas E. Wright, Chairman  
Michael C. Moffet, Commissioner  
Joseph F. Harkins, Commissioner

May 5, 2008

Mr. Bennie Griffin  
LaVeta Oil & Gas, LLC  
PO Box 780  
Middleburg, VA 20118

RE: Haul-Off Pit Application  
Mary Fischer Lease Well No. 1  
SE/4 Sec. 06-22S-11W  
Stafford County, Kansas

Dear Mr. Griffin:

District staff has inspected the above referenced location and has determined that the haul-off pit shall be constructed **without slots**, the bottom shall be flat and reasonably level, and the free fluids must be removed. The fluids are to be removed from the haul-off pit as soon as the Hutchinson Salt section has been drilled through and displacement of the fluids into the haul-off pit has occurred. The fluids should be removed again as soon as practical after haul-off operations have ceased.

**NO completion fluids or non-exempt wastes shall be placed in the haul-off pit.**

The fluids should be taken to an authorized disposal well. Please call the District Office at (620) 225-8888 when the fluids have been removed. Please file form CDP-5 (August 2004), Exploration and Production Waste Transfer, within 30 days of fluid removal. Conservation division forms are available through our office and on the KCC web site: [www.kcc.state.ks.us/conservation/forms](http://www.kcc.state.ks.us/conservation/forms).

**A copy of this letter should be posted in the doghouse along with the approved Intent to Drill.**

If you have any questions or concerns please feel free to contact the undersigned at the above address.

Sincerely,

A handwritten signature in black ink that reads "Kathy Haynes".

Kathy Haynes  
Environmental Protection and Remediation Department

cc: district office



*Kathleen Sebelius, Governor  
Thomas E. Wright, Chairman  
Michael C. Moffet, Commissioner  
Joseph F. Harkins, Commissioner*

### HAUL-OFF PIT APPLICATION FILING REQUIREMENTS

**82-3-607. DISPOSAL OF DIKE AND PIT CONTENTS.**

- (a) Each operator shall perform one of the following when disposing of dike or pit contents:
- (1) Remove the liquid contents to a disposal well or other oil and gas operation approved by the commission or to road maintenance or construction locations approved by the department;
  - (2) dispose of reserve pit waste down the annular space of a well completed according to the alternate I requirements of K.A.R. 82-3-106, if the waste to be disposed of was generated during the drilling and completion of the well; or
  - (3) dispose of the remaining solid contents in any manner required by the commission. The requirements may include any of the following:
    - (A) Burial in place, in accordance with the grading and restoration requirements in K.A.R. 82-3-602 (f);
    - (B) removal and placement of the contents in an on-site disposal area approved by the commission;
    - (C) removal and placement of the contents in an off-site disposal area on acreage owned by the same landowner or to another producing lease or unit operated by the same operator, if prior written permission from the landowner has been obtained; or
    - (D) removal of the contents to a permitted off-site disposal area approved by the department.
- (b) Each violation of this regulation shall be punishable by the following:
- (1) A \$1,000 penalty for the first violation;
  - (2) a \$2,500 penalty for the second violation; and
  - (3) a \$5,000 penalty and an operator license review for the third violation.

**Complete and return with Haul-Off Pit Application, Form CDP1(2004)**

Haul-off pit will be located in an on-site disposal area:  Yes  No

Haul-off pit is located in an off-site disposal area on acreage owned by the same landowner:  
 Yes  No If yes, written permission from the landowner must be obtained. Attach written permission to haul-off pit application.

Haul-off pit is located in an off-site disposal area on another **producing** lease or unit operated by the same operator:  Yes  No If yes, written permission from the landowner must be obtained. Attach permission and a copy of the lease assignment that covers the acreage where the haul-off pit is to be located, to the haul-off pit application.

**IN ALL CASES PLOT THE INTENDED WELL ON THE PLAT BELOW**

*Plat of acreage attributable to a well in a prorated or spaced field*

**If the intended well is in a prorated or spaced field, please fully complete this side of the form.** If the intended well is in a prorated or spaced field complete the plat below showing that the well will be properly located in relationship to other wells producing from the common source of supply. Please show all the wells and within 1 mile of the boundaries of the proposed acreage attribution unit for gas wells and within 1/2 mile of the boundaries of the proposed acreage attribution unit for oil wells.

API No. 15 - \_\_\_\_\_  
 Operator: LaVeta Oil & Gas, LLC  
 Lease: Mary Fischer  
 Well Number: 1  
 Field: \_\_\_\_\_  
 Number of Acres attributable to well: \_\_\_\_\_  
 QTR / QTR / QTR of acreage: SE - SW - SE

Location of Well: County: Stafford  
 330 \_\_\_\_\_ feet from  N /  S Line of Section  
 1840 \_\_\_\_\_ feet from  E /  W Line of Section  
 Sec. 6 Twp. 22 S. R. 11  East  West

Is Section:  Regular or  Irregular

**If Section is Irregular, locate well from nearest corner boundary.**

Section corner used:  NE  NW  SE  SW

**PLAT**

*(Show location of the well and shade attributable acreage for prorated or spaced wells.)  
 (Show footage to the nearest lease or unit boundary line.)*

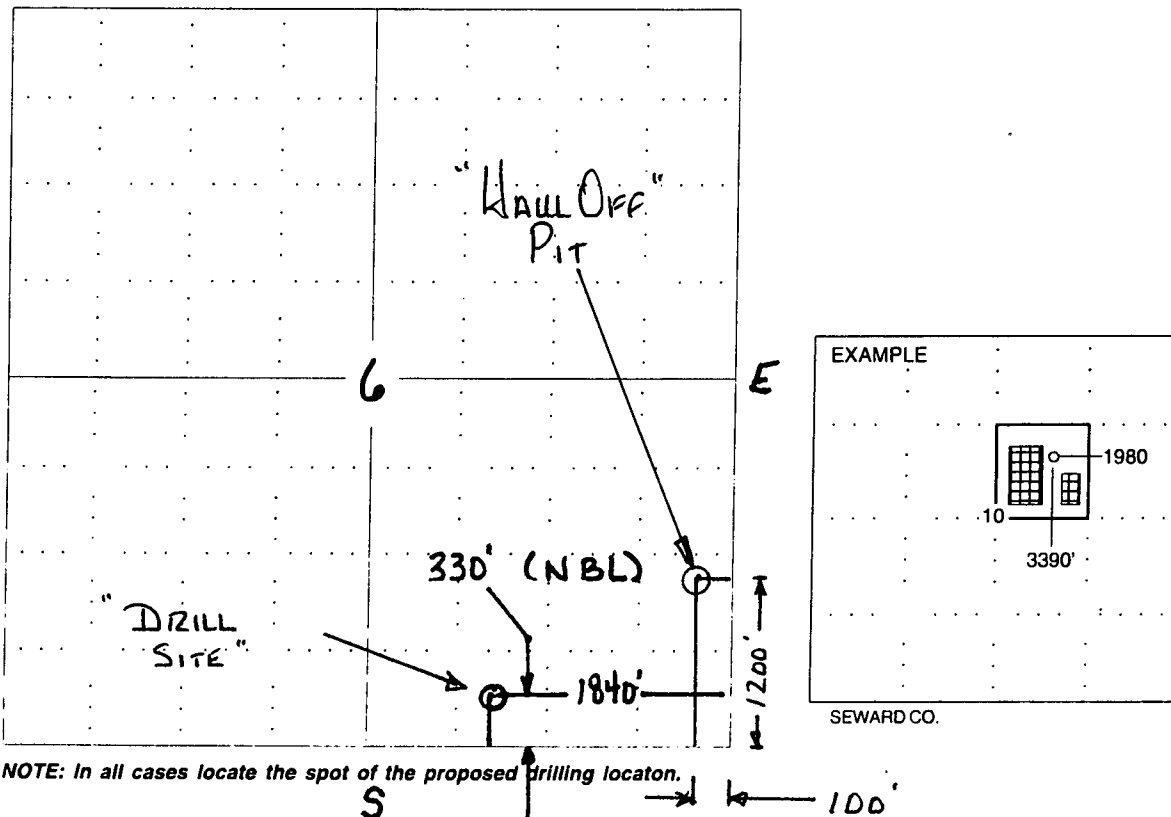

**In plotting the proposed location of the well, you must show:**

1. The manner in which you are using the depicted plat by identifying section lines, i.e. 1 section, 1 section with 8 surrounding sections, 4 sections, etc.
2. The distance of the proposed drilling location from the section's south / north and east / west.
3. The distance to the nearest lease or unit boundary line.
4. If proposed location is located within a prorated or spaced field a certificate of acreage attribution plat must be attached: (CO-7 for oil wells; CG-8 for gas wells).