

FOR KCC USE:

EFFECTIVE DATE: 6-20-92
DISTRICT # 4
SSAT... Yes... No

State of Kansas
NOTICE OF INTENTION TO DRILL

FORM C-1 7/91
FORM MUST BE TYPED
FORM MUST BE SIGNED
ALL BLANKS MUST BE FILLED

Must be approved by the K.C.C. five (5) days prior to commencing well

Expected Spud Date 7 1 92
month day year

Spot SW NE NE Sec 3 Twp 10 S, Rg 26 East West

OPERATOR: License # 6875
Name: Marmik Oil Company
Address: 200 N. Jefferson, Suite 500
City/State/Zip: El Dorado, AR 71730
Contact Person: Curtis G. Morrill
Phone: 501-862-8546

990 feet from South (North) line of Section
960 feet from (East) West line of Section
IS SECTION X REGULAR IRREGULAR

(NOTE: Locate well on the Section Plat on Reverse Side)

County: Sheridan
Lease Name: Ziegler Well #: 2
Field Name: Wildcat

CONTRACTOR: License # Will Advise on ACQ-1
Name: Unknown

Is this a Prorated/Spaced Field? yes X no
Target Formation(s): IKC

Nearest lease or unit boundary: 960
Ground Surface Elevation: 2601 feet MSL

Well Drilled For: Well Class: Type Equipment:
X Oil ... Enh Rec ... Infield X Mud Rotary
... Gas ... Storage ... Pool Ext. ... Air Rotary
... OUVO ... Disposal X Wildcat ... Cable
... Seismic: ... # of Holes ... Other

Water well within one-quarter mile: yes X no
Public water supply well within one mile: yes X no

Depth to bottom of fresh water: 100
Depth to bottom of usable water: 1290

Surface Pipe by Alternate: 1 X 2
Length of Surface Pipe Planned to be set: 200

If OUVO: old well information as follows:
Operator:
Well Name:
Comp. Date: Old Total Depth

Length of Conductor pipe required:
Projected Total Depth: 4000'

Formation at Total Depth: PENN

Water Source for Drilling Operations:
... well X farm pond ... other

Directional, Deviated or Horizontal wellbore? yes X no
If yes, true vertical depth:
Bottom Hole Location:

DWR Permit #:
Will Cores Be Taken? yes X no

If yes, proposed zone:

AFFIDAVIT

The undersigned hereby affirms that the drilling, completion and eventual plugging of this well will comply with K.S.A. 55-101, et. seq.
It is agreed that the following minimum requirements will be met:

- 1. Notify the appropriate district office prior to spudding of well;
- 2. A copy of the approved notice of intent to drill shall be posted on each drilling rig;
- 3. The minimum amount of surface pipe as specified below shall be set by circulating cement to the top; in all cases surface pipe shall be set through all unconsolidated materials plus a minimum of 20 feet into the underlying formation;
- 4. If the well is dry hole, an agreement between the operator and the district office on plug length and placement is necessary prior to plugging;
- 5. The appropriate district office will be notified before well is either plugged or production casing is cemented in;
- 6. IF AN ALTERNATE II COMPLETION, PRODUCTION PIPE SHALL BE CEMENTED FROM BELOW ANY USABLE WATER TO SURFACE WITHIN 120 DAYS OF SPUD DATE. IN ALL CASES, NOTIFY DISTRICT OFFICE PRIOR TO ANY CEMENTING.

I hereby certify that the statements made herein are true and to the best of my knowledge and belief.

Date: 6-12-92 Signature of Operator or Agent: Curtis G. Morrill Title: GEOLOGIST

FOR KCC USE:
API # 15-179-21041-0000
Conductor pipe required None feet
Minimum surface pipe required 200 feet per Alt. X(2)
Approved by: C.B. 6-15-92
This authorization expires: 6-12-15-92
(This authorization void if drilling not started within 6 months of effective date.)
Spud date: Agent:

REMEMBER TO:

- File Drill Pit Application (form GDP-1) with Intent to Drill;
- File Completion Form ACQ-1 within 120 days of spud date;
- File acreage attribution plat according to field proration orders;
- Notify appropriate district office 48 hours prior to workover or re-entry;
- Submit plugging report (CP-4) after plugging is completed;
- Obtain written approval before disposing or injecting salt water.

Mail to: Conservation Division, 200 Colorado Derby Building, 202 W. First St., Wichita, Kansas 67202-1200

RECEIVED
STATE CORPORATION COMMISSION
JUN 15 1992
CONSERVATION DIVISION
Wichita, Kansas

W
10
26

IN ALL CASES PLOT THE INTENDED WELL LOCATION PLAT BELOW

PLAT OF ACREAGE ATTRIBUTABLE TO A WELL IN A PRORATED OR SPACED FIELD

If the intended well is in a prorated or spaced field, please fully complete this side of the form. If the intended well is in a prorated or spaced field complete the plat below showing that the well will be properly located in relationship to other wells producing from the common source of supply. Please show all the wells within 1 mile of the boundaries of the proposed acreage attribution unit for gas wells and within 1/2 mile of the boundaries of the proposed acreage attribution unit for oil wells.

API NO. 15- _____
 OPERATOR Marmik Oil Company
 LEASE Ziegler
 WELL NUMBER 2
 FIELD _____

LOCATION OF WELL: COUNTY Sheridan
990 feet from south/north line of section
960 feet from east/west line of section
 SECTION 3 TWP 10S RG 26W

NUMBER OF ACRES ATTRIBUTABLE TO WELL 10
 QTR/QTR/QTR OF ACREAGE SW - NE - NE

IS SECTION X REGULAR or _____ IRREGULAR
IF SECTION IS IRREGULAR, LOCATE WELL FROM NEAREST CORNER BOUNDARY.

Section corner used: X NE _____ NW _____ SE _____ SW

PLAT

(Show location of the well and shade attributable acreage for prorated or spaced wells.)
 (Show footage to the nearest lease or unit boundary line.)

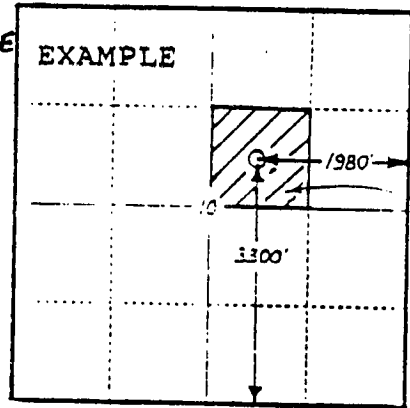
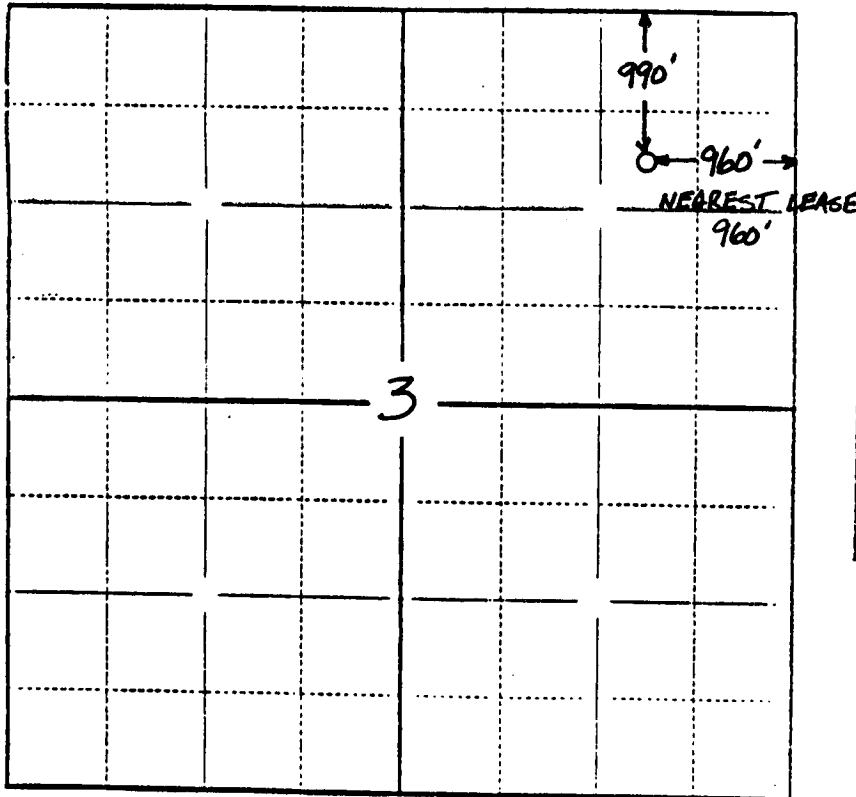

40 ACRES

SEWARD CO.

In plotting the proposed location of the well, you must show:

- 1) The manner in which you are using the depicted plat by identifying section lines, i.e. 1 section, 1 section with 8 surrounding sections, 4 sections, etc.;
- 2) the distance of the proposed drilling location from the section's south/north and east/west lines; and
- 3) the distance to the nearest lease or unit boundary line.