

STATE OF KANSAS
STATE CORPORATION COMMISSION

WELL PLUGGING RECORD

Give All Information Completely
Make Required Affidavit
Mail or Deliver Report to
Conservation Division
State Corporation Comm.
245 North Water
Wichita, KS 67202

Graham County. Sec. 20 Twp. 10S Rge. 25W E/W
Location as "NE/CNW $\frac{1}{4}$ /SW $\frac{1}{4}$ " or footage from lines _____
NE NW NE
Lease Owner John O. Farmer, Inc.
Lease Name PFEIFER Well No. 1
Office Address P.O. Box 352, Russell, Kansas, 67665
Character of Well (Completed as Oil, Gas or Dry Hole) _____
Dry Hole

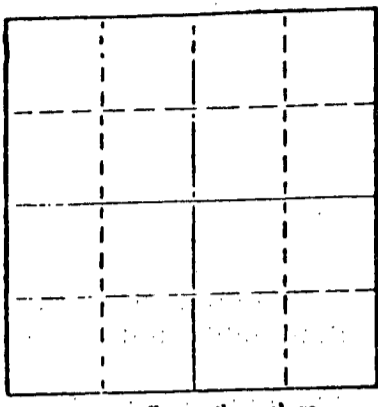

Date Well completed 9/4/76 19
Application for plugging filed _____ 19
Application for plugging approved _____ 19
Plugging commenced _____ 19
Plugging completed 9/4/76 19
Reason for abandonment of well or producing formation _____

If a producing well is abandoned, date of last production _____ 19
Was permission obtained from the Conservation Division or its agents before plugging was commenced? Yes

Name of Conservation Agent who supervised plugging of this well Gilbert Balthazor
Producing formation _____ Depth to top _____ Bottom _____ Total Depth of Well _____
Show depth and thickness of all water, oil and gas formations.

OIL, GAS OR WATER RECORDS

CASING RECORD

FORMATION	CONTENT	FROM	TO	SIZE	PUT IN	PULLED OUT

Describe in detail the manner in which the well was plugged, indicating where the mud fluid was placed and the method or methods used in introducing it into the hold. If cement or other plugs were used, state the character of same and depth placed, from _____ feet to _____ feet for each plug set.

- Plug #1 1100' w/ 70 sx. cement
- Plug #2 200' w/ 20 sx. cement
- Plug #3 40' w/ 10 sx. cement

RECEIVED
STATE CORPORATION COMMISSION
9-15-1976
SEP 15 1976

(If additional description is necessary, use BACK of this sheet)

Name of Plugging Contractor John O. Farmer, Inc.
P.O. Box 352, Russell, Kansas 67665

STATE OF KANSAS COUNTY OF RUSSELL ss.

John O. Farmer (owner or operator) of the above-described well, being first duly sworn on oath, says: That I have knowledge of the facts, statements, and matters herein contained and the log of the above-described well as filed and that the same are true and correct. So help me God.

(Signature) John O. Farmer
P.O. Box 352, Russell, Kansas 67665
(Address)

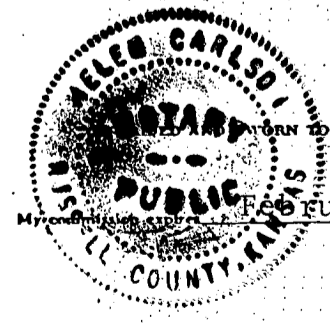

Subscribed and sworn to before me this 10th day of September, 19 76

Helen Carlson
HELEN CARLSON Notary Public.

February 15, 1979

15-065-20858-00-00

KANSAS DRILLERS LOG

API No. 15 _____
 County _____ Number _____

S. 20 T. 10 R. 25 ^{EC} _W

Loc. NE NW NE

County Graham

Operator
 John O. Farmer, Inc.

Address
 P.O. Box 352, Russell, Kansas 67665

Well No. 1 Lease Name PFEIFER

Footage Location
 330 feet from (N) (X) line 990 feet from (W) line

Principal Contractor John O. Farmer, Inc. Geologist Sam Farmer

Spud Date 8-28-76 Total Depth 4090' P.B.T.D. None

Date Completed 9-4-76 Oil Purchaser None - D & A

640 Acres
 N

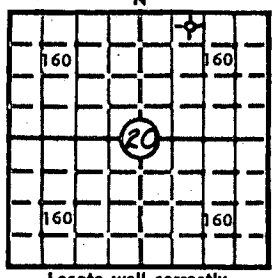

Locate well correctly

Elev.: Gr. 2550'

DF 2553' KB 2555'

CASING RECORD

Report of all strings set — surface, intermediate, production, etc.

Purpose of string	Size hole drilled	Size casing set (in O.D.)	Weight lbs/ft.	Setting depth	Type cement	Sacks	Type and percent additives
Surface	12 1/4	8-5/8"	26	231'	Common	160	

LINER RECORD

PERFORATION RECORD

Top, ft.	Bottom, ft.	Sacks cement	Shots per ft.	Size & type	Depth interval

TUBING RECORD

Size	Setting depth	Packer set at

ACID, FRACTURE, SHOT, CEMENT SQUEEZE RECORD

Amount and kind of material used	Depth interval treated

INITIAL PRODUCTION

RECORDED
 STATE CORPORATION COMMISSION
 9-15-1976
 SEP 15 1976

Date of first production _____ Producing method (flowing, pumping, gas lift, etc.) _____

RATE OF PRODUCTION PER 24 HOURS
 Oil _____ bbls. Gas _____ MCF Water _____ bbls. Gas-oil ratio _____ CFPB

Disposition of gas (vented, used on lease or sold) _____ Producing interval(s) _____

INSTRUCTIONS: As provided in KCC Rule 82-2-125, within 90 days after completion of a well, one completed copy of this Drillers Log shall be transmitted to the State Geological Survey of Kansas, 4150 Monroe Street, Wichita, Kansas 67209. Copies of this form are available from the Conservation Division, State Corporation Commission, 3830 So. Meridian (P.O. Box 17027), Wichita, Kansas 66217. Phone AC 316-522-2206. If confidential custody is desired, please note Rule 82-2-125. Drillers Logs will be on open file in the Oil and Gas Division, State Geological Survey of Kansas, Lawrence, Kansas 66044.

Operator John O. Farmer		DESIGNATE TYPE OF COMP.: OIL, GAS, DRY HOLE, SWDW, ETC.:
Well No. 1	Lease Name PFEIFER	Dry Hole
S20 T10 R25 ^K_W		

WELL LOG

Show all important zones of porosity and contents thereof; cored intervals, and all drill-stem tests, including depth interval tested, cushion used, time tool open, flowing and shut-in pressures, and recoveries.

SHOW GEOLOGICAL MARKERS, LOGS RUN, OR OTHER DESCRIPTIVE INFORMATION.

FORMATION DESCRIPTION, CONTENTS, ETC.	TOP	BOTTOM	NAME	DEPTH
			<u>SAMPLE TOPS:</u>	
Shale	200	1200		
Sand	1200	1255	Anhydrite	2197' (+358)
Shale & Sand	1255	1780	Heebner	3809' (-1254)
Sand	1780	1960	Toronto	3830' (-1275)
Red Bed	1960	2197	Lansing	3848' (-1293)
Anhydrite	2197	2234	B/KC	4084' (-1529)
Shale	2234	2285	T.D.	4090' (-1535)
Shale & Shells	2285	2760		
Shale & Lime	2760	2885		
Lime & Shale	2885	3045		
Shale & lime	3045	3210		
Lime & Shale	3210	3915		
Lime	3915	4090		
T.D.	4090			

USE ADDITIONAL SHEETS, IF NECESSARY, TO COMPLETE WELL RECORD.

Date Received	<div style="border-bottom: 1px solid black; margin-bottom: 5px;"><i>John O. Farmer</i></div> <div style="border-bottom: 1px solid black; margin-bottom: 5px;">Signature</div> <div style="border-bottom: 1px solid black; margin-bottom: 5px;">President</div> <div style="border-bottom: 1px solid black; margin-bottom: 5px;">Title</div> <div style="border-bottom: 1px solid black; margin-bottom: 5px;">September 10, 1976</div> <div style="border-bottom: 1px solid black; margin-bottom: 5px;">Date</div>
---------------	---