

15-065-02064-0000

STATE OF KANSAS  
STATE CORPORATION COMMISSION

Give All Information Completely  
Make Required Affidavit  
Mail or Deliver Report to:  
Conservation Division  
State Corporation Commission  
212 North Market, Insurance Bldg.  
Wichita, Kansas

WELL PLUGGING RECORD

NORTH

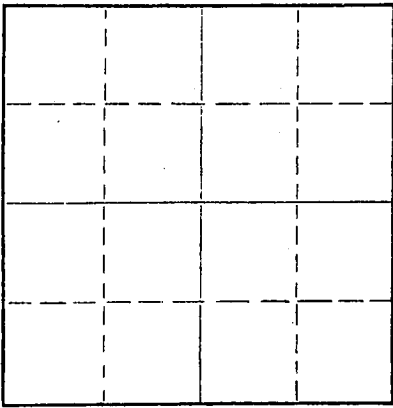

Locate well correctly on above  
Section Plat

Graham County, Sec. 18 Twp. 10S Rge. (E) 25 (W)

Location as "NE/CNW%SW%" or footage from lines CEL. NW SW

Lease Owner JOHN O. FARMER, INC.

Lease Name WALDT Well No. 2

Office Address Russell, Kansas

Character of Well (completed as Oil, Gas or Dry Hole) Dry

Date well completed 11/29 1959

Application for plugging filed 11/29 1959

Application for plugging approved 11/29 1959

Plugging commenced 11/29 1959

Plugging completed 11/29 1959

Reason for abandonment of well or producing formation Dry

If a producing well is abandoned, date of last production 19

Was permission obtained from the Conservation Division or its agents before plugging was commenced? yes

Name of Conservation Agent who supervised plugging of this well Fabricius, Hill City, Kansas

Producing formation \_\_\_\_\_ Depth to top \_\_\_\_\_ Bottom \_\_\_\_\_ Total Depth of Well 4023 Feet

Show depth and thickness of all water, oil and gas formations.

OIL, GAS OR WATER RECORDS

CASING RECORD

FORMATION	CONTENT	FROM	TO	SIZE	PUT IN	PULLED OUT
				8-5/8"	190*	None

Describe in detail the manner in which the well was plugged, indicating where the mud fluid was placed and the method or methods used in introducing it into the hole. If cement or other plugs were used, state the character of same and depth placed, from \_\_\_\_\_ feet to \_\_\_\_\_ feet for each plug set.

First plug set at 500 feet with 20 sacks cement

Second plug set at 185 feet with 20 sacks cement

Third plug set at 40 feet with 10 sacks cement

FILED  
STATE CORPORATION COMMISSION  
DEC 8 1959  
CONSERVATION DIVISION  
Wichita, Kansas

(If additional description is necessary, use BACK of this sheet)

Name of Plugging Contractor JOHN O. FARMER, INC.

Address Russell, Kansas

STATE OF KANSAS, COUNTY OF RUSSELL, ss.

I, JOHN O. FARMER (employee of owner) or (owner or operator) of the above-described well, being first duly sworn on oath, says: That I have knowledge of the facts, statements, and matters herein contained and the log of the above-described well as filed and that the same are true and correct. So help me God.

(Signature) John O. Farmer

Russell, Kansas

(Address)

SUBSCRIBED AND SWORN to before me this 7th day of December, 1959

My commission expires October 11, 1962

Lucille Kennedy

Notary Public.



OPERATOR JOHN O. FARMER, INC.

FORMATION RECORD

ADDRESS Russell, Kansas

Give detailed description and thickness of all formation drilled through, contents of sand, whether dry, water, oil or gas.

15-065-02064-0000  
 25 RGE. 105 TWP. 18 SEC. 2 COUNTY GRAHAM WELL NO. 2 FARM NAME WALDT

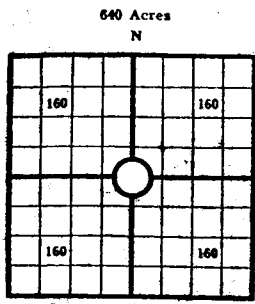

COUNTY Graham, SEC. 18, TWP. 105, RGE. 25W  
 COMPANY OPERATING JOHN O. FARMER, INC.  
 OFFICE ADDRESS Russell, Kansas  
 DRILLING STARTED....., 19....., DRILLING FINISHED....., 19.....  
 DATE OF FIRST PRODUCTION..... COMPLETED.....  
 WELL LOCATED CEL 1/4 NW 1/4 SW 1/4, North of South  
 Line and.....ft. East of West Line of Quarter Section  
 Elevation (Relative to sea level) DERRICK FLOOR 2571 GROUND, 2566  
 CHARACTER OF WELL (Oil, gas or dryhole)..... Dry

OIL OR GAS SANDS OR ZONES

Name	From	To	Name	From	To
1			4		
2			5		
3			6		

Perforating Record If Any

Shot Record

Formation	From	To	No. of Shots	Formation	From	To	Size of Shot

CASING RECORD

Amount Set				Amount Pulled				Packer Record			
Size	Wt.	Thds.	Make	Ft.	In.	Ft.	In.	Size	Length	Depth Set	Make
8-5/8				190							

Liner Record: Amount..... Kind..... Top..... Bottom.....

CEMENTING AND MUDDING

Size	Amount Set		Sacks Cement	Chemical		Method of Cementing	Amount	Mudding Method	Results (See Note)
	Ft.	In.		Gal.	Make				
8-5/8	190		135						

Note: What method was used to protect sands if outer strings were pulled?.....

NOTE: Were bottom hole plugs used?..... If so, state kind, depth set and results obtained.....

TOOLS USED

Rotary Tools were used from..... feet to..... Cable tools were used from..... feet to..... feet, and from..... feet to..... feet, and from..... feet to.....

Type Rig.....

INITIAL PRODUCTION TEST

Describe initial test: whether by flow through tubing or casing or by pumping.....

Amount of Oil Production..... bbls. Size of choke, if any..... Length of test..... Water

Production..... bbls. Gravity of oil..... Type of Pump if pump is used, describe.....

Formation	Top	Bottom	Formation	Top	Bottom
<b>FARM NAME:</b>			<b>WALDT #2</b>		
Clay & sand	0	130			
Rock	130	160			
Blue Clay	160	1200			
Shale & shells	1200	2190			
Anhydrite	2190	2230			
Shale & shells	2230	2575			
Shale & lime	2575	2840			
Lime & shale	2840	3815	<b>ELEVATION:</b>	<b>KB</b>	<b>2575</b>
Lime	3815	4023	<b>SAMPLE TOPS:</b>		
T.D.	4023	4023	Anhydrite		2190
			Heebner		3787
			Toronto		3819
			Lansing		3835
			T.D.		4023
			<b>D &amp; A</b>		

I, the undersigned, being first duly sworn upon oath, state that this well record is true, correct and complete according to the records of this office and to the best of my knowledge and belief.

*John O. Farmer* President  
 Name and title of representative of company

Subscribed and sworn to before me this 7th day of December, 1959

My Commission expires 10/11/62  
*Luella Kennedy*  
 Notary Public