

KANSAS CORPORATION COMMISSION  
OIL & GAS CONSERVATION DIVISION  
**WELL PLUGGING APPLICATION**  
Please TYPE Form and File ONE Copy

Form CP-1  
March 2009  
This Form must be Typed  
Form must be Signed  
All blanks must be Filled

OPERATOR: License #: 5004  
Name: Vincent Oil Corporation  
Address 1: 155 N. Market, Ste 700  
Address 2: \_\_\_\_\_  
City: Wichita State: Ks Zip: 67202 + \_\_\_\_\_  
Contact Person: M.L. Korphage  
Phone: (316) 682-9464

API No. ~~13~~- 15-151-20894-00-00  
If pre 1967, supply original completion date: \_\_\_\_\_  
Spot Description: NW-NE  
\_\_\_\_ - \_\_\_\_ NW-NE Sec. 19 Twp. 27 S. R. 15  East  West  
660 Feet from  North /  South Line of Section  
1,980 Feet from  East /  West Line of Section  
Footages Calculated from Nearest Outside Section Corner:  
 NE  NW  SE  SW  
County: Pratt  
Lease Name: Weller "A" Well #: 1

Check One:  Oil Well  Gas Well  OG  D&A  Cathodic  Water Supply Well  Other: \_\_\_\_\_  
 SWD Permit #: \_\_\_\_\_  ENHR Permit #: \_\_\_\_\_  Gas Storage Permit #: \_\_\_\_\_

Conductor Casing Size: \_\_\_\_\_ Set at: \_\_\_\_\_ Cemented with: \_\_\_\_\_ Sacks  
Surface Casing Size: 8 5/8" Set at: 382' Cemented with: 275 Sacks  
Production Casing Size: 5 1/2" Set at: 4599' Cemented with: 200 Sacks

List (ALL) Perforations and Bridge Plug Sets:

Perforations at: 4430 to 4434'

Elevation: 2081 ( G.L. /  K.B.) T.D.: 4650' PBTD: 4649' Anhydrite Depth: 980'  
(Stone Corral Formation)

Condition of Well:  Good  Poor  Junk in Hole  Casing Leak at: \_\_\_\_\_  
(Interval)

Proposed Method of Plugging (attach a separate page if additional space is needed):

Will plug per KCC rules and regulations and direction of KCC District Office

Is Well Log attached to this application?  Yes  No Is ACO-1 filed?  Yes  No

If ACO-1 not filed, explain why:

See Attached Completion report / Kansas Drillers Log

RECEIVED  
APR 19 2010  
KCC WICHITA

Plugging of this Well will be done in accordance with K.S.A. 55-101 et. seq. and the Rules and Regulations of the State Corporation Commission

Company Representative authorized to supervise plugging operations: Pat Livingston

Address: 20275 SW 20th Avenue City: Pratt State: Ks Zip: 67124 + \_\_\_\_\_

Phone: (620) 388-6143

Plugging Contractor License #: 31925 Name: Quality Well Service

Address 1: 190 US 56 Highway Address 2: \_\_\_\_\_

City: Ellinwood State: Ks Zip: 67526 + \_\_\_\_\_

Phone: (620) 938-2388

Proposed Date of Plugging (if known): \_\_\_\_\_

Payment of the Plugging Fee (K.A.R. 82-3-118) will be guaranteed by Operator or Agent

Date: 4/15/2010 Authorized Operator / Agent: M. L. Korphage  
(Signature)

Mail to: KCC - Conservation Division, 130 S. Market - Room 2078, Wichita, Kansas 67202

*[Handwritten signature]*

KANSAS

WELL COMPLETION REPORT AND DRILLER'S LOG

S. 19 T. 27S R. 15W  
Loc. C NW NE

County Pratt

API No. 15 — 151 — 20,894  
County Number

Operator Vincent Oil Corporation

Address 230 O. W. Garvey Bldg.; Wichita, KS 67202

Well No. #1 Lease Name Weller "A"

Footage Location  
feet from (N) (S) line feet from (E) (W) line

Principal Contractor Slawson Drilling Company Geologist Terry McLeod

Spud Date 4/7/81 Date Completed 5/28/81 Total Depth 4600' P.B.T.D.

Directional Deviation Oil and/or Gas Purchaser Panhandle Eastern Pipeline Co.

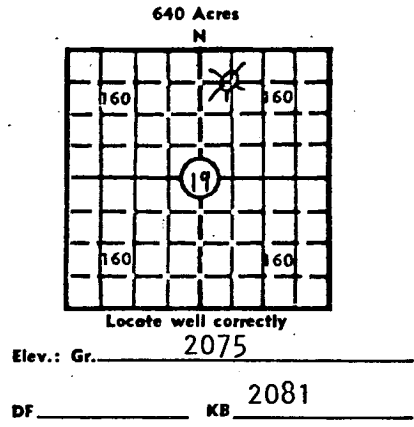

CASING RECORD

Report of all strings set—surface, intermediate, production, etc.

Purpose of string	Size hole drilled	Size casing set (in O.D.)	Weight lbs/ft.	Setting depth	Type cement	Sacks	Type and percent additives
Surface	12-1/4"	8-5/8"	24#	387'	60-40 Pozmix	275	2% gel, 3% CC
Production		5-1/2"	14#	4599'	Regular Class	200	10% salt, 2% gel, 3/4 of 1% CFR-2

LINER RECORD

PERFORATION RECORD

Top, ft.	Bottom, ft.	Sacks cement	Shots per ft.	Size & type	Depth interval

Size	Setting depth	Packer set at

ACID, FRACTURE, SHOT, CEMENT SQUEEZE RECORD

Amount and kind of material used	Depth interval treated
	RECEIVED
	APR 19 2010
	KCC WICHITA

INITIAL PRODUCTION

Date of first production	Producing method (flowing, pumping, gas lift, etc.)			
RATE OF PRODUCTION PER 24 HOURS	Oil bbls.	Gas MCF	Water bbls.	Gas-oil ratio CFPB
Disposition of gas (vented, used on lease or sold)			Producing interval (s)	

INSTRUCTIONS: As provided in KCC Rule 82-2-125, within 90 days after completion of a well, one completed copy of this Drillers Log shall be transmitted to the State Geological Survey of Kansas, 4150 Monroe Street, Wichita, Kansas 67209. Copies of this form are available from the Conservation Division, State Corporation Commission, 245 No. Water, Wichita, Kansas 67202. Phone AC 316-522-2206. If confidential custody is desired, please note Rule 82-2-125. Drillers Logs will be on an open file in the Oil and Gas Division, State Geological Survey of Kansas, Lawrence, Kansas 66044.

Operator Vincent Oil Corporation DESIGNATE TYPE OF COMP.: OIL, GAS, DRY HOLE, SWD, ETC.: Gas & Oil

Well No. #1 Lease Name Weller "A"

S 19 T 27 SR 15 W EX W

**WELL LOG**

Show all important zones of porosity and contents thereof; cored intervals, and all drill-stem tests, including depth interval tested, cushion used, time tool open, flowing and shut-in pressures, and recoveries.

SHOW GEOLOGICAL MARKERS, LOGS RUN, OR OTHER DESCRIPTIVE INFORMATION.

FORMATION DESCRIPTION, CONTENTS, ETC.	TOP	BOTTOM	NAME	DEPTH
<u>ELECTRIC LOG TOPS:</u>				
Sand - Shale & Red Bed	0	387	Heebner	3858 (-1778)
Red Bed	387	725	Brown Lime	4018 (-1938)
Red Bed & Shale	725	1560	Lansing KC	4040 (-1960)
Shale	1560	3245	Base KC	4371 (-2291)
Lime & Shale	3245	3510	Marmaton	4389 (-2309)
Shale & Lime	3510	3825	Cherokee Sh.	4496 (-2416)
Lime & Shale	3825	4600	Cherokee Sand	4507 (-2427)
RTD		4600	Miss.	4525 (-2445)
			Kind. Shale	4533 (-2453)
			Kind. Sand	4540 (-2460)
			LTD	4599
DST #1 - 4178'-4200', open 45", shut in 45", open 45", shut in 60". 1st open, weak blow increasing to fair. 2nd open, weak stabilized blow. Recovered 30' clean oil, 90' oil cut mud. IFP - 81-68# ISIP - 95# FFP - 40-40# FSIP - 101#				
DST #2 - 4198'-4216', open 30", shut in 45", open 60", shut in 60". 1st open, strong blow throughout. Recovered 40' mud, 60' slightly gas cut mud, 60' slightly gas cut muddy water, 435' muddy water (85,000 CL). IFP - 210-222# ISIP - 1507# FFP - 297-309# FSIP - 1482#				
DST #3 - 4305'-4320', open 45", shut in 45", open 45", shut in 60", 1st open, strong blow throught. Recovered 2830' gas in pipe, 120' mud cut oil. IFP - 40-54# ISIP-65# FFP - 54-60# FSIP-81#				
DST #4 - 4396'-4465', open 50", shut in 25", open 0", shut in 60". Gas to surface in 5 m Oil to surface in 45 ". Gauged: 34.3 NCF/10" 1/2' chock 23.7 NCF/20" 19.9 NCF/30" 23.7 NCF/40" Recovered 3000 ft. clean oil. IFP - 396-1024# ISIP - 1295# FFP - None FSIP - 1376#				
DST #5 - 4474'-4530', open 45", shut in 45", open 45", shut in 60". Gas to surface in 2' into final flow, too small to measure. Recovered 60' gas cut mud, 120' gas cut m with oil specks. IFP - 64-68# ISIP - 1078# FFP --68-81# FSIP - 1159#				

USE ADDITIONAL SHEETS, IF NECESSARY, TO COMPLETE WELL RECORD.

Date Received \_\_\_\_\_  
 Signature Richard H. Diebel  
 Vice President  
 Title  
 August 13, 1981  
 Date

DST #6 - 4538'-4585'. Open 45", shut in 45", open 60", shut in 90". 1st opening - strong blow throughout, 2nd opening - strong blow throughout. Recovered 130' mud, no show. ISIP 368# IFP 40-40#  
 FSIP 751# FFP 54-54#

VINCENT OIL CORP.  
 230 O. W. GARVEY BLDG. #1 WELLER "A" 19-27-15W  
 WICHITA, KS 67202 C NW NE  
 CONTR SLAWSON DRIG. CO., INC. CTY PRATT

GEOLOGIST TERRY MCLEOD FIELD CARVER-ROBBINS EXT (1/8 E)

E 2081 KB CM 4/6/81 CARD ISSUED 10/8/81 IP SLOW  
 2075 GL MARM 4430-4434  
 API 15-151-20,894

		*
+		+
+		+
+		+

LOG	TOPS	DEPTH	DATUM
HEEB		3858	-1777
BR LM		4018	-1937
LKC		4040	-1959
B KC		4371	-2290
MARM		4389	-2308
CHER SH		4496	-2415
CHER SD		4507	-2426
MISS		4525	-2444
KIND SH		4533	-2452
KIND SD		4540	-2459
LTD		4599	-2518
RTD		4600	-2519

8 5/8" 382/275sx; 5 1/2" 4599/200sx  
 DST (1) 4178-4200/45-45-60, REC 30' CL O, 90' OCM, SIP 95-101#, FP 81-68/40-40#  
 DST (2) 4198-4216/30-45-60-60, REC 40' M, 60' SL GCM, 60' SL GCM, 435' MW, SIP 1507-1482#, FP 210-222/297-309#  
 DST (3) 4305-4320/45-45-60, REC 2830' GIP, 120' MCO, SIP 655-819#, FP 40-54/54-60#

INDEPENDENT OIL & GAS SERVICE  
 WICHITA, KANSAS

(OVER)

RECEIVED  
 APR 19 2010  
 KCC WICHITA

COPY

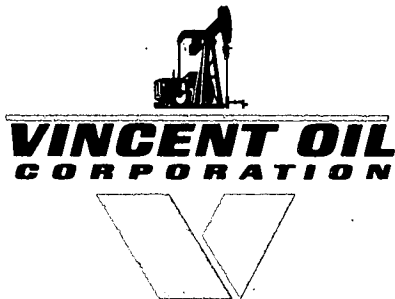

Suite 700 • 155 North Market • Wichita, Kansas 67202-1821  
(316) 262-3573

April 15, 2010

Kansas Corporation Commission  
Conservation Division  
130 S. Market, Room 2078  
Wichita, Kansas 67202

Attn: Production Dept.

Ref: **Vincent Oil Corporation**  
**CP-1 Well Plugging Applications**  
Fruit #1  
SW-NW 19-27-15W  
API # 15-151-20755-00-00  
Pratt Co., Kansas

✓ Weller "A" #1  
NW-NE 19-27-15W  
API # 15-151-20894-00-00  
Pratt Co., Kansas

Koehn #2  
T00' E. of SW-SW-NE 28-29-18W  
API #15-097-21246-00-00  
Kingman Co., Kansas

Dear KCC Staff:

Attached are completed and signed Well Plugging Applications (CP-1 forms) with attached well records for the above referenced wells.

Should you have any questions or require additional information prior to issuing a notice of receipt of these applications I can be contacted at the address or telephone number listed in the above letterhead.

Sincerely,

M.L. Korphage, P.G.  
Geologist  
Vincent Oil Corporation

RECEIVED  
APR 19 2010  
KCC WICHITA

XC: File



Mark Parkinson, Governor Thomas E. Wright, Chairman Joseph F. Harkins, Commissioner

**NOTICE OF RECEIPT OF WELL PLUGGING APPLICATION (CP-1)**

VINCENT OIL CORPORATION  
155 N MARKET STE 700  
WICHITA, KS 67202-1821

April 21, 2010

Re: WELLER - A #1  
API 15-151-20894-00-00  
19-27S-15W, 660 FNL 1980 FEL  
PRATT COUNTY, KANSAS

Dear Operator:

This letter is to notify you that the Conservation Division has received your plugging proposal, form CP-1, for the above well and has reviewed the proposal for completeness. The central office will now forward your CP-1 to the district office listed below for review of the proposed plugging method. **Please contact the district office for approval of your proposed plugging method at least five (5) days before plugging the well, pursuant to K.A.R. 82-3-113(b). If a workover pit will be used during the plugging of the well it must be permitted. A CDP-1 form must be filed and approved prior to the use of the pit in accordance with K.A.R. 82-3-600.**

The Conservation Division's review of form CP-1, either in the central or district office, does not include an inquiry into well ownership or the filing operator's legal right to plug the well. This notice in no way constitutes authorization to plug the above well by persons not having legal rights of ownership or interest in the well.

**This notice is void after October 18, 2010. The CP-1 filing does not bring the above well into compliance with K.A.R. 82-3-111 with regard to the Commission's temporary abandonment requirements.**

District: #1  
210 E Frontview, Suite A  
Dodge City, KS 67801  
(620) 225-8888

Sincerely

Steve Bond  
Production Department Supervisor