

15-179-05562-0000

STATE OF KANSAS
STATE CORPORATION COMMISSION

WELL PLUGGING RECORD

Give All Information Completely
Make Required Affidavit
Mail or Deliver Report to:
Conservation Division
State Corporation Commission
211 No. Broadway
Wichita, Kansas

Sheridan County. Sec. 12 Twp. 10S Rge. (E) 26 (W)

Location as "NE/CNW%SW%" or footage from lines. SE SE SE

Lease Owner JOHN O. FARMER, INC.

Lease Name CUSTER Well No. 2

Office Address Russell, Kansas

Character of Well (completed as Oil, Gas or Dry Hole) Dry

Date well completed 1/10 19 59

Application for plugging filed 1/10 19 59

Application for plugging approved 1/10 19 59

Plugging commenced 1/10 19 59

Plugging completed 1/10 19 59

Reason for abandonment of well or producing formation Dry

If a producing well is abandoned, date of last production _____ 19 _____

Was permission obtained from the Conservation Division or its agents before plugging was commenced? yes

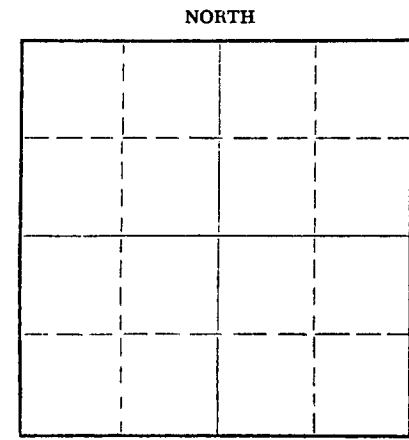

Locate well correctly on above Section Plat

Name of Conservation Agent who supervised plugging of this well Fabricius, Hill City, Kansas

Producing formation _____ Depth to top _____ Bottom _____ Total Depth of Well 4100 Feet

Show depth and thickness of all water, oil and gas formations.

OIL, GAS OR WATER RECORDS

CASING RECORD

FORMATION	CONTENT	FROM	TO	SIZE	PUT IN	PULLED OUT
				8-5/8"	170'	None

Describe in detail the manner in which the well was plugged, indicating where the mud fluid was placed and the method or methods used in introducing it into the hole. If cement or other plugs were used, state the character of same and depth placed, from _____ feet to _____ feet for each plug set.

First plug set at 600 feet with 20 sacks cement

Second plug set at 179 feet with 20 sacks cement

Third plug set at 40 feet with 10 sacks cement

WELL
COMMISSION
JAN 16 1959
CONSERVATION DIVISION
Wichita, Kansas

(If additional description is necessary, use BACK of this sheet)

Name of Plugging Contractor JOHN O. FARMER, INC.

Address Russell, Kansas

STATE OF KANSAS, COUNTY OF RUSSELL, ss. I, JOHN O. FARMER

(owner or operator) of the above-described well, being first duly sworn on oath, says: That I have knowledge of the facts, statements, and matters herein contained and the log of the above-described well as filed and that the same are true and correct. So help me God.

(Signature) John O. Farmer
Russell, Kansas
(Address)

SUBSCRIBED AND SWORN to before me this 14th day of January, 19 59

My commission expires October 11, 1962

Lucille Kennedy
Lucille Kennedy Notary Public.

PLUGGING
FILE SEC. 12 T. 10 R. 26W
BOOK PAGE 11 LINE 30

OPERATOR JOHN O. FARMER, INC.

FORMATION RECORD

ADDRESS Russell, Kansas

Give detailed description and thickness of all formation drilled through, contents of sand, whether dry, water, oil or gas.

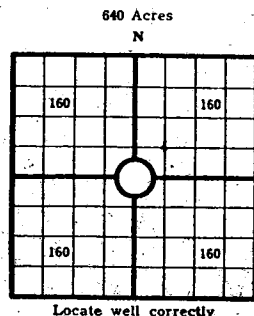

COUNTY Sheridan, SEC. 12, TWP. 10S, RGE. 26W
 COMPANY OPERATING JOHN O. FARMER, INC.
 OFFICE ADDRESS Russell, Kansas
 DRILLING STARTED 12/31 1958 DRILLING FINISHED 1/10, 1959
 DATE OF FIRST PRODUCTION _____ COMPLETED _____
 WELL LOCATED SE 1/4 SE 1/4 SE 1/4, North of South
 Line and _____ ft. East of West Line of Quarter Section
 Elevation (Relative to sea level) DERRICK FLOOR 2584 GROUND, 2581
 CHARACTER OF WELL (Oil, gas or dryhole) Dry

OIL OR GAS SANDS OR ZONES

Name	From	To	Name	From	To
1			4		
2			5		
3			6		

Perforating Record, If Any

Shot Record:

Formation	From	To	No. of Shots	Formation	From	To	Size of Shot

CASING RECORD

Size	Amount Set				Amount Pulled				Packer Record		
	Wt.	Thds.	Make	Ft.	In.	Ft.	In.	Size	Length	Depth Set	Make
8-5/8				170							

Liner Record: Amount _____ Kind _____ Top _____ Bottom _____

CEMENTING AND MUDDING

Size	Amount Set		Sacks Cement	Chemical		Method of Cementing	Amount	Mudding Method	Results (See Note)
	Ft.	In.		Gal.	Make				
8-5/8	170		130						

Note: What method was used to protect sands if outer strings were pulled?

NOTE: Were bottom hole plugs used? _____ If so, state kind, depth set and results obtained

TOOLS USED

Rotary Tools were used from _____ feet to _____ Cable tools were used from _____ feet to _____ feet, and from _____ feet to _____ feet, and from _____ feet to _____ feet to _____

Type Rig _____

INITIAL PRODUCTION TEST

Describe initial test: whether by flow through tubing or casing or by pumping _____

Amount of Oil Production _____ bbls. Size of choke, if any _____ Length of test _____ Water Production _____ bbls. Gravity of oil _____ Type of Pump if pump is used, describe _____

FARM NAME:

CUSTER #2

Formation	Top	Bottom
Clay & sand	0	140
Shale	140	440
Shale-sand	440	1440
Shale-shells-sand	1440	1650
Shale & sand	1650	1800
Redbed	1800	2115
Shale-redbed	2115	2212
Anhydrite	2212	2245
Shale & shells	2245	2770
Shale & lime	2770	3810
Lime & shale	3810	4100
T.D.		4100

ELEVATION:

RB

2586

LOG TOPS:

Heebner	3810
Toronto	3833
Lansing	3850
B/KC	4084
Log T.D.	4099
R.T.D.	4100

PLUGGING
 FILE SEC. 12, T. 10, R. 26W
 BOOK PAGE 11 LINE 30

NO. 1
 JAN 10 1959
 CONSERVATION DIVISION
 Wichita, Kansas

I, the undersigned, being first duly sworn upon oath, state that this well record is true, correct and complete according to the records of this office and to the best of my knowledge and belief.

John O. Farmer President
 Name and title of representative of company

Subscribed and sworn to before me this 13th day of January, 1959My Commission expires 10/11/62

Notary Public.