

For KCC Use: 6-16-10
 Effective Date: 6-16-10
 District #: 4
 SGA? Yes No

KANSAS CORPORATION COMMISSION
OIL & GAS CONSERVATION DIVISION
NOTICE OF INTENT TO DRILL
Must be approved by KCC five (5) days prior to commencing well

Form C-1
 December 2002
Form must be Typed
Form must be Signed
All blanks must be Filled

Expected Spud Date _____ month _____ day _____ year

OPERATOR: License# 3553
 Name: Citation Oil & Gas Corp.
 Address: P O Box 690688
Houston, TX 77269
 City/State/Zip:
 Contact Person: Bridget Lisenbe / Hakim Benhamou
 Phone: (281) 891-1565 / (281) 891-1486

CONTRACTOR: License# 5929
 Name: Duke Drilling Co., Inc.

Well Drilled For:	Well Class:	Type Equipment:
<input checked="" type="checkbox"/> Oil	<input type="checkbox"/> Enh Rec	<input checked="" type="checkbox"/> Infield
<input type="checkbox"/> Gas	<input type="checkbox"/> Storage	<input type="checkbox"/> Pool Ext.
<input type="checkbox"/> OAWO	<input type="checkbox"/> Disposal	<input type="checkbox"/> Wildcat
<input type="checkbox"/> Seismic: _____ # of Holes	<input type="checkbox"/> Other	<input type="checkbox"/> Cable
<input type="checkbox"/> Other		

If OWWO: old well information as follows:
 Operator: _____
 Well Name: _____
 Original Completion Date: _____ Original Total Depth: _____

Directional, Deviated or Horizontal wellbore? Yes No
 If Yes, true vertical depth: _____
 Bottom Hole Location: _____
 KCC DKT #: _____

Spot _____ SW Sec. 31 Twp. 12 S. R. 15 East West
2310 feet from N / S Line of Section
1650 feet from E / W Line of Section
 Is SECTION Regular Irregular?

(Note: Locate well on the Section Plat on reverse side)
 County: Russell
 Lease Name: Wieland Well #: 2-20
 Field Name: Fairport
 Is this a Prorated / Spaced Field? Yes No
 Target Formation(s): Arbuckle, LKC & Topeka
 Nearest Lease or unit boundary: 1650
 Ground Surface Elevation: 1890 feet MSL
 Water well within one-quarter mile: Yes No
 Public water supply well within one mile: Yes No
 Depth to bottom of fresh water: 180
 Depth to bottom of usable water: 500
 Surface Pipe by Alternate: 1 2
 Length of Surface Pipe Planned to be set: 1000'
 Length of Conductor Pipe required: None
 Projected Total Depth: 3545
 Formation at Total Depth: Arbuckle
 Water Source for Drilling Operations:
 Well Farm Pond Other _____
 DWR Permit #: _____

RECEIVED
 KANSAS CORPORATION COMMISSION
 JUN 10 2010
 CONSERVATION DIVISION
 WICHITA, KS

(Note: Apply for Permit with DWR)
 Will Cores be taken? Yes No
 If Yes, proposed zone: _____

AFFIDAVIT

The undersigned hereby affirms that the drilling, completion and eventual plugging of this well will comply with K.S.A. 55 et. seq.
 It is agreed that the following minimum requirements will be met:

1. Notify the appropriate district office **prior** to spudding of well;
2. A copy of the approved notice of intent to drill **shall be** posted on each drilling rig;
3. The minimum amount of surface pipe as specified below **shall be set** by circulating cement to the top; in all cases surface pipe **shall be set** through all unconsolidated materials plus a minimum of 20 feet into the underlying formation.
4. If the well is dry hole, an agreement between the operator and the district office on plug length and placement is necessary **prior to plugging**;
5. The appropriate district office will be notified before well is either plugged or production casing is cemented in;
6. If an ALTERNATE II COMPLETION, production pipe shall be cemented from below any usable water to surface within **120 days** of spud date.
 Or pursuant to Appendix "B" - Eastern Kansas surface casing order #133,891-C, which applies to the KCC District 3 area, alternate II cementing must be completed within 30 days of the spud date or the well shall be plugged. **In all cases, NOTIFY district office** prior to any cementing.

I hereby certify that the statements made herein are true and to the best of my knowledge and belief.

Date: 6/7/2010 Signature of Operator or Agent: Bridget Lisenbe Title: Permitting Analyst

For KCC Use ONLY	
API # 15 - <u>167-23645-00-00</u>	
Conductor pipe required <u>None</u> feet	
Minimum surface pipe required <u>520</u> feet per Alt. <input checked="" type="checkbox"/> 1 <input type="checkbox"/> X	
Approved by: <u>SB</u> <u>6-11-2010</u>	
This authorization expires: <u>6-11-2011</u>	
<i>(This authorization void if drilling not started within 6 months of approval date.)</i>	
Spud date: _____	Agent: _____

Remember to:

- File Drill Pit Application (form CDP-1) with Intent to Drill;
- File Completion Form ACO-1 within 120 days of spud date;
- File acreage attribution plat according to field proration orders;
- Notify appropriate district office 48 hours prior to workover or re-entry;
- Submit plugging report (CP-4) after plugging is completed;
- Obtain written approval before disposing or injecting salt water.

- If this permit has expired (See: authorized expiration date) please check the box below and return to the address below.
 Well Not Drilled - Permit Expired
 Signature of Operator or Agent: _____
 Date: _____

Mail to: KCC - Conservation Division, 130 S. Market - Room 2078, Wichita, Kansas 67202

31
12
151

IN ALL CASES PLOT THE INTENDED WELL ON THE PLAT BELOW

Plat of acreage attributable to a well in a prorated or spaced field

If the intended well is in a prorated or spaced field, please fully complete this side of the form. If the intended well is in a prorated or spaced field complete the plat below showing that the well will be properly located in relationship to other wells producing from the common source of supply. Please show all the wells and within 1 mile of the boundaries of the proposed acreage attribution unit for gas wells and within 1/2 mile of the boundaries of the proposed acreage attribution unit for oil wells.

API No. 15 - 167-23645-00-00
Operator: Citation Oil & Gas Corp.
Lease: Wieland
Well Number: 2-20
Field: Fairport
Number of Acres attributable to well: _____
QTR / QTR / QTR of acreage: _____ - _____ - SW

Location of Well: County: Russell
2310 feet from N / S Line of Section
1650 feet from E / W Line of Section
Sec. 31 Twp. 12 S. R. 15 East West

Is Section: Regular or Irregular

If Section is Irregular, locate well from nearest corner boundary.
Section corner used: NE NW SE SW

PLAT

*(Show location of the well and shade attributable acreage for prorated or spaced wells.)
(Show footage to the nearest lease or unit boundary line.)*

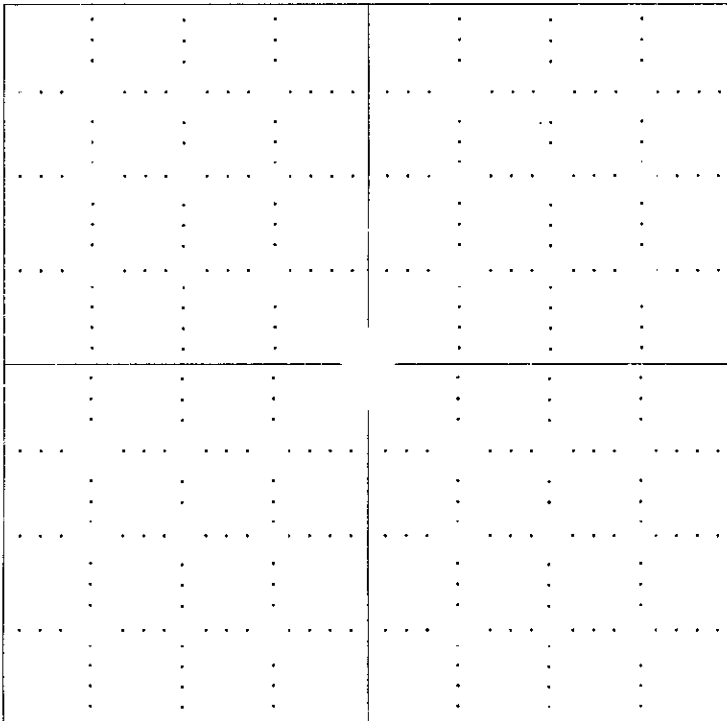

RECEIVED
KANSAS CORPORATION COMMISSION
JUN 10 2010
CONSERVATION DIVISION
WICHITA, KS

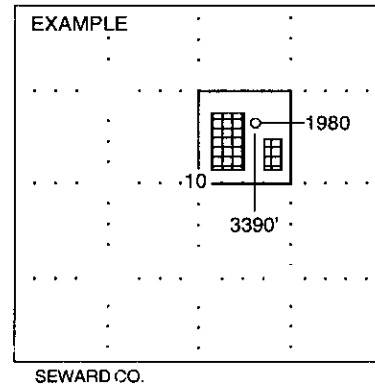

NOTE: In all cases locate the spot of the proposed drilling location.

In plotting the proposed location of the well, you must show:

1. The manner in which you are using the depicted plat by identifying section lines, i.e. 1 section, 1 section with 8 surrounding sections, 4 sections, etc.
2. The distance of the proposed drilling location from the section's south / north and east / west.
3. The distance to the nearest lease or unit boundary line.
4. If proposed location is located within a prorated or spaced field a certificate of acreage attribution plat must be attached: (CO-7 for oil wells; CG-8 for gas wells).

**KANSAS CORPORATION COMMISSION
OIL & GAS CONSERVATION DIVISION
APPLICATION FOR SURFACE PIT**

Form CDP-1
April 2004
Form must be Typed

Submit in Duplicate

Operator Name: Citation Oil & Gas Corp		License Number: 3553
Operator Address: P O Box 690688 Houston, TX 77269		
Contact Person: Bridget Lisenbe		Phone Number: (281) 891 - 1565
Lease Name & Well No.: Wieland 2-20		Pit Location (QQQQ): <u> NW NE SW </u> Sec. <u>31</u> Twp. <u>12S</u> R. <u>15</u> <input type="checkbox"/> East <input checked="" type="checkbox"/> West <u>2310</u> Feet from <input type="checkbox"/> North / <input checked="" type="checkbox"/> South Line of Section <u>1650</u> Feet from <input type="checkbox"/> East / <input checked="" type="checkbox"/> West Line of Section <u>Russell</u> County
Type of Pit: <input type="checkbox"/> Emergency Pit <input type="checkbox"/> Burn Pit <input type="checkbox"/> Settling Pit <input checked="" type="checkbox"/> Drilling Pit <input type="checkbox"/> Workover Pit <input type="checkbox"/> Haul-Off Pit <small>(If WP Supply API No. or Year Drilled)</small>	Pit is: <input checked="" type="checkbox"/> Proposed <input type="checkbox"/> Existing If Existing, date constructed: _____ Pit capacity: 600 (bbls)	
Is the pit located in a Sensitive Ground Water Area? <input type="checkbox"/> Yes <input checked="" type="checkbox"/> No		Chloride concentration: _____ mg/l <small>(For Emergency Pits and Settling Pits only)</small>
Is the bottom below ground level? <input checked="" type="checkbox"/> Yes <input type="checkbox"/> No	Artificial Liner? <input type="checkbox"/> Yes <input checked="" type="checkbox"/> No	How is the pit lined if a plastic liner is not used? Bentonite and drill solids
Pit dimensions (all but working pits): <u>100</u> Length (feet) <u>100</u> Width (feet) _____ N/A: Steel Pits Depth from ground level to deepest point: <u>4</u> (feet)		
If the pit is lined give a brief description of the liner material, thickness and installation procedure.		Describe procedures for periodic maintenance and determining liner integrity, including any special monitoring.
Distance to nearest water well within one-mile of pit <u>None</u> feet Depth of water well <u>N/A</u> feet		Depth to shallowest fresh water <u>180</u> feet. Source of information: _____ measured _____ well owner _____ electric log <input checked="" type="checkbox"/> KDWR
Emergency, Settling and Burn Pits ONLY: Producing Formation: _____ Number of producing wells on lease: _____ Barrels of fluid produced daily: _____ Does the slope from the tank battery allow all spilled fluids to flow into the pit? <input type="checkbox"/> Yes <input type="checkbox"/> No		Drilling, Workover and Haul-Off Pits ONLY: Type of material utilized in drilling/workover: <u>Conditioned native mud fresh water</u> Number of working pits to be utilized: <u>1</u> Abandonment procedure: <u>Evaporation and backfill</u> _____ Drill pits must be closed within 365 days of spud date.
I hereby certify that the above statements are true and correct to the best of my knowledge and belief.		
<u>6/7/2010</u> Date		<u>Bridget Lisenbe</u> Signature of Applicant or Agent

RECEIVED
KANSAS CORPORATION COMMISSION
JUN 10 2010
CONSERVATION DIVISION
WICHITA, KS

15-167-23645-00-00

KCC OFFICE USE ONLY			
Date Received: <u>6-10-10</u>	Permit Number: _____	Permit Date: <u>6-10-10</u>	Lease Inspection: <input type="checkbox"/> Yes <input checked="" type="checkbox"/> No

Mail to: KCC - Conservation Division, 130 S. Market - Room 2078, Wichita, Kansas 67202

**CITATION OIL & GAS CORPORATION
WIELAND UNIT LEASE
SW.1/4, SECTION 31, T12S, R15W
RUSSELL COUNTY, KANSAS**

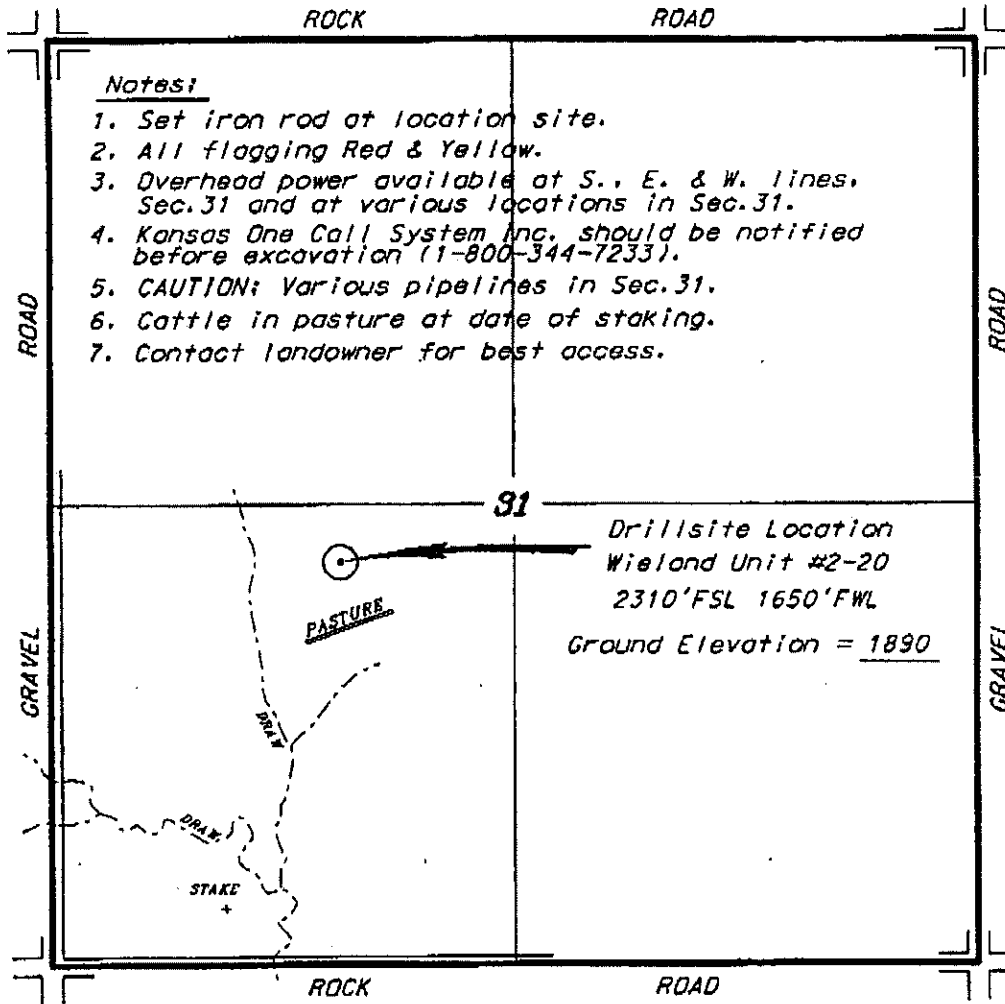

Ingress and egress to location as shown on this plot is for usage only and may not be legally opened for public use. Contact landowner, tenant and county road department for access.

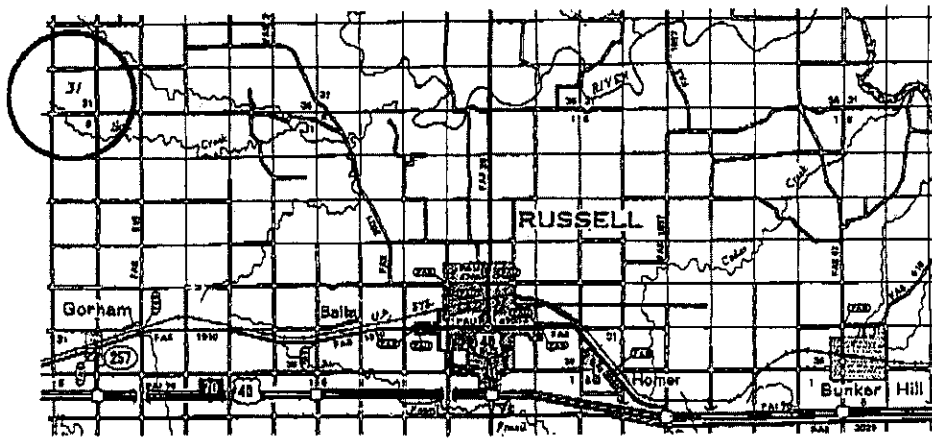
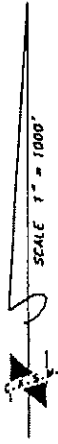

RECEIVED
KANSAS CORPORATION COMMISSION
JUN 10 2010
CONSERVATION DIVISION
WICHITA, KE

15-127-23145-00-00

Controlling data is based upon the best maps and photographs available to us and upon a regular section of land containing 640 acres.
Approximate section lines were determined using the normal standards of care of oilfield surveyors practicing in the state of Kansas. The section corners, which establish the precise section lines, were not necessarily located, and the exact location of the drillsite location in the section is not guaranteed. Therefore, the operator assuming this service and accepting this plot and all other parties relying thereon agree to hold Central Kansas Oilfield Services, Inc., its officers and employees harmless from all losses, costs and expenses and said utilities released from any liability from incidental or consequential damages.
Elevations derived from National Geodetic Vertical Datum.

Date May 18, 2010

CENTRAL KANSAS OILFIELD SERVICES, INC. (620)792-1977