

For KCC Use: 6-19-2010
 Effective Date: _____
 District # 3
 SGA? Yes No

KANSAS CORPORATION COMMISSION
 OIL & GAS CONSERVATION DIVISION

Form C-1
 October 2007
Form must be Typed
Form must be Signed
All blanks must be Filled

NOTICE OF INTENT TO DRILL

Must be approved by KCC five (5) days prior to commencing well

Expected Spud Date: 6 23 2010
 month day year

OPERATOR: License# 5953
 Name: A.R.&R. Ltd.
 Address 1: 6213 Sawgrass Place
 Address 2: _____
 City: Bartlesville State: ok Zip: 74006
 Contact Person: Andy Park
 Phone: 620-252-6009
 CONTRACTOR: License# 5989
 Name: Finney Drilling

Well Drilled For: Oil Gas Seismic; _____ # of Holes Other: _____
 Enh Rec Storage Disposal
 Well Class: Infield Pool Ext. Wildcat Other
 Type Equipment: Mud Rotary Air Rotary Cable

If OWWO: old well information as follows:
 Operator: _____
 Well Name: _____
 Original Completion Date: _____ Original Total Depth: _____

Directional, Deviated or Horizontal wellbore? Yes No
 If Yes, true vertical depth: _____
 Bottom Hole Location: _____
 KCC DKT #: _____

Spot Description: N2 SE 30 34 14
 (0000) 3,937 feet from N / S Line of Section
660 feet from E / W Line of Section

Is SECTION: Regular Irregular?
 (Note: Locate well on the Section Plat on reverse side)

County: montgomery
 Lease Name: Kincaid Well #: 2 Weiser
 Field Name: Wayside/Havana

Is this a Prorated / Spaced Field? Yes No
 Target Formation(s): Weiser
 Nearest Lease or unit boundary line (in footage): 660

Ground Surface Elevation: 830 feet MSL
 Water well within one-quarter mile: Yes No
 Public water supply well within one mile: Yes No

Depth to bottom of fresh water: 150
 Depth to bottom of usable water: 175
 Surface Pipe by Alternate: I II
 Length of Surface Pipe Planned to be set: 20
 Length of Conductor Pipe (if any): n/a
 Projected Total Depth: 900
 Formation at Total Depth: weiser

Water Source for Drilling Operations: Well Farm Pond Other: _____
 DWR Permit #: _____

(Note: Apply for Permit with DWR)
 Will Cores be taken? Yes No
 If Yes, proposed zone: _____

RECEIVED
 KANSAS CORPORATION COMMISSION
 JUN 11 2010
 CONSERVATION DIVISION
 WICHITA, KS

AFFIDAVIT

The undersigned hereby affirms that the drilling, completion and eventual plugging of this well will comply with K.S.A. 55 et. seq.

It is agreed that the following minimum requirements will be met:

1. Notify the appropriate district office **prior** to spudding of well;
2. A copy of the approved notice of intent to drill **shall be** posted on each drilling rig;
3. The minimum amount of surface pipe as specified below **shall be set** by circulating cement to the top; in all cases surface pipe **shall be set** through all unconsolidated materials plus a minimum of 20 feet into the underlying formation.
4. If the well is dry hole, an agreement between the operator and the district office on plug length and placement is necessary **prior to plugging**;
5. The appropriate district office will be notified before well is either plugged or production casing is cemented in;
6. If an ALTERNATE II COMPLETION, production pipe shall be cemented from below any usable water to surface within **120 DAYS** of spud date.
 Or pursuant to Appendix "B" - Eastern Kansas surface casing order #133,891-C, which applies to the KCC District 3 area, alternate II cementing must be completed within 30 days of the spud date or the well shall be plugged. **In all cases, NOTIFY district office** prior to any cementing.

I hereby certify that the statements made herein are true and correct to the best of my knowledge and belief.

Date: 6-10-2010 Signature of Operator or Agent: Andy Park Title: President

For KCC Use ONLY
 API # 15 - 125-31974-00-00
 Conductor pipe required None feet
 Minimum surface pipe required 20 feet per ALT. I II
 Approved by: PWP 6-14-2010
 This authorization expires: 6-14-2011
 (This authorization void if drilling not started within 12 months of approval date.)
 Spud date: _____ Agent: _____

Remember to:

- File Drill Pit Application (form CDP-1) with Intent to Drill;
- File Completion Form ACO-1 within 120 days of spud date;
- File acreage attribution plat according to field proration orders;
- Notify appropriate district office 48 hours prior to workover or re-entry;
- Submit plugging report (CP-4) after plugging is completed (within 60 days);
- Obtain written approval before disposing or injecting salt water.
- If this permit has expired (See: authorized expiration date) please check the box below and return to the address below.

Well Not Drilled - Permit Expired Date: _____
 Signature of Operator or Agent: _____

30
34
14
 E
 W

IN ALL CASES PLOT THE INTENDED WELL ON THE PLAT BELOW

Plat of acreage attributable to a well in a prorated or spaced field

If the intended well is in a prorated or spaced field, please fully complete this side of the form. If the intended well is in a prorated or spaced field complete the plat below showing that the well will be properly located in relationship to other wells producing from the common source of supply. Please show all the wells and within 1 mile of the boundaries of the proposed acreage attribution unit for gas wells and within 1/2 mile of the boundaries of the proposed acreage attribution unit for oil wells.

API No. 15 - 125-31974-00-00
 Operator: A.R.&R. Ltd.
 Lease: Kincaid
 Well Number: 2 Weiser
 Field: Wayside/Havana
 Number of Acres attributable to well: _____
 QTR/QTR/QTR/QTR of acreage: NE - SE - NE

Location of Well: County: montgomery
 _____ feet from N / S Line of Section
 _____ feet from E / W Line of Section
 Sec. 30 Twp. 34 S. R. 14 E W

Is Section: Regular or Irregular

If Section Is Irregular, locate well from nearest corner boundary.

Section corner used: NE NW SE SW

PLAT

(Show location of the well and shade attributable acreage for prorated or spaced wells.)

(Show footage to the nearest lease or unit boundary line.)

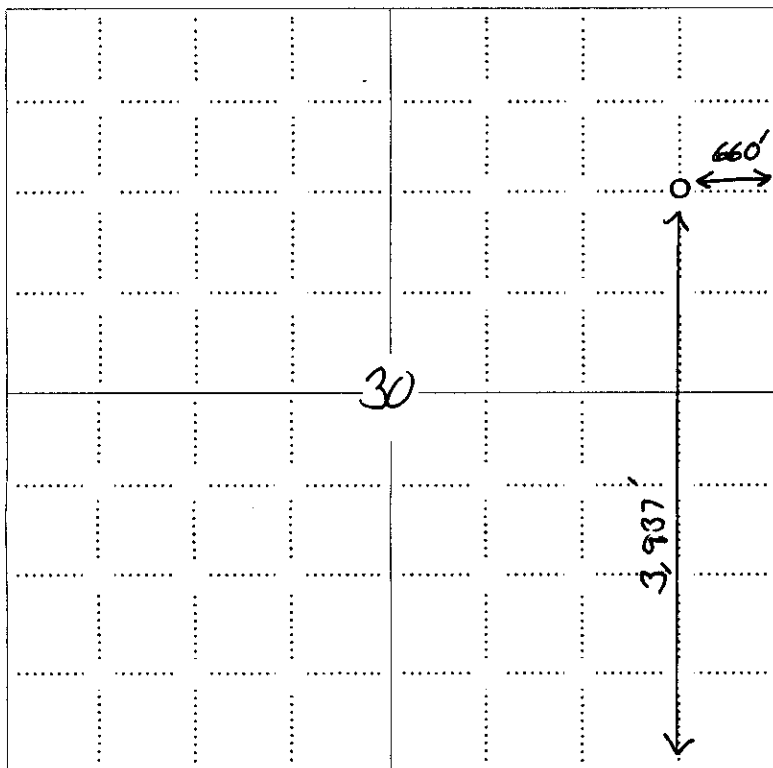

NOTE: In all cases locate the spot of the proposed drilling location.

RECEIVED
 KANSAS CORPORATION COMMISSION

JUN 11 2010

CONSERVATION DIVISION
 WICHITA, KS

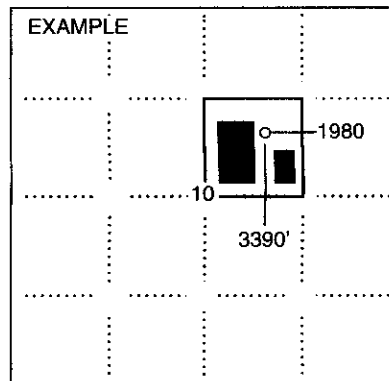

In plotting the proposed location of the well, you must show:

1. The manner in which you are using the depicted plat by identifying section lines, i.e. 1 section, 1 section with 8 surrounding sections, 4 sections, etc.
2. The distance of the proposed drilling location from the south / north and east / west outside section lines.
3. The distance to the nearest lease or unit boundary line (in footage).
4. If proposed location is located within a prorated or spaced field a certificate of acreage attribution plat must be attached: (C0-7 for oil wells; C0-8 for gas wells)

**KANSAS CORPORATION COMMISSION
OIL & GAS CONSERVATION DIVISION
APPLICATION FOR SURFACE PIT**

Form CDP-1
April 2004
Form must be Typed

Submit in Duplicate

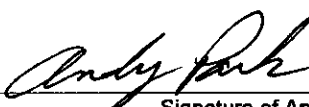
Operator Name: A.R.&R. Ltd.		License Number: 5953	
Operator Address: 6213 Sawgrass Place		Bartlesville ok 74006	
Contact Person: Andy Park		Phone Number: 620-252-5009	
Lease Name & Well No.: Kincaid 2 Weiser		Pit Location (QQQQ): N2 - ^{N2} SE ^{SE} NE - ne	
Type of Pit: <input type="checkbox"/> Emergency Pit <input type="checkbox"/> Burn Pit <input type="checkbox"/> Settling Pit <input checked="" type="checkbox"/> Drilling Pit <input type="checkbox"/> Workover Pit <input type="checkbox"/> Haul-Off Pit <small>(If WP Supply API No. or Year Drilled)</small>	Pit is: <input checked="" type="checkbox"/> Proposed <input type="checkbox"/> Existing If Existing, date constructed: Pit capacity: 500 (bbls)	Sec. 30 Twp. 34 R. 14 <input checked="" type="checkbox"/> East <input type="checkbox"/> West 3,600 3937 Feet from <input type="checkbox"/> North / <input checked="" type="checkbox"/> South Line of Section 660 Feet from <input checked="" type="checkbox"/> East / <input type="checkbox"/> West Line of Section montgomery County	
Is the pit located in a Sensitive Ground Water Area? <input type="checkbox"/> Yes <input checked="" type="checkbox"/> No		Chloride concentration: _____ mg/l <small>(For Emergency Pits and Settling Pits only)</small>	
Is the bottom below ground level? <input checked="" type="checkbox"/> Yes <input type="checkbox"/> No	Artificial Liner? <input type="checkbox"/> Yes <input checked="" type="checkbox"/> No	How is the pit lined if a plastic liner is not used?	
Pit dimensions (all but working pits): <u>60</u> Length (feet) <u>8</u> Width (feet)		<input type="checkbox"/> N/A: Steel Pits	
Depth from ground level to deepest point: <u>8</u> (feet)		<input type="checkbox"/> No Pit	
If the pit is lined give a brief description of the liner material, thickness and installation procedure.		Describe procedures for periodic maintenance and determining liner integrity, including any special monitoring.	
Distance to nearest water well within one-mile of pit <u>NA</u> feet Depth of water well _____ feet	Depth to shallowest fresh water _____ feet. Source of information: <input type="checkbox"/> measured <input type="checkbox"/> well owner <input type="checkbox"/> electric log <input checked="" type="checkbox"/> KDWR		
Emergency, Settling and Burn Pits ONLY: Producing Formation: _____ Number of producing wells on lease: _____ Barrels of fluid produced daily: _____ Does the slope from the tank battery allow all spilled fluids to flow into the pit? <input type="checkbox"/> Yes <input type="checkbox"/> No	Drilling, Workover and Haul-Off Pits ONLY: Type of material utilized in drilling/workover: <u>fresh water</u> Number of working pits to be utilized: <u>1</u> Abandonment procedure: <u>let dry and fill</u> Drill pits must be closed within 365 days of spud date.		
I hereby certify that the above statements are true and correct to the best of my knowledge and belief.			
Date: <u>6-9-10</u>		 Signature of Applicant or Agent	

KCC OFFICE USE ONLY		Steel Pit <input type="checkbox"/>	RFAC <input type="checkbox"/>	RFAS <input type="checkbox"/>
Date Received: <u>6/11/10</u>	Permit Number: _____	Permit Date: <u>6/11/10</u>	Lease Inspection: <input type="checkbox"/> Yes <input checked="" type="checkbox"/> No	

15-125-31974-00-00

RECEIVED
KANSAS CORPORATION COMMISSION
JUN 11 2010
CONSERVATION DIVISION