

STATE OF KANSAS
STATE CORPORATION COMMISSION

WELL PLUGGING RECORD

Give All Information Completely
Make Required Affidavit
Mail or Deliver Report to
Conservation Division
State Corporation Comm.
245 North Water
Wichita, KS 67202

Gove County, Sec. 32 Twp. 12S Rge. 30W E/W
Location as "NE/CNW $\frac{1}{4}$ SW $\frac{1}{4}$ " or footage from lines
C NE NE

Lease Owner Abercrombie Drilling, Inc.

Lease Name ABELL Well No. 1

Office Address 801 Union Center, Wichita, Kansas 67202

Character of Well (Completed as Oil, Gas or Dry Hole)
Dry Hole

Date Well completed 5-05 1977

Application for plugging filed (Verbally) 5-05 1977

Application for plugging approved (Verbally) 5-05 1977

Plugging commenced 5-05 1977

Plugging completed 5-05 1977

Reason for abandonment of well or producing formation
No commercial quantity of oil or gas encountered

If a producing well is abandoned, date of last production
19

Was permission obtained from the Conservation Division or
its agents before plugging was commenced? Yes

Name of Conservation Agent who supervised plugging of this well Gilbert Balthazor

Producing formation _____ Depth to top _____ Bottom _____ Total Depth of Well _____

Show depth and thickness of all water, oil and gas formations.

OIL, GAS OR WATER RECORDS

CASING RECORD

FORMATION	CONTENT	FROM	TO	SIZE	PUT IN	PULLED OUT

Describe in detail the manner in which the well was plugged, indicating where the mud fluid was placed and the method or methods used in introducing it into the hold. If cement or other plugs were used, state the character of same and depth placed, from _____ feet to _____ feet for each plug set.

T.D. 4560'
Set 1st plug at 1150' with 70 sx.
2nd plug at 240' with 20 sx.,
3rd plug at 40' with 10 sx.

05-20-1977

(If additional description is necessary, use BACK of this sheet)

Name of Plugging Contractor Abercrombie Drilling, Inc.

STATE OF Kansas COUNTY OF Sedgwick, ss.
Jack L. Partridge, Asst. Sec.-Treas. (employee of owner) or (owner or operator)
of the above-described well, being first duly sworn on oath, says: That I have knowledge of the facts, statements, and matters herein contained and the log of the above-described well as filed and that the same are true and correct. So help me God.

(Signature) Jack L. Partridge
801 Union Center, Wichita, Kansas 67202
(Address)

SUBSCRIBED AND SWORN TO before me this 16th day of May, 1977

Kathy S. Goertz
Kathy S. Goertz Notary Public.

My commission expires _____

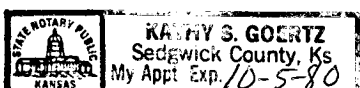

KANSAS DRILLERS LOG

S. 32 T. 12S R. 30W E
W

Loc. C NE NE

County Gove County

API No. 15 — 063 — 20338-00-00
County Number

Operator
Abercrombie Drilling, Inc.

Address
801 Union Center, Wichita, Kansas 67202

Well No. 1 Lease Name ABELL

Footage Location
feet from (N) (S) line feet from (E) (W) line

Principal Contractor Abercrombie Drilling, Inc. Geologist K. Greg Cheney

Spud Date 4-25-77 Total Depth 4560' P.B.T.D.

Date Completed 5-05-77 Oil Purchaser

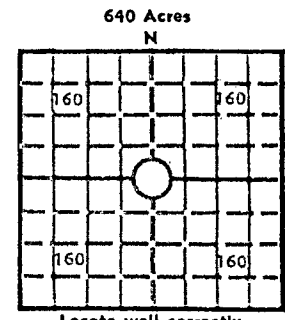

Elev.: Gr. 2857'

DF 2860' KB 2862'

CASING RECORD

Report of all strings set — surface, intermediate, production, etc.

Purpose of string	Size hole drilled	Size casing set (in O.D.)	Weight lbs/ft.	Setting depth	Type cement	Sacks	Type and percent additives
Surface	12 3/4"	8 5/8"	28#	240.11'	Common	190	3% Ca. Cl., 2% gel.

LINER RECORD

PERFORATION RECORD

Top, ft.	Bottom, ft.	Sacks cement	Shots per ft.	Size & type	Depth interval

TUBING RECORD

Size	Setting depth	Packer set at

ACID, FRACTURE, SHOT, CEMENT SQUEEZE RECORD

Amount and kind of material used	Depth interval treated

INITIAL PRODUCTION

Date of first production		Producing method (flowing, pumping, gas lift, etc.)			
RATE OF PRODUCTION PER 24 HOURS	Oil	Gas	Water	Gas-oil ratio	CFPB
	bbls.	bbls.	MCF	bbls.	
Disposition of gas (vented, used on lease or sold)			Producing interval (s)		

INSTRUCTIONS: As provided in KCC Rule 82-2-125, within 90 days after completion of a well, one completed copy of this Drillers Log shall be transmitted to the State Geological Survey of Kansas, 4150 Monroe Street, Wichita, Kansas 67209. Copies of this form are available from the Conservation Division, State Corporation Commission, 3830 So. Meridian (P.O. Box 17027), Wichita, Kansas 66217. Phone AC 316-522-2206. If confidential custody is desired, please note Rule 82-2-125. Drillers Logs will be on open file in the Oil and Gas Division, State Geological Survey of Kansas, Lawrence, Kansas 66044.

KANSAS DRILLERS LOG

S. 32 T. 12S R. 30W ^E/_W

API No. 15 —————
 County _____ Number _____

Loc. C NE NE

County Gove County

Operator
Abercrombie Drilling, Inc.

Address
801 Union Center, Wichita, Kansas 67202

Well No. 1 Lease Name ABELL

Footage Location
 feet from (N) (S) line _____ feet from (E) (W) line _____

Principal Contractor Abercrombie Drilling, Inc. Geologist K. Greg Cheney

Spud Date 4-25-77 Total Depth 4560' P.B.T.D. _____

Date Completed 5-05-77 Oil Purchaser _____

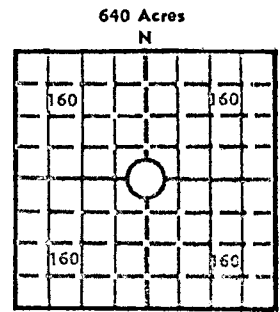

Elev.: Gr. 2857'
 Locate well correctly

DF 2860' KB 2862'

CASING RECORD

Report of all strings set — surface, intermediate, production, etc.

Purpose of string	Size hole drilled	Size casing set (in O.D.)	Weight lbs/ft.	Setting depth	Type cement	Sacks	Type and percent additives
Surface	12 $\frac{3}{4}$ "	8 5/8"	28#	240.11'	Common	190	3% Ca. Cl., 2% gel.

LINER RECORD

PERFORATION RECORD

Top, ft.	Bottom, ft.	Sacks cement	Shots per ft.	Size & type	Depth interval

TUBING RECORD

Size	Setting depth	Packer set at

ACID, FRACTURE, SHOT, CEMENT SQUEEZE RECORD

Amount and kind of material used	Depth interval treated

INITIAL PRODUCTION

Date of first production _____		Producing method (flowing, pumping, gas lift, etc.) _____			
RATE OF PRODUCTION PER 24 HOURS	Oil _____ bbls.	Gas _____ MCF	Water _____ bbls.	Gas-oil ratio _____ CFPB	Disposition of gas (vented, used on lease or sold) _____
Producing interval(s) _____					

INSTRUCTIONS: As provided in KCC Rule 82-2-125, within 90 days after completion of a well, one completed copy of this Drillers Log shall be transmitted to the State Geological Survey of Kansas, 4150 Monroe Street, Wichita, Kansas 67209. Copies of this form are available from the Conservation Division, State Corporation Commission, 3830 So. Meridian (P.O. Box 17027), Wichita, Kansas 66217. Phone AC 316-522-2206. If confidential custody is desired, please note Rule 82-2-125. Drillers Logs will be on open file in the Oil and Gas Division, State Geological Survey of Kansas, Lawrence, Kansas 66044.