

STATE CORPORATION COMMISSION OF KANSAS
OIL & GAS CONSERVATION DIVISION
WELL COMPLETION OR RECOMPLETION FORM
ACO-1 WELL HISTORY
DESCRIPTION OF WELL AND LEASE

SIDE ONE 15-033-19002-00-00
API NO. 15-033-20719 Skid rig
County Comanche
Sec. 10 Twp. 35 Rge. 20 East West

Operator: License # 5673
Name W.L. Kirkman, Inc.
Address P.O. Box 782290
City/State/Zip Wichita, KS 67278-2290

1270 Ft North from Southeast Corner of Section
510 Ft West from Southeast Corner of Section
(Note: Locate well in section plat below)

Purchaser Northern Natural

Lease Name Box Ranch B Well # 2X

Operator Contact Person Wayne Kirkman
Phone 316-685-5372

Field Name SE Tuttle

Producing Formation Morrow

Contractor: License # 5107
Name H-30 Drilling, Inc.

Elevation: Ground 1753 KB 1765

Wellsite Geologist Allen Siemens
Phone 838-5344

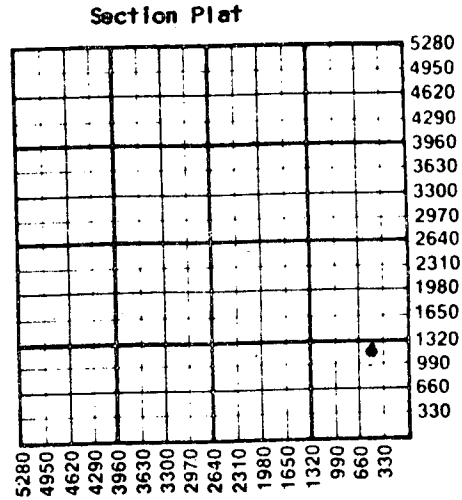

Designate Type of Completion
 New Well Re-Entry Workover
 Oil SWD Temp Abd
 Gas Inj Delayed Comp.
 Dry Other (Core, Water Supply etc.)

If OWG: old well info as follows:
Operator
Well Name
Comp. Date Old Total Depth

WATER SUPPLY INFORMATION

Disposition of Produced Water: Disposal
Docket # Repressuring

WELL HISTORY

Drilling Method:
 Mud Rotary Air Rotary Cable
1-27-88 2-4-88 2/17/88
Spud Date Date Reached TD Completion Date
5533'
Total Depth PBTD

Questions on this portion of the ACO-1 call:
Water Resources Board (913) 296-3717

Source of Water:
Division of Water Resources Permit #
 Groundwater.....Ft North from Southeast Corner
(Well)Ft West from Southeast Corner of
Sec Twp Rge East West
 Surface Water.....Ft North from Southeast Corner
(Stream, pond etc).....Ft West from Southeast Corner
Sec Twp Rge East West
 Other (explain) Clarke Corp.
(purchased from city, R.W.D. #)

Amount of Surface Pipe Set and Cemented at 639 feet
Multiple Stage Cementing Collar Used? Yes No
If yes, show depth set.....feet
If alternate 2 completion, cement circulated
from.....feet depth to.....w/.....SX cmt
Cement Company Name
Invoice # A/I 5-11-88

INSTRUCTIONS: This form shall be completed in triplicate and filed with the Kansas Corporation Commission, 200 Colorado Derby Building, Wichita, Kansas 67202, within 120 days of the spud date of any well. Rule 82-3-130, 82-3-107 and 82-3-106 apply.
Information on side two of this form will be held confidential for a period of 12 months if requested in writing and submitted with the form. See rule 82-3-107 for confidentiality in excess of 12 months.
One copy of all wireline logs and drillers time log shall be attached with this form. Submit CP-4 form with all plugged wells. Submit CP-111 form with all temporarily abandoned wells.

All requirements of the statutes, rules and regulations promulgated to regulate the oil and gas industry have been fully complied with and the statements herein are complete and correct to the best of my knowledge.

Signature Jane Kemp
Title Bookkeeper Date 4/06/88

Subscribed and sworn to before me this 6th day of April 1988
Notary Public Marilyn Everson

Date Commission Expires
MARILYN EVERSON
NOTARY PUBLIC
STATE OF KANSAS
MY APPT. EXPIRES 7-17-91

K.C.C. OFFICE USE ONLY
F Letter of Confidentiality Attached
C Wireline Log Received
C Drillers Timelog Received
Distribution
 KCC SWD/Rep NGPA
 KGS Plug Other
STATE CORPORATION COMMISSION (Specify)
APR 20 1988 4-20-88

Sec 10 Twp 35 Rge 20

Operator Name W. L. Kirkman, Inc. Lease Name Box Ranch B Well # 2

Sec. 10 Twp. 35S Rge. 20 East West County Comanche

WELL LOG

INSTRUCTIONS: Show important tops and base of formations penetrated. Detail all cores. Report all drill stem tests giving interval tested, time tool open and closed, flowing and shut-in pressures, whether shut-in pressure reached static level, hydrostatic pressures, bottom hole temperature, fluid recovery, and flow rates if gas to surface during test. Attach extra sheet if more space is needed. Attach copy of log.

Drill Stem Tests Taken Yes No
 Samples Sent to Geological Survey Yes No
 Cores Taken Yes No

Formation Description
 Log Sample

DST #1- Rec. 120' oil (44° fravity)
 IHP: 2630# IFP 790-852
 ICIP: 2025 FFP: 821-821
 FCIP 1973 FHP: 2556

Name	Top	Bottom
Red Bed	0	2,340'
Red Bed and Sand	2,340'	2,575'
Lime and Shale	2,575'	2,840'
Shale and Lime	2,840'	3,123'
Lime and Shale	3,123'	3,795'
Shale and Lime	3,795'	4,079'
Lime and Shale	4,079'	5,533'
Rotary Total Depth		5,533'

CASING RECORD <input checked="" type="checkbox"/> New <input type="checkbox"/> Used							
Report all strings set-conductor, surface, intermediate, production, etc.							
Purpose of String	Size Hole Drilled	Size Casing Set (in O.D.)	Weight Lbs/Ft.	Setting Depth	Type of Cement	#Sacks Used	Type and Percent Additives
Conductor		16"		65'	6-1/2 yards grout		
Surface	12-1/4"	8-5/8"	24#	639'	Lite	250	3% CC
Production	7-7/8"	4-1/2"	10.5#	5527'	Common 60/40 Poz	100 200	2% gel, 10% salt 3/4 of 1% CD-31
PERFORATION RECORD				Acid, Fracture, Shot, Cement Squeeze Record			
Shots Per Foot	Specify Footage of Each Interval Perforated			(Amount and Kind of Material Used)			Depth
4	5393-5397, 5403-5418						
TUBING RECORD				Liner Run <input type="checkbox"/> Yes <input checked="" type="checkbox"/> No			
Date of First Production		Producing Method					
		<input checked="" type="checkbox"/> Flowing <input type="checkbox"/> Pumping <input type="checkbox"/> Gas Lift <input type="checkbox"/> Other (explain).....					
Estimated Production Per 24 Hours		Oil Bbls	Gas MCF	Water Bbls	Gas-Oil Ratio	Gravity	
25			500,000	0			

METHOD OF COMPLETION

Production Interval

Disposition of gas: Vented Open Hole Perforation
 Sold Other (Specify)
 Used on Lease Dually Completed
 Commingled