

STATE CORPORATION COMMISSION OF KANSAS
OIL & GAS CONSERVATION DIVISION
WELL COMPLETION OR RECOMPLETION FORM
ACO-1 WELL HISTORY
DESCRIPTION OF WELL AND LEASE

Operator: License # 9041
Name Joseph H. Strabala
Address 312 E. Uintah St.
Colorado Springs, Colo.
City/State/Zip 80903

Purchaser

Operator Contact Person Joseph H. Strabala
Phone 303-6357807

Contractor: License # 4083
Name Western Kansas Drilling

Wellsite Geologist Mark Gary Torr
Phone 625-3131

Designate Type of Completion
 New Well Re-Entry Workover
 Oil SWD Temp Abd
 Gas Inj Delayed Comp.
 Dry Other (Core, Water Supply etc.)

If ~~OWN~~ Old well info as follows:
Operator
Well Name
Comp. Date Old Total Depth

WELL HISTORY

Drilling Method:
 Mud Rotary Air Rotary Cable
..8-5-87... ..8-13-87... ..8-13-87...
Spud Date Date Reached TD Completion Date
4600..... 2510.....
Total Depth PBDT

Amount of Surface Pipe Set and Cemented at 268 feet
Multiple Stage Cementing Collar Used? Yes No
If yes, show depth set.....feet
If alternate 2 completion, cement circulated
from.....feet depth to.....w/.....SX cmt
Cement Company Name Allied Cementing
Invoice # 49364

API NO. 15-.....15-193-20,446-0000.....
County Thomas
NW
SW SE NE Sec 24 Twp 10S Rge 31 X West
N.W.C.
3240 Ft North from Southeast Corner of Section
3950 Ft West from Southeast Corner of Section
(Note: Locate well in section plat below)

Lease Name Delzeit Well # 3
Field Name Triangle North
Producing Formation None

Elevation: Ground 2923 KB 2928

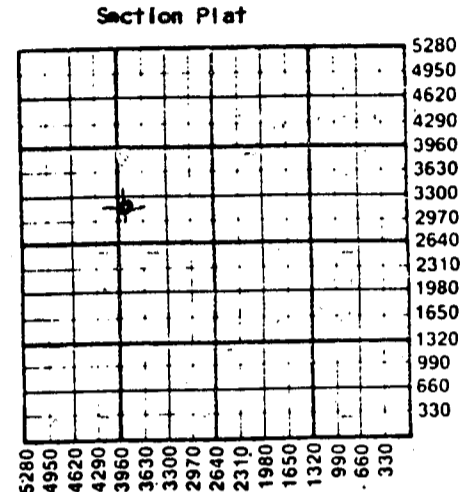

WATER SUPPLY INFORMATION
Disposition of Produced Water: Disposal
Docket # Repressuring

Questions on this portion of the ACO-1 call:
Water Resources Board (913) 296-3717
Source of Water: B&B Well Drilling, Grinnell, Kan
Division of Water Resources Permit #
Groundwater.....Ft North from Southeast Corner
(Well)Ft West from Southeast Corner of
Sec Twp Rge East West
Surface Water.....Ft North from Southeast Corner
(Stream, pond etc).....Ft West from Southeast Corner
Sec Twp Rge East West
Other (explain).....
(purchased from city, R.W.D. #)

INSTRUCTIONS: This form shall be completed in triplicate and filed with the Kansas Corporation Commission, 200 Colorado Derby Building, Wichita, Kansas 67202, within 120 days of the spud date of any well. Rule 82-3-130, 82-3-107 and 82-3-106 apply. Information on side two of this form will be held confidential for a period of 12 months if requested in writing and submitted with the form. See rule 82-3-107 for confidentiality in excess of 12 months. One copy of all wireline logs and drillers time log shall be attached with this form. Submit CP-4 form with all plugged wells. Submit CP-111 form with all temporarily abandoned wells.

All requirements of the statutes, rules and regulations promulgated to regulate the oil and gas industry have been fully complied with and the statements herein are complete and correct to the best of my knowledge.

Signature Joseph H. Strabala
Title Operator Date 8-24-87

Subscribed and sworn to before me this 24th day of August 1987
Notary Public
Date Commission Expires 12-13-87

K.C.C. OFFICE USE ONLY
 Letter of Confidentiality Attached
 Wireline Log Received
 Drillers Timelog Received
Distribution
 KCC SWD/Rep NGPA
 KGS Plug Other
(Specify)

Sec. 24 Twp. 10 S. Rge. 31 W

15-193-20446-0000

SIDE TWO

Operator Name Joseph H. Strabala Lease Name..... Delzeit Well #... 3.....

Sec. 24 Twp. 10s Rge. 31 East West County..... Thomas.....

WELL LOG

INSTRUCTIONS: Show important tops and base of formations penetrated. Detail all cores. Report all drill stem tests giving interval tested, time tool open and closed, flowing and shut-in pressures, whether shut-in pressure reached static level, hydrostatic pressures, bottom hole temperature, fluid recovery, and flow rates if gas to surface during test. Attach extra sheet if more space is needed. Attach copy of log.

Drill Stem Tests Taken Yes No
 Samples Sent to Geological Survey Yes No
 Cores Taken Yes No

Formation Description
 Log Sample

DST #1 4117-4150, 60-60-60-60, Wk sur blw to 1/4 in throughout. Rec 15ft Drill md sh oil top. Hydro 2385-2339 - FIFP65-65 SIFP72-72 ISP-1372 FSP-1305

DST #2 4147-4208, 45-30-30-30, Wk 1/4 in blw decr to sur blw through. Rec 10 ft Drill md. Hydro 2426-2390, FIFP77-77 SIFP77-77 ISP-77 FSP-77

DST #3 4204-4245, 60-60-60-60, Sur blw to 6" throughout. F blw 1/2" to 8" throughout. Rec. 140 ft Gas - 40 ft SGOCM. Hydro. 2422-2360, FIFP-62-62, SIFP-67-67 ISP-1044, FSP-1101

Name	Top	Bottom
Anhydrite	+429	+400
Heebner Shale	-1026	
Toronto L	-1049	
Lansing K C	-1069	
B. K C	-1339	
Pawnee	-1470	
Fort Scott	-1543	
RTD	-1672	
LTD	-1673	

RELEASED

SEP 22 1988

FROM CONFIDENTIAL

CASING RECORD <input type="checkbox"/> New <input type="checkbox"/> Used							
Report all strings set-conductor, surface, intermediate, production, etc.							
Purpose of String	Size Hole Drilled	Size Casing Set (in O.D.)	Weight Lbs/Ft.	Setting Depth	Type of Cement	#Sacks Used	Type and Percent Additives
Surface	12 1/4"	8-5/8"	20#	268'	60/40poz	170	3%cc 2%gel
PERFORATION RECORD				Acid, Fracture, Shot, Cement Squeeze Record			
Shots Per Foot	Specify Footage of Each Interval Perforated			(Amount and Kind of Material Used)			Depth
	None						
TUBING RECORD				Liner Run	<input type="checkbox"/> Yes <input type="checkbox"/> No		
Date of First Production	Producing Method <input type="checkbox"/> Flowing <input type="checkbox"/> Pumping <input type="checkbox"/> Gas Lift <input type="checkbox"/> Other (explain).....						
Estimated Production Per 24 Hours	Oil Bbls	Gas MCF	Water Bbls	Gas-Oil Ratio	Gravity		
	None						

METHOD OF COMPLETION Plugged Production Interval

Disposition of gas: Vented Open Hole Perforation
 Sold Other (Specify)
 Used on Lease Dually Completed
 Commingled

MARK TORR

Independent Petroleum Geologist
P.O. BOX 1293
HAYS, KANSAS 67601

(913) 628-3131

08-17-87

JOSEPH H. STRABALA
DELZEIT # 3
3240' FSL & 3950' FEL of the the NW/4
Section 24-10S-31W
Thomas County, Kansas

Commenced: 08-05-87.

Completed: 08-13-87.

Drilled By: Western Kansas Drilling, Rig # 2.

Pipe Record: 8⁵/₈" at 266'.

Electric Log: R.A. Guard.

-GEOLOGICAL REPORT-

Elevation

2928:KB

2926:DF

2923:GL

Gentlemen;

The above captioned well was under my supervision from a rotary depth of 3600' to a rotary total depth of 4600'. Ten foot samples, washed and dried, were examined from 3700' to RTD. Three drill stem tests were run. This well was plugged and abandoned.

Formation Data

All measurements are from KB.

Log Tops

ANHYDRITE	2499 Top	+429
	2528 Bottom	+400
HEEBNER SHALE	3954	-1026
TORONTO LIMESTONE	3977	-1049
LANSING-KANSAS CITY	3997	-1069
BASE OF KANSAS CITY	4267	-1339
PAWNEE	4398	-1470
FORT SCOTT	4471	-1543
RTD	4600	-1672
LTD	4601	-1673

RELEASED

SEP 22 1988

FROM CONFIDENTIAL

MARK TORR

Independent Petroleum Geologist
P.O. BOX 1293
HAYS, KANSAS 67601

(913) 628-3131

Zones of Interest

4045'-4048': Offwhite chalky limestone. Fine crystalline, with scattered vugs. No free oil, no odor, and a minor stain.

4072'-4076': Tan fine crystalline limestone. Trace of black asphaltic stain, no free oil, and no odor.

4144'-4148': Offwhite to gray limestone. Fine crystalline, with scattered fossils. Show of free oil, faint odor, and a spotted stain. This zone was covered in DST # 1.

DST # 1

Interval Tested: 4117'-4150'.

Times: 60-60-60-60.

Recovery: 15' of drilling mud, with a show of oil on top.

Shut-in Pressures: 1381-1301 PSI.

Flow Pressures: 60-60 & 60-72 PSI.

4191'-4198': Gray to tan limestone. Fine crystalline to fossiliferous, with a minor show of oil, fair to good odor, and a spotted stain. This zone was covered in DST # 2.

DST # 2

Interval Tested: 4147'-4208'.

Times: 45-30-30-30.

Recovery: 10' of drilling mud, with no show.

Shut-in Pressures: 72-72 PSI.

Flow Pressures: 72-72 & 72-72 PSI.

4223'-4227': Gray limestone. Fossiliferous, with interfossiliferous porosity. Show of free oil, fair to good odor, and a spotted to even stain. This zone was covered in DST # 3.

DST # 3

Interval Tested: 4204'-4245'.

Times: 60-60-60-60.

Recovery: 140' of gas-in-pipe,

40' of slightly gassy, oil-cut mud, (14% gas, 16% oil, 70% mud).

Shut-in Pressures: 1048-1083 PSI.

Flow Pressures: 60-60 & 60-60 PSI.

4400-4402: Offwhite fine crystalline to oolitic limestone, with interoolitic porosity. Show of oil, faint odor, spotted stain.

Recommendations

Due to low structural position, sparse oil shows, and poor drill stem test results, it was recommended to plug and abandon this well.

Respectfully submitted,



Mark Torr
Geologist

1987
RELEASED
SEP 22 1988
FROM CONFIDENTIAL

MARK TORR

Independent Petroleum Geologist
P.O. BOX 1293
HAYS, KANSAS 67601

(913) 628-3131

One foot drill time from 3601' to 4600'.

3601-3700 11222-21111-12222-22237-32233-32222-32333-23222-11111-12212-
12222-11122-22111-22224-33432-223 1½ 1½-½ ½ ½ ½ ½-1½ 3221-33423-32232-

3701-3800 13232-33343-22223-23222-32222-33333-22122-32333-23221-22222-
22333-22322-22121-21221-21232-32222-23222-33223-32121-12212-

3801-3900 22121-11222-12321-11112-22121-11222-23332-22221-1 ½ ½ 32-12211-
11211-½ ½ 111-11111-12132-32322-22211-33234-23233-23322-21222-

3901-4000 22444-23333-43122-23221-22233-64322-23432-22221-21112-11221-
11232-23543-44555-44444-45454-42233-22444-55555-55544-23223-

4001-4100 33444-35223-2½ 2½ 2½ 2½ 2-34434-54643-43555-43443-4 3½ 5½ 33-23223-33334-
34333-33223-23343-34343-2½ 3½ 223-34332-33222-22223-22322-33324-

4101-4200 23334-23343-34333-34342-33443-22432-32343-43444-33323-34334-
34653-44324-44454-44455-43433-44454-55544-34443-33323-34434-

4201-4300 34343-43442-21233-43333-33432-23233-32333-33333-22222-34444-
44334-33444-43434-54344-54443-222 1½ 1½-12121-11211-23443-34343-

4301-4400 44533-33353-44444-44353-34332-23333-33322-22222-32223-33334-
32534-33344-42233-23434-44444-55545-55534-55665-56666-45334-

4401-4500 34444-43333-45333-34334-44344-33333-23435-43454-53323-34343-
43334-34434-32223-33333-35444-32533-33443-43344-33444-43323-

4501-4600 43434-44343-33454-34444-44445-54547-54543-67644-43444-44443-
34443-45433-34443-33433-44454-55665-43333-43444-44444-52344-

RELEASED

SEP 22 1988

FROM CONFIDENTIAL