

15-033-20909-00-00

EFFECTIVE DATE: 2-25-96

State of Kansas
NOTICE OF INTENTION TO DRILL

FORM MUST BE SIGNED
ALL BLANKS MUST BE FILLED

DISTRICT # 1
SGAT Yes No

Must be approved by the K.C.C. five (5) days prior to commencing well

Expected Spud Date 3 1 96
month day year

Spot APPROX. E2 SE 1/4 NW Sec 34 Twp 34 S Rg 20 X East West

OPERATOR: License # 4145
Name: Roberts & Murphy, Inc.
Address: P.O. BOX 7125
City/State/Zip: Shreveport, LA 71137-7125
Contact Person: Brad Cummings
Phone: (318) 221-8601

1970 feet from South (North) line of Section
2515 feet from East (West) line of Section
IS SECTION XX REGULAR IRREGULAR?

CONTRACTOR: License # 5380
Name: Eagle Drilling

(NOTE: Locate well on the Section Plat on Reverse Side)
County: Comanche
Lease Name: Miller Well #: 6-34
Field Name: BOX RANCH

Well Drilled For: Well Class: Type Equipment:
XX Oil ... Enh Rec XX Infield XX Mud Rotary
... Gas ... Storage ... Pool Ext. ... Air Rotary
... OWWO ... Disposal ... Wildcat ... Cable
... Seismic; ... # of Holes ... Other
If OWWO: old well information as follows:
Operator:
Well Name:
Comp. Date: Old Total Depth

Is this a Prorated/Spaced Field? yes XX no
Target Formation(s): ARBUCKLE
Nearest lease or unit boundary: 785
Ground Surface Elevation: Approx. = 1715 feet MSL
Water well within one-quarter mile: yes X no
Public water supply well within one mile: yes X no
Depth to bottom of fresh water: 100'
Depth to bottom of usable water: 180'
Surface Pipe by Alternate: X 1 ... 2
Length of Surface Pipe Planned to be set: 650'
Length of Conductor pipe required: 80'
Projected Total Depth: 6500'
Formation at Total Depth: ARBUCKLE
Water Source for Drilling Operations:
... well ... farm pond XX other

Directional, Deviated or Horizontal wellbore? yes XX no
If yes, true vertical depth:
Bottom Hole Location:

DWR Permit #:
Will Cores Be Taken?: yes XX no
If yes, proposed zone:

AFFIDAVIT

The undersigned hereby affirms that the drilling, completion and eventual plugging of this well shall comply with K.S.A. 55-101, et. seq.
It is agreed that the following minimum requirements will be met:

RECEIVED
2-12-1996
FEB 12 1996

- 1. Notify the appropriate district office prior to spudding of well;
- 2. A copy of the approved notice of intent to drill shall be posted on each drilling rig;
- 3. The minimum amount of surface pipe as specified below shall be set by circulating cement to the top; in all cases surface pipe shall be set through all unconsolidated materials plus a minimum of 20 feet into the underlying formation;
- 4. If the well is dry hole, an agreement between the operator and the district office on plug length and placement is necessary prior to plugging;
- 5. The appropriate district office will be notified before well is either plugged or production casing is cemented in;
- 6. IF AN ALTERNATE II COMPLETION, PRODUCTION PIPE SHALL BE CEMENTED FROM BELOW ANY USABLE WATER TO SURFACE WITHIN 120 DAYS OF SPUD DATE. IN ALL CASES, NOTIFY DISTRICT OFFICE PRIOR TO ANY CEMENTING.

I hereby certify that the statements made herein are true and to the best of my knowledge and belief.
Date: 01/06/96 Signature of Operator or Agent: Scott Martin Title: Geologist

FOR KCC USE:
API # 15- 033-209090000
Conductor pipe required NONE feet
Minimum surface pipe required 200 feet per Alt. (1) X
Approved by: JK 2-20-96
This authorization expires: 8-20-96
(This authorization void if drilling not started within 6 months of effective date.)
Spud date: Agent:

REMEMBER TO:

- File Drill Pit Application (form CDP-1) with Intent to Drill;
- File Completion Form ACO-1 within 120 days of spud date;
- File acreage attribution plat according to field proration orders;
- Notify appropriate district office 48 hours prior to workover or re-entry;
- Submit plugging report (CP-4) after plugging is completed;
- Obtain written approval before disposing or injecting salt water.

Mail to: Conservation Division, 200 Colorado Derby Building, 202 W. First St., Wichita, Kansas 67202-1286.

34
34
20 W

PLAT OF ACREAGE ATTRIBUTABLE TO A WELL IN A PRORATED OR SPACED FIELD

If the intended well is in a prorated or spaced field, please fully complete this side of the form. If the intended well is in a prorated or spaced field complete the plat below showing that the well will be properly located in relationship to other wells producing from the common source of supply. Please show all the wells within 1 mile of the boundaries of the proposed acreage attribution unit for gas wells and within 1/2 mile of the boundaries of the proposed acreage attribution unit for oil wells.

API NO. 15- _____
 OPERATOR Roberts & Murphy, Inc.
 LEASE MILLER
 WELL NUMBER 6-34
 FIELD BOX RANCH

LOCATION OF WELL: COUNTY Comanche
1970 feet from south/north line of section
2515 feet from east/west line of section
 SECTION 34 TWP 34 RG 20

NUMBER OF ACRES ATTRIBUTABLE TO WELL _____
 QTR/QTR/QTR OF ACREAGE _____

IS SECTION XX REGULAR or _____ IRREGULAR
IF SECTION IS IRREGULAR, LOCATE WELL FROM NEAREST CORNER BOUNDARY.

Section corner used: _____ NE _____ NW _____ SE _____ SW

PLAT

(Show location of the well and shade attributable acreage for prorated or spaced wells.)
 (Show footage to the nearest lease or unit boundary line.)

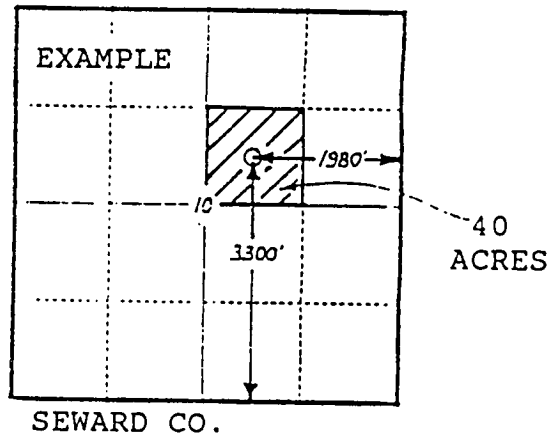
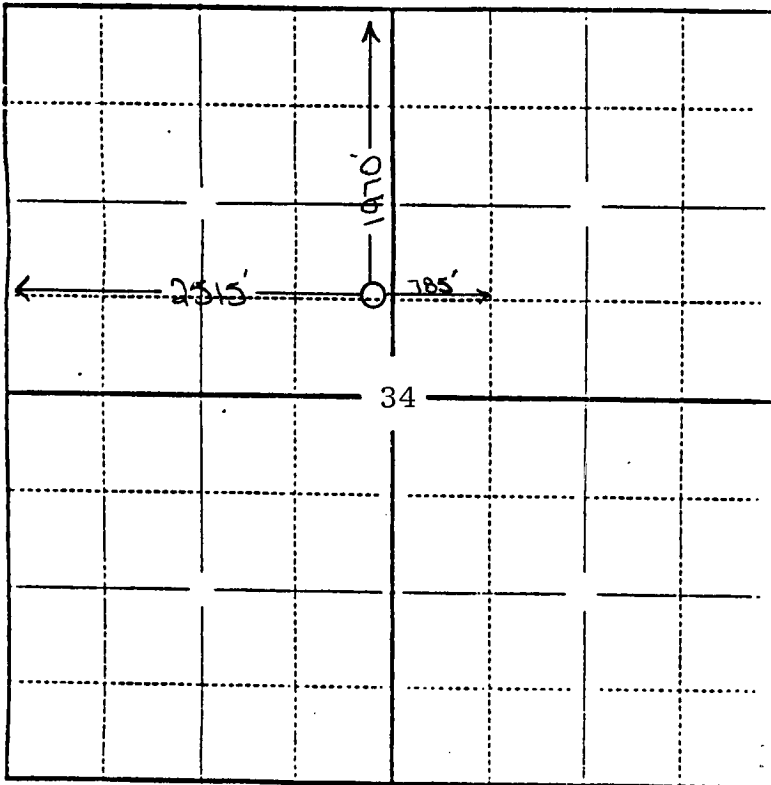

SECTION 34, T34S, R20W

In plotting the proposed location of the well, you must show:

- 1) The manner in which you are using the depicted plat by identifying section lines, i.e. 1 section, 1 section with 8 surrounding sections, 4 sections, etc.;
- 2) the distance of the proposed drilling location from the section's south/north and east/west lines; and
- 3) the distance to the nearest lease or unit boundary line.