

EFFECTIVE DATE: 12-24-91  
DISTRICT #  
35A7... Yes... No

State of Kansas  
NOTICE OF INTENTION TO DRILL

Must be approved by the K.C.C. five (5) days prior to commencing well

Expected Spud Date Jan 4 1992  
month day year

Spot SW NW NE Sec 34 Twp 34 S. Rg 20 East West

OPERATOR: License # 4145  
Name: Roberts & Murphy, Inc.  
Address: P. O. Box 7125  
City/State/Zip: Shreveport, LA 71137-7125  
Contact Person: J. Brad Cummings  
Phone: (318) 221-8601

CONTRACTOR: License #: 7345  
Name: Triad Drilling

Well Drilled For: Well Class: Type Equipment:  
X. Oil ... Enh Rec ... Infield ... Mud Rotary  
... Gas ... Storage ... Pool Ext. ... Air Rotary  
... OWD ... Disposal ... Wildcat ... Cable  
... Seismic; ... # of Holes ... Other  
If OWD: old well information as follows:  
Operator:  
Well Name:  
Comp. Date: ... Old Total Depth

Directional, Deviated or Horizontal wellbore? ... yes X... no  
If yes, true vertical depth:  
Bottom Hole Location:

1150' feet from South/North line of Section  
2575' feet from East/West line of Section  
IS SECTION X REGULAR IRREGULAR?  
(NOTE: Locate well on the Section Plat on Reverse Side)  
County: Comanche  
Lease Name: Miller Well #: 4-34  
Field Name: Box Ranch  
Is this a Prorated/Spaced Field? ... yes X. no  
Target Formation(s): Arbuckle  
Nearest lease or unit boundary: 550  
Ground Surface Elevation: 1728 feet MSL  
Water well within one-quarter mile: X. yes ... no  
Public water supply well within one mile: ... yes X. no  
Depth to bottom of fresh water: 110  
Depth to bottom of usable water: 180  
Surface Pipe by Alternate: X 1 ... 2  
Length of Surface Pipe Planned to be set: 650  
Length of Conductor pipe required: 80  
Projected Total Depth: 6500  
Formation at Total Depth: Arbuckle  
Water Source for Drilling Operations:  
... well X. farm pond ... other  
DWR Permit #:  
Will Cores Be Taken?: ... yes X. no  
If yes, proposed zone:

AFFIDAVIT

The undersigned hereby affirms that the drilling, completion and eventual plugging of this well will comply with K.S.A. 55-101, et. seq.  
It is agreed that the following minimum requirements will be met:

- 1. Notify the appropriate district office prior to spudding of well;
- 2. A copy of the approved notice of intent to drill shall be posted on each drilling rig;
- 3. The minimum amount of surface pipe as specified below shall be set by circulating cement to the top; in all cases surface pipe shall be set through all unconsolidated materials plus a minimum of 20 feet into the underlying formation;
- 4. If the well is dry hole, an agreement between the operator and the district office on plug length and placement is necessary prior to plugging;
- 5. The appropriate district office will be notified before well is either plugged or production casing is cemented in;
- 6. IF AN ALTERNATE II COMPLETION, PRODUCTION PIPE SHALL BE CEMENTED FROM BELOW ANY USABLE WATER TO SURFACE WITHIN 120 DAYS OF SPUD DATE. IN ALL CASES, NOTIFY DISTRICT OFFICE PRIOR TO ANY CEMENTING.

I hereby certify that the statements made herein are true and to the best of my knowledge and belief.  
Date: 12/09/91 Signature of Operator or Agent: [Signature] Title: Geologist

FOR KCC USE:  
API # 15- 033-20,841  
Conductor pipe required None feet  
Minimum surface pipe required 300 feet per Alt. ①  
Approved by: [Signature] 12-19-91  
This authorization expires: 6-19-92  
(This authorization void if drilling not started within 6 months of effective date.)  
Spud date: Agent:

RECEIVED  
STATE CORPORATION COMMISSION  
12-13-1991  
DEC 13 1991

CONSERVATION DIVISION  
WICHITA, KANSAS

REMEMBER TO:

- File Drill Pit Application (form CDP-1) with Intent to Drill;
- File Completion Form ACO-1 within 120 days of spud date;
- File acreage attribution plat according to field proration orders;
- Notify appropriate district office 48 hours prior to workover or re-entry;
- Submit plugging report (CP-4) after plugging is completed;
- Obtain written approval before disposing or injecting salt water.

Mail to: Conservation Division, 200 Colorado Derby Building, 202 W. First St., Wichita, Kansas 67202-1286.

34  
34  
200

IN ALL CASES PLOT THE INTENDED WELL ON THE PLAT BELOW

**PLAT OF ACREAGE ATTRIBUTABLE TO A WELL IN A PRORATED OR SPACED FIELD**

If the intended well is in a prorated or spaced field, please fully complete this side of the form. If the intended well is in a prorated or spaced field complete the plat below showing that the well will be properly located in relationship to other wells producing from the common source of supply. Please show all the wells within 1 mile of the boundaries of the proposed acreage attribution unit for gas wells and within 1/2 mile of the boundaries of the proposed acreage attribution unit for oil wells.

API NO. 15- \_\_\_\_\_  
 OPERATOR Roberts & Murphy, Inc.  
 LEASE \_\_\_\_\_  
 WELL NUMBER Miller 4-34  
 FIELD Box Ranch

LOCATION OF WELL: COUNTY Comanche  
 \_\_\_\_\_ 1150 feet from south/north line of section  
 \_\_\_\_\_ 2575 feet from east/west line of section  
 SECTION 34 TWP 34S RG 20W

NUMBER OF ACRES ATTRIBUTABLE TO WELL 80  
 QTR/QTR/QTR OF ACREAGE SW - NW - NE

IS SECTION X REGULAR or IRREGULAR  
IF SECTION IS IRREGULAR, LOCATE WELL FROM NEAREST CORNER BOUNDARY.

Section corner used: NE NW SE SW  
**PLAT**

(Show location of the well and shade attributable acreage for prorated or spaced wells.)  
 (Show footage to the nearest lease or unit boundary line.)

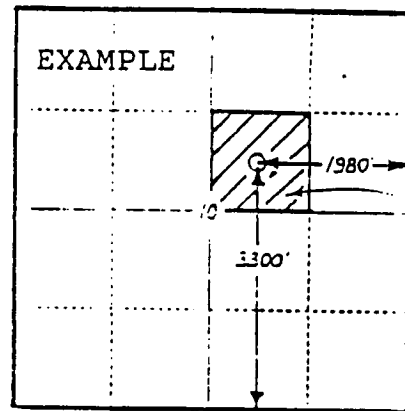
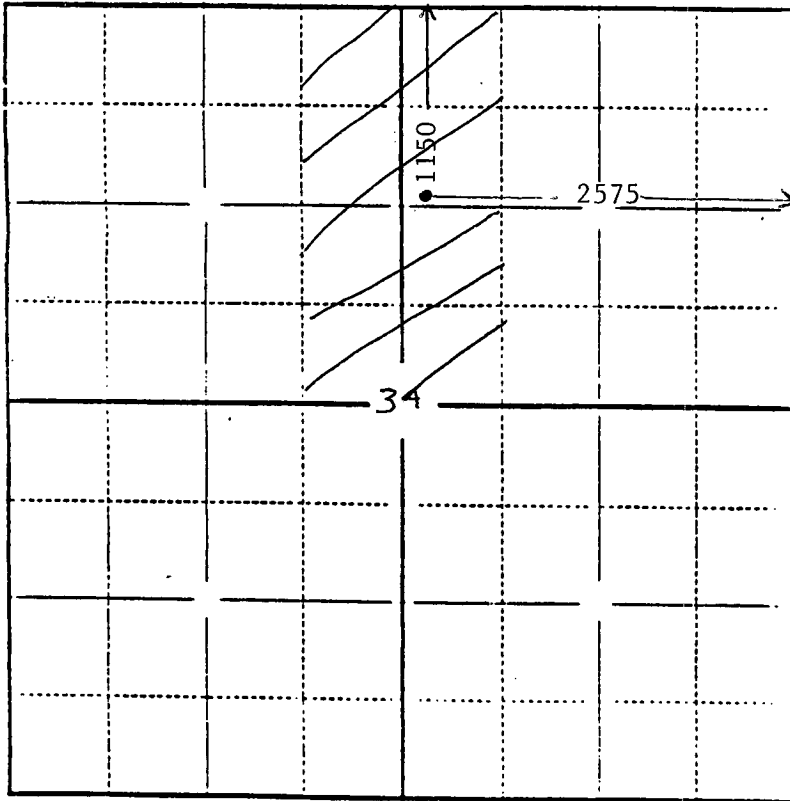

40  
ACRES

SEWARD CO.

COMANCHE CO.

In plotting the proposed location of the well, you must show:

- 1) The manner in which you are using the depicted plat by identifying section lines, i.e. 1 section, 1 section with 8 surrounding sections, 4 sections, etc.;
- 2) the distance of the proposed drilling location from the section's south/north and east/west lines; and
- 3) the distance to the nearest lease or unit boundary line.