

For KCC Use:
Effective Date:
District #
SGA? Yes No

KANSAS CORPORATION COMMISSION
OIL & GAS CONSERVATION DIVISION

* CORRECTED

Form C-1
October 2007
Form must be Typed
Form must be Signed
All blanks must be Filled

NOTICE OF INTENT TO DRILL

Must be approved by KCC five (5) days prior to commencing well

Expected Spud Date 07 12 2010
month day year

Spot Description:
SW SE NE NW Sec 1 Twp 26 S. R 38 E W

OPERATOR: License # 5952
Name: BP AMERICA PRODUCTION COMPANY
Address: P. O. BOX 3092, RM 3.454B, WL-1
City/State/Zip: HOUSTON, TX 77253-3092
Contact Person: DEANN SMYERS
Phone: (281) 366-4395

1250 feet from N / S Line of Section
2050 feet from E / W Line of Section
Is SECTION Regular Irregular?

(Note: Locate well on Section Plat on Reverse Side)

CONTRACTOR: License # Advise on ACO-1. Must be Licensed by KCC

County: Kearny
Lease Name: McKinney Gas Unit 'A' Well #: 4
Field Name: Hugoton - Panama

Well Drilled For: Oil Gas Enh Rec Storage Disposal
Well Class: Infield Pool Ext Wildcat Other
Type Equipment: Mud Rotary Air Rotary Cable

Is this a Prorated/Spaced Field? Yes No
Target Formation(s): Council Grove
Nearest Lease or unit boundary: 1250

If OWWO: old well information as follows:
Operator:
Well Name:
Original Completion Date: Original Total Depth

Ground Surface Elevation: 3132.6 feet MSL
Water well within one-quarter mile: Yes No
Public water supply within one mile: Yes No

Directional, Deviated or Horizontal wellbore? Yes No

Depth to bottom of fresh water: 180
Depth to bottom of usable water: 580
Surface Pipe by Alternate: I II

If yes, true vertical depth:
Bottom Hole Location

Length of Surface Pipe Planned to be set: 600 min.
Length of Conductor pipe (if any):
Projected Total Depth: 3013

KCC DKT # 10-CONS-192-CIDW

Formation at Total Depth: Council Grove
Water Source for Drilling Operations: Well Farm Pond Other

* WAS: 1950' FWL; Elev. 3130.9
IS: 2050' FWL; Elev. 3132.6
PRORATED & SPACED: HUGOTON - PANOMA

DWR Permit #: will apply if needed
Will Cores Be Taken?: Yes No

If yes, proposed zone:

AFFIDAVIT

The undersigned hereby affirms that the drilling, completion and eventual plugging of this well will comply with K.S.A. 55- 101 et, seq. It is agreed that the following minimum requirements will be met:

- 1. Notify the appropriate district office prior to spudding of well;
2. A copy of the approved notice of intent to drill shall be posted on each drilling rig;
3. The minimum amount of surface pipe as specified below shall be set by circulating cement to the top; in all cases surface pipe shall be set through all unconsolidated materials plus a minimum of 20 feet into the underlying formation;
4. If the well is dry hole, an agreement between the operator and the district office on plug length and placement is necessary prior to plugging;
5. The appropriate district office will be notified before well is either plugged or production casing is cemented in;
6. If an ALTERNATE II COMPLETION, production pipe shall be cemented from below any usable water to surface within 120 days of spud date. Or pursuant to Appendix "B" - Eastern Kansas surface casing order #133,891-C, which applies to the KCC District 3 area, alternate II cementing must be completed within 30 days of the spud date or the well shall be plugged. In all cases, NOTIFY district office prior to any cementing.

I hereby certify that the statements made herein are true and to the best of my knowledge and belief.

Date: 06/14/2010 Signature of Operator or Agent: DeAnn Smyers Title: REGULATORY STAFF ASSIST.

For KCC Use ONLY
API # 15- 093-21862-00-00
Conductor pipe required None feet
Minimum surface pipe required 600 feet per ALT.
Approved by: RUT 5-27-2010/Per 6-22-2010
This authorization expires: 5-27-2011
Spud date: Agent

Remember to:
- File Drill Pit Application (form CDP-1) with Intent to Drill;
- File Completion Form ACO-1 within 120 days of spud date;
- File acreage attribution plat according to field proration orders;
- Notify appropriate district office 48 hours prior to workover or re-entry;
- Submit plugging report (CP-4) after plugging is completed (within 60 days);
- Obtain written approval before disposing or injecting salt water.
- If permit has expired (See: authorized expiration date) please check the box below and return to the address below
Well Not Drilled - Permit Expired Date:
Signature of Operator or Agent:

IN ALL CASES PLOT THE INTENDED WELL ON THE PLAT BELOW

***CORRECTED**

Plat of acreage attributable to a well in a prorated or spaced field

If the intended well is in a prorated or spaced field, please fully complete this side of the form. If the intended well is in a prorated or spaced field complete the plat below showing that the well will be properly located in relationship to other wells producing from the common source of supply. Please show all the wells within 1 mile of the boundaries of the proposed acreage attribution unit for gas wells and within 1/2 mile of the boundaries of the proposed acreage attribution unit for oil wells.

API No. 15- 093-21862-0000

Operator BP AMERICA PRODUCTION COMPANY

Lease McKinney Gas Unit 'A'

Well Number 4

Field Hugoton

Number of Acres attributable to well: 833

QTR/QTR/QTR/QTR of acreage: SW - SE - NE - NW

Location of Well: County: Kearny

1250 feet from N / S Line of Section

2050 feet from E / W Line of Section

Sec 1 Twp 26 S. R. 38 E W

Is Section Regular or Irregular

If Section is irregular, locate well from nearest corner boundary.

Section corner used: NE NW SE SW

PLAT

(Show location of the well and shade attributable acreage for prorated or spaced wells.)
(Show footage to nearest lease or unit boundary line)

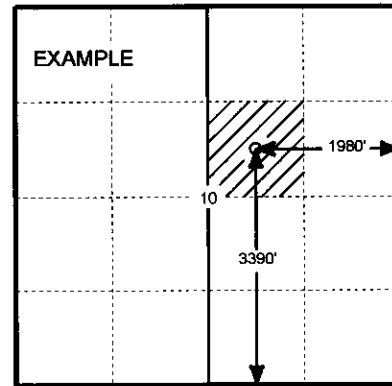
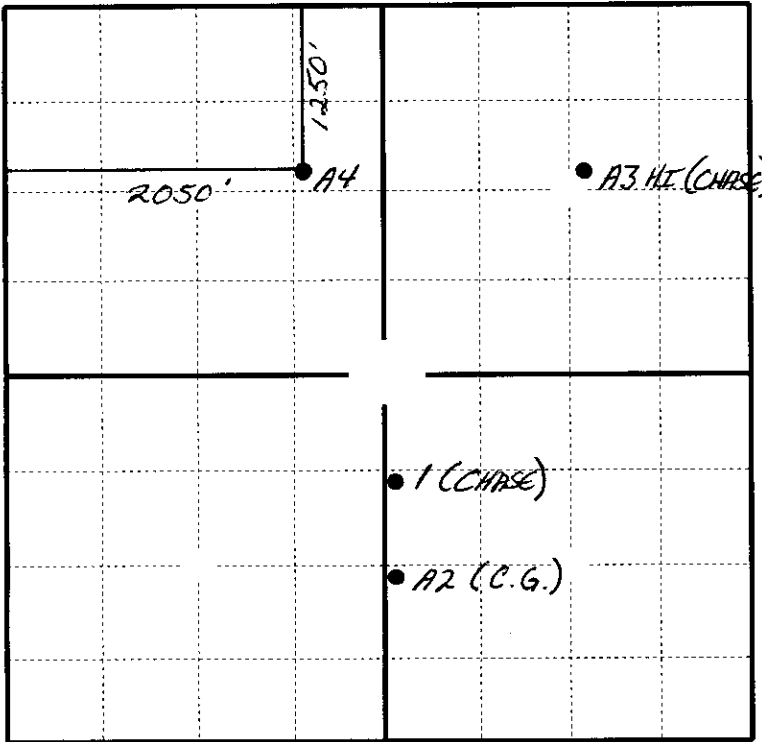

SEWARD CO.

In plotting the proposed location of the well, you must show;

1. The manner in which you are using the depicted plat by identifying section lines, i.e. 1 section, 1 section with 8 surrounding sections, 4 sections, etc.;
2. The distance of the proposed drilling location from the section's south/north and east/west outside section lines.
3. The distance to the nearest lease or unit boundary line (in footage).
4. If proposed location is located within a prorated or spaced field a certificate of acreage attribution plat must be attached: (CO-7 for oil wells; CG-8 for gas wells).

AMENDED

PLAT AND CERTIFICATION OF ACREAGE ATTRIBUTABLE TO A GAS WELL

Kansas Corporation Commission, Conservation Division
Finney State Office Building, 130 South Market, Room 2078
Wichita, Kansas 67202

10-CONS-192-C10W

*
CORRECTED

API NUMBER 15- 093-21862-0700

OPERATOR BP AMERICA PRODUCTION COMPANY

LEASE MCKINNEY GAS UNIT 'A'

WELL NUMBER 4

FIELD HUGOTON

LOCATION OF WELL: COUNTY KEARNY

1250 ENL feet from south/north line of section

* 2050 ENL feet from east / west line of section

SECTION 1 TWP 26S (s) RG 38W E/W

IS SECTION X REGULAR or _____ IRREGULAR

IF SECTION IS IRREGULAR, LOCATE WELL FROM
NEAREST CORNER BOUNDARY. (check line below)

Section corner used: NE NW SE SW

NUMBER OF ACRES ATTRIBUTABLE TO WELL 640

QTR/QTR/QTR OF ACREAGE SE - NE - NW

(Show the location of the well and shade attributable acreage for prorated or spaced wells).
(Show the footage to the nearest lease or unit boundary line; and show footage to the nearest common source supply well).

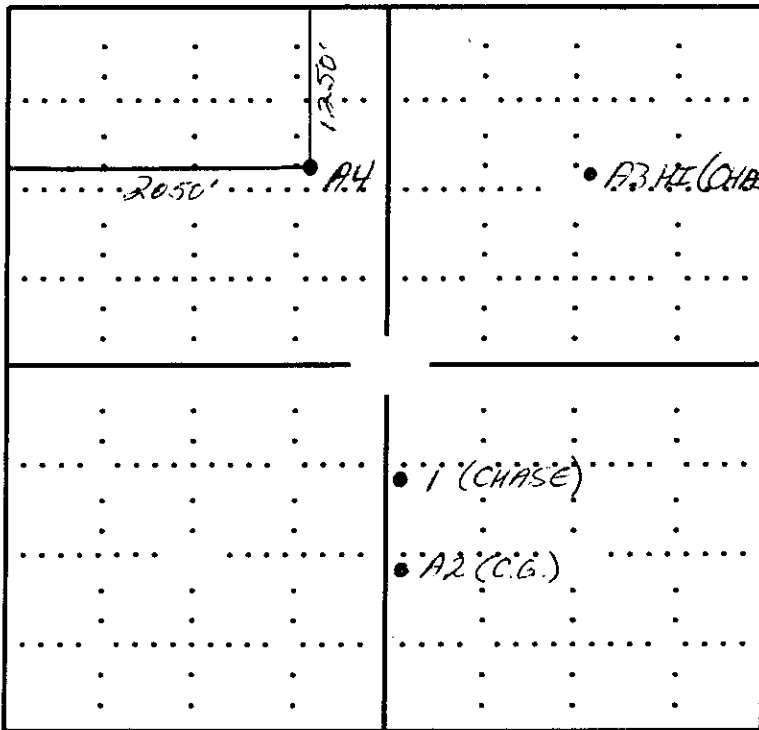

RECEIVED
KANSAS CORPORATION COMMISSION

JUN 18 2010

CONSERVATION DIVISION
WICHITA, KS

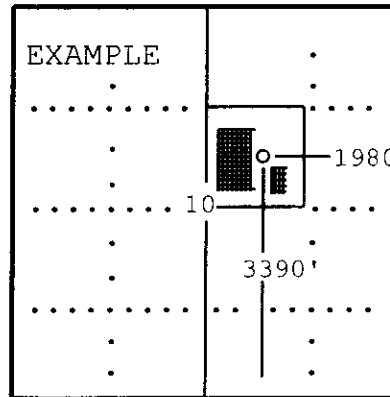

SEWARD CO.

The undersigned hereby certifies as REGULATORY STAFF ASSISTANT (title) for

BP AMERICA PRODUCTION COMPANY

(Co.), a duly authorized agent, that all information shown hereon is true and correct to the best of my knowledge and belief, that all acreage claimed attributable to the well named herein is held by production from that well and hereby make application for an allowable to be assigned to the well upon the filing of this form and the State test, whichever is later.

Signature [Signature]

Subscribed and sworn to before me on this 15 day of June, 2010

[Signature]
Notary Public

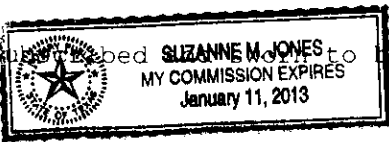

My Commission expires

1-11-2013

15-093-21862000

McKINNEY GU A-4

1250' FNL

2050' FWL

LATITUDE: 37°49'28.032"

LONGITUDE: 101°25'43.901"

GROUND ELEVATION: 3132.6'

WATER WELL WITHIN 1/4 MILE: YES

PUBLIC WATER SUPPLY WITHIN 1 MILE: NO

CORRECTED

NOTES:

1. BEARINGS HEREON ARE RELATIVE TO TRUE NORTH AS DETERMINED FROM G.P.S. OBSERVATIONS.

2. THIS PLAT DOES NOT REPRESENT A TRUE BOUNDARY SURVEY. THE FOOTAGES AND TIES SHOWN ARE FROM LINES OF OCCUPATION WHICH MAY NOT BE ACTUAL PROPERTY LINES.



35 36 36 31

2

6

SANDHILLS

WINDMILL
769' TO McKINNEY GU A-4

1250'

2050'

SANDY PASTURE

ROUGH

**McKINNEY GU A-4
DATUM NAD 27
LAT. 37°49'28.032"
LONG. 101°25'43.901"**

RECEIVED
KANSAS CORPORATION COMMISSION

JUN 18 2010

CONSERVATION DIVISION
WICHITA, KS

SECTION 1 T-26-S, R-38-W

2

6

11

12

12

7

MET MAVERICK
ENGINEERING, INC.
www.maverickengineering.com

408 SW 7th AVENUE
AMARILLO, TX 79101
PHONE: 806-323-1800
FAX: 806-322-1801

DRAWN BY: DALE HALATA
APPROVED BY: J.D. KELLER
SCALE: 1" = 1000'
DATE: JUNE 14, 2010

bp 2225 W. OKLAHOMA AVE.
ULYSSES KANSAS 67880
PH: (620)356-8981
FAX: (620)356-8950

AUTHORIZED BY: JOE EUDEY

McKINNEY GU A-4
SECTION 1
T-26-S, R-38-W
KEARNY COUNTY, KANSAS

AMENDED

KANSAS CORPORATION COMMISSION
OIL & GAS CONSERVATION DIVISION

Form CDP-1
April 2004
Form must be Typed

APPLICATION FOR SURFACE PIT

Submit in Duplicate

CORRECTED

Operator Name: BP America Production Company		License Number: 5952	
Operator Address: P. O. Box 3092, Houston, TX 77253-3092, Room 3.454B, WL-1			
Contact Person: DeAnn Snyers		Phone Number: (281) 366-4395	
Lease Name & Well No.: McKinney Gas Unit 'A' #4		Pit Location (QQQQ): SW - SE - NE - NW	
Type of Pit: <input type="checkbox"/> Emergency Pit <input type="checkbox"/> Burn Pit <input type="checkbox"/> Settling Pit <input checked="" type="checkbox"/> Drilling Pit <input type="checkbox"/> Workover Pit <input type="checkbox"/> Haul-Off Pit <small>(If WP Supply API No. or Year Drilled)</small>	Pit is <input checked="" type="checkbox"/> Proposed <input type="checkbox"/> Existing If existing, date constructed _____ Pit capacity 4375 (bbis)	Sec. 1 Twp. 26S R. 38 <input type="checkbox"/> East <input checked="" type="checkbox"/> West 1250 Feet from <input checked="" type="checkbox"/> North/ <input type="checkbox"/> South Line of Section * 2050 Feet from <input type="checkbox"/> East/ <input checked="" type="checkbox"/> West Line of Section Kearny County	
Is the pit located in a Sensitive Ground Water Area? <input checked="" type="checkbox"/> Yes <input checked="" type="checkbox"/> No		Chloride concentration: _____ mg/l <small>(For Emergency Pits and Settling Pits, only)</small>	
Is the bottom below ground level? <input checked="" type="checkbox"/> Yes <input type="checkbox"/> No	Artificial Liner? <input type="checkbox"/> Yes <input checked="" type="checkbox"/> No	How is pit lined if a plastic liner is not used? Sealed with Bentonite from drilling fluid	
Pit dimensions (all but working pits): 75 Length (feet) 75 Width (feet) N/A Steel Pits Depth from ground level to deepest point 5 (feet)			
If the pit is lined give a brief description of the liner material, thickness and installation procedure.		Describe procedures for periodic maintenance and determining liner integrity, including any special monitoring. RECEIVED KANSAS CORPORATION COMMISSION JUN 18 2010 CONSERVATION DIVISION WICHITA, KS	
Distance to nearest water well within one-mile of pit N/A feet Depth of water well _____ feet		Depth to shallowest fresh water _____ feet. Source of information: _____ measured _____ well owner _____ electric log _____ KDWR	
Emergency, Settling and Burn Pits ONLY: Producing Formation: _____ Number of producing wells on lease: _____ Barrels of fluid produced daily: _____ Does the slope from the tank battery allow all spilled fluids to flow into the pond? <input type="checkbox"/> Yes <input type="checkbox"/> No		Drilling, Workover and Haul-Off Pits ONLY: Type of material utilized in drilling/workover Bentonite Number of working pits to be utilized 0 Abandonment procedure: Evaporate & Backfill Drill pits must be closed within 365 days of spud date.	
I hereby certify that the above statements are true and correct to the best of my knowledge and belief. 6/15/2010 DeAnn Snyers Date Signature of Applicant or Agent			
KCC OFFICE USE ONLY			
Date Received: _____ Permit Number: _____ Permit Date: 6-15-10 Lease Inspection: <input checked="" type="checkbox"/> Yes <input type="checkbox"/> No			

15-093-21862-0005