

For KCC Use: 7-7-10
 Effective Date: _____
 District #: 2
 SGA? Yes No

KANSAS CORPORATION COMMISSION
 OIL & GAS CONSERVATION DIVISION

Form C-1
 March 2010
Form must be Typed
Form must be Signed
All blanks must be Filled

NOTICE OF INTENT TO DRILL

Must be approved by KCC five (5) days prior to commencing well
Form KSONA-1, Certification of Compliance with the Kansas Surface Owner Notification Act, MUST be submitted with this form.

Expected Spud Date: 07 / 07 / 2010
month day year

OPERATOR: License# 31958 ✓
 Name: Hesse Petroleum Company, LLC
 Address 1: 400 N. Woodlawn
 Address 2: Suite 7
 City: Wichita State: KS Zip: 67205 + 4 3 3
 Contact Person: Phil Hesse
 Phone: (316) 685-4746
 CONTRACTOR: License# 5123 ✓
 Name: Pickrell Drilling Company, Inc.

Spot Description: _____
NW - NW - SE - SE Sec. 17 Twp. 24 S. R. 9 E W
(XXXX) 1,125 feet from N / S Line of Section
1,072 feet from E / W Line of Section

Is SECTION: Regular Irregular?
 (Note: Locate well on the Section Plat on reverse side)

County: Reno
 Lease Name: Hinshaw Well #: 3
 Field Name: Plevna South ✓

Is this a Prorated / Spaced Field? Yes No
 Target Formation(s): Arbuckle ✓

Nearest Lease or unit boundary line (in footage): 1072' ✓
 Ground Surface Elevation: 1675 approx ✓ feet MSL

Water well within one-quarter mile: Yes No ✓
 Public water supply well within one mile: Yes No ✓

Depth to bottom of fresh water: 80' ✓
 Depth to bottom of usable water: 120' ✓

Surface Pipe by Alternate: I II ✓
 Length of Surface Pipe Planned to be set: 210' ✓

Length of Conductor Pipe (if any): _____
 Projected Total Depth: 4200 ✓

Formation at Total Depth: Arbuckle ✓

Water Source for Drilling Operations: Well Farm Pond Other: _____
 DWR Permit #: _____

(Note: Apply for Permit with DWR) No ✓

Will Cores be taken? Yes No ✓
 If Yes, proposed zone: _____

Well Drilled For: Oil Enh Rec Infield Mud Rotary
 Gas Storage Pool Ext. Air Rotary
 Disposal Wildcat Cable
 Seismic; _____ # of Holes Other _____
 Other: _____
 If OWWO: old well information as follows: ✓

Operator: _____
 Well Name: _____
 Original Completion Date: _____ Original Total Depth: _____

Directional, Deviated or Horizontal wellbore? Yes No ✓
 If Yes, true vertical depth: _____
 Bottom Hole Location: _____
 KCC DKT #: _____

AFFIDAVIT

The undersigned hereby affirms that the drilling, completion and eventual plugging of this well will comply with K.S.A. 55 et. seq.

It is agreed that the following minimum requirements will be met:

1. Notify the appropriate district office **prior** to spudding of well;
2. A copy of the approved notice of intent to drill **shall be** posted on each drilling rig;
3. The minimum amount of surface pipe as specified below **shall be set** by circulating cement to the top; in all cases surface pipe **shall be set** through all unconsolidated materials plus a minimum of 20 feet into the underlying formation.
4. If the well is dry hole, an agreement between the operator and the district office on plug length and placement is necessary **prior to plugging**;
5. The appropriate district office will be notified before well is either plugged or production casing is cemented in;
6. If an ALTERNATE II COMPLETION, production pipe shall be cemented from below any usable water to surface within **120 DAYS** of spud date. Or pursuant to Appendix "B" - Eastern Kansas surface casing order #133,891-C, which applies to the KCC District 3 area, alternate II cementing must be completed within 30 days of the spud date or the well shall be plugged. **In all cases, NOTIFY district office** prior to any cementing.

I hereby certify that the statements made herein are true and to the best of my knowledge and belief.

Date: 06/23/2010 Signature of Operator or Agent: Phil Hesse Title: Partner

For KCC Use ONLY
 API # 15 - 155-21559-00-00
 Conductor pipe required _____ feet
 Minimum surface pipe required 140 feet per ALT. I II
 Approved by: SB 7-2-10
 This authorization expires: 7-2-11
 (This authorization void if drilling not started within 12 months of approval date.)
 Spud date: _____ Agent: _____

Remember to:

- File Certification of Compliance with the Kansas Surface Owner Notification Act (KSONA-1) with Intent to Drill;
- File Drill Pit Application (form CDP-1) with Intent to Drill;
- File Completion Form ACO-1 within 120 days of spud date;
- File acreage attribution plat according to field proration orders;
- Notify appropriate district office 48 hours prior to workover or re-entry;
- Submit plugging report (CP-4) after plugging is completed (within 60 days);
- Obtain written approval before disposing or injecting salt water.
- If well will not be drilled or permit has expired (See: authorized expiration date) please check the box below and return to the address below.

Well will not be drilled or Permit Expired Date: _____
 Signature of Operator or Agent: _____

Mail to: KCC - Conservation Division,
 130 S. Market - Room 2078, Wichita, Kansas 67202

17
24
9
 E
 W

For KCC Use ONLY
API # 15 - 155-21559-00-00

IN ALL CASES PLOT THE INTENDED WELL ON THE PLAT BELOW

In all cases, please fully complete this side of the form. Include items 1 through 5 at the bottom of this page.

Operator: Hesse Petroleum Company, LLC
Lease: Hinshaw
Well Number: 3
Field: Plevna
Number of Acres attributable to well: _____
QTR/QTR/QTR/QTR of acreage: _____

Location of Well: County: Reno
1,125 feet from N / S Line of Section
1,072 feet from E / W Line of Section
Sec. 17 Twp. 24 S. R. 9 E W

Is Section: Regular or Irregular

If Section is Irregular, locate well from nearest corner boundary.
Section corner used: NE NW SE SW

PLAT

Show location of the well. Show footage to the nearest lease or unit boundary line. Show the predicted locations of lease roads, tank batteries, pipelines and electrical lines, as required by the Kansas Surface Owner Notice Act (House Bill 2032). You may attach a separate plat if desired.

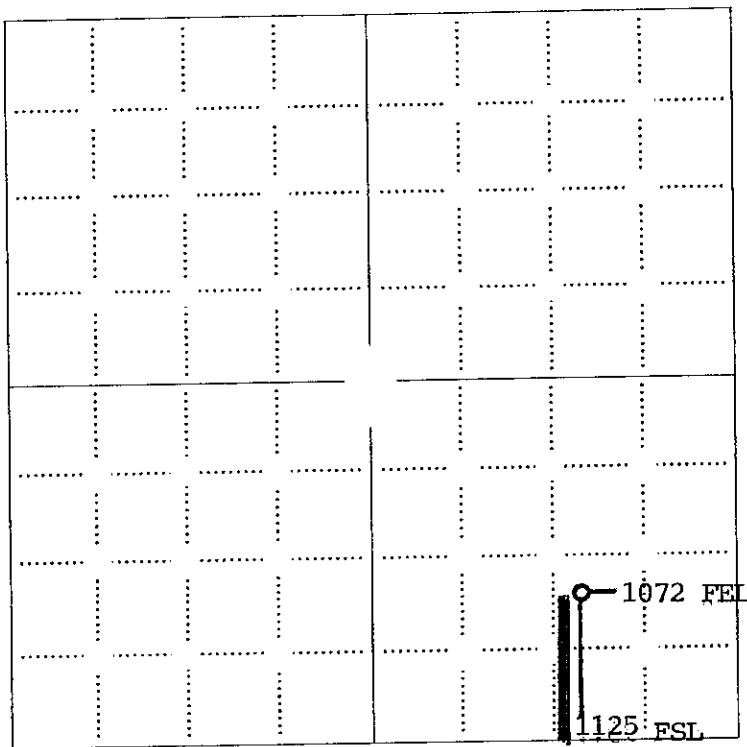

LEGEND

- Well Location
- Tank Battery Location
- Pipeline Location
- Electric Line Location
- Lease Road Location

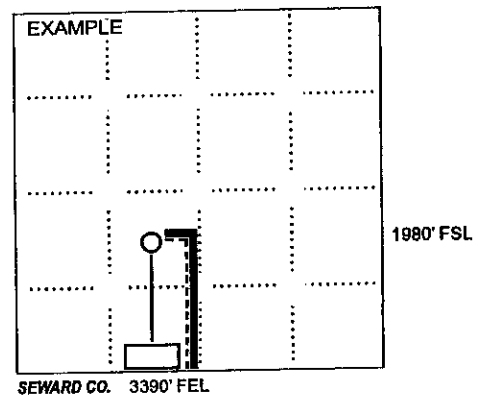

NOTE: In all cases locate the spot of the proposed drilling location.

In plotting the proposed location of the well, you must show:

1. The manner in which you are using the depicted plat by identifying section lines, i.e. 1 section, 1 section with 8 surrounding sections, 4 sections, etc.
2. The distance of the proposed drilling location from the south / north and east / west outside section lines.
3. The distance to the nearest lease or unit boundary line (in footage).
4. If proposed location is located within a prorated or spaced field a certificate of acreage attribution plat must be attached: (CO-7 for oil wells; CG-8 for gas wells).
5. The predicted locations of lease roads, tank batteries, pipelines, and electrical lines.

RECEIVED
KANSAS CORPORATION COMMISSION

JUN 28 2010

CONSERVATION DIVISION
WICHITA, KS

HESSE PETROLEUM COMPANY, LLC
HINSHAW LEASE
SE. 1/4, SECTION 17, T24S, R9W
RENO COUNTY, KANSAS

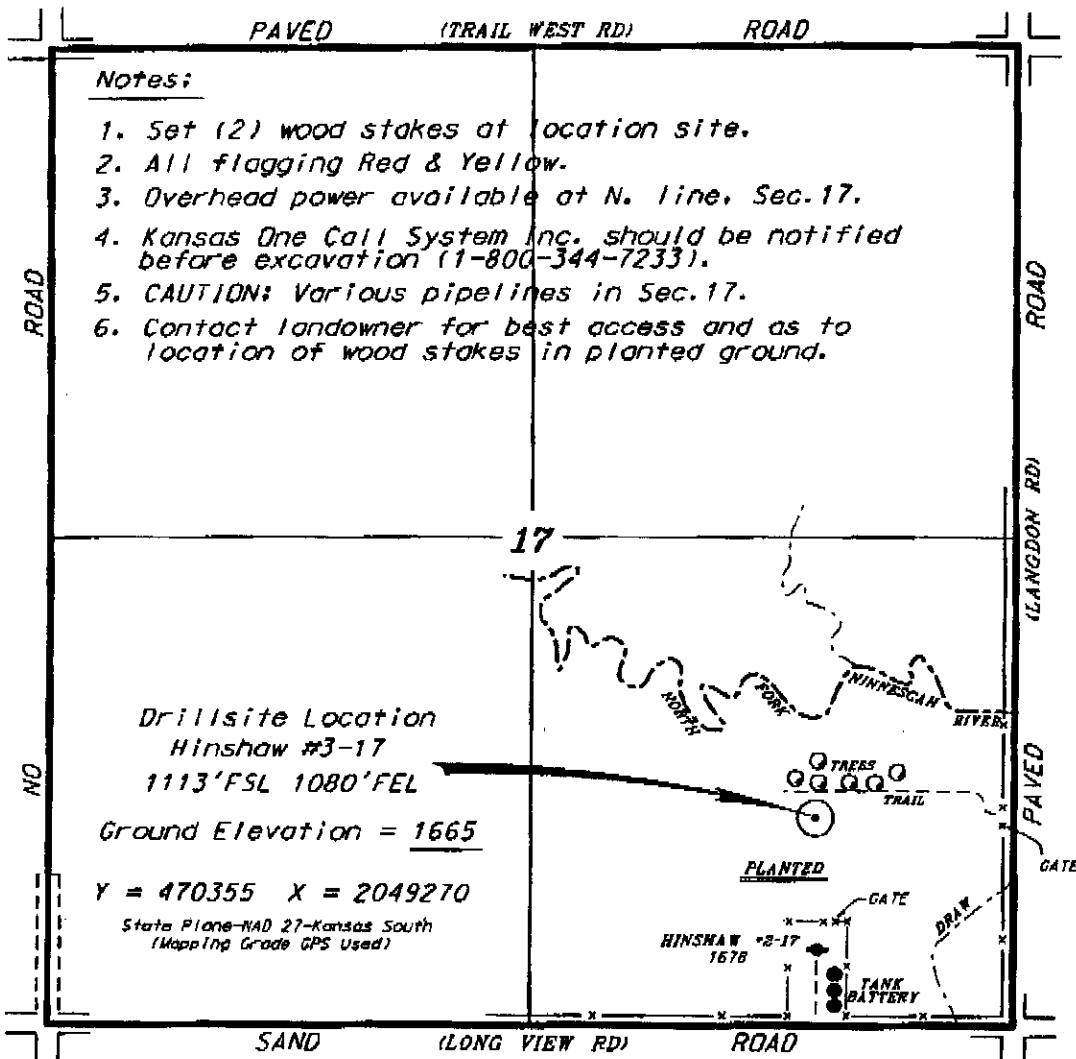

*Ingress and egress to location as shown on this plat is for usage only and may not be legally gained for public use. Contact landowner, tenant and county road department for access.

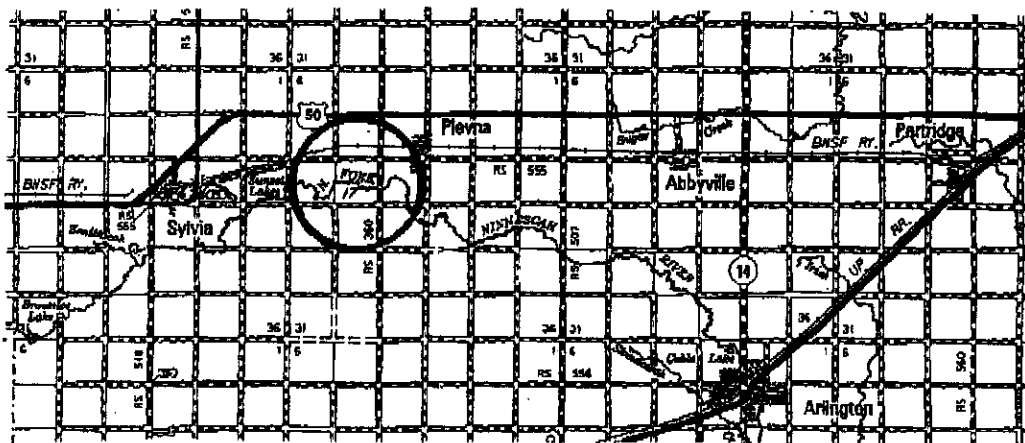

Controlling data is based upon the best maps and photographs available to us and upon a regular section of land containing 640 acres.

Approximate section lines were determined using the normal standard of care of oilfield surveyors practicing in the state of Kansas. The section corners, which establish the precise section lines, were not necessarily located, and the exact location of the drillsite location in the section is not guaranteed. Therefore, the operator securing this service and accepting this plat and all other parties relying thereon agree to hold Central Kansas Oilfield Services, Inc., its officers and employees harmless from all, losses, costs and expenses and said entities released from any liability from incidental or consequential damages.

Elevations derived from National Geodetic Vertical Datum.

Date June 24, 2010

CENTRAL KANSAS OILFIELD SERVICES, INC. (620)792-1977

RECEIVED
KANSAS CORPORATION COMMISSION

JUN 28 2010

CONSERVATION DIVISION
WICHITA, KS

15-155-21539-00-00

**KANSAS CORPORATION COMMISSION
OIL & GAS CONSERVATION DIVISION
APPLICATION FOR SURFACE PIT**

Form GDP-1
May 2010
Form must be Typed

Submit in Duplicate

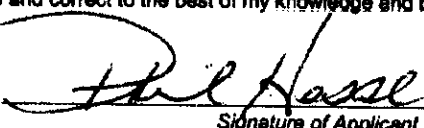
Operator Name: Hesse Petroleum Company, LLC		License Number: 31958
Operator Address: 400 N. Woodlawn		Suite 7
		Wichita KS 67205
Contact Person: Phil Hesse		Phone Number: (316) 685-4746
Lease Name & Well No.: Hinshaw 3		Pit Location (QQQQ): <u>NW - NW - SE - SE</u>
Type of Pit: <input type="checkbox"/> Emergency Pit <input type="checkbox"/> Burn Pit <input type="checkbox"/> Settling Pit <input checked="" type="checkbox"/> Drilling Pit <input type="checkbox"/> Workover Pit <input type="checkbox"/> Haul-Off Pit <i>(If WOP Supply API No. or Year Drilled)</i>	Pit is: <input checked="" type="checkbox"/> Proposed <input type="checkbox"/> Existing If Existing, date constructed: _____ Pit capacity: _____ (bbls)	Sec. <u>17</u> Twp. <u>24</u> R. <u>9</u> <input type="checkbox"/> East <input checked="" type="checkbox"/> West <u>1185</u> Feet from <input type="checkbox"/> North / <input checked="" type="checkbox"/> South Line of Section <u>1072</u> Feet from <input checked="" type="checkbox"/> East / <input type="checkbox"/> West Line of Section Reno _____ County
Is the pit located in a Sensitive Ground Water Area? <input checked="" type="checkbox"/> Yes <input type="checkbox"/> No		Chloride concentration: _____ mg/l <i>(For Emergency Pits and Settling Pits only)</i>
Is the bottom below ground level? <input checked="" type="checkbox"/> Yes <input type="checkbox"/> No	Artificial Liner? <input type="checkbox"/> Yes <input checked="" type="checkbox"/> No	How is the pit lined if a plastic liner is not used? <u>NATIVE CLAY</u>
Pit dimensions (all but working pits): <u>70</u> Length (feet) <u>70</u> Width (feet) <input type="checkbox"/> N/A: Steel Pits Depth from ground level to deepest point: <u>3</u> (feet) <input type="checkbox"/> No Pit		
If the pit is lined give a brief description of the liner material, thickness and installation procedure.		Describe procedures for periodic maintenance and determining liner integrity, including any special monitoring.
		RECEIVED KANSAS CORPORATION COMMISSION JUN 28 2010 CONSERVATION DIVISION WICHITA, KS
Distance to nearest water well within one-mile of pit: <u>2450</u> feet Depth of water well <u>70</u> feet	Depth to shallowest fresh water <u>13</u> feet.	Source of information: <input type="checkbox"/> measured <input type="checkbox"/> well owner <input type="checkbox"/> electric log <input checked="" type="checkbox"/> KQWR
Emergency, Settling and Burn Pits ONLY: Producing Formation: _____ Number of producing wells on lease: _____ Barrels of fluid produced daily: _____ Does the slope from the tank battery allow all spilled fluids to flow into the pit? <input type="checkbox"/> Yes <input type="checkbox"/> No	Drilling, Workover and Haul-Off Pits ONLY: Type of material utilized in drilling/workover: <u>Mud</u> Number of working pits to be utilized: <u>3</u> Abandonment procedure: <u>Haul Fluid, Dry, Backfill</u> Drill pits must be closed within 365 days of spud date.	
I hereby certify that the above statements are true and correct to the best of my knowledge and belief.		
<u>06/23/2010</u> Date	 Signature of Applicant or Agent	
KCC OFFICE USE ONLY		
<input type="checkbox"/> Liner <input checked="" type="checkbox"/> Steel Pit <input checked="" type="checkbox"/> RFAC <input type="checkbox"/> RFAS		
Date Received: <u>6-28-10</u> Permit Number: _____ Permit Date: <u>7-1-10</u> Lease Inspection: <input checked="" type="checkbox"/> Yes <input type="checkbox"/> No		

15-155-21599-00-00



Mark Parkinson, Governor
Thomas E. Wright, Chairman
Joseph F. Harkins, Commissioner
Ward Loyd, Commissioner

July 1, 2010

Hesse Petroleum Company, LLC
400 N. Woodlawn Ste 7
Wichita, KS 67205-4333

RE: Drilling Pit Application
Hinshaw Lease Well No. 3
SE/4 Sec. 17-24S-09W
Reno County, Kansas

Dear Sir or Madam:

District staff has inspected the location and has determined that an unsealed condition will present a pollution threat to water resources.

District staff has instructed that no earthen pits are to be used at the location. Steel pits are to be used. Please inform the Commission in writing as to which disposal well you will utilize to dispose of the contents in the steel pits and the amount of fluid that will be disposed. **If a haul-off pit is necessary please file, form CDP-1, Application for Surface Pit.** This location will have to be inspected prior to approval of the haul-off pit application.

If fluids are taken to an authorized disposal well, please call the District Office at (316) 630-4000. Please file form CDP-5, Exploration and Production Waste Transfer, within 30 days of fluid removal. Conservation division forms are available through our office and on the KCC web site: www.kcc.state.ks.us/conservation/forms.

Sincerely,

Kathy Haynes
Environmental Protection and Remediation Department

Cc: File

15-155-21559-00-00

Kansas Corporation Commission Oil & Gas Conservation Division

HAUL-OFF PIT APPLICATION FILING REQUIREMENTS

82-3-607. DISPOSAL OF DIKE AND PIT CONTENTS.

- (a) Each operator shall perform one of the following when disposing of dike or pit contents:
- (1) Remove the liquid contents to a disposal well or other oil and gas operation approved by the commission or to road maintenance or construction locations approved by the department;
 - (2) dispose of reserve pit waste down the annular space of a well completed according to the alternate requirements of K.A.R. 82-3-106, if the waste to be disposed of was generated during the drilling and completion of the well; or
 - (3) dispose of the remaining solid contents in any manner required by the commission. The requirements may include any of the following:
 - (A) Burial in place, in accordance with the grading and restoration requirements in K.A.R. 82-3-602 (f);
 - (B) removal and placement of the contents in an on-site disposal area approved by the commission;
 - (C) removal and placement of the contents in an off-site disposal area on acreage owned by the same landowner or to another producing lease or unit operated by the same operator, if prior written permission from the landowner has been obtained; or
 - (D) removal of the contents to a permitted off-site disposal area approved by the department.
- (b) Each violation of this regulation shall be punishable by the following:
- (1) A \$1,000 penalty for the first violation;
 - (2) a \$2,500 penalty for the second violation; and
 - (3) a \$5,000 penalty and an operator license review for the third violation.

Complete and return with Haul-Off Pit Application, Form CDP1(2004)

Haul-off pit will be located in an on-site disposal area: Yes No

Haul-off pit is located in an off-site disposal area on acreage owned by the same landowner:
 Yes No If yes, written permission from the land owner must be obtained. Attach written permission to haul-off pit application.

Haul-off pit is located in an off-site disposal area on another **producing** lease or unit operated by the same operator: Yes No If yes, written permission from the land owner must be obtained. Attach permission and a copy of the lease assignment that covers the acreage where the haul-off pit is to be located, to the haul-off pit application.

KANSAS CORPORATION COMMISSION
OIL & GAS CONSERVATION DIVISION
**CERTIFICATION OF COMPLIANCE WITH THE
KANSAS SURFACE OWNER NOTIFICATION ACT**

Form KSONA-1
July 2010
Form Must Be Typed
Form must be Signed
All blanks must be Filled

This form must be submitted with all Forms C-1 (Notice of Intent to Drill); CB-1 (Cathodic Protection Borehole Intent); T-1 (Request for Change of Operator Transfer of Injection or Surface Pit Permit); and CP-1 (Well Plugging Application). Any such form submitted without an accompanying Form KSONA-1 will be returned.

Select the corresponding form being filed: C-1 (Intent) CB-1 (Cathodic Protection Borehole Intent) T-1 (Transfer) CP-1 (Plugging Application)

OPERATOR: License # 31958
Name: Hesse Petroleum Company, LLC
Address 1: 400 N. Woodlawn
Address 2: Suite 7
City: Wichita State: KS Zip: 67205 + 4 3 3 3
Contact Person: Phil Hesse
Phone: (316) 685-4746 Fax: (316) 685-4749
Email Address:

Well Location:
Sec. 17 Twp. 24 S. R. 9 East West
County: Reno
Lease Name: Hinshaw Well #: 3

If filing a Form T-1 for multiple wells on a lease, enter the legal description of the lease below:

RECEIVED
KANSAS CORPORATION COMMISSION

Surface Owner Information:

Name: Dale Hinshaw JUN 28 2010
Address 1: Box 79, Route 1
Address 2: CONSERVATION DIVISION
WICHITA, KS
City: Benton State: KS Zip: 67017 +

When filing a Form T-1 involving multiple surface owners, attach an additional sheet listing all of the information to the left for each surface owner. Surface owner information can be found in the records of the register of deeds for the county, and in the real estate property tax records of the county treasurer.

If this form is being submitted with a Form C-1 (Intent) or CB-1 (Cathodic Protection Borehole Intent), you must supply the surface owners and the KCC with a plat showing the predicted locations of lease roads, tank batteries, pipelines, and electrical lines. The locations shown on the plat are preliminary non-binding estimates. The locations may be entered on the Form C-1 plat, Form CB-1 plat, or a separate plat may be submitted.

Select one of the following:

I certify that, pursuant to the Kansas Surface Owner Notice Act (House Bill 2032), I have provided the following to the surface owner(s) of the land upon which the subject well is or will be located: 1) a copy of the Form C-1, Form CB-1, Form T-1, or Form CP-1 that I am filing in connection with this form; 2) if the form being filed is a Form C-1 or Form CB-1, the plat(s) required by this form; and 3) my operator name, address, phone number, fax, and email address.

I have not provided this information to the surface owner(s). I acknowledge that, because I have not provided this information, the KCC will be required to send this information to the surface owner(s). To mitigate the additional cost of the KCC performing this task, I acknowledge that I am being charged a \$30.00 handling fee, payable to the KCC, which is enclosed with this form.

If choosing the second option, submit payment of the \$30.00 handling fee with this form. If the fee is not received with this form, the KSONA-1 form and the associated Form C-1, Form CB-1, Form T-1, or Form CP-1 will be returned.

I hereby certify that the statements made herein are true and correct to the best of my knowledge and belief.

Date: 06/23/2010 Signature of Operator or Agent: Phil Hesse Title: Partner