

RECEIVED  
JUL 13 2010

Form C-1  
March 2010

For KCC Use:  
Effective Date: 7-19-2010  
District #: 2

KANSAS CORPORATION COMMISSION  
OIL & GAS CONSERVATION DIVISION

Form must be Typed  
Form must be Signed  
All blanks must be Filled

NOTICE OF INTENT TO DRILL KCC WICHITA

Must be approved by KCC five (5) days prior to commencing well  
Form KSONA-1, Certification of Compliance with the Kansas Surface Owner Notification Act, MUST be submitted with this form.

Expected Spud Date: July 15 2010  
month day year

Spot Description: 175' East of  
SE SW NW Sec. 31 Twp. 33 S. R. 8  E  W  
(200/0/0) 2,310 feet from  N /  S Line of Section  
1,165 feet from  E /  W Line of Section

OPERATOR: License# 33936  
Name: CHARLES N. GRIFFIN  
Address 1: P.O. Box 347  
Address 2:  
City: Pratt State: KS Zip: 67124 +  
Contact Person: Charles N. Griffin  
Phone: 720-490-5648

Is SECTION:  Regular  Irregular?  
(Note: Locate well on the Section Plat on reverse side)

CONTRACTOR: License# 33549  
Name: LANDMARK DRILLING, LLC

County: Harper  
Lease Name: Diel Well #: 1  
Field Name: Hibbard North East

Well Drilled For:  Oil  Gas  Enh Rec  Storage  Disposal  
Well Class:  Infield  Pool Ext.  Wildcat  Other  
Type Equipment:  Mud Rotary  Air Rotary  Cable  
 Seismic: # of Holes  Other:  
 If OWWO: old well information as follows:

Is this a Prorated / Spaced Field?  Yes  No  
Target Formation(s): Mississippian  
Nearest Lease or unit boundary line (in footage): 330'

Operator:  
Well Name:  
Original Completion Date: Original Total Depth:

Ground Surface Elevation: 1298 feet MSL  
Water well within one-quarter mile:  Yes  No  
Public water supply well within one mile:  Yes  No

Directional, Deviated or Horizontal wellbore?  Yes  No  
If Yes, true vertical depth:  
Bottom Hole Location:  
KCC DKT #:

Depth to bottom of fresh water: 120  
Depth to bottom of usable water: 180  
Surface Pipe by Alternate:  I  II  
Length of Surface Pipe Planned to be set: 200+

Length of Conductor Pipe (if any):  
Projected Total Depth: 5100  
Formation at Total Depth: Arbuckle

Water Source for Drilling Operations:  
 Well  Farm Pond  Other:  
DWR Permit #:

(Note: Apply for Permit with DWR)   
Will Cores be taken?  Yes  No  
If Yes, proposed zone:

AFFIDAVIT

The undersigned hereby affirms that the drilling, completion and eventual plugging of this well will comply with K.S.A. 55 et. seq.  
It is agreed that the following minimum requirements will be met:

1. Notify the appropriate district office **prior** to spudding of well;
2. A copy of the approved notice of intent to drill **shall be** posted on each drilling rig;
3. The minimum amount of surface pipe as specified below **shall be set** by circulating cement to the top; in all cases surface pipe **shall be set** through all unconsolidated materials plus a minimum of 20 feet into the underlying formation.
4. If the well is dry hole, an agreement between the operator and the district office on plug length and placement is necessary **prior to plugging**;
5. The appropriate district office will be notified before well is either plugged or production casing is cemented in;
6. If an ALTERNATE II COMPLETION, production pipe shall be cemented from below any usable water to surface within **120 DAYS** of spud date.  
Or pursuant to Appendix "B" - Eastern Kansas surface casing order #133,891-C, which applies to the KCC District 3 area, alternate II cementing must be completed within 30 days of the spud date or the well shall be plugged. **In all cases, NOTIFY district office** prior to any cementing.

I hereby certify that the statements made herein are true and to the best of my knowledge and belief.

Date: 7/13/10 Signature of Operator or Agent: \_\_\_\_\_ Title: Agent

For KCC Use ONLY  
API # 15 - 077-21689-00-00  
Conductor pipe required None feet  
Minimum surface pipe required 200 feet per ALT.  I  II  
Approved by: Rum 7-14-2010  
This authorization expires: 7-14-2011  
(This authorization void if drilling not started within 12 months of approval date.)  
Spud date: \_\_\_\_\_ Agent: \_\_\_\_\_

- Remember to:
- File Certification of Compliance with the Kansas Surface Owner Notification Act (KSONA-1) with Intent to Drill;
  - File Drill Pit Application (form CDP-1) with Intent to Drill;
  - File Completion Form ACO-1 within 120 days of spud date;
  - File acreage attribution plat according to field proration orders;
  - Notify appropriate district office 48 hours prior to workover or re-entry;
  - Submit plugging report (CP-4) after plugging is completed (within 60 days);
  - Obtain written approval before disposing or injecting salt water.
  - If well will not be drilled or permit has expired (See: authorized expiration date) please check the box below and return to the address below.

Well will not be drilled or Permit Expired Date: \_\_\_\_\_  
Signature of Operator or Agent: \_\_\_\_\_

Mail to: KCC - Conservation Division,  
130 S. Market - Room 2078, Wichita, Kansas 67202

31  
33  
8  
 E  
 W

RECEIVED  
JUL 13 2010  
KCC WICHITA

For KCC Use ONLY  
API # 15 - 077-21689-0000

**IN ALL CASES PLOT THE INTENDED WELL ON THE PLAT BELOW**

In all cases, please fully complete this side of the form. Include items 1 through 5 at the bottom of this page.

Operator: CHARLES N. GRIFFIN  
Lease: Diel  
Well Number: 1  
Field: Hibbord North East  
Number of Acres attributable to well: \_\_\_\_\_  
QTR/QTR/QTR/QTR of acreage: \_\_\_\_\_ - SE - SW - NW

Location of Well: County: Harper  
2,310 feet from  N /  S Line of Section  
1,165 feet from  E /  W Line of Section  
Sec. 31 Twp. 33 S. R. 8  E  W  
Is Section:  Regular or  Irregular

If Section is Irregular, locate well from nearest corner boundary.  
Section corner used:  NE  NW  SE  SW

**PLAT**

Show location of the well. Show footage to the nearest lease or unit boundary line. Show the predicted locations of lease roads, tank batteries, pipelines and electrical lines, as required by the Kansas Surface Owner Notice Act (House Bill 2032).  
You may attach a separate plat if desired.

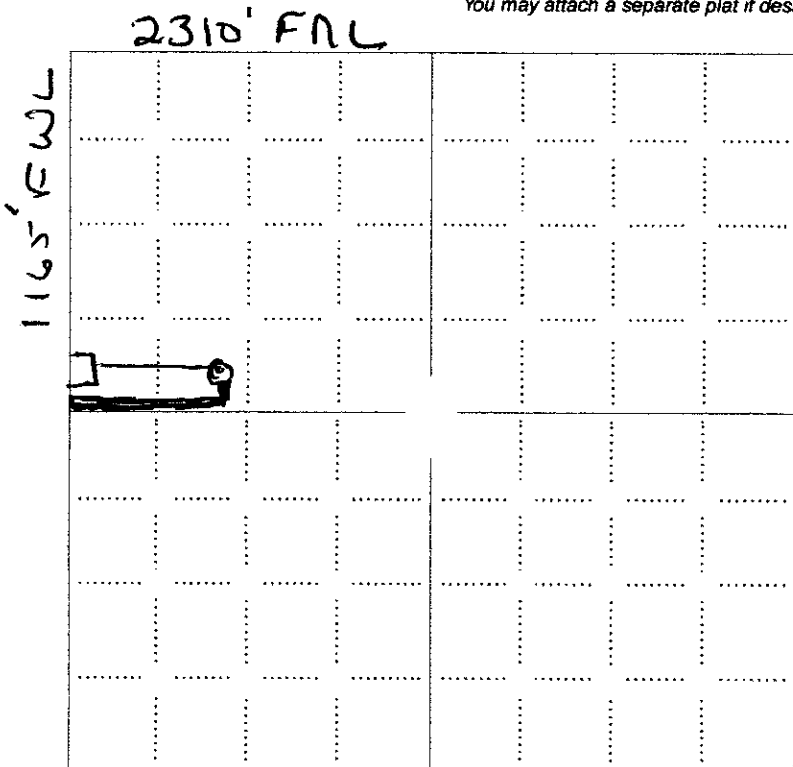

**LEGEND**

- Well Location
- Tank Battery Location
- Pipeline Location
- Electric Line Location
- Lease Road Location

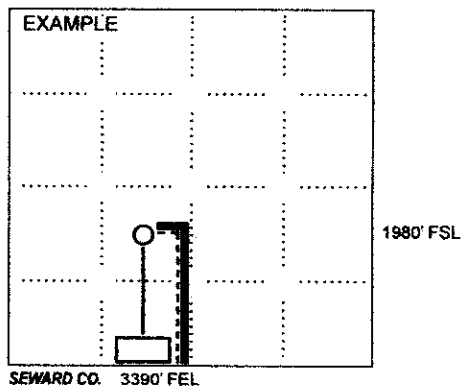

**NOTE: In all cases locate the spot of the proposed drilling locaton.**

**In plotting the proposed location of the well, you must show:**

1. The manner in which you are using the depicted plat by identifying section lines, i.e. 1 section, 1 section with 8 surrounding sections, 4 sections, etc.
2. The distance of the proposed drilling location from the south / north and east / west outside section lines.
3. The distance to the nearest lease or unit boundary line (in footage).
4. If proposed location is located within a prorated or spaced field a certificate of acreage attribution plat must be attached: (CO-7 for oil wells; CG-8 for gas wells).
5. The predicted locations of lease roads, tank batteries, pipelines, and electrical lines.

GRIFFIN MANAGEMENT, LLC  
 DIEI LEASE  
 NW.1/4. SECTION 31. T33S. RBW  
 HARPER COUNTY, KANSAS

RECEIVED  
 JUL 13 2010  
 KCC WICHITA

Ingress and egress to location as shown on this plot is for usage only and may not be legally opened for public use. Contact landowner, tenant and county road department for access.

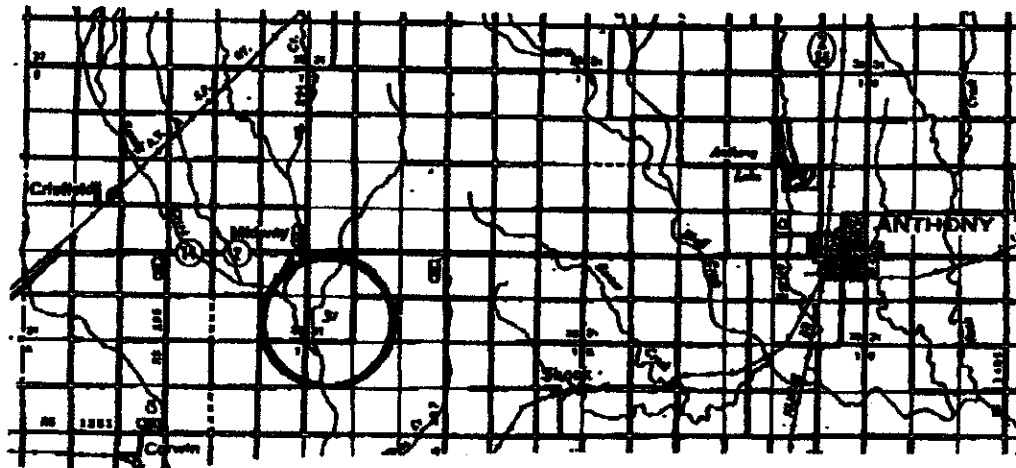
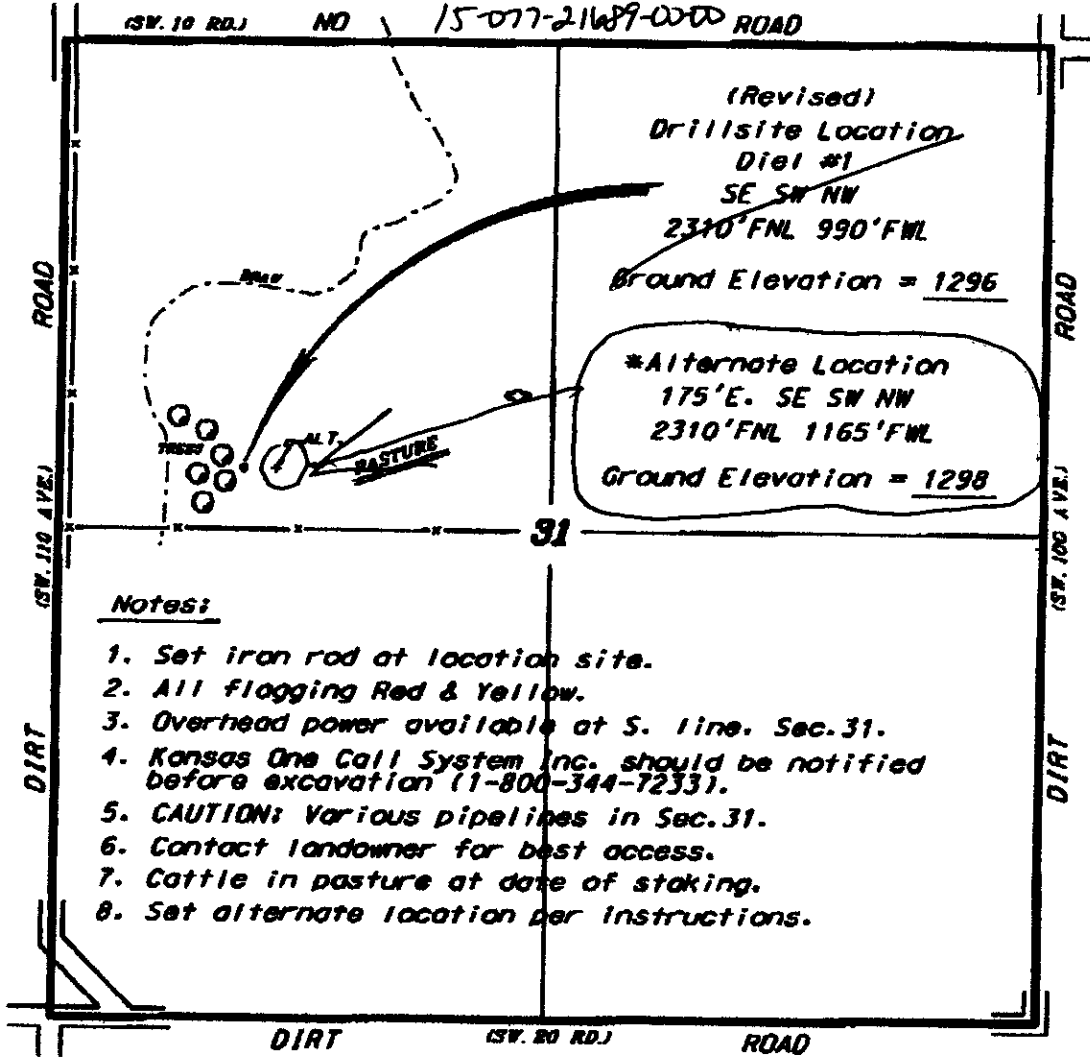

Control data is based upon the best map and photographic available to us and upon a regular section of land comprising 90 acres.  
 All bearings and distances were determined using the corner bearings of one or several surveys originating in the State of Kansas. The position bearings, which establish the precise location lines, were not necessarily observed, but the corner bearings of the original section in the section is not guaranteed. Therefore, the sponsor, bearing this service and accepting this plot and all other services arising therefrom agree to hold Central Kansas Oilfield Services, Inc., its officers and employees harmless from all losses, suits and expenses and avoid all claims and liability from incidental or consequential damage.  
 Elevations derived from National Geodetic Vertical Datum.

July 9, 2010

KANSAS CORPORATION COMMISSION  
OIL & GAS CONSERVATION DIVISION

RECEIVED

JUL 13 2010

Form CDP-1  
May 2010  
Form must be Typed

APPLICATION FOR SURFACE PIT

KCC WICHITA

Submit in Duplicate

Operator Name: <b>CHARLES N. GRIFFIN</b>		License Number: <b>33936</b>	
Operator Address: <b>P.O. Box 347</b>		<b>Pratt KS 67124</b>	
Contact Person: <b>Charles N. Griffin</b>		Phone Number: <b>720-490-5648</b>	
Lease Name & Well No.: <b>Diel 1</b>		Pit Location (QQQQ): <b>SW NW</b>	
Type of Pit: <input type="checkbox"/> Emergency Pit <input type="checkbox"/> Burn Pit <input type="checkbox"/> Settling Pit <input checked="" type="checkbox"/> Drilling Pit <input type="checkbox"/> Workover Pit <input type="checkbox"/> Haul-Off Pit <small>(If WP Supply API No. or Year Drilled)</small>	Pit is: <input checked="" type="checkbox"/> Proposed <input type="checkbox"/> Existing If Existing, date constructed: _____ Pit capacity: <del>4000</del> <b>9,000</b> (bbls)	Sec. <b>31</b> Twp. <b>33</b> R. <b>8</b> <input type="checkbox"/> East <input checked="" type="checkbox"/> West <b>2,777</b> Feet from <input type="checkbox"/> North / <input checked="" type="checkbox"/> South Line of Section <b>5,070</b> Feet from <input checked="" type="checkbox"/> East / <input type="checkbox"/> West Line of Section <b>Harper</b> _____ County	
Is the pit located in a Sensitive Ground Water Area? <input checked="" type="checkbox"/> Yes <input type="checkbox"/> No		Chloride concentration: _____ mg/l <small>(For Emergency Pits and Settling Pits only)</small>	
Is the bottom below ground level? <input checked="" type="checkbox"/> Yes <input type="checkbox"/> No	Artificial Liner? <input type="checkbox"/> Yes <input checked="" type="checkbox"/> No	How is the pit lined if a plastic liner is not used? <b>Native Mud And Clay</b>	
Pit dimensions (all but working pits): <b>100 150</b> Length (feet) <b>100 150</b> Width (feet)		<input type="checkbox"/> N/A: Steel Pits	
Depth from ground level to deepest point: <b>4</b> (feet)		<input type="checkbox"/> No Pit	
If the pit is lined give a brief description of the liner material, thickness and installation procedure.		Describe procedures for periodic maintenance and determining liner integrity, including any special monitoring.	
Distance to nearest water well within one-mile of pit: <b>N/A</b> feet    Depth of water well _____ feet		Depth to shallowest fresh water _____ feet. Source of information: <input type="checkbox"/> measured <input type="checkbox"/> well owner <input type="checkbox"/> electric log <input type="checkbox"/> KDWR	
<b>Emergency, Settling and Burn Pits ONLY:</b> Producing Formation: _____ Number of producing wells on lease: _____ Barrels of fluid produced daily: _____ Does the slope from the tank battery allow all spilled fluids to flow into the pit? <input type="checkbox"/> Yes <input type="checkbox"/> No		<b>Drilling, Workover and Haul-Off Pits ONLY:</b> Type of material utilized in drilling/workover: <b>Fresh</b> Number of working pits to be utilized: <b>1</b> Abandonment procedure: <b>Haul Clear Fluids. Allow To Dry, And Backfill</b> Drill pits must be closed within 365 days of spud date.	
I hereby certify that the above statements are true and correct to the best of my knowledge and belief.			
<b>7/13/10</b> Date		 Signature of Applicant or Agent	
<b>KCC OFFICE USE ONLY</b>			
Date Received: <b>7-13-10</b> Permit Number: _____		Permit Date: <b>7-14-10</b> Lease Inspection: <input checked="" type="checkbox"/> Yes <input type="checkbox"/> No	

15-077-21689-00-00

July 14, 2010

Charles N. Griffin  
PO Box 347  
Pratt, KS 67124

RE: Drilling Pit Application  
Diel Lease Well No. 1  
NW/4 Sec. 31-33S-08W  
Harper County, Kansas

Dear Sir or Madam:

District staff has inspected the location and has determined that an unsealed condition will present a pollution threat to water resources.

District staff has instructed that no earthen pits are to be used at the location. Steel pits are to be used. Please inform the Commission in writing as to which disposal well you will utilize to dispose of the contents in the steel pits and the amount of fluid that will be disposed. **If a haul-off pit is necessary please file, form CDP-1, Application for Surface Pit.** This location will have to be inspected prior to approval of the haul-off pit application.

If fluids are taken to an authorized disposal well, please call the District Office at (316) 630-4000. Please file form CDP-5, Exploration and Production Waste Transfer, within 30 days of fluid removal. Conservation division forms are available through our office and on the KCC web site: [www.kcc.state.ks.us/conservation/forms](http://www.kcc.state.ks.us/conservation/forms).

Sincerely,

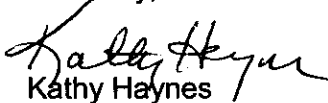
  
Kathy Haynes

Environmental Protection and Remediation Department

Cc: File

# Kansas Corporation Commission Oil & Gas Conservation Division

## HAUL-OFF PIT APPLICATION FILING REQUIREMENTS

### 82-3-607. DISPOSAL OF DIKE AND PIT CONTENTS.

- (a) Each operator shall perform one of the following when disposing of dike or pit contents:
- (1) Remove the liquid contents to a disposal well or other oil and gas operation approved by the commission or to road maintenance or construction locations approved by the department;
  - (2) dispose of reserve pit waste down the annular space of a well completed according to the alternate I requirements of K.A.R. 82-3-106, if the waste to be disposed of was generated during the drilling and completion of the well; or
  - (3) dispose of the remaining solid contents in any manner required by the commission. The requirements may include any of the following:
    - (A) Burial in place, in accordance with the grading and restoration requirements in K.A.R. 82-3-602 (f);
    - (B) removal and placement of the contents in an on-site disposal area approved by the commission;
    - (C) removal and placement of the contents in an off-site disposal area on acreage owned by the same landowner or to another producing lease or unit operated by the same operator, if prior written permission from the landowner has been obtained; or
    - (D) removal of the contents to a permitted off-site disposal area approved by the department.
- (b) Each violation of this regulation shall be punishable by the following:
- (1) A \$1,000 penalty for the first violation;
  - (2) a \$2,500 penalty for the second violation; and
  - (3) a \$5,000 penalty and an operator license review for the third violation.

### **Complete and return with Haul-Off Pit Application, Form CDP1(2004)**

Haul-off pit will be located in an on-site disposal area:  Yes  No

Haul-off pit is located in an off-site disposal area on acreage owned by the same landowner:  
 Yes  No If yes, written permission from the land owner must be obtained. Attach written permission to haul-off pit application.

Haul-off pit is located in an off-site disposal area on another **producing** lease or unit operated by the same operator:  Yes  No If yes, written permission from the land owner must be obtained. Attach permission and a copy of the lease assignment that covers the acreage where the haul-off pit is to be located, to the haul-off pit application.

15-077-21689-0000  
KANSAS CORPORATION COMMISSION  
OIL & GAS CONSERVATION DIVISION

RECEIVED

JUL 13 2010

Form KSONA-1

July 2010

Form Must Be Typed

Form must be Signed

All blanks must be Filled

**CERTIFICATION OF COMPLIANCE WITH THE  
KANSAS SURFACE OWNER NOTIFICATION ACT**

This form must be submitted with all Forms C-1 (Notice of Intent to Drill); CB-1 (Cathodic Protection Borehole Intent); T-1 (Request for Change of Operator Transfer of Injection or Surface Pit Permit); and CP-1 (Well Plugging Application). Any such form submitted without an accompanying Form KSONA-1 will be returned.

Select the corresponding form being filed:  C-1 (Intent)  CB-1 (Cathodic Protection Borehole Intent)  T-1 (Transfer)  CP-1 (Plugging Application)

OPERATOR: License # 33936  
Name: CHARLES N. GRIFFIN  
Address 1: P.O. Box 347  
Address 2: \_\_\_\_\_  
City: Pratt State: KS Zip: 67124 + \_\_\_\_\_  
Contact Person: Charles N. Griffin  
Phone: ( 720 ) 490-5648 Fax: ( 620 ) 680-1262  
Email Address: \_\_\_\_\_

Well Location:  
SE SW NW Sec. 31 Twp. 33 S. R. 8  East  West  
County: Harper  
Lease Name: Diel Well #: 1

If filing a Form T-1 for multiple wells on a lease, enter the legal description of the lease below:

**Surface Owner Information:**

Name: Diel Farms LLC / C/O Brent Diel  
Address 1: 212 Coats Street  
Address 2: \_\_\_\_\_  
City: Kiowa State: KS Zip: 67070 + \_\_\_\_\_

When filing a Form T-1 involving multiple surface owners, attach an additional sheet listing all of the information to the left for each surface owner. Surface owner information can be found in the records of the register of deeds for the county, and in the real estate property tax records of the county treasurer.

If this form is being submitted with a Form C-1 (Intent) or CB-1 (Cathodic Protection Borehole Intent), you must supply the surface owners and the KCC with a plat showing the predicted locations of lease roads, tank batteries, pipelines, and electrical lines. The locations shown on the plat are preliminary non-binding estimates. The locations may be entered on the Form C-1 plat, Form CB-1 plat, or a separate plat may be submitted.

**Select one of the following:**

I certify that, pursuant to the Kansas Surface Owner Notice Act (House Bill 2032), I have provided the following to the surface owner(s) of the land upon which the subject well is or will be located: 1) a copy of the Form C-1, Form CB-1, Form T-1, or Form CP-1 that I am filing in connection with this form; 2) if the form being filed is a Form C-1 or Form CB-1, the plat(s) required by this form; and 3) my operator name, address, phone number, fax, and email address.

I have not provided this information to the surface owner(s). I acknowledge that, because I have not provided this information, the KCC will be required to send this information to the surface owner(s). To mitigate the additional cost of the KCC performing this task, I acknowledge that I am being charged a \$30.00 handling fee, payable to the KCC, which is enclosed with this form.

If choosing the second option, submit payment of the \$30.00 handling fee with this form. If the fee is not received with this form, the KSONA-1 form and the associated Form C-1, Form CB-1, Form T-1, or Form CP-1 will be returned.

I hereby certify that the statements made herein are true and correct to the best of my knowledge and belief.

Date: 7/13/10 Signature of Operator or Agent: \_\_\_\_\_ Title: Agent